



- EXCAVATION - (SPECIAL)
- SCARIFY EXISTING SURFACE
- REMOVE AND REPLACE SIDEWALK
- PROPOSED GUARD POST
- PROPOSED SIGN

GUARD POSTS		
STA.	OFFSET	EACH
335+16.57	13	1
337+80.72	41	1
337+84.01	41	1
337+87.31	41	1

PROPOSED SIGN PANEL TYPE 1	WOOD SUPPORT (FOOT)
STA. 334+02, 25.00' RT, 3 SQ. FT. (R6-1R)	14
STA. 334+09, 24.20' LT, 1.5 SQ. FT. (R7-8)	14
STA. 334+09, 24.20' LT, 0.5 SQ. FT. (R7-110I)	14
STA. 334+25, 23.97' LT, 1.5 SQ. FT. (R7-8)	14
STA. 334+25, 23.97' LT, 0.5 SQ. FT. (R7-110I)	14
STA. 334+43, 7.54' LT, 6.25 SQ. FT. (R5-1)	14
STA. 334+43, 12.95' RT, 6.25 SQ. FT. (R5-1)	14

LOCATION	EXCAVATION SPECIAL (CU YD)
PARKING LOT	
STA. 333+94 TO STA. 334+32	19.4
STA. 338+11 TO STA. 338+36	4.3
STA. 338+19 TO STA. 338+33	1.2

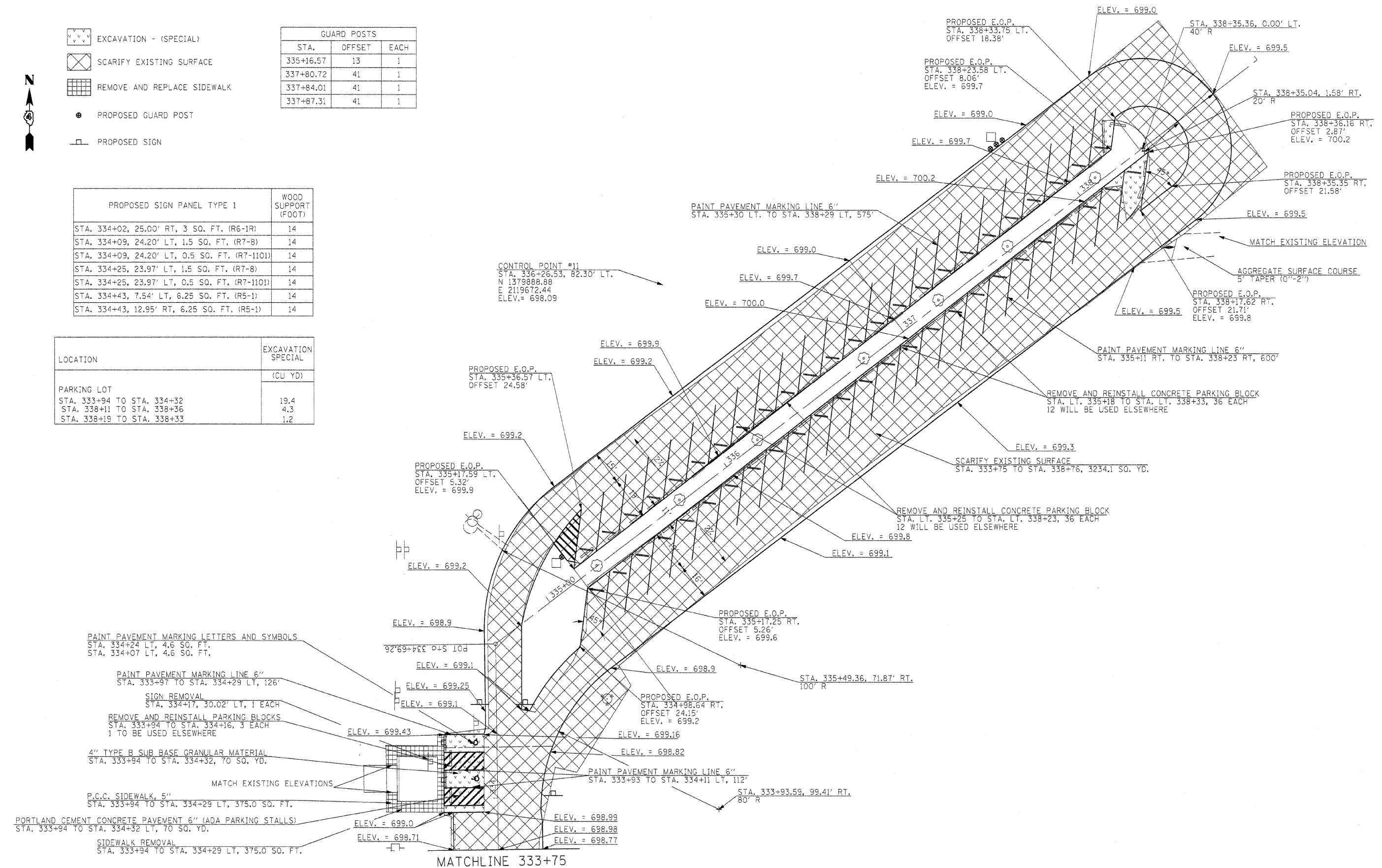

FILE NAME =	USER NAME = #USER#	DESIGNED - R.H.D.	REVISED -	STATE OF ILLINOIS DEPARTMENT OF TRANSPORTATION	ARGYLE LAKE STATE PARK SIDE ROAD	F.A. RTE.	SECTION	COUNTY	TOTAL SHEETS	SHEET NO.	
#FILE#		DRAWN - J.T.T.	REVISED -			ARGYLE LAKE STATE PARK	MCDONOUGH	162	72	CONTRACT NO. 46158	
PLOT SCALE = #SCALE#		CHECKED - T.T.P.	REVISED -			SCALE: 1" = 20' SHEET NO. 72 OF 162 SHEETS STA. 333+75 TO STA. 339+00					
PLOT DATE = #DATE#		DATE - 12/09/10	REVISED -			FED. ROAD DIST. NO. ILLINOIS FED. AID PROJECT					