

STATE OF ILLINOIS
DEPARTMENT OF TRANSPORTATION

DIVISION OF HIGHWAYS

PROPOSED
GRANT HOME SIDEWALKS
ROUTE PARK ROADS
SECTION PARK ROADS
JO DAVIESS COUNTY
JOB NO. C-30-008-11

F.A.P. RTE.	SECTION	COUNTY	TOTAL SHEETS	SHEET NO.
		JO DAVIESS	18	1
		ILLINOIS	CONTRACT NO. 46165	

INDEX OF SHEETS

- 1 COVER SHEET
- 2 SUMMARY OF QUANTITIES
- 3 TYPICAL SECTIONS, MISCELLANEOUS DETAILS & LEGEND
- 4 SCHEDULE OF QUANTITIES
- 5 CONTROL SURVEY TIES & BENCHMARKS
- 6-9 PLAN AND PROFILES
- 10 TRAIL 1, 2 & 3 IMPROVEMENTS PLAN
- 11 DRAINAGE PLAN
- 12-18 CROSS SECTIONS

STATE STANDARDS

- 000001-06 STANDARD SYMBOLS, ABBREVIATIONS AND PATTERNS
- 280001-05 TEMPORARY EROSION CONTROL SYSTEMS
- 601101-01 CONCRETE HEADWALL FOR PIPE UNDERDRAIN
- 701301-04 LANE CLOSURE, 2L, 2W, SHORT TIME OPERATIONS
- 701801-04 LANE CLOSURE MULTILANE 1W OR 2W CROSSWALK OR SIDEWALK CLOSURE
- 701901-01 TRAFFIC CONTROL DEVICES

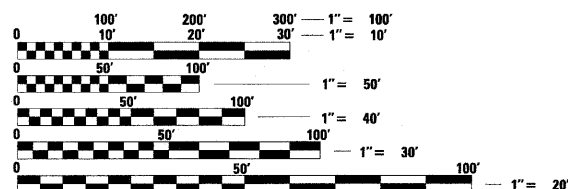

FULL SIZE PLANS HAVE BEEN PREPARED USING STANDARD ENGINEERING SCALES. REDUCED SIZED PLANS WILL NOT CONFORM TO STANDARD SCALES. IN MAKING MEASUREMENTS ON REDUCED PLANS, THE ABOVE SCALES MAY BE USED.

J.U.L.I.E.
JOINT UTILITY LOCATION INFORMATION FOR EXCAVATION
1-800-892-0123
OR 811

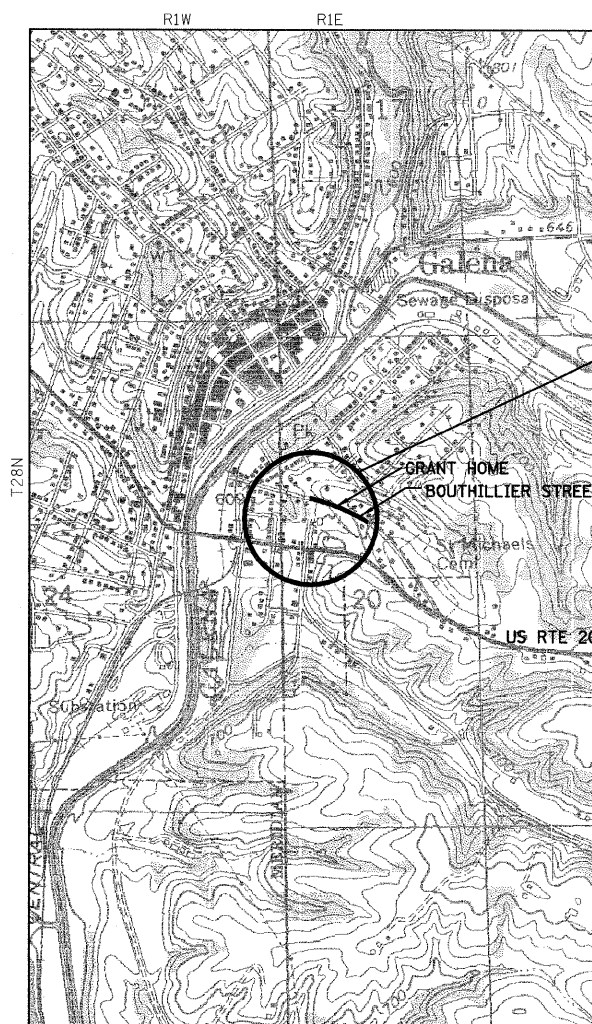

LOCATION MAP
NOT TO SCALE

GROSS LENGTH = 693.08 FT. = 0.131 MILE
NET LENGTH = 693.08 FT. = 0.131 MILE

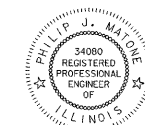

Philip Mathe 1/31/11
SIGNATURE

EXPIRATION DATE NOV. 30, 2011

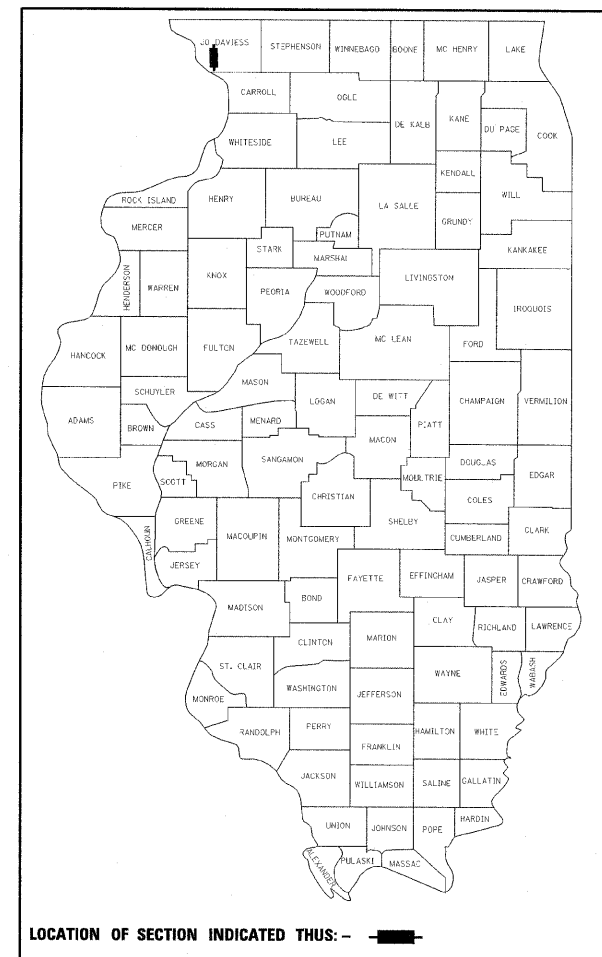

STATE OF ILLINOIS
DEPARTMENT OF TRANSPORTATION
DIVISION OF HIGHWAYS

SUBMITTED February 7 20 11
William R. Frey Jr.
DEPUTY DIRECTOR OF HIGHWAYS, REGION ENGINEER

March 25 20 11
Scott E. Stitt P.E. Jr.
ENGINEER OF DESIGN AND ENVIRONMENT

March 25 20 11
Christine M. Reed Jr.
DIRECTOR OF HIGHWAYS, CHIEF ENGINEER

**PRINTED BY THE AUTHORITY
OF THE STATE OF ILLINOIS**