

NO.	STATION	OFFSET
①	7000+05.00	11.16' RT

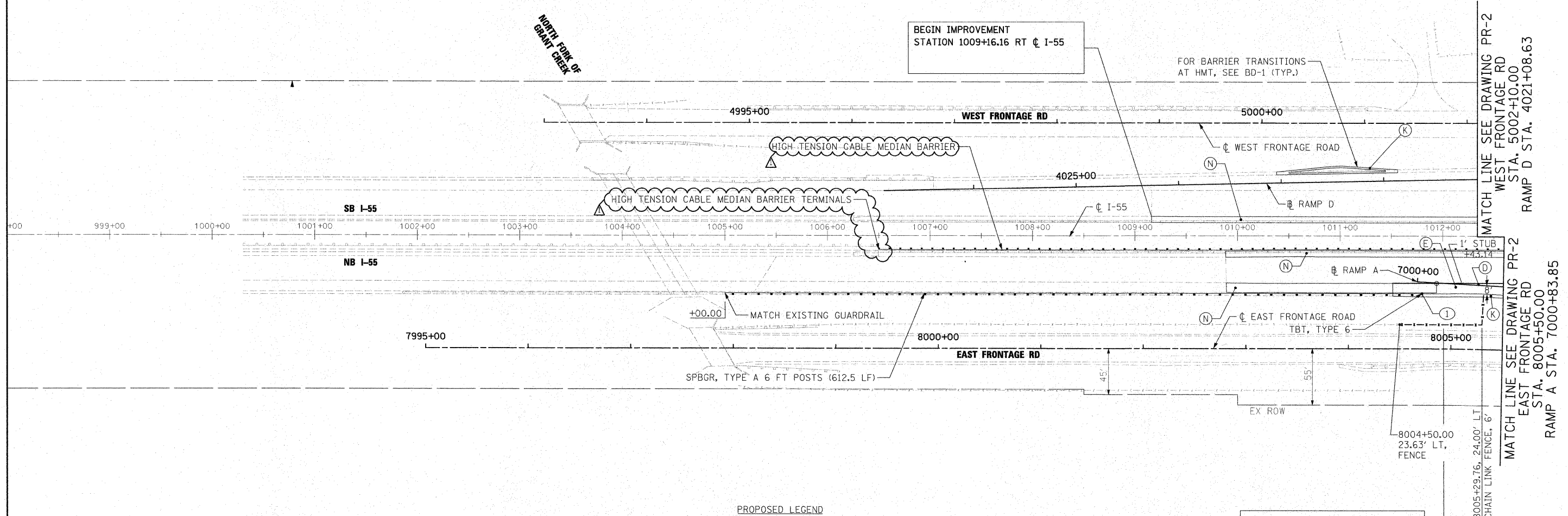

- PROPOSED LEGEND**
- (A) PCC PAVEMENT 10" (JOINTED)
 - (B) PCC SHOULDERS, 10"
 - (C) AGGREGATE SHOULDERS, TYPE B 10"
 - (D) HMA PAVEMENT (SEE TYPICAL SECTIONS)
 - (E) HMA SHOULDERS (SEE TYPICAL SECTIONS)
 - (F) CONCRETE MEDIAN SURFACE, 4 INCH
 - (G) CONCRETE MEDIAN RAMP NOSE (SEE STD 606301-04)
PAID FOR AS CONCRETE MEDIAN, TYPE SB-6.24 (MODIFIED)
 - (H) CONCRETE MEDIAN, TYPE SB 6.24 (MODIFIED)
 - (I) COMBINATION CONCRETE CURB & GUTTER TYPE B-6.24
 - (J) COMBINATION CONCRETE CURB & GUTTER TYPE M-2.24
 - (K) CONCRETE BARRIER, DOUBLE FACE, 42" HEIGHT
 - (L) IMPACT ATTENUATOR FULLY REDIRECTIVE NARROW TEST LEVEL 3
 - (M) CORRUGATED MEDIAN
 - (N) HMA SHOULDER CROSS SLOPE CORRECTION
 - (O) STATION OFFSET
 - FENCE AS INDICATED IN PLANS

NOTE:
 1. FOR CURVE DATA SEE ALIGNMENTS, TIES AND BENCHMARKS DRAWING NOS. AT-1 TO AT-9
 2. FOR ROW CALL-OUTS SEE PLAT OF HIGHWAY SHEETS

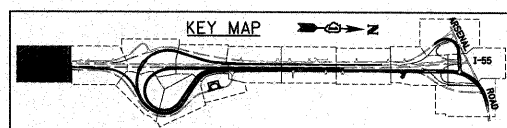

McDonough Associates Inc.
 Engineers / Architects
 130 East Randolph Street Chicago, Illinois 60601

FILE NAME = D160F12-SHT-PLAN01.dgn	USER NAME = TKluegel	DESIGNED - JTF	REVISED - REV. 4/14/11
		DRAWN - JTF	REVISED -
		CHECKED - DLT	REVISED -
		DATE - 2/4/11	REVISED -

**STATE OF ILLINOIS
DEPARTMENT OF TRANSPORTATION**

PROPOSED PLAN

SCALE: 1"=50' SHEET NO. 1 OF 15 SHEETS STA. TO STA.

F.A.I. RTE.	SECTION	COUNTY	TOTAL SHEETS	SHEET NO.
55	99-2HB-2B-1	WILL	756	59
				CONTRACT NO. 60F12