

COMMITMENTS

- PRIOR TO CONSTRUCTION COMMENCING IN THE INTERSTATE 55/ARSENAL ROAD INTERCHANGE AREA, THE LOCATION OF THE FALSE MALLOW, BLANDING'S TURTLE, AND RED-TAILED PRAIRIE LEAFHOPPER WILL BE IDENTIFIED AND FENCING WILL BE ERECTED AROUND THE AREA TO PREVENT THE INTRUSION OF PERSONNEL AND VEHICLES. ALSO, A TRAINING SESSION WILL BE HELD AT THE PRE-CONSTRUCTION MEETING TO ALERT CONSTRUCTION PERSONNEL OF THE SENSITIVITY OF THE PLANT AND ANIMAL SPECIES AND THE NEED TO AVOID ACCIDENTAL INTRUSIONS OR SPILLS IN THE AREA. THE TRAINING SESSION WILL ALSO ADDRESS ACCIDENTAL INTRUSIONS INTO THE NOTEWORTHY BOTANICAL AREAS THAT WILL NOT BE IMPACTED.
- A RETAINING WALL IS PROPOSED ALONG THE EAST SIDE OF THE EXTENSION OF ARSENAL ROAD ALONG THE EAST FRONTAGE OF INTERSTATE 55 TO MINIMIZE RIGHT-OF-WAY ACQUISITION FROM THE HIGH QUALITY WETLAND AND FLOOD PLAIN.
- THE IDNR INCIDENTAL TAKE AUTHORIZATION FOR THE BLANDING'S TURTLE SHALL BE EXECUTED PRIOR TO PROJECT AWARD.
- HIGH MAST INTERCHANGE LIGHTING WILL BE INSTALLED AS PART OF THE INTERCHANGE IMPROVEMENT. IN ORDER TO MINIMIZE IMPACT ON THE ADJACENT WETLANDS AND BOTANICAL SITES, SHIELDING OF THE LIGHTS WILL BE INCLUDED TO REDUCE THE AMOUNT OF LIGHT FALLING BEYOND THE INTERCHANGE RAMPS.
- ANY INTERMITTENT LANE CLOSURES ON INTERSTATE 55 TO CONSTRUCT THE PROPOSED BRIDGE PIERS FOR THE SOUTHBOUND EXIT RAMP FLYOVER BRIDGE AND THE WEST FRONTAGE ROAD BRIDGE MUST BE DONE DURING NIGHTTIME HOURS. NO LANE CLOSURES WILL BE ALLOWED ON INTERSTATE 55 DURING DAYTIME HOURS.
- INSTALLATION OF EMERGENCY VEHICLE PREEMPTION EQUIPMENT WILL BE COORDINATED WITH THE CHANNAHON FIRE DEPARTMENT VIA A LETTER OF INTENT THROUGH IDOT OR AN INTERGOVERNMENTAL AGREEMENT THROUGH THE COUNTY.
- THE PROJECT AREA CONTAINS BOTH SENSITIVE PLANT AND ANIMAL SPECIES THAT NEED TO BE AVOIDED DURING CONSTRUCTION. A TRAINING SESSION SHALL BE CONDUCTED BY THE ENGINEER DURING THE PRECONSTRUCTION MEETING TO ALERT PROJECT PERSONNEL ON THE NEED TO AVOID ACCIDENTAL INTRUSIONS OR SPILLS IN THE SENSITIVE AREAS. THE TRAINING SESSION WILL ALSO ADVISE PROJECT PERSONNEL TO AVOID ACCIDENTAL INTRUSIONS OR SPILLS INTO NOTE-WORTHY BOTANICAL AND WETLAND AREAS. ALL SENSITIVE AREAS ARE TO BE FENCED OFF AND CLEARLY MARKED AS SHOWN ON THE EROSION AND SEDIMENT CONTROL DRAWINGS.
- THIS PROJECT REQUIRES A US ARMY CORPS OF ENGINEERS 404 PERMIT. THE PERMIT ISSUED TO THE DEPARTMENT DOES NOT COVER IN STREAM WORK BY THE CONTRACTOR; THEREFORE AFTER AWARD, THE CONTRACTOR WILL NEED TO COORDINATE AND HAVE HIS WORK PLAN APPROVED BY THE CORPS. GUIDELINES ON ACCEPTABLE IN STREAM WORK TECHNIQUES CAN BE FOUND ON THE CORPS WEBSITE [HTTP://WWW.LRC.USACE.ARMY.MIL/](http://www.lrc.usace.army.mil/)

GENERAL NOTES

- THE THICKNESS OF HMA SHOWN ON THE PLANS IS THE NOMINAL THICKNESS. DEVIATIONS FROM THE NOMINAL THICKNESS WILL BE PERMITTED WHEN SUCH DEVIATIONS OCCUR DUE TO IRREGULARITIES IN THE EXISTING SURFACE OR BASE ON WHICH THE HMA IS PLACED.
- THE HMA SURFACE OF ALL MAILBOX TURNOUTS, PRIVATE ENTRANCES, COMMERCIAL ENTRANCES, AND SIDE ROADS SHALL BE MADE NEATLY, IN A WORKMANLIKE MANNER, AND SHALL ACCURATELY CONFORM TO THE SHAPES AND DIMENSIONS SHOWN ON THE PLAN DETAILS. THE CONTRACTOR SHALL BE REQUIRED TO SAW CUT THE HMA SURFACE TO CONFORM TO THE SHAPES AND DIMENSIONS SHOWN ON THE PLAN DETAILS. THIS WORK SHALL BE INCLUDED IN THE COST OF THE HMA SURFACE.
- THE BASE COURSE WIDENING SHALL BE CARRIED THROUGH ALL ENTRANCES, SIDE ROADS, AND MAILBOX TURNOUTS. EXCEPTIONS WILL BE SHOWN ON THE PLANS.
- EXCEPT AS NOTED ON THE PLANS, PAVEMENT GRADES SHOWN ARE AT THE TOP OF PAVEMENT SURFACES.
- BEFORE ORDERING PIPE CULVERTS OR PIPE DRAINS, THE CONTRACTOR SHALL CONSULT THE ENGINEER FOR EXACT LENGTHS.
- THE ENGINEER WILL BE THE SOLE JUDGE CONCERNING CURING TIME FOR THE VARIOUS HMA LIFTS.
- SEEDING SHALL NOT BE PERMITTED AT ANY TIME WHEN THE GROUND IS FROZEN, WET, OR IN AN UNTILLABLE CONDITION. LOCATIONS TO BE SEEDED WILL BE DETERMINED BY THE ENGINEER.
- ONLY THOSE TREES DESIGNATED BY THE ENGINEER, LISTED IN THE TREE REMOVAL SCHEDULE, OR SHOWN IN THE PLANS SHALL BE REMOVED. THE CONTRACTOR SHALL PROTECT ALL REMAINING TREES FROM DAMAGE DUE TO HIS OPERATIONS.

GENERAL NOTES

9. THE LOCATION OF EXISTING DRAINAGE STRUCTURES, STORM SEWERS, WATER MAINS, SANITARY SEWERS, AND ANY OTHER PUBLIC OR PRIVATE UTILITIES AS SHOWN ON THE PLANS IS APPROXIMATE, AND THEIR EXACT LOCATION IS TO BE DETERMINED IN THE FIELD BY THE CONTRACTOR. THIS WORK SHALL BE PAID FOR PER ART. 105.07 OF THE STANDARD SPECIFICATIONS. LOCATING UTILITIES SHALL BE PAID PER ART. 109.04.

10. WET REFLECTIVE TEMPORARY TAPE, TYPE III SHALL BE USED TO OUTLINE EXIT AND ENTRANCE RAMPS FOR THE PRIME COAT APPLICATION AND EACH RESURFACING LIFT.

11. THE WORK REQUIRED TO CONNECT ANY SEWER TO AN EXISTING DRAINAGE STRUCTURE OR PIPE WILL NOT BE PAID FOR SEPARATELY, BUT SHALL BE CONSIDERED AS INCLUDED IN THE CONTRACT UNIT PRICE BID FOR THE SEWER ITEMS.

12. ON EXISTING PAVEMENT WHICH MAY BE SUPERELEVATED, THE NEW HMA PAVEMENT SHALL BE BUILT WITH THE SAME SUPERELEVATION UNLESS NEW SUPERELEVATION RATES ARE GIVEN ON THE PLANS.

13. THE CONTRACTOR SHALL PROTECT AND CAREFULLY PRESERVE ALL SECTION OR SUBSECTION MONUMENTS, PROPERTY CORNERS, AND REFERENCE MARKERS UNTIL THE OWNER, HIS AGENT, OR ANY AUTHORIZED SURVEYOR HAS WITNESSED OR OTHERWISE REFERENCED THEIR LOCATIONS.

14. ABANDONED UNDERGROUND UTILITIES THAT CONFLICT WITH CONSTRUCTION SHALL BE DISPOSED OF OUTSIDE THE LIMITS OF THE RIGHT OF WAY ACCORDING TO ARTICLE 202.03 OF THE STANDARD SPECIFICATIONS AND AS DIRECTED BY THE ENGINEER. THIS WORK WILL NOT BE PAID FOR SEPARATELY, BUT SHALL BE INCLUDED IN THE COST OF EARTH EXCAVATION.

15. USE EPOXY-COATED TIE BARS, CONFORMING TO ART. 1006.10 OF THE STANDARD SPECIFICATIONS, FOR ALL TIE BARS.

16. THE CONTRACTOR SHALL CONTACT IDOT EXPRESSWAY TRAFFIC (847-705-4151) TWO WEEKS PRIOR TO THE PLACEMENT OF FINAL PAVEMENT MARKINGS.

17. THE REMOVAL OF ALL PIPE END SECTIONS ARE INCLUDED IN THE COST OF EARTH EXCAVATION.

18. ANY REFERENCE TO A STANDARD IN THESE PLANS SHALL BE INTERPRETED TO MEAN THE EDITION AS INDICATED BY THE SUBNUMBER SHOWN IN THE LIST OF STANDARDS OR THE COPY INCLUDED IN THESE PLANS.

19. THE FOLLOWING RATES OF APPLICATION HAVE BEEN USED IN CALCULATING PLAN QUANTITIES:

GRANULAR MATERIALS	2.05	TONS / CU YD
BITUMINOUS MAT PRIME COAT	0.05	GAL / SQ YD - BETWEEN LIFTS
	0.5	GAL / SQ YD - AGGREGATE
	0.1	GAL / SQ YD - ABOVE PCC BASE
AGGREGATE (PRIME COAT)	0.002	TONS / SQ YD
HMA RESURFACING	112	LBS / SQ YD / IN
LEVEL BINDER (HAND METHOD)	112	LBS / SQ YD / IN
SUPPLEMENTAL WATERING	3	GAL / SQ YD / APPLICATION

20. ALL DAMAGE TO DEPARTMENT OWNED UNDERGROUND FACILITIES, CAUSED BY THE CONTRACTOR SHALL BE REPAIRED TO THE SATISFACTION OF THE DEPARTMENT AT THE CONTRACTOR'S EXPENSE. THIS SHALL INCLUDE ALL TEMPORARY REPAIRS REQUIRED TO KEEP THE FACILITY OPERATIONAL WHILE MATERIAL IS BEING OBTAINED TO MAKE PERMANENT REPAIRS. SPLICING OF ELECTRIC CABLE SHALL NOT BE ALLOWED. ELECTRIC CABLE SHALL BE REPLACED FROM POLE TO POLE OR CONTROLLER.

21. MEMBERS OF JULIE KNOWN TO BE WITHIN THE LIMITS OF THE IMPROVEMENT ARE:
 ALLIANCE: CHRIS CLEVELAND 815-370-3520
 AT&T: MITCH CULLEN 630-573-6447
 COM ED: TIM COSLET 815-724-5010
 MGT: JUSTIN MALONEY 815-690-7901
 NICOR: ED VANSCOIT 815-740-4100 EXT 261
 ONE OK NORTH: ROBERT WILD 815-942-2230 EXT. 2114
 TEPPCO: MIKE BOOMSMA 708-906-8659

22. THE CONTRACTOR SHALL CONTACT JULIE AT LEAST 48 HOURS PRIOR TO EXCAVATION TO DETERMINE WHICH UTILITIES ARE IN THE AREA.

23. THE CONTRACTOR SHALL MAINTAIN EXISTING STREET ACCESS, EXISTING DRIVEWAY ACCESS, AND PEDESTRIAN ACCESS TO ABUTTING PROPERTY AT ALL TIMES DURING CONSTRUCTION OF THE PROJECT, UNLESS OTHERWISE NOTED IN THE PLANS OR DIRECTED BY THE ENGINEER. THIS WORK SHALL BE INCLUDED IN THE ITEM "TEMPORARY ACCESS (COMMERCIAL ENTRANCE)".

24. SAWING OF REMOVAL ITEMS AS NOTED ON THE PLANS, SPECIFIED IN THE STANDARD SPECIFICATIONS, OR AS REQUIRED BY THE ENGINEER SHALL BE INCLUDED IN THE COST OF THE ITEM BEING REMOVED

25. IT IS THE CONTRACTOR'S RESPONSIBILITY TO ASCERTAIN EXISTING FIELD CONDITIONS BEFORE BIDDING ON THIS CONTRACT

26. HORIZONTAL CONTROL IS BASED ON IL STATE PLANE COORDINATES, EAST ZONE, NAD-83. NGS MONUMENT PID #AE2474 WAS RECEIVED AND USED. COORDINATES AND DISTANCES SHOWN ARE "GROUND" COORDINATES. COMBINED SCALE FACTOR (GROUND TO GRID) = 0.99995548.

27. ELEVATIONS ARE BASED ON NGS MONUMENT PID #MF0335 AND NAVD-88 DATUM.

28. THE GENERAL CONTRACTOR IS REQUIRED TO HIRE AN ENVIRONMENTAL FIRM WITH AT LEAST FIVE (5) DOCUMENTED LEAKING UNDERGROUND STORAGE TANK (LUST) CLEANUPS OR THAT IS PRE-QUALIFIED IN HAZARDOUS WASTE BY THE DEPARTMENT TO REMEDIATE THE SOIL CONTAMINATION AND MONITOR FOR WORKER PROTECTION.

29. THE PHASE III CONSULTANT WILL BE RESPONSIBLE FOR THE RE-ESTABLISHMENT OF CONTROL AND TIE POINTS AS SHOWN ON THE ALIGNMENT, TIES, AND BENCHMARKS SHEETS. THE CONTRACTOR SHALL COORDINATE THE RE-ESTABLISHMENT OF THE EXISTING CONTROL AND TIE POINTS DISTURBED BY THE CONSTRUCTION ACTIVITIES WITH THE RESIDENT ENGINEER AND PHASE III CONSULTANT. EXISTING CONTROL AND TIE POINT LOCATIONS THAT ARE CONSIDERED NOT VIABLE UNDER THE FINAL CONDITIONS MAY BE RE-ESTABLISHED AT A MORE FEASIBLE LOCATION, AS APPROVED BY THE RESIDENT ENGINEER. THE PHASE III CONSULTANT SHALL SUBMIT DOCUMENTATION OF ALL RE-ESTABLISHED CONTROL AND TIE POINTS TO THE DEPARTMENT NO LATER THAN ONE (1) MONTH AFTER COMPLETION OF THE CONTRACT.

30. R.O.W. FENCING: THE PROPOSED R.O.W. FENCE SHOWN ON THE PLANS SHALL BE PLACED ONLY AT LOCATIONS WHERE PRIVATE FENCES PREVIOUSLY EXISTED. IF THE PROPERTY OWNERS HAVE ALREADY REPLACED THE PRIVATE FENCES, THEN THE R.O.W. FENCE SHALL BE OMITTED AT THOSE LOCATIONS, AS DIRECTED BY THE ENGINEER. THE FENCE QUANTITY SHALL BE REDUCED ACCORDINGLY. THIS WORK WILL BE MEASURED AND PAID FOR AS "TEMPORARY FENCE (SPECIAL)."

31. THE TIE BARS AT THE LONGITUDINAL CONSTRUCTION JOINT BETWEEN THE PCC SHOULDER AND THE ANCHOR SLAB SHALL NOT BE PAID FOR SEPARATELY BUT SHALL BE CONSIDERED INCLUDED IN THE COST PER SQUARE YARD OF THE PCC SHOULDER.

32. BEDROCK AND UTILITY ELEVATIONS ARE APPROXIMATE. CONTRACTOR TO VERIFY IN FIELD.

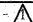
FILE NAME =	USER NAME = TKLuegel	DESIGNED - TRK	REVISED -  REV. 4/14/11
D:\60F12-SHT-GENNOTE.dgn		DRAWN - TRK/JPW	REVISED -
	PLOT SCALE = 1:50	CHECKED - DLT	REVISED -
	PLOT DATE = 4/14/2011	DATE - 2/4/11	REVISED -

F.A.I RTE.	SECTION	COUNTY	TOTAL SHEETS	SHEET NO.
55	99-2HB-2B-1	WILL	756	4
CONTRACT NO. 60F12				
FED. ROAD DIST. NO. 1 ILLINOIS FED. AID PROJECT				

ACIM
ACBRE
ACIM

ROADWAY
URBAN
90% FED.
10% STATE

RETAINING WALLS

WEST FRONTAGE
OVER 1-55
SN 093-0347

SB EXIT RAMP
OVER 1-55
SN 093-0348

ELECTRICAL
TRAFFIC
SURVEILLANCE

CODE NUMBER	PAY ITEM	UNIT	TOTAL QUANTITY	CONSTRUCTION TYPE CODES			
				0001	0010	0008	0021
20100110	TREE REMOVAL (6 TO 15 UNITS DIAMETER)	UNIT	1,583	1,583			
20100210	TREE REMOVAL (OVER 15 UNITS DIAMETER)	UNIT	368	368			
20100500	TREE REMOVAL, ACRES	ACRE	4.25	4.25			
20200100	EARTH EXCAVATION	CU YD	158,750	158,750			
20200200	ROCK EXCAVATION	CU YD	605	605			
20201200	REMOVAL AND DISPOSAL OF UNSUITABLE MATERIAL	CU YD	26,872	26,872			
20400800	FURNISHED EXCAVATION	CU YD	131,190	131,190			
20700220	POROUS GRANULAR EMBANKMENT	CU YD	12,130	8,241	3,889		
20800150	TRENCH BACKFILL	CU YD	8,133	8,133			
21001000	GEOTECHNICAL FABRIC FOR GROUND STABILIZATION	SQ YD	12,225	12,225			
21101505	TOPSOIL EXCAVATION AND PLACEMENT	CU YD	35,000	35,000			
* 21101805	COMPOST FURNISH AND PLACE, 2"	SQ YD	179,564	179,564			
* 25000210	SEEDING, CLASS 2A	ACRE	22.9	22.9			
* 25000310	SEEDING, CLASS 4	ACRE	35.2	35.2			
* 25000400	NITROGEN FERTILIZER NUTRIENT	POUND	2,130	2,130			
* 25000500	PHOSPHORUS FERTILIZER NUTRIENT	POUND	2,130	2,130			
* 25000600	POTASSIUM FERTILIZER NUTRIENT	POUND	2,130	2,130			
25000775	SELECTIVE MOWING STAKES	EACH	62	62			
25100115	MULCH, METHOD 2	ACRE	144.4	144.4			
25100630	EROSION CONTROL BLANKET	SQ YD	133,721	133,721			
28000200	EARTH EXCAVATION FOR EROSION CONTROL	CU YD	80	80			
28000250	TEMPORARY EROSION CONTROL SEEDING	POUND	11,515	11,515			
28000305	TEMPORARY DITCH CHECKS	FOOT	1,320	1,320			
28000400	PERIMETER EROSION BARRIER	FOOT	30,500	30,500			
28000500	INLET AND PIPE PROTECTION	EACH	26	26			
28000510	INLET FILTERS	EACH	62	62			
28100105	STONE RIPRAP, CLASS A3	SQ YD	270	270			
28100107	STONE RIPRAP, CLASS A4	SQ YD	263	263			
28100109	STONE RIPRAP, CLASS A5	SQ YD	1,256	1,256			
28200200	FILTER FABRIC	SQ YD	1,761	1,761			
31101100	SUBBASE GRANULAR MATERIAL, TYPE B	CU YD	5,628	5,628			
31200502	STABILIZED SUBBASE - HOT-MIX ASPHALT, 4 1/2"	SQ YD	94,400	94,400			
35300500	PORTLAND CEMENT CONCRETE BASE COURSE 10"	SQ YD	15,863	15,863			
35501316	HOT-MIX ASPHALT BASE COURSE, 8"	SQ YD	1,521	1,521			
40200800	AGGREGATE SURFACE COURSE, TYPE B	TON	427	427			
40600100	BITUMINOUS MATERIALS (PRIME COAT)	GALLON	10,826	10,826			

* DENOTES SPECIALTY ITEM

Rev. 4-14-11

Rev.

FILE NAME = D160F12-SHT-50001.dgn	USER NAME = TKluegel	DESIGNED - MJT	REVISED -	STATE OF ILLINOIS DEPARTMENT OF TRANSPORTATION	SUMMARY OF QUANTITIES	F.A.I. RTE. 55	SECTION 99-2HB-2B-1	COUNTY WILL	TOTAL SHEETS 756	SHEET NO. 5	
PLOT SCALE = 1:50	CHECKED - DLT	REVISED -	SCALE: NONE			SHEET NO. 1 OF 11 SHEETS	STA.	TO STA.	FED. ROAD DIST. NO. 1	ILLINOIS FED. AID PROJECT	CONTRACT NO. 60F12
PLOT DATE = 2/4/2011	DATE - 2/4/11	REVISED -									

CODE NUMBER	PAY ITEM	UNIT	TOTAL QUANTITY	CONSTRUCTION TYPE CODES				
				0001	0040	0010	0008	0021
40600300	AGGREGATE (PRIME COAT)	TON	3	3				
40600895	CONSTRUCTING TEST STRIP	EACH	2	2				
40600982	HOT-MIX ASPHALT SURFACE REMOVAL - BUTT JOINT	SQ YD	145	145				
40603085	HOT-MIX ASPHALT BINDER COURSE, IL-19.0, N70	TON	2,100	2,100				
40603310	HOT-MIX ASPHALT SURFACE COURSE, MIX "C", N50	TON	171	171				
40603340	HOT-MIX ASPHALT SURFACE COURSE, MIX "D", N70	TON	1,868	1,868				
40701881	HOT-MIX ASPHALT PAVEMENT (FULL-DEPTH), 10"	SQ YD	620	620				
42000501	PORTLAND CEMENT CONCRETE PAVEMENT 10" (JOINTED)	SQ YD	84,581	84,581				
42001300	PROTECTIVE COAT	SQ YD	128,936	128,936				
42001420	BRIDGE APPROACH PAVEMENT CONNECTOR (PCC)	SQ YD	2,237	2,237				
44000100	PAVEMENT REMOVAL	SQ YD	67,105	67,105				
44000155	HOT-MIX ASPHALT SURFACE REMOVAL, 1 1/2"	SQ YD	1,261	1,261				
44000165	HOT-MIX ASPHALT SURFACE REMOVAL, 4"	SQ YD	1,126	1,126				
44000200	DRIVEWAY PAVEMENT REMOVAL	SQ YD	4,780	4,780				
44000500	COMBINATION CURB AND GUTTER REMOVAL	FOOT	1,384	1,384				
44004000	PAVED DITCH REMOVAL	FOOT	32	32				
44004250	PAVED SHOULDER REMOVAL	SQ YD	23,910	23,910				
44300200	STRIP REFLECTIVE CRACK CONTROL TREATMENT	FOOT	7,783	7,783				
48101600	AGGREGATE SHOULDERS, TYPE B 8"	SQ YD	42	42				
48101620	AGGREGATE SHOULDERS, TYPE B 10"	SQ YD	7,430	7,430				
48203029	HOT-MIX ASPHALT SHOULDERS, 8"	SQ YD	95	95				
48203037	HOT-MIX ASPHALT SHOULDERS, 10"	SQ YD	16,627	16,627				
48300500	PORTLAND CEMENT CONCRETE SHOULDERS 10"	SQ YD	28,400	28,400				
50100300	REMOVAL OF EXISTING STRUCTURES NO. 1	EACH	1			1		
50200100	STRUCTURE EXCAVATION	CU YD	11,829		11,600	146		83
50200400	ROCK EXCAVATION FOR STRUCTURES	CU YD	5,207	2,014	2,440	38	65	650
50200450	REMOVAL AND DISPOSAL OF UNSUITABLE MATERIAL FOR STRUCTURES	CU YD	2,318		2,000	24	294	
50300225	CONCRETE STRUCTURES	CU YD	6,634.2		5,873.5	247.5	377.2	136
50300255	CONCRETE SUPERSTRUCTURE	CU YD	1,345.1			667.6	677.5	
50300260	BRIDGE DECK GROOVING	SQ YD	2,782			1,302	1,480	
50300280	CONCRETE ENCASEMENT	CU YD	7.6			7.6		
50300300	PROTECTIVE COAT	SQ YD	3,159			1,409	1,750	
50400735	FURNISHING AND ERECTING PRECAST PRESTRESSED CONCRETE BULB T-BEAMS 63"	FOOT	1,501			1,501		
50500105	FURNISHING AND ERECTING STRUCTURAL STEEL	L SUM	1				1	
50500505	STUD SHEAR CONNECTORS	EACH	2,046				2,046	
50800205	REINFORCEMENT BARS, EPOXY COATED	POUND	1,097,007	2,250	658,020	188,580	238,460	4,297

* DENOTES SPECIALTY ITEM

FILE NAME = D:\60F12-SHT-S0082.dgn

USER NAME = TKluegel
 PLOT SCALE = 1:50
 PLOT DATE = 2/4/2011

DESIGNED - MJT
 DRAWN - MJT
 CHECKED - DLT
 DATE - 2/4/11

REVISED -
 REVISED -
 REVISED -
 REVISED -

STATE OF ILLINOIS
 DEPARTMENT OF TRANSPORTATION

SUMMARY OF QUANTITIES

SCALE: NONE SHEET NO. 2 OF 11 SHEETS STA. TO STA.

F.A.I. RTE.	SECTION	COUNTY	TOTAL SHEETS	SHEET NO.
55	99-2HB-2B-1	WILL	756	6
FED. ROAD DIST. NO. 1 ILLINOIS FED. AID PROJECT			CONTRACT NO. 60F12	

Rev. 4-14-11

Rev.

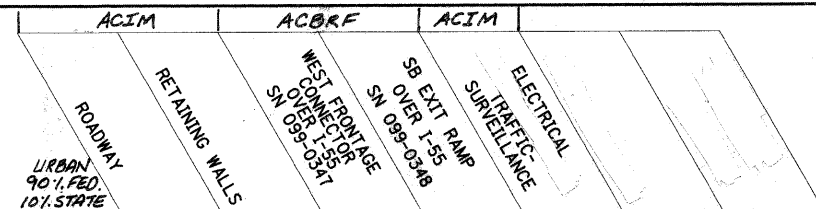

CODE NUMBER	PAY ITEM	UNIT	TOTAL QUANTITY	CONSTRUCTION TYPE CODES				
				0001	0040	0010	0008	0021
X0324045	SEDIMENT CONTROL, STABILIZED CONSTRUCTION ENTRANCE REMOVAL	EACH	6	6				
* X0324234	2070 LITE CONTROLLER	EACH	8					8
* X0324236	BUCK-BOOST TRANSFORMER, 1.5KVA, 240V PRIMARY, 24V SECONDARY	EACH	13					13
* X0324237	CLOSED CIRCUIT TELEVISION DOME CAMERA HIGH MAST TOWER INSTALLATION	EACH	2					2
* X0324245	CONCRETE FOUNDATION, SURVEILLANCE CABINET, MODEL 334	EACH	5					5
* X0324248	DETECTOR RACK	EACH	5					5
* X0324263	REMOVAL OF EXISTING HIGH MAST LIGHT TOWER, SALVAGE	EACH	12					12
X0324775	SEDIMENT CONTROL, STABILIZED CONSTRUCTION ENTRANCE MAINTENANCE	SQ YD	4,555	4,555				
* X0029654	HIGH TENSION CABLE MEDIAN BARRIER TERMINALS	EACH	2	2				
* X0325040	FIBER OPTIC INNERDUCT 1 1/4" DIA.	FOOT	25,235					25,235
* X0029652	HIGH TENSION CABLE MEDIAN BARRIER	FOOT	11,065	11,065				
X0326020	UTILITY PROTECTION PAD	SQ YD	911	911				
* X0029653	HIGH TENSION CABLE MEDIAN BARRIER DEMONSTRATION	EACH	1	1				
* X0326266	ETHERNET SWITCH	EACH	8					8
* X0326323	UNDERPASS LUMINAIRE, 70 WATT, HIGH PRESSURE SODIUM VAPOR, STAINLESS STEEL HOUSING	EACH	8					8
* X0326465	MODIFICATION OF EXISTING VIDEO DISTRIBUTION SYSTEM	L SUM	1					1
* X0326492	REMOVAL OF EXISTING SIGN LIGHTING UNIT AND SALVAGE	EACH	2	2				
X2020502	BRACED EXCAVATION	CU YD	347			224	123	
X2070304	POROUS GRANULAR EMBANKMENT, SPECIAL	CU YD	294			294		
* X2502024	SEEDING, CLASS 4B (MODIFIED)	ACRE	2.6					2.6
X4022000	TEMPORARY ACCESS (COMMERCIAL ENTRANCE)	EACH	4	4				
X4401198	HOT-MIX ASPHALT SURFACE REMOVAL, VARIABLE DEPTH	SQ YD	22,820	22,820				
* X5011100	FOUNDATION REMOVAL	EACH	12					12
X5210110	HIGH LOAD MULTI-ROTATIONAL BEARINGS, GUIDED EXPANSION, 200K	EACH	14				14	
X5210335	HIGH LOAD MULTI-ROTATIONAL BEARINGS, FIXED - 450K	EACH	7				7	
X6020294	MANHOLES, TYPE A, 7'-DIAMETER, TYPE 1 FRAME, CLOSED LID, RESTRICTOR PLATE	EACH	1	1				
X6060200	CONCRETE MEDIAN, TYPE SB-6.24 (MODIFIED)	SQ FT	5,991	5,991				
X6061310	CONCRETE MEDIAN SURFACE, 4 INCH (SPECIAL)	SQ FT	13,109	13,109				
X6640200	TEMPORARY CHAIN LINK FENCE	FOOT	1,925	1,925				
X6700410	ENGINEER'S FIELD OFFICE, TYPE A (SPECIAL)	CAL MO	18	18				
X6700600	ENGINEER'S FIELD LABORATORY (SPECIAL)	CAL MO	18	18				
X7010216	TRAFFIC CONTROL AND PROTECTION, (SPECIAL)	L SUM	1	1				
X7011015	TRAFFIC CONTROL AND PROTECTION (EXPRESSWAYS)	L SUM	1	1				
X7030025	WET REFLECTIVE TEMPORARY TAPE, TYPE III - LETTERS AND SYMBOLS	SQ FT	809	809				
X7030030	WET REFLECTIVE TEMPORARY TAPE TYPE III, 4 INCH	FOOT	138,743	138,743				
X7030035	WET REFLECTIVE TEMPORARY TAPE TYPE III, 5 INCH	FOOT	10,208	10,208				
X7030045	WET REFLECTIVE TEMPORARY TAPE TYPE III, 8 INCH	FOOT	4,678	4,678				
X7030050	WET REFLECTIVE TEMPORARY TAPE TYPE III, 12 INCH	FOOT	1,582	1,582				

* DENOTES SPECIALTY ITEM

Rev. 4-14-11

Rev.

FILE NAME = D:\60F12-SHT-S0009.dgn	USER NAME = TKLuegel	DESIGNED - MJT	REVISED -	STATE OF ILLINOIS DEPARTMENT OF TRANSPORTATION	SUMMARY OF QUANTITIES			F.A.I. RTE. 55	SECTION 99-2HB-2B-1	COUNTY WILL	TOTAL SHEETS 756	SHEET NO. 13
PLOT SCALE = 1/80	CHECKED - DLT	REVISED -	REVISED -		SCALE: NONE	SHEET NO. 9 OF 11 SHEETS	STA. TO STA.	CONTRACT NO. 60F12				
PLOT DATE = 2/4/2011	DATE - 2/4/11	REVISED -	REVISED -		FED. ROAD DIST. NO. 1 ILLINOIS FED. AID PROJECT							

CODE NUMBER	PAY ITEM	UNIT	TOTAL QUANTITY	CONSTRUCTION TYPE CODES						0021	0021
				0001	0040	0010	0008	0021	0021		
X7030055	WET REFLECTIVE TEMPORARY TAPE TYPE III, 24 INCH	FOOT	453	453							
X7040650	REMOVE TEMPORARY CONCRETE BARRIER	FOOT	2,999	2,999							
* X8040310	ELECTRICAL SERVICE DISCONNECT	EACH	5					5			
* 8050020	SERVICE INSTALLATION - POLE MOUNTED	EACH	1							1	
* X8210190	LUMINAIRE, SODIUM VAPOR, HIGH MAST, HORIZONTAL MOUNT, 750 WATT (INSTALL ONLY)	EACH	13						13		
* X8250110	LIGHTING CONTROLLER, RADIO CONTROL, DUPLEX CONSOLE TYPE, WITH SCADA	EACH	2						2		
* X8710035	FIBER OPTIC CABLE 96 FIBERS, SINGLE MODE	FOOT	25,400						25,400		
* X8710052	FIBER OPTIC TERMINATION PANEL, 12 FIBER, FO TERM PANEL 12F	EACH	5						5		
* X8850102	INDUCTION LOOP	FOOT	642						642		
Z0001050	AGGREGATE SUBGRADE 12"	SQ YD	153,943	153,943							
Z0004552	APPROACH SLAB REMOVAL	SQ YD	280.0	280.0							
Z0013796	SEDIMENT CONTROL, STABILIZED CONSTRUCTION ENTRANCE	SQ YD	2,280	2,280							
Z0013798	CONSTRUCTION LAYOUT	L SUM	1	1							
Δ Z0014800	CULVERT TO BE CLEANED	FOOT	114	114							
Z0018002	DRAINAGE SCUPPERS, DS-11	EACH	2					2			
Z0022800	FENCE REMOVAL	FOOT	21,889	21,889							
Z0023202	SEDIMENT CONTROL, DRAINAGE STRUCTURE INLET FILTER CLEANING	EACH	308	308							
Z0023206	SEDIMENT CONTROL, SILT FENCE MAINTENANCE	FOOT	9,155	9,155							
Z0029999	IMPACT ATTENUATOR REMOVAL	EACH	3	3							
Z0030030	IMPACT ATTENUATORS (FULLY REDIRECTIVE, NARROW), TEST LEVEL 3	EACH	3	3							
Z0030150	IMPACT ATTENUATORS (NON-REDIRECTIVE), TEST LEVEL 3	EACH	2	2							
Z0030250	IMPACT ATTENUATORS, TEMPORARY (NON- REDIRECTIVE), TEST LEVEL 3	EACH	6	6							
Z0030280	IMPACT ATTENUATORS, TEMPORARY (SEVERE USE, NARROW), TEST LEVEL 3	EACH	10	10							
Z0030350	IMPACT ATTENUATORS, RELOCATE (NON- REDIRECTIVE), TEST LEVEL 3	EACH	16	16							
Z0030850	TEMPORARY INFORMATION SIGNING	SQ FT	103	103							
* Z0033028	MAINTENANCE OF LIGHTING SYSTEM	CAL MO	18						18		
* Z0033044	RE-OPTIMIZE TRAFFIC SIGNAL SYSTEM LEVEL 1	EACH	1						1		
* Z0033052	COMMUNICATIONS VAULT	EACH	8						8		
* 88600700	PREFORMED DETECTOR LOOP	FOOT	1,056						268	788	
Z0034210	MECHANICALLY STABILIZED EARTH RETAINING WALL	SQ FT	3,764					3,764			
Z0042002	POROUS GRANULAR EMBANKMENT, SUBGRADE	CU YD	5,780	5,780							
Z0046304	PIPE UNDERDRAINS FOR STRUCTURES 4"	FOOT	4,227		4,043	184					
Z0056220	SAND MODULE IMPACT ATTENUATOR TO BE REMOVED	EACH	4	4							
Z0062456	TEMPORARY PAVEMENT	SQ YD	17,847	17,847							
Z0073510	TEMPORARY TRAFFIC SIGNAL TIMING	EACH	1							1	
Z0076600	TRAINEES	HOURLY									

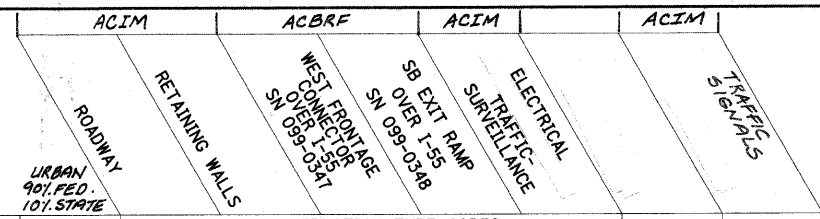

McDonough Associates Inc.
 Engineers / Architects
 130 East Randolph Street, Chicago, Illinois 60601

Δ = Non-participating
 * DENOTES SPECIALTY ITEM

FILE NAME = D:\60\F12-SHT-S0010.dgn	USER NAME = TKIvege1	DESIGNED - MJT	REVISED -
		DRAWN - MJT	REVISED -
PLOT SCALE = 1:50		CHECKED - DLT	REVISED -
PLOT DATE = 2/4/2011		DATE - 2/4/11	REVISED -

STATE OF ILLINOIS
DEPARTMENT OF TRANSPORTATION

SUMMARY OF QUANTITIES			
SCALE: NONE	SHEET NO. 10 OF 11 SHEETS	STA.	TO STA.

F.A.I. RTE. 55	SECTION 99-2HB-28-1	COUNTY WILL	TOTAL SHEETS 756	SHEET NO. 14
CONTRACT NO. 60F12			ILLINOIS FED. AID PROJECT	

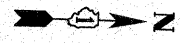

NO.	STATION	OFFSET
①	7000+05.00	11.16' RT

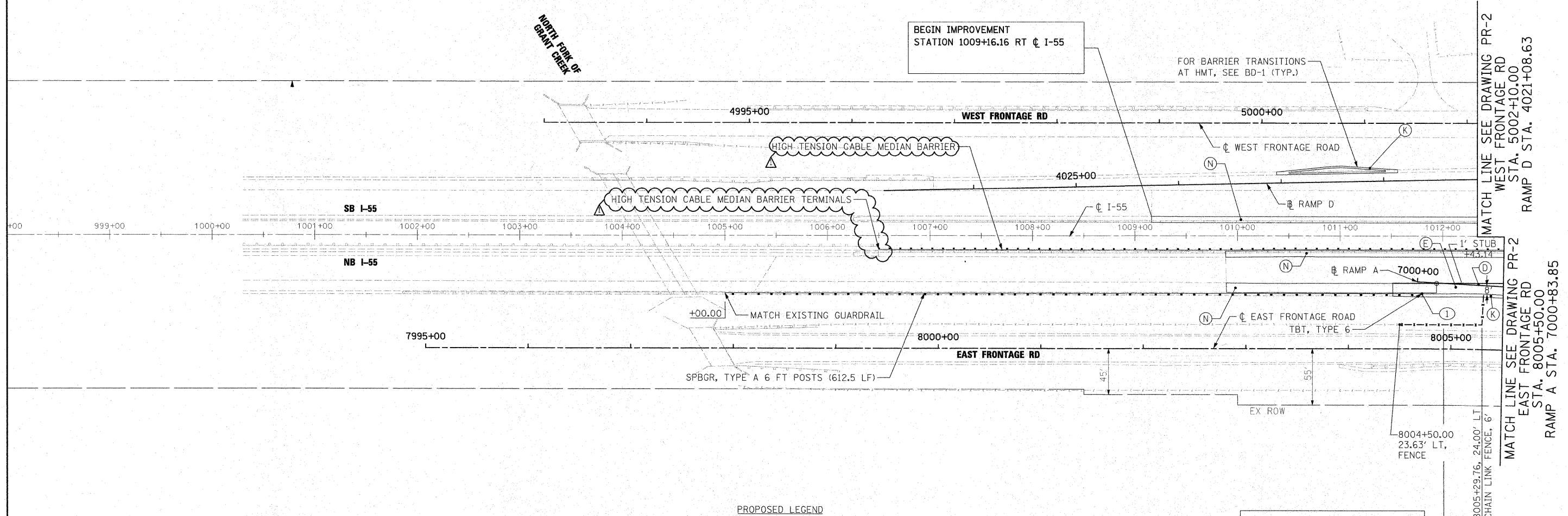

- PROPOSED LEGEND**
- (A) PCC PAVEMENT 10" (JOINTED)
 - (B) PCC SHOULDERS, 10"
 - (C) AGGREGATE SHOULDERS, TYPE B 10"
 - (D) HMA PAVEMENT (SEE TYPICAL SECTIONS)
 - (E) HMA SHOULDERS (SEE TYPICAL SECTIONS)
 - (F) CONCRETE MEDIAN SURFACE, 4 INCH
 - (G) CONCRETE MEDIAN RAMP NOSE (SEE STD 606301-04)
PAID FOR AS CONCRETE MEDIAN, TYPE SB-6.24 (MODIFIED)
 - (H) CONCRETE MEDIAN, TYPE SB 6.24 (MODIFIED)
 - (I) COMBINATION CONCRETE CURB & GUTTER TYPE B-6.24
 - (J) COMBINATION CONCRETE CURB & GUTTER TYPE M-2.24
 - (K) CONCRETE BARRIER, DOUBLE FACE, 42" HEIGHT
 - (L) IMPACT ATTENUATOR FULLY REDIRECTIVE NARROW TEST LEVEL 3
 - (M) CORRUGATED MEDIAN
 - (N) HMA SHOULDER CROSS SLOPE CORRECTION
 - (O) STATION OFFSET
 - FENCE AS INDICATED IN PLANS

NOTE:
 1. FOR CURVE DATA SEE ALIGNMENTS, TIES AND BENCHMARKS DRAWING NOS. AT-1 TO AT-9
 2. FOR ROW CALL-OUTS SEE PLAT OF HIGHWAY SHEETS

STA 1012+00.78, 45.91' RT ϕ I-55 =
 STA 7000+25.37 ϕ RAMP A

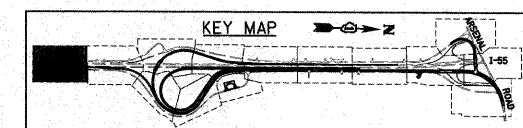

McDonough Associates Inc.
 Engineers / Architects
 130 East Randolph Street Chicago, Illinois 60601

FILE NAME = D160F12-SHT-PLAN01.dgn	USER NAME = TKluegel	DESIGNED - JTF	REVISED - Δ REV. 4/14/11
		DRAWN - JTF	REVISED -
		CHECKED - DLT	REVISED -
		DATE - 2/4/11	REVISED -

**STATE OF ILLINOIS
 DEPARTMENT OF TRANSPORTATION**

PROPOSED PLAN

SCALE: 1"=50' SHEET NO. 1 OF 15 SHEETS STA. TO STA.

F.A.I. RTE.	SECTION	COUNTY	TOTAL SHEETS	SHEET NO.
55	99-2HB-2B-1	WILL	756	59

CONTRACT NO. 60F12
 FED. ROAD DIST. NO. 1 ILLINOIS FED. AID PROJECT

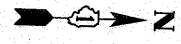

NO.	STATION	OFFSET
①	7006+87.23	16.00' LT
②	7006+86.35	36.20' LT
③	7010+60.00	22.00' RT
④	7010+70.00	8.00' RT
⑤	7010+80.00	6.00' RT

NOTE:
 1. FOR CURVE DATA SEE ALIGNMENTS, TIES AND BENCHMARKS DRAWING NOS. AT-1 TO AT-9
 2. FOR ROW CALL-OUTS SEE PLAT OF HIGHWAY SHEETS

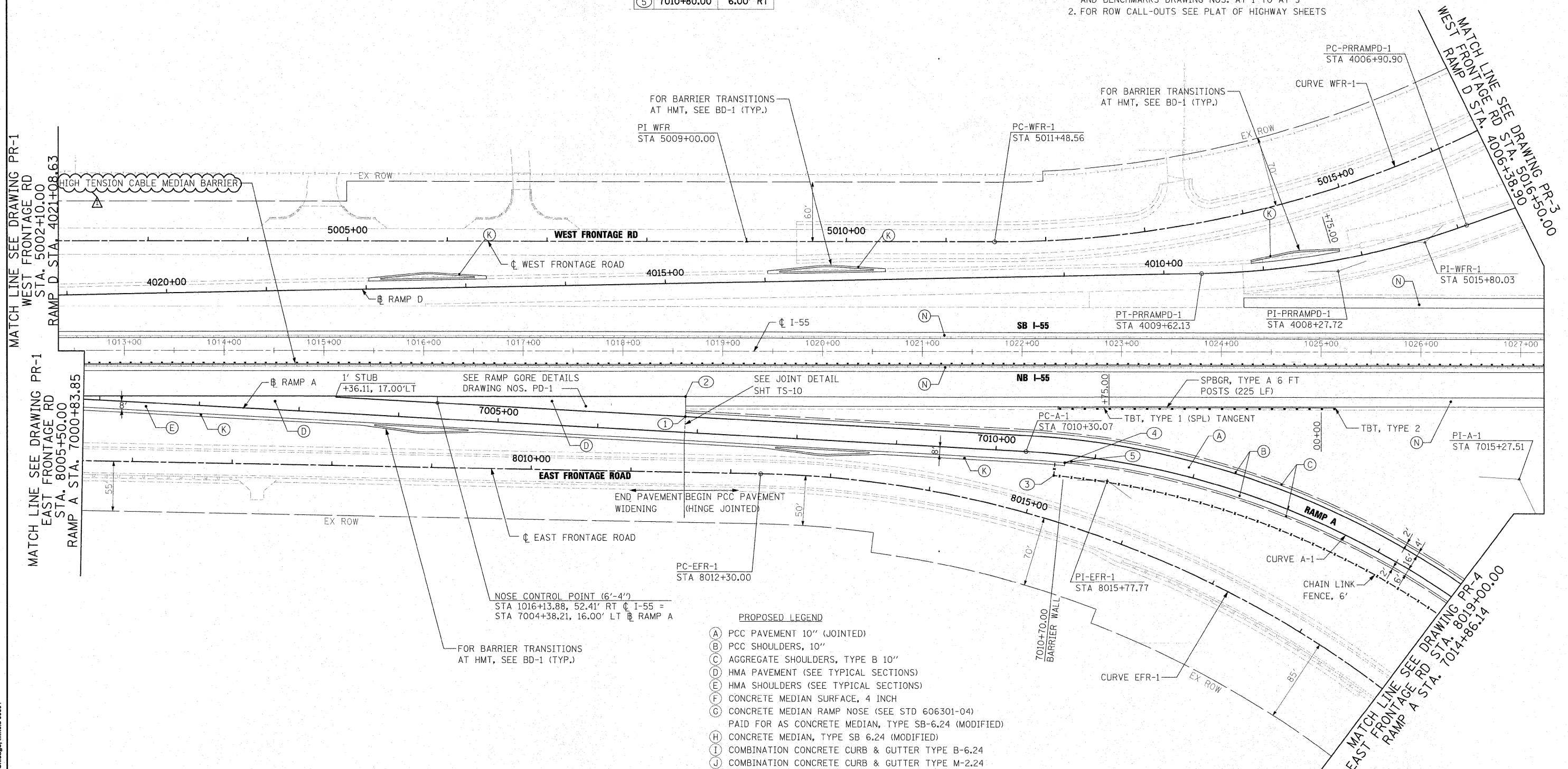

- PROPOSED LEGEND**
- (A) PCC PAVEMENT 10" (JOINTED)
 - (B) PCC SHOULDERS, 10"
 - (C) AGGREGATE SHOULDERS, TYPE B 10"
 - (D) HMA PAVEMENT (SEE TYPICAL SECTIONS)
 - (E) HMA SHOULDERS (SEE TYPICAL SECTIONS)
 - (F) CONCRETE MEDIAN SURFACE, 4 INCH
 - (G) CONCRETE MEDIAN RAMP NOSE (SEE STD 606301-04)
 - (H) PAID FOR AS CONCRETE MEDIAN, TYPE SB-6.24 (MODIFIED)
 - (I) CONCRETE MEDIAN, TYPE SB 6.24 (MODIFIED)
 - (J) COMBINATION CONCRETE CURB & GUTTER TYPE B-6.24
 - (K) COMBINATION CONCRETE CURB & GUTTER TYPE M-2.24
 - (L) CONCRETE BARRIER, DOUBLE FACE, 42" HEIGHT
 - (M) IMPACT ATTENUATOR FULLY REDIRECTIVE NARROW TEST LEVEL 3
 - (N) CORRUGATED MEDIAN
 - (O) HMA SHOULDER CROSS SLOPE CORRECTION
 - (P) STATION OFFSET
 - FENCE AS INDICATED IN PLANS

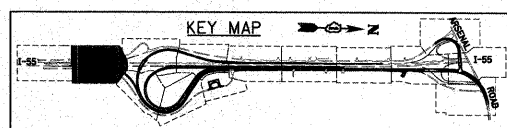

McDonough Associates Inc.
 Engineers / Architects
 130 East Randolph Street Chicago, Illinois 60601

FILE NAME = D160F12-SHT-PLAN02.dgn	USER NAME = TKLuegel	DESIGNED - JTF	REVISED - REV. 4/14/11
PLOT SCALE = 1:50	CHECKED - DLT	DRAWN - JTF	REVISED -
PLOT DATE = 4/14/2011	DATE - 2/4/11	CHECKED - DLT	REVISED -

**STATE OF ILLINOIS
DEPARTMENT OF TRANSPORTATION**

PROPOSED PLAN
 SCALE: 1"=50' SHEET NO. 2 OF 15 SHEETS STA. TO STA.

F.A.I. RTE.	SECTION	COUNTY	TOTAL SHEETS	SHEET NO.
55	99-2HB-2B-1	WILL	756	60
				CONTRACT NO. 60F12

NO.	STATION	OFFSET
1	3034+28.39	21.04' LT
2	3034+32.60	44.64' LT
3	2028+19.08	14.00' RT
4	2028+43.68	14.00' RT
5	2028+42.51	17.54' RT
6	2031+04.40	14.00' LT
7	2031+15.79	14.00' RT
8	2031+24.72	18.00' RT
9	4001+96.63	57.71' LT
10	4001+96.27	73.79' LT
11	4002+02.94	80.78' LT
12	4003+87.35	84.94' LT

NOTE:
 1. FOR CURVE DATA SEE ALIGNMENTS, TIES AND BENCHMARKS DRAWING NOS. AT-1 TO AT-9
 2. FOR ROW CALL-OUTS SEE PLAT OF HIGHWAY SHEETS

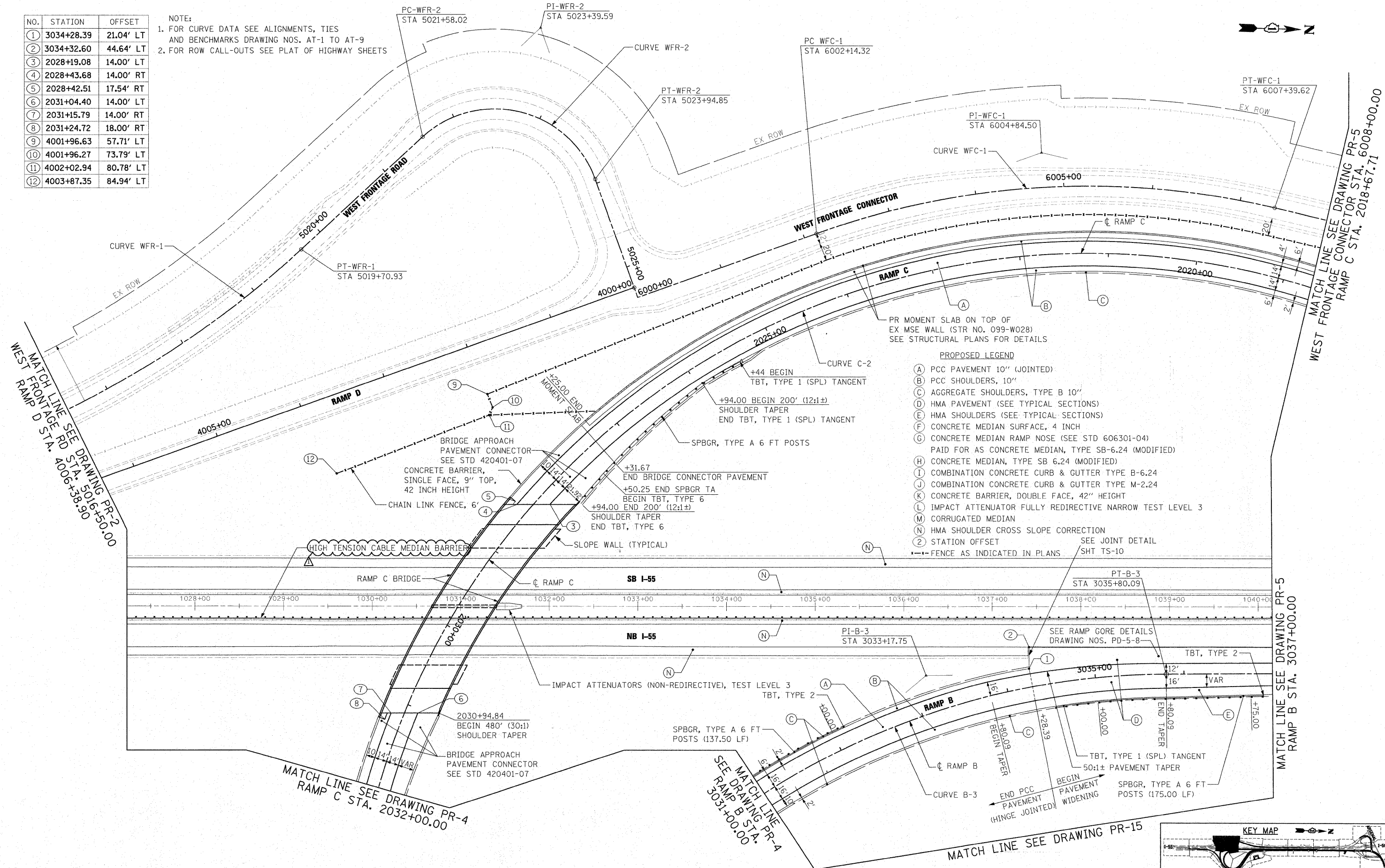

- PROPOSED LEGEND**
- (A) PCC PAVEMENT 10" (JOINTED)
 - (B) PCC SHOULDERS, 10"
 - (C) AGGREGATE SHOULDERS, TYPE B 10"
 - (D) HMA PAVEMENT (SEE TYPICAL SECTIONS)
 - (E) HMA SHOULDERS (SEE TYPICAL SECTIONS)
 - (F) CONCRETE MEDIAN SURFACE, 4 INCH
 - (G) CONCRETE MEDIAN RAMP NOSE (SEE STD 606301-04)
 - (H) PAID FOR AS CONCRETE MEDIAN, TYPE SB-6.24 (MODIFIED)
 - (I) CONCRETE MEDIAN, TYPE SB 6.24 (MODIFIED)
 - (J) COMBINATION CONCRETE CURB & GUTTER TYPE B-6.24
 - (K) COMBINATION CONCRETE CURB & GUTTER TYPE M-2.24
 - (L) CONCRETE BARRIER, DOUBLE FACE, 42" HEIGHT
 - (M) IMPACT ATTENUATOR FULLY REDIRECTIVE NARROW TEST LEVEL 3
 - (N) CORRUGATED MEDIAN
 - (O) HMA SHOULDER CROSS SLOPE CORRECTION
 - (P) STATION OFFSET
 - (Q) FENCE AS INDICATED IN PLANS

McDonough Associates Inc.
 Engineers / Architects
 130 East Randolph Street, Chicago, Illinois 60601

FILE NAME = D:\160F12-SHT-PLAN\03.dgn	USER NAME = TK(uegel)	DESIGNED - JTF	REVISED - Δ REV. 4/14/11
PLOT SCALE = 1:50	DATE = 2/4/11	DRAWN - JTF	REVISED -
PLOT DATE = 4/14/2011		CHECKED - DLT	REVISED -
		DATE - 2/4/11	REVISED -

**STATE OF ILLINOIS
DEPARTMENT OF TRANSPORTATION**

PROPOSED PLAN

SCALE: 1"=50' SHEET NO. 3 OF 15 SHEETS STA. TO STA.

F.A.I. RTE.	SECTION	COUNTY	TOTAL SHEETS	SHEET NO.
55	99-2HB-2B-1	WILL	756	61

CONTRACT NO. 60F12

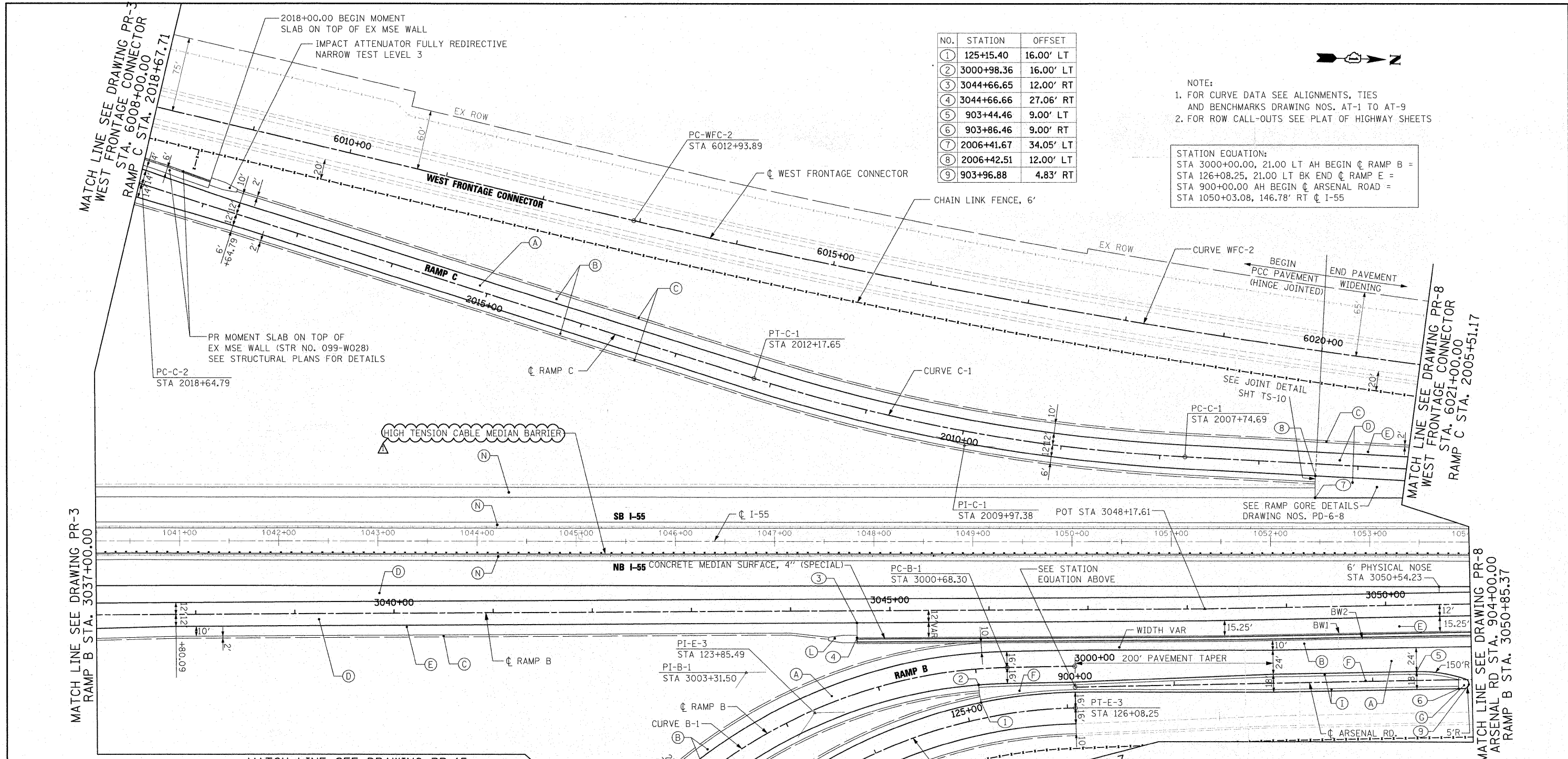

NO.	STATION	OFFSET
1	125+15.40	16.00' LT
2	3000+98.36	16.00' LT
3	3044+66.65	12.00' RT
4	3044+66.66	27.06' RT
5	903+44.46	9.00' LT
6	903+86.46	9.00' RT
7	2006+41.67	34.05' LT
8	2006+42.51	12.00' LT
9	903+96.88	4.83' RT

NOTE:
 1. FOR CURVE DATA SEE ALIGNMENTS, TIES AND BENCHMARKS DRAWING NOS. AT-1 TO AT-9
 2. FOR ROW CALL-OUTS SEE PLAT OF HIGHWAY SHEETS

STATION EQUATION:
 STA 3000+00.00, 21.00 LT AH BEGIN @ RAMP B =
 STA 126+08.25, 21.00 LT BK END @ RAMP E =
 STA 900+00.00 AH BEGIN @ ARSENAL ROAD =
 STA 1050+03.08, 146.78' RT @ I-55

- PROPOSED LEGEND
- (A) PCC PAVEMENT 10" (JOINTED)
 - (B) PCC SHOULDERS, 10"
 - (C) AGGREGATE SHOULDERS, TYPE B 10"
 - (D) HMA PAVEMENT (SEE TYPICAL SECTIONS)
 - (E) HMA SHOULDERS (SEE TYPICAL SECTIONS)
 - (F) CONCRETE MEDIAN SURFACE, 4 INCH
 - (G) CONCRETE MEDIAN RAMP NOSE (SEE STD 606301-04)
 - (H) PAID FOR AS CONCRETE MEDIAN, TYPE SB-6.24 (MODIFIED)
 - (I) CONCRETE MEDIAN, TYPE SB 6.24 (MODIFIED)
 - (L) COMBINATION CONCRETE CURB & GUTTER TYPE B-6.24
 - (M) COMBINATION CONCRETE CURB & GUTTER TYPE M-2.24
 - (K) CONCRETE BARRIER, DOUBLE FACE, 42" HEIGHT
 - (L) IMPACT ATTENUATOR FULLY REDIRECTIVE NARROW TEST LEVEL 3
 - (M) CORRUGATED MEDIAN
 - (N) HMA SHOULDER CROSS SLOPE CORRECTION
 - (2) STATION OFFSET

BW1 = CONCRETE BARRIER, SINGLE FACE, 6" TOP, 42" HEIGHT
 BW2 = CONCRETE BARRIER, SINGLE FACE, 9" TOP, 42" HEIGHT

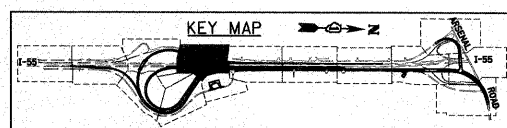

FILE NAME: D162F12-SHT-PLAN05.dgn	DESIGNED - JTF	REVISED - REV. 4/14/11	STATE OF ILLINOIS DEPARTMENT OF TRANSPORTATION	PROPOSED PLAN	F.A.I. RTE. 55	SECTION 99-2HB-2B-1	COUNTY WILL	TOTAL SHEETS 756	SHEET NO. 63
PLOT SCALE = 1:50	DRAWN - JTF	REVISED -			SCALE: 1"=50'	SHEET NO. 5 OF 15 SHEETS	CONTRACT NO. 60F12		
PLOT DATE = 4/14/2011	CHECKED - DLT	REVISED -			STA. TO STA.	FED. ROAD DIST. NO. 1 ILLINOIS FED. AID PROJECT			

- PROPOSED LEGEND
- (A) PCC PAVEMENT 10" (JOINTED)
 - (B) PCC SHOULDERS, 10"
 - (C) AGGREGATE SHOULDERS, TYPE B 10"
 - (D) HMA PAVEMENT (SEE TYPICAL SECTIONS)
 - (E) HMA SHOULDERS (SEE TYPICAL SECTIONS)
 - (F) CONCRETE MEDIAN SURFACE, 4 INCH
 - (G) CONCRETE MEDIAN RAMP NOSE (SEE STD 606301-04)
PAID FOR AS CONCRETE MEDIAN, TYPE SB-6.24 (MODIFIED)
 - (H) CONCRETE MEDIAN, TYPE SB 6.24 (MODIFIED)
 - (I) COMBINATION CONCRETE CURB & GUTTER TYPE B-6.24
 - (J) COMBINATION CONCRETE CURB & GUTTER TYPE M-2.24
 - (K) CONCRETE BARRIER, DOUBLE FACE, 42" HEIGHT
 - (L) IMPACT ATTENUATOR FULLY REDIRECTIVE NARROW TEST LEVEL 3
 - (M) CORRUGATED MEDIAN
 - (N) HMA SHOULDER CROSS SLOPE CORRECTION
 - (O) STATION OFFSET
 - FENCE AS INDICATED IN PLANS

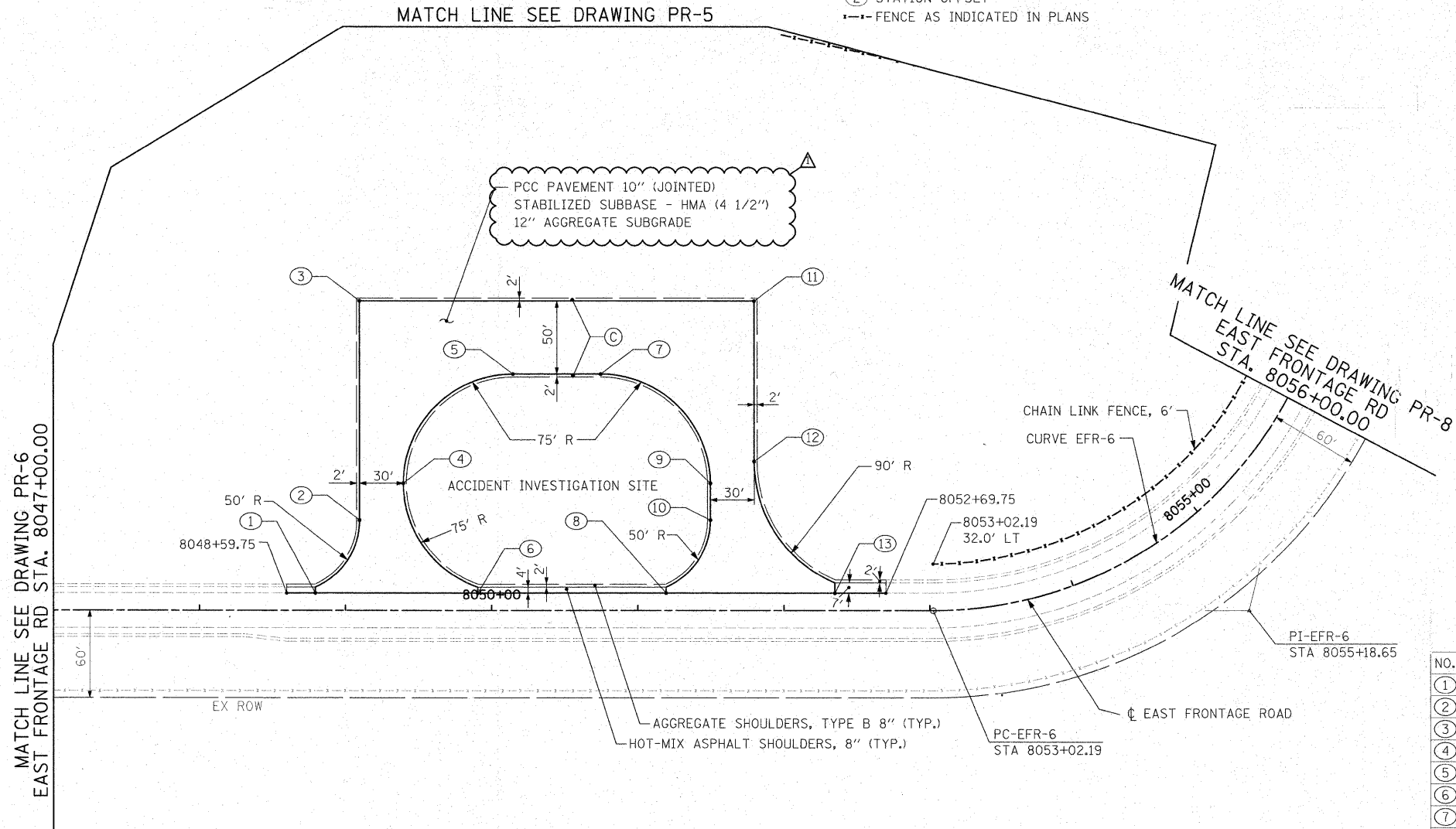

NO.	STATION	OFFSET
①	8048+79.35	12.00' LT
②	8049+09.75	62.00' LT
③	8049+09.75	212.00' LT
④	8049+39.75	87.00' LT
⑤	8050+14.75	162.00' LT
⑥	8049+90.59	12.00' LT
⑦	8050+74.75	162.00' LT
⑧	8051+19.35	12.00' LT
⑨	8051+49.75	87.00' LT
⑩	8051+49.75	62.00' LT
⑪	8051+79.75	212.00' LT
⑫	8051+79.75	102.00' LT
⑬	8052+34.96	12.00' LT

- NOTE:
- FOR CURVE DATA SEE ALIGNMENTS, TIES AND BENCHMARKS DRAWING NOS. AT-1 TO AT-9
 - FOR ROW CALL-OUTS SEE PLAT OF HIGHWAY SHEETS

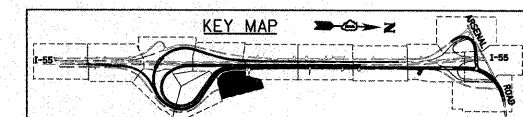

FILE NAME = D160F12-SHT-PLAN07.dgn	USER NAME = TK1uegel	DESIGNED - JTF	REVISED - REV. 4/14/11
PLOT SCALE = 1:50	CHECKED - DLT	DRAWN - JTF	REVISED -
PLOT DATE = 4/14/2011	DATE - 2/4/11		REVISED -

STATE OF ILLINOIS
DEPARTMENT OF TRANSPORTATION

PROPOSED PLAN

SCALE: 1"=50' SHEET NO. 7 OF 15 SHEETS STA. TO STA.

F.A.I. RTE.	SECTION	COUNTY	TOTAL SHEETS	SHEET NO.
55	99-2HB-2B-1	WILL	756	65
FED. ROAD DIST. NO. 1 ILLINOIS FED. AID PROJECT			CONTRACT NO. 60F12	

NO.	STATION	OFFSET
①	905+59.95	3.00' RT
②	908+94.88	3.00' LT
③	908+95.02	9.00' RT
④	913+39.48	9.00' LT
⑤	916+39.39	6.00' RT
⑥	916+71.00	6.00' LT
⑦	3052+70.99	14.00' LT
⑧	2002+20.96	12.00' LT
⑨	6028+39.02	32.00' RT

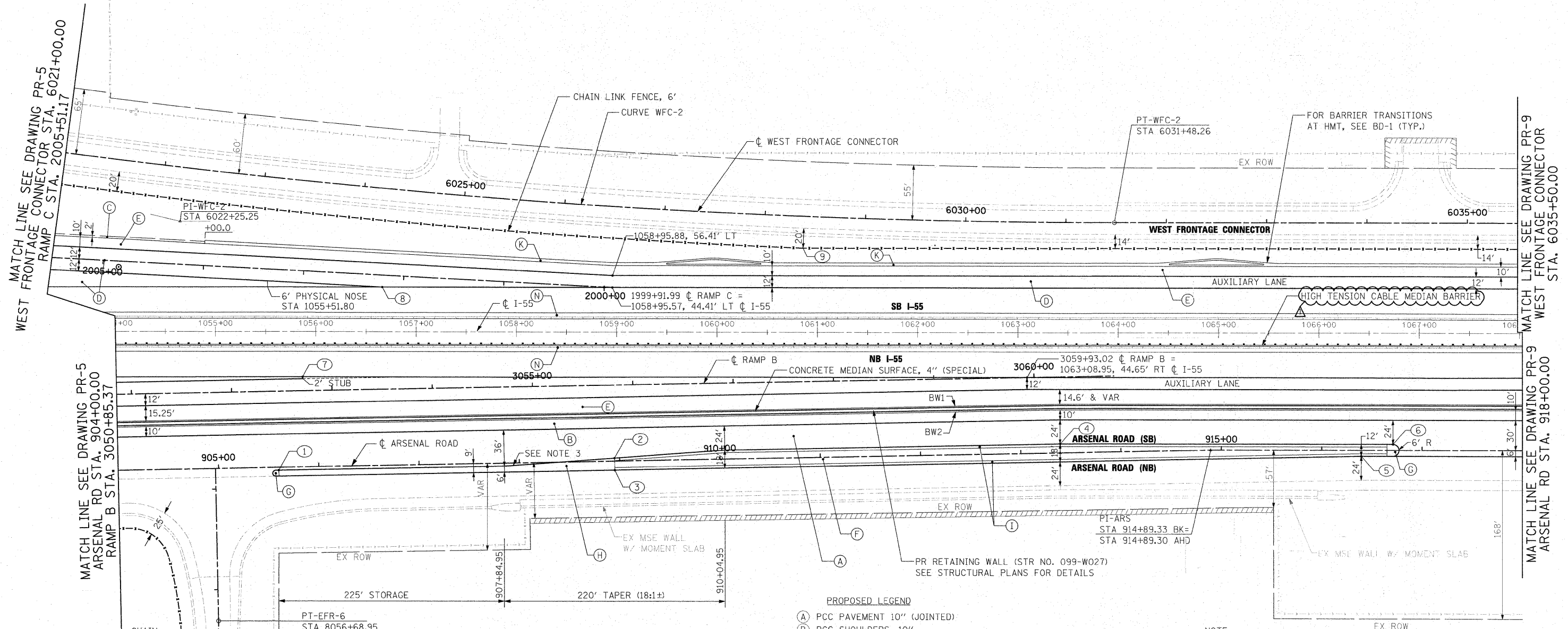

- PROPOSED LEGEND**
- (A) PCC PAVEMENT 10" (JOINTED)
 - (B) PCC SHOULDERS, 10"
 - (C) AGGREGATE SHOULDERS, TYPE B 10"
 - (D) HMA PAVEMENT (SEE TYPICAL SECTIONS)
 - (E) HMA SHOULDERS (SEE TYPICAL SECTIONS)
 - (F) CONCRETE MEDIAN SURFACE, 4 INCH
 - (G) CONCRETE MEDIAN RAMP NOSE (SEE STD 606301-04)
PAID FOR AS CONCRETE MEDIAN, TYPE SB-6.24 (MODIFIED)
 - (H) CONCRETE MEDIAN, TYPE SB 6.24 (MODIFIED)
 - (I) COMBINATION CONCRETE CURB & GUTTER TYPE B-6.24
 - (J) COMBINATION CONCRETE CURB & GUTTER TYPE M-2.24
 - (K) CONCRETE BARRIER, DOUBLE FACE, 42" HEIGHT
 - (L) IMPACT ATTENUATOR FULLY REDIRECTIVE NARROW TEST LEVEL 3
 - (M) CORRUGATED MEDIAN
 - (N) HMA SHOULDER CROSS SLOPE CORRECTION
 - (2) STATION OFFSET
 - FENCE AS INDICATED IN PLANS

NOTE:

- FOR CURVE DATA SEE ALIGNMENTS, TIES AND BENCHMARKS DRAWING NOS. AT-1 TO AT-9
- FOR ROW CALL-OUTS SEE PLAT OF HIGHWAY SHEETS
- 18' CURB & GUTTER TRANSITION FROM TYPE B-6.12 TO TYPE B-6.24

BW1 = CONCRETE BARRIER, SINGLE FACE, 6" TOP, 42" HEIGHT
 BW2 = CONCRETE BARRIER, SINGLE FACE, 9" TOP, 42" HEIGHT

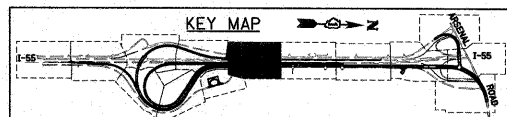

MATCH LINE SEE DRAWING PR-7
 EAST FRONTAGE RD STA. 8056+00.00

MATCH LINE SEE DRAWING PR-5
 WEST FRONTAGE CONNECTOR STA. 6021+00.00
 RAMP C STA. 2005+51.17

MATCH LINE SEE DRAWING PR-9
 WEST FRONTAGE CONNECTOR STA. 6035+50.00
 WEST FRONTAGE CONNECTOR STA. 6035+50.00
 ARSENAL RD STA. 918+00.00

McDonough Associates Inc.
 Engineers / Architects
 130 East Randolph Street Chicago, Illinois 60601

FILE NAME = D160F12-SHT-PLAN08.dgn	USER NAME = TKLuegel	DESIGNED - JTF	REVISED - REV. 4/14/11
PLOT SCALE = 1:500	CHECKED - DLT	DRAWN - JTF	REVISED -
PLOT DATE = 4/14/2011	DATE - 2/4/11	REVISIONS -	REVISED -

**STATE OF ILLINOIS
 DEPARTMENT OF TRANSPORTATION**

PROPOSED PLAN	
SCALE: 1"=50'	SHEET NO. 8 OF 15 SHEETS STA. TO STA.

F.A.I. RTE.	SECTION	COUNTY	TOTAL SHEETS	SHEET NO.
55	99-2HB-2B-1	WILL	756	66
CONTRACT NO. 60F12			FED. ROAD DIST. NO. 1 ILLINOIS FED. AID PROJECT	

NO.	STATION	OFFSET
①	920+78.20	31.00' RT
②	920+95.97	71.33' RT
③	920+95.07	83.00' RT
④	921+14.98	83.00' RT
⑤	921+16.74	70.00' RT
⑥	921+34.62	31.00' RT

NO.	STATION	OFFSET
⑦	929+29.04	31.00' RT
⑧	929+45.92	68.00' RT
⑨	929+45.92	88.00' RT
⑩	929+95.922	88.00' RT
⑪	929+95.92	68.00' RT
⑫	930+12.79	31.00' RT

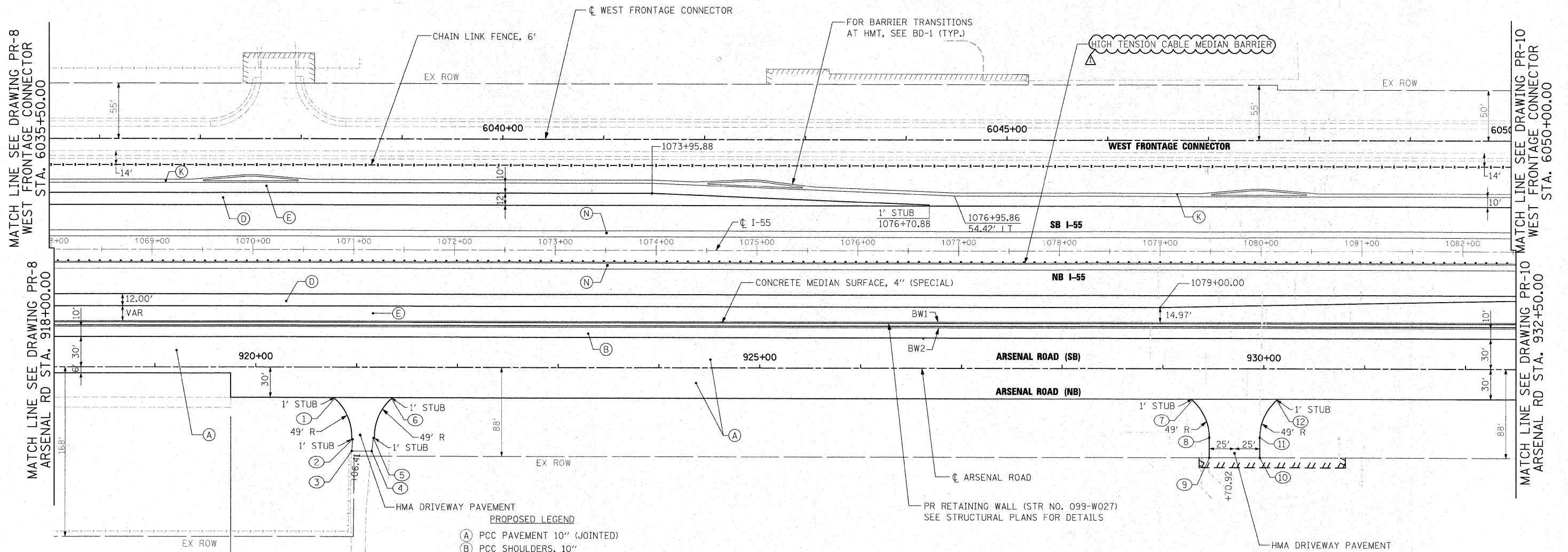
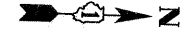

- PROPOSED LEGEND**
- (A) PCC PAVEMENT 10" (JOINTED)
 - (B) PCC SHOULDERS, 10"
 - (C) AGGREGATE SHOULDERS, TYPE B 10"
 - (D) HMA PAVEMENT (SEE TYPICAL SECTIONS)
 - (E) HMA SHOULDERS (SEE TYPICAL SECTIONS)
 - (F) CONCRETE MEDIAN SURFACE, 4 INCH
 - (G) CONCRETE MEDIAN RAMP NOSE (SEE STD 606301-04)
PAID FOR AS CONCRETE MEDIAN, TYPE SB-6.24 (MODIFIED)
 - (H) CONCRETE MEDIAN, TYPE SB 6.24 (MODIFIED)
 - (I) COMBINATION CONCRETE CURB & GUTTER TYPE B-6.24
 - (J) COMBINATION CONCRETE CURB & GUTTER TYPE M-2.24
 - (K) CONCRETE BARRIER, DOUBLE FACE, 42" HEIGHT
 - (L) IMPACT ATTENUATOR FULLY REDIRECTIVE NARROW TEST LEVEL 3
 - (M) CORRUGATED MEDIAN
 - (N) HMA SHOULDER CROSS SLOPE CORRECTION
 - ② STATION OFFSET
 - FENCE AS INDICATED IN PLANS

NOTE:
 1. FOR CURVE DATA SEE ALIGNMENTS, TIES AND BENCHMARKS DRAWING NOS. AT-1 TO AT-9
 2. FOR ROW CALL-OUTS SEE PLAT OF HIGHWAY SHEETS

BW1 = CONCRETE BARRIER, SINGLE FACE, 6" TOP, 42" HEIGHT
 BW2 = CONCRETE BARRIER, SINGLE FACE, 9" TOP, 42" HEIGHT

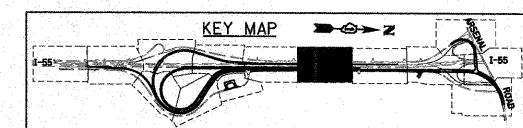

McDonough Associates Inc.
 Engineers / Architects
 130 East Randolph Street Chicago, Illinois 60601

FILE NAME = DI60F12-SHT-PLAN89.dgn	USER NAME = TKLuegel	DESIGNED - JTF	REVISED - Δ REV. 4/14/11
PLOT SCALE = 1:50	DRAWN - JTF	CHECKED - DLT	REVISED -
PLOT DATE = 4/14/2011	DATE - 2/4/11		

**STATE OF ILLINOIS
DEPARTMENT OF TRANSPORTATION**

PROPOSED PLAN
 SCALE: 1"=50' SHEET NO. 9 OF 15 SHEETS STA. TO STA.

F.A.I. RTE.	SECTION	COUNTY	TOTAL SHEETS	SHEET NO.
55	99-2HB-2B-1	WILL	756	67
CONTRACT NO. 60F12				

NO.	STATION	OFFSET
①	933+80.01	31.00' RT
②	933+96.88	68.00' RT
③	933+96.88	88.00' RT
④	934+46.88	88.00' RT
⑤	934+46.88	68.00' RT
⑥	934+63.76	31.00' RT
⑦	945+50.00	30.00' RT
⑧	1084+50.00	44.36' RT
⑨	1094+27.54	43.69' RT

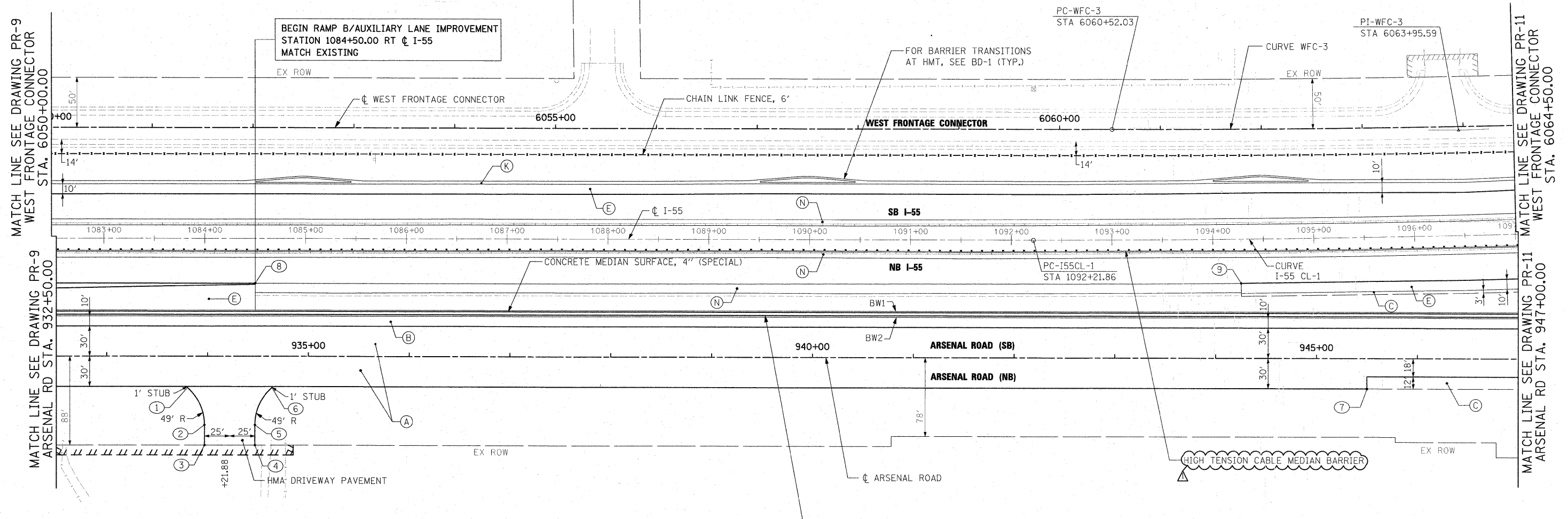
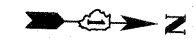

- PROPOSED LEGEND**
- (A) PCC PAVEMENT 10" (JOINTED)
 - (B) PCC SHOULDERS, 10"
 - (C) AGGREGATE SHOULDERS, TYPE B 10"
 - (D) HMA PAVEMENT (SEE TYPICAL SECTIONS)
 - (E) HMA SHOULDERS (SEE TYPICAL SECTIONS)
 - (F) CONCRETE MEDIAN SURFACE, 4 INCH
 - (G) CONCRETE MEDIAN RAMP NOSE (SEE STD 606301-04)
PAID FOR AS CONCRETE MEDIAN, TYPE SB-6.24 (MODIFIED)
 - (H) CONCRETE MEDIAN, TYPE SB 6.24 (MODIFIED)
 - (I) COMBINATION CONCRETE CURB & GUTTER TYPE B-6.24
 - (J) COMBINATION CONCRETE CURB & GUTTER TYPE M-2.24
 - (K) CONCRETE BARRIER, DOUBLE FACE, 42" HEIGHT
 - (L) IMPACT ATTENUATOR FULLY REDIRECTIVE NARROW TEST LEVEL 3
 - (M) CORRUGATED MEDIAN
 - (N) HMA SHOULDER CROSS SLOPE CORRECTION
 - (O) STATION OFFSET
 - - - FENCE AS INDICATED IN PLANS

NOTE:
 1. FOR CURVE DATA SEE ALIGNMENTS, TIES AND BENCHMARKS DRAWING NOS. AT-1 TO AT-7
 2. FOR ROW CALL-OUTS SEE PLAT OF HIGHWAY SHEETS

BW1 = CONCRETE BARRIER, SINGLE FACE, 6" TOP, 42" HEIGHT
 BW2 = CONCRETE BARRIER, SINGLE FACE, 9" TOP, 42" HEIGHT

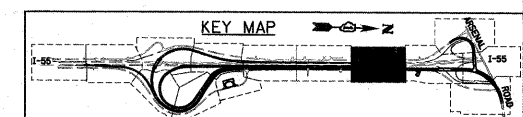

McDonough Associates Inc.
 Engineers / Architects
 130 East Randolph Street Chicago, Illinois 60601

FILE NAME = 0160F12-SHT-PLAN10.dgn	USER NAME = TKIuegal	DESIGNED - JTF	REVISED - REV. 4/14/11
PLOT SCALE = 1/50	CHECKED - DLT	DRAWN - JTF	REVISED -
PLOT DATE = 4/14/2011	DATE - 2/4/11	CHECKED -	REVISED -

**STATE OF ILLINOIS
DEPARTMENT OF TRANSPORTATION**

PROPOSED PLAN	
SCALE: 1"=50'	SHEET NO. 10 OF 15 SHEETS STA. TO STA.

F.A.I. RTE.	SECTION	COUNTY	TOTAL SHEETS	SHEET NO.
55	99-2HB-2B-1	WILL	756	68
CONTRACT NO. 60F12				

NO.	STATION	OFFSET	NO.	STATION	OFFSET
1	964+58.57	9.00' LT	11	6089+94.65	22.29' LT
2	965+63.96	9.00' LT	12	6089+94.65	22.00' RT
3	965+61.57	0.39' RT	13	6090+54.65	22.00' RT
4	965+95.37	9.00' RT	14	6090+54.65	22.00' LT
5	964+33.14	33.00' LT	15	1112+30.00	44.58' RT
6	965+43.51	77.34' LT	16	1121+26.00	43.94' RT
7	965+99.68	45.00' LT	17	1119+19.67	98.00' RT
8	970+00.01	45.00' LT	18	1119+18.02	151.85' RT
9	6090+39.50	22.00' RT	19	1117+40.00	44.25' LT
10	6089+77.61	22.00' LT	20	1116+75.59	98.20' LT
			21	965+69.94	9.00' LT

- PROPOSED LEGEND**
- (A) PCC PAVEMENT 10" (JOINTED)
 - (B) PCC SHOULDERS, 10"
 - (C) AGGREGATE SHOULDERS, TYPE B 10"
 - (D) HMA PAVEMENT (SEE TYPICAL SECTIONS)
 - (E) HMA SHOULDERS (SEE TYPICAL SECTIONS)
 - (F) CONCRETE MEDIAN SURFACE, 4 INCH
 - (G) CONCRETE MEDIAN RAMP NOSE (SEE STD 606301-04)
 - (H) PAID FOR AS CONCRETE MEDIAN, TYPE SB-6.24 (MODIFIED)
 - (I) CONCRETE MEDIAN, TYPE SB 6.24 (MODIFIED)
 - (J) COMBINATION CONCRETE CURB & GUTTER TYPE B-6.24
 - (K) COMBINATION CONCRETE CURB & GUTTER TYPE M-2.24
 - (L) CONCRETE BARRIER, DOUBLE FACE, 42" HEIGHT
 - (M) IMPACT ATTENUATOR FULLY REDIRECTIVE NARROW TEST LEVEL 3
 - (N) CORRUGATED MEDIAN
 - (O) HMA SHOULDER CROSS SLOPE CORRECTION
 - (P) STATION OFFSET
- FENCE AS INDICATED IN PLANS

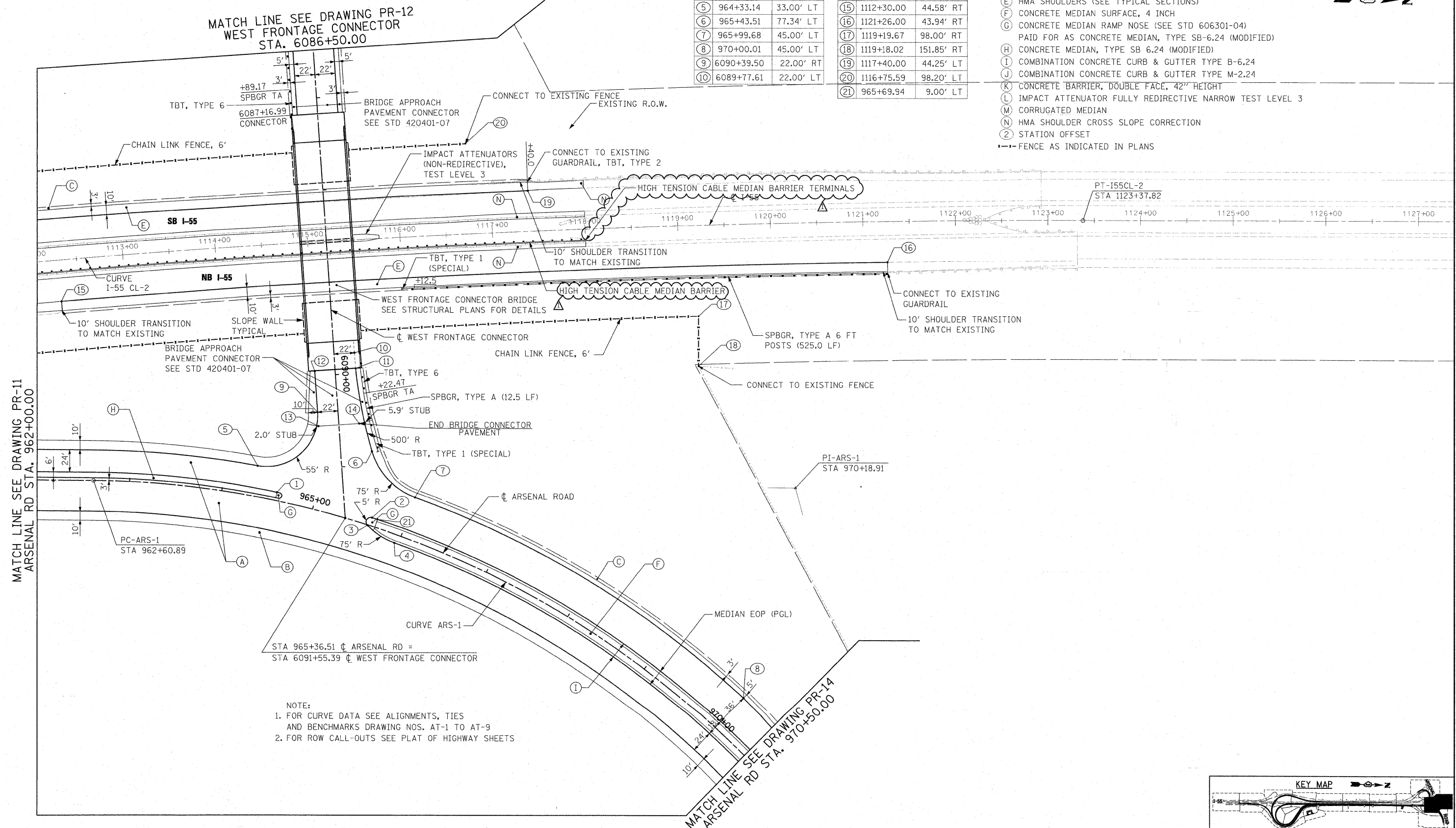

McDonough Associates Inc.
 Engineers / Architects
 130 East Randolph Street, Chicago, Illinois 60601

FILE NAME = D16@F12-SHT-PLAN13.dgn	USER NAME = TKJuegel	DESIGNED - JTF	REVISED - Δ REV. 4/14/11
PLOT SCALE = 1:50	CHECKED - DLT	DRAWN - JTF	REVISED -
PLOT DATE = 4/14/2011	DATE - 2/4/11	CHECKED - DLT	REVISED -

STATE OF ILLINOIS
DEPARTMENT OF TRANSPORTATION

PROPOSED PLAN
 SCALE: 1"=50' SHEET NO. 13 OF 15 SHEETS STA. TO STA.

F.A.I. RTE.	SECTION	COUNTY	TOTAL SHEETS	SHEET NO.
55	99-2HB-2B-1	WILL	756	71

CONTRACT NO. 60F12

FED. ROAD DIST. NO. 1 ILLINOIS FED. AID PROJECT

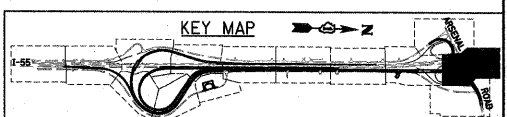

STATE OF ILLINOIS
DEPARTMENT OF TRANSPORTATION

GENERAL NOTES

- Fasteners shall be AASHTO M164 Type 1, mechanically galvanized bolts. Bolts $\frac{7}{8}$ in. dia., holes $\frac{15}{16}$ in. dia., unless otherwise noted.
- Calculated weight of Structural Steel:
AASHTO M270 Gr50 **481,680 lbs** Δ
- No field welding is permitted except as specified in the contract documents.
- Reinforcement bars shall conform to the requirements of ASTM A 706 Gr 60. See Special Provisions.
- Reinforcement bars designated "E" shall be epoxy coated.
- If the Contractor elects to use cantilever forming brackets on the exterior beams or girders, the brackets shall be placed at the same locations as required for the hardwood blocks in Article 503.06(b) of the Standard Specifications. If additional cantilever forming brackets are required, hardwood blocking shall be wedged between the exterior and first interior beam at each of these additional bracket locations.
- Bearing seat surfaces shall be constructed or adjusted to the designated elevations within a tolerance of $\frac{1}{8}$ in. "0.01 ft.". Adjustment shall be made either by grinding the surface or by shimming the bearings.
- Concrete sealer shall be applied to the designated areas of the West and East Abutments.
- The Organic Zinc Rich Primer / Epoxy / Urethane Paint System shall be used for painting of new structural steel except where otherwise noted. The entire system shall be shop applied, with the exception of the exterior surfaces and the bottom of the bottom flange of fascia beams, masked off connection surfaces, field installed fasteners and damaged areas shall be touched up and finish coated in the field. The color of the final finish coat for all interior steel surfaces shall be Gray, Munsell No. 5B 7/1. The color of the final finish coat for the exterior and the bottom of the bottom flange of fascia beams shall be Blue, Munsell No. 10B 3/6. See Special Provision for "Cleaning and Painting New Metal Structures."
- The embankment configuration shown shall be the minimum that must be placed and compacted prior to construction of the abutments.
- The Contractor shall drive test piles to 110% of the nominal required bearing specified in production locations at substructures specified or approved by the Engineer before ordering the remainder of piles.
- Slip forming of the concrete parapets IS not allowed.

INDEX OF SHEETS

- SC-1 General Plan and Elevation
- SC-2 General Notes and Total Bill of Material
- SC-3 Substructure Layout
- SC-4 Top of W. Approach Slab Elevations
- SC-5 Top of Slab Elevations
- SC-6 Top of Slab Elevations
- SC-7 Top of Slab Elevations
- SC-8 Top of Slab Elevations
- SC-9 Top of E. Approach Slab Elevations
- SC-10 Deck Plan and Cross Section
- SC-11 Inside Elevation of Parapets
- SC-12 Superstructure Details
- SC-13 Superstructure Bill of Material
- SC-14 Preformed Joint Strip Seal
- SC-15 Drainage Scupper DS-11
- SC-16 Framing Plan
- SC-17 Girder Layout
- SC-18 Steel Details
- SC-19 Steel Details
- SC-20 Moment and Reaction Tables
- SC-21 Bearing Layout
- SC-22 Expansion Bearing Details
- SC-23 Fixed Bearing Details
- SC-24 West Abutment Plan and Elevation
- SC-25 West Abutment Wingwall Details
- SC-26 West Abutment Details
- SC-27 East Abutment Plan and Elevation
- SC-28 East Abutment Wingwall Details
- SC-29 East Abutment Details
- SC-30 Pier
- SC-31 West Approach Slab Details
- SC-32 East Approach Slab Details
- SC-33 Approach Slab Details
- SC-34 Steel H-Pile Details
- SC-35 Bar Splicer Details
- SC-36 Soil Borings Logs
- SC-37 Soil Borings Logs

TOTAL BILL OF MATERIAL

ITEM	UNIT	SUPER	SUB	TOTAL
Preformed Joint Strip Seal	Foot	155	-	155
Concrete Structures	Cu. Yd.	-	377.2	377.2
Concrete Superstructure	Cu. Yd.	677.5	-	677.5
Bridge Deck Grooving	Sq. Yd.	1,480	-	1,480
Protective Coat	Sq. Yd.	1,750	-	1,750
Stud Shear Connectors	Each	2,046	-	2,046
Reinforcement Bars, Epoxy Coated	Pound	183,170	56,620	239,790
Name Plates	Each	1	-	1
Concrete Sealer	Sq. Ft.	-	507	507
Drainage Scuppers, DS-11	Each	2	-	2
Furnishing and Erecting Structural Steel				
Furnishing Steel Piles HP12X53	Foot	-	1,010	1,010
Driving Piles	Foot	-	1,010	1,010
Test Pile Steel HP12X53	Each	-	2	2
Pile Shoes	Each	-	46	46
Bar Splicers	Each	-	124	124
Slope Wall 4 Inch	Sq. Yd.	-	748	748
Braced Excavation	Cu. Yd.	-	123	123
Rock Excavation for Structures	Cu. Yd.	-	65	65
High Load Multi-Rotational Bearings, Guided Expansion, 200K	Each	14	-	14
High Load Multi-Rotational Bearings, Fixed - 450K	Each	7	-	7
Mechanically Stabilized Earth Retaining Wall	Sq. Ft.	-	3,764	3,764
Removal and Disposal of Unsuitable Material for Structures	Cu. Yd.	-	294	294
Anchor Bolts, 1"	Each	56	-	56
Anchor Bolts, 1 1/4"	Each	28	-	28

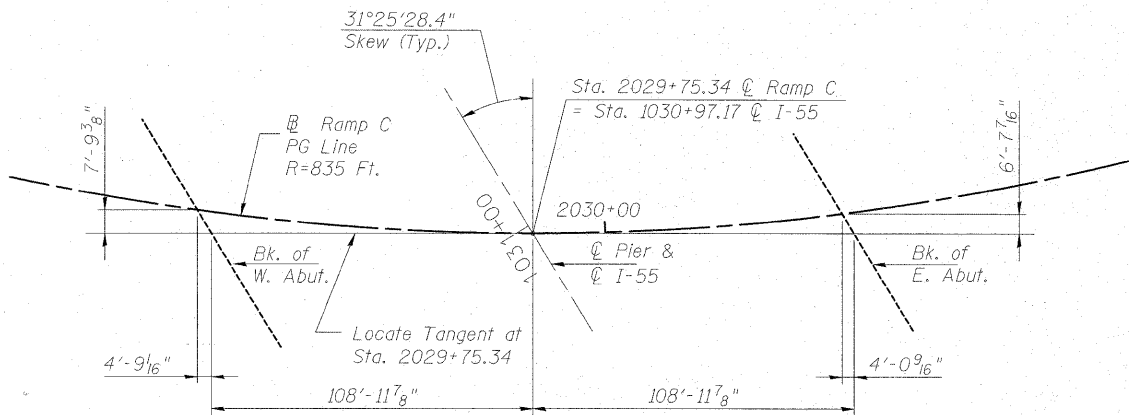

OFFSET SKETCH

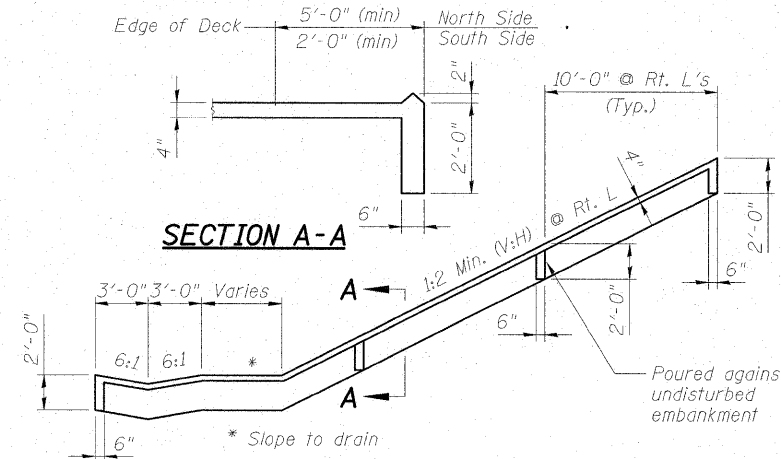

TYPICAL SECTION THRU SLOEWALL

Note:
Slope wall shall be reinforced with welded wire fabric, 6 in. x 6 in. - W4.0 x W4.0, weighing 58 lbs. per 100 sq. ft..

STATION 2029+75.34
BUILT 20__ BY
STATE OF ILLINOIS
RAMP C
SEC. (99-1 & 22) R-6
LOADING HL-93
STRUCTURE NO. 099-0348

NAME PLATE

See Sta. 515001-01

DESIGNED	BKB
CHECKED	PMH
DRAWN	AMV/RJ
CHECKED	BKB

GENERAL NOTES
AND TOTAL BILL OF MATERIAL
STRUCTURE NO. 099-0348

Δ Rev. 4-20-11

McDonough Associates Inc.
Engineers / Architects
130 East Randolph Street
Chicago, Illinois 60601
(312) 946-8600

SHEET NO.	F.A.I. RTE.	SECTION	COUNTY	TOTAL SHEETS	SHEET NO.
SC-2	55	(99-1&2) R-6	WILL	756	528
CONTRACT NO. 60F12					
SC-37		FED. ROAD DIST. NO.	ILLINOIS	FED. AID PROJECT	

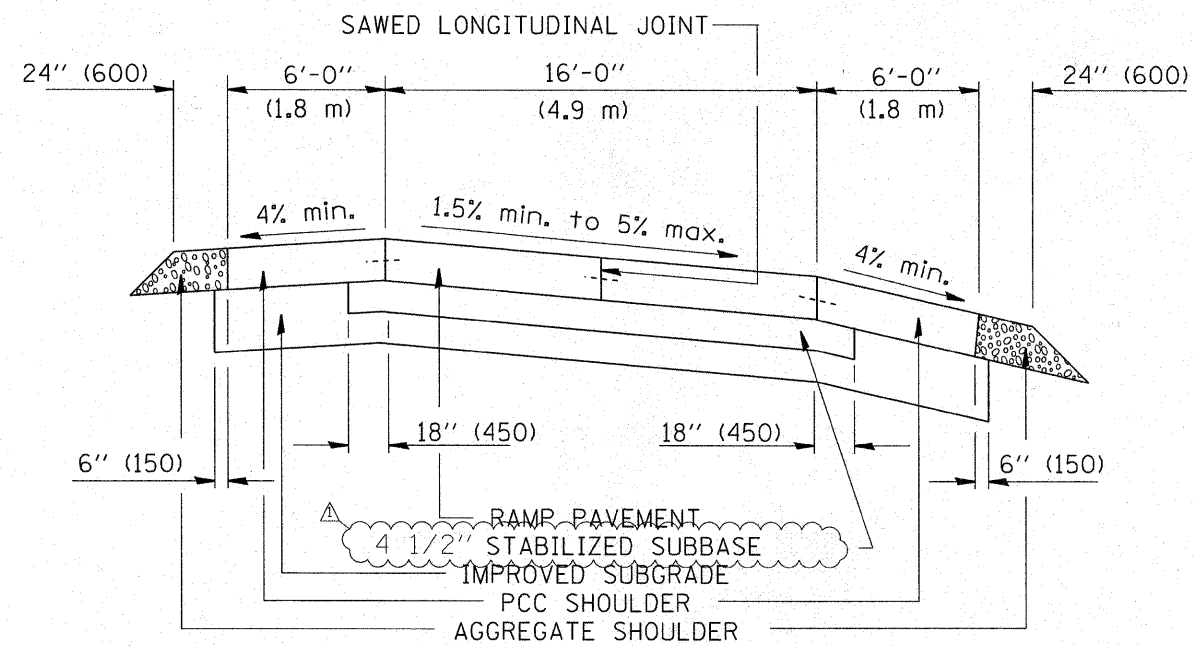

SECTION

NOTES:

1. CENTERLINE JOINT REMAINS IN THE CENTER WHEN RAMP TRANSITIONS TO TWO (2) RAMPS AT 12' (3.6 m).
2. ALL BARS TO BE EPOXY COATED.

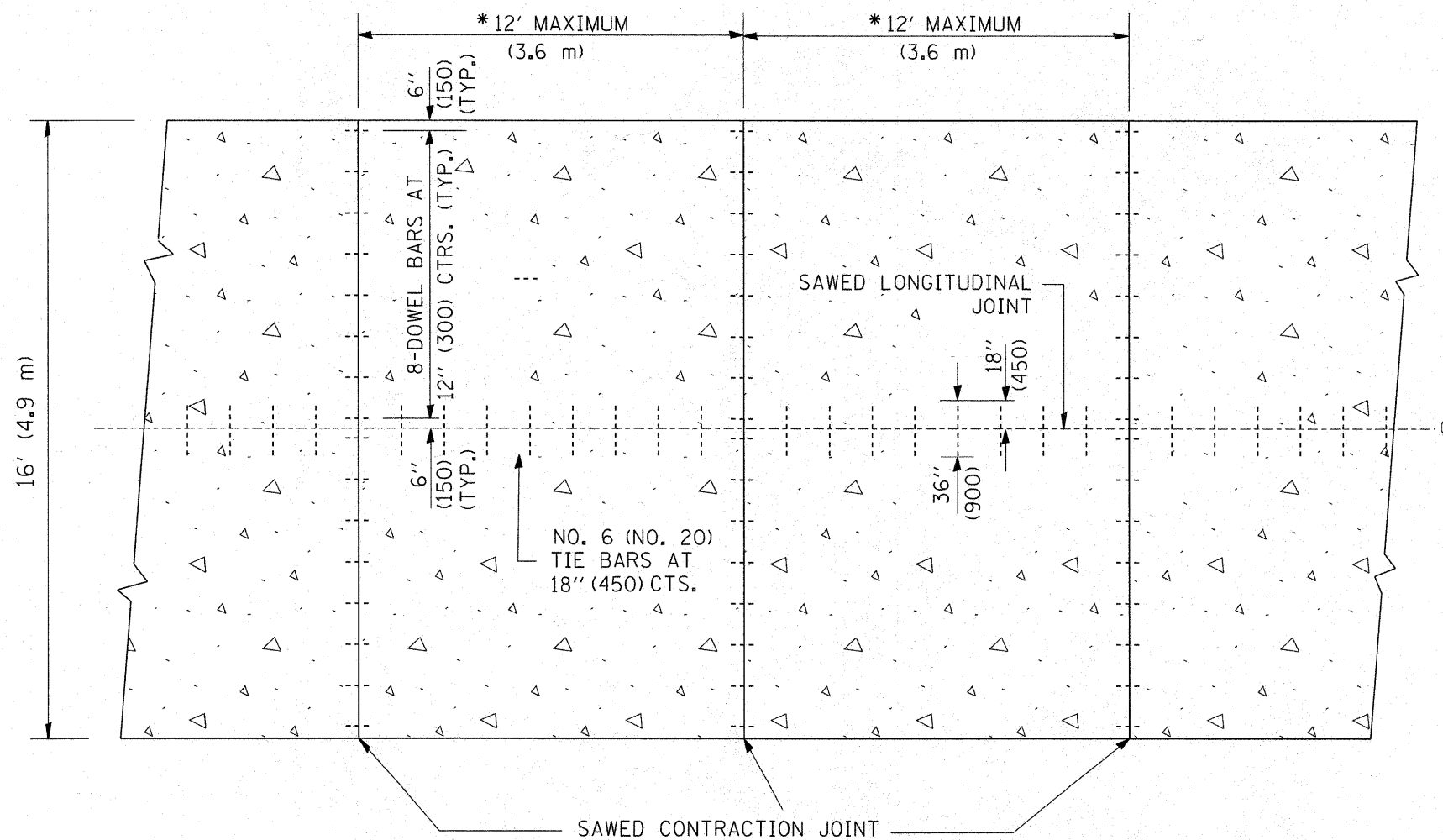

PLAN

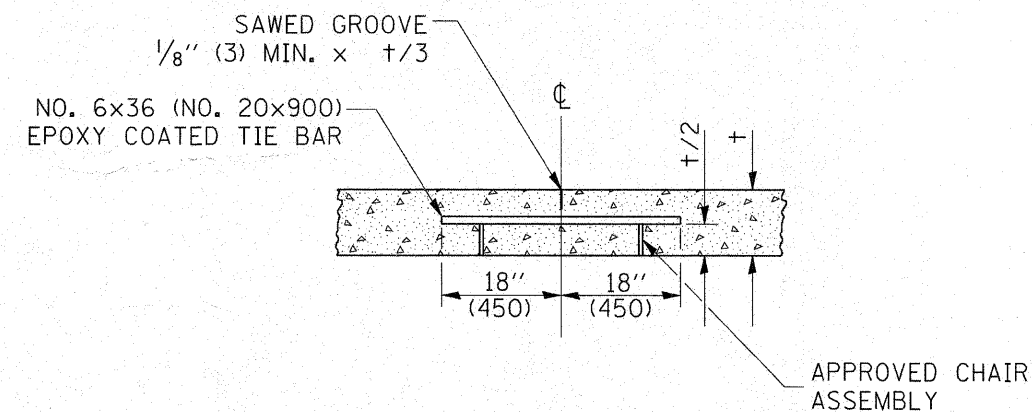

SAWED LONGITUDINAL JOINT

△ SHEET MODIFIED 4/14/11

ALL DIMENSIONS ARE IN INCHES (MILLIMETERS) UNLESS OTHERWISE NOTED

FILE NAME = W:\diststd\22x34\bd49.dgn	USER NAME = geglennobt	DESIGNED -	REVISED -	STATE OF ILLINOIS DEPARTMENT OF TRANSPORTATION	DETAIL FOR CENTERLINE SAW CUT 16' (4.9 m) AND VARIABLE JOINTED PCC PAVEMENT FOR RAMPS	F.A.I. RTE.	SECTION	COUNTY	TOTAL SHEETS	SHEET NO.
	PLOT SCALE = 50.0000' / IN.	DRAWN - TOM MATOUSEK	REVISED -			55	99-2HB-2B-1	WILL	756	569
PLOT DATE = 1/4/2008	CHECKED - A. ABBAS	DATE - 10-18-02	REVISED -	SCALE: NONE	SHEET NO. 1 OF 1 SHEETS	STA.	TO STA.	FED. ROAD DIST. NO. 1 ILLINOIS FED. AID PROJECT		
								CONTRACT NO. 60F12		