

- PROPOSED LEGEND**
- (A) PCC PAVEMENT 10" (JOINTED)
 - (B) PCC SHOULDERS, 10"
 - (C) AGGREGATE SHOULDERS, TYPE B 10"
 - (D) HMA PAVEMENT (SEE TYPICAL SECTIONS)
 - (E) HMA SHOULDERS (SEE TYPICAL SECTIONS)
 - (F) CONCRETE MEDIAN SURFACE, 4 INCH
 - (G) CONCRETE MEDIAN RAMP NOSE (SEE STD 606301-04)
PAID FOR AS CONCRETE MEDIAN, TYPE SB-6.24 (MODIFIED)
 - (H) CONCRETE MEDIAN, TYPE SB 6.24 (MODIFIED)
 - (I) COMBINATION CONCRETE CURB & GUTTER TYPE B-6.24
 - (J) COMBINATION CONCRETE CURB & GUTTER TYPE M-2.24
 - (K) CONCRETE BARRIER, DOUBLE FACE, 42" HEIGHT
 - (L) IMPACT ATTENUATOR FULLY REDIRECTIVE NARROW TEST LEVEL 3
 - (M) CORRUGATED MEDIAN
 - (N) HMA SHOULDER CROSS SLOPE CORRECTION
 - (2) STATION OFFSET
- FENCE AS INDICATED IN PLANS

NO.	STATION	OFFSET
①	6079+90.07	16.00' LT
②	6079+90.07	16.00' RT

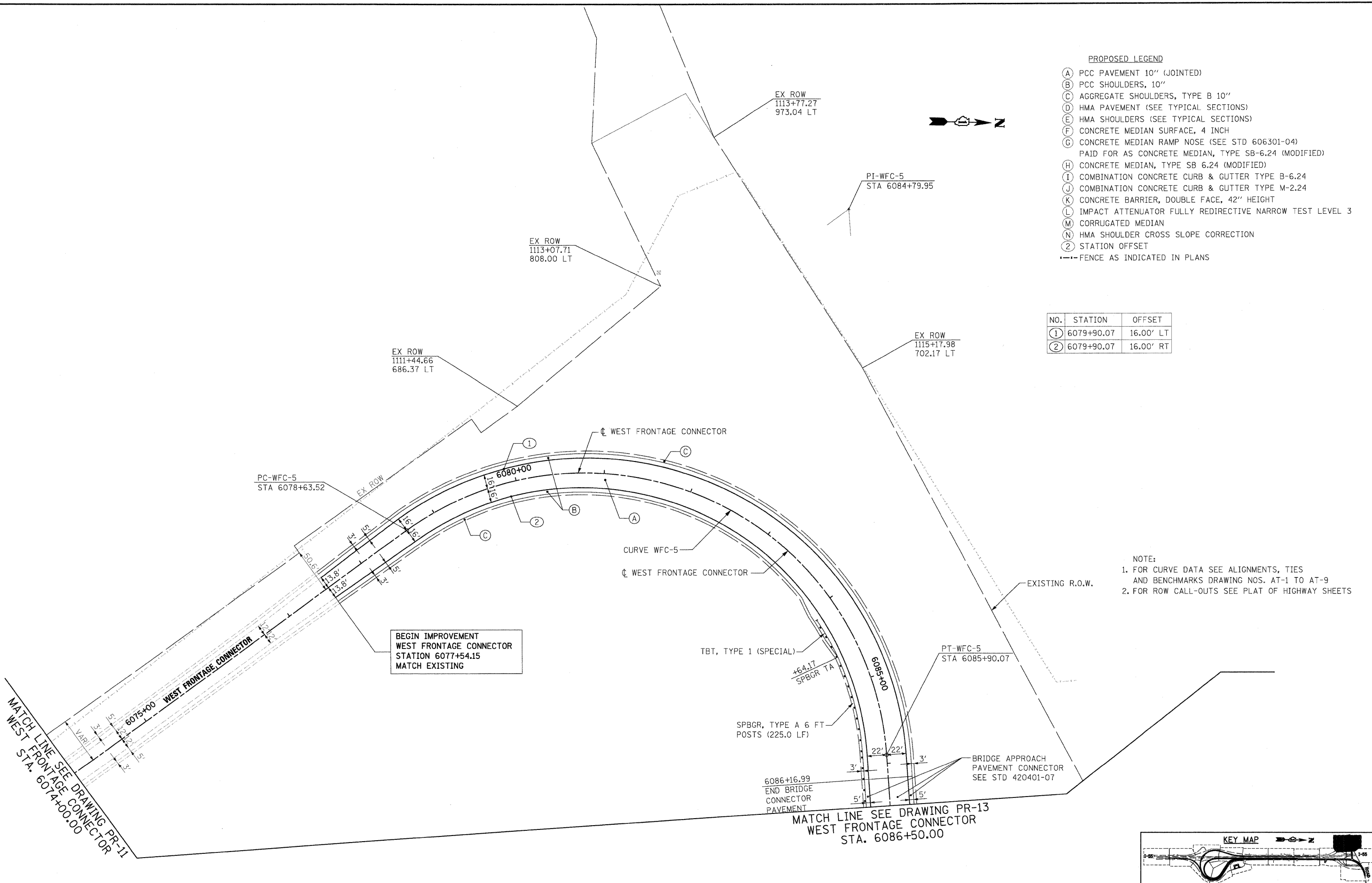

NOTE:
 1. FOR CURVE DATA SEE ALIGNMENTS, TIES AND BENCHMARKS DRAWING NOS. AT-1 TO AT-9
 2. FOR ROW CALL-OUTS SEE PLAT OF HIGHWAY SHEETS

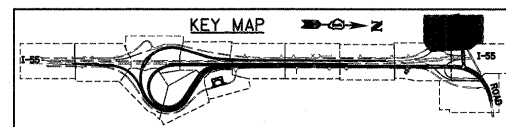

McDonough Associates Inc.
 Engineers / Architects
 130 East Randolph Street, Chicago, Illinois 60601

FILE NAME = D150F12-SHT-PLAN12.dgn	USER NAME = TKLuegel	DESIGNED - JTF	REVISED -
		DRAWN - JTF	REVISED -
		CHECKED - DLT	REVISED -
		DATE - 2/4/11	REVISED -

STATE OF ILLINOIS
DEPARTMENT OF TRANSPORTATION

PROPOSED PLAN
 SCALE: 1"=50' SHEET NO. 12 OF 15 SHEETS STA. TO STA.

F.A.I. RTE. 55	SECTION 99-2HB-2B-1	COUNTY WILL	TOTAL SHEETS 756	SHEET NO. 70
CONTRACT NO. 60F12				
FED. ROAD DIST. NO. 1 ILLINOIS FED. AID PROJECT				