

| NO. | STATION | OFFSET | NO. | STATION | OFFSET |
|-----|------------|-----------|-----|------------|------------|
| ① | 964+58.57 | 9.00' LT | ⑪ | 6089+94.65 | 22.29' LT |
| ② | 965+63.96 | 9.00' LT | ⑫ | 6089+94.65 | 22.00' RT |
| ③ | 965+61.57 | 0.39' RT | ⑬ | 6090+54.65 | 22.00' RT |
| ④ | 965+95.37 | 9.00' RT | ⑭ | 6090+54.65 | 22.00' LT |
| ⑤ | 964+33.14 | 33.00' LT | ⑮ | 1112+30.00 | 44.58' RT |
| ⑥ | 965+43.51 | 77.34' LT | ⑯ | 1121+26.00 | 43.94' RT |
| ⑦ | 965+99.68 | 45.00' LT | ⑰ | 1119+19.67 | 98.00' RT |
| ⑧ | 970+00.01 | 45.00' LT | ⑱ | 1119+18.02 | 151.85' RT |
| ⑨ | 6090+39.50 | 22.00' RT | ⑲ | 1117+40.00 | 44.25' LT |
| ⑩ | 6089+77.61 | 22.00' LT | ⑳ | 1116+75.59 | 98.20' LT |
| | | | ㉑ | 965+69.94 | 9.00' LT |

- PROPOSED LEGEND**
- (A) PCC PAVEMENT 10" (JOINTED)
 - (B) PCC SHOULDERS, 10"
 - (C) AGGREGATE SHOULDERS, TYPE B 10"
 - (D) HMA PAVEMENT (SEE TYPICAL SECTIONS)
 - (E) HMA SHOULDERS (SEE TYPICAL SECTIONS)
 - (F) CONCRETE MEDIAN SURFACE, 4 INCH
 - (G) CONCRETE MEDIAN RAMP NOSE (SEE STD 606301-04)
 - (H) PAID FOR AS CONCRETE MEDIAN, TYPE SB-6.24 (MODIFIED)
 - (I) CONCRETE MEDIAN, TYPE SB 6.24 (MODIFIED)
 - (J) COMBINATION CONCRETE CURB & GUTTER TYPE B-6.24
 - (K) COMBINATION CONCRETE CURB & GUTTER TYPE M-2.24
 - (L) CONCRETE BARRIER, DOUBLE FACE, 42" HEIGHT
 - (M) IMPACT ATTENUATOR FULLY REDIRECTIVE NARROW TEST LEVEL 3
 - (N) CORRUGATED MEDIAN
 - (O) HMA SHOULDER CROSS SLOPE CORRECTION
 - (P) STATION OFFSET
- FENCE AS INDICATED IN PLANS

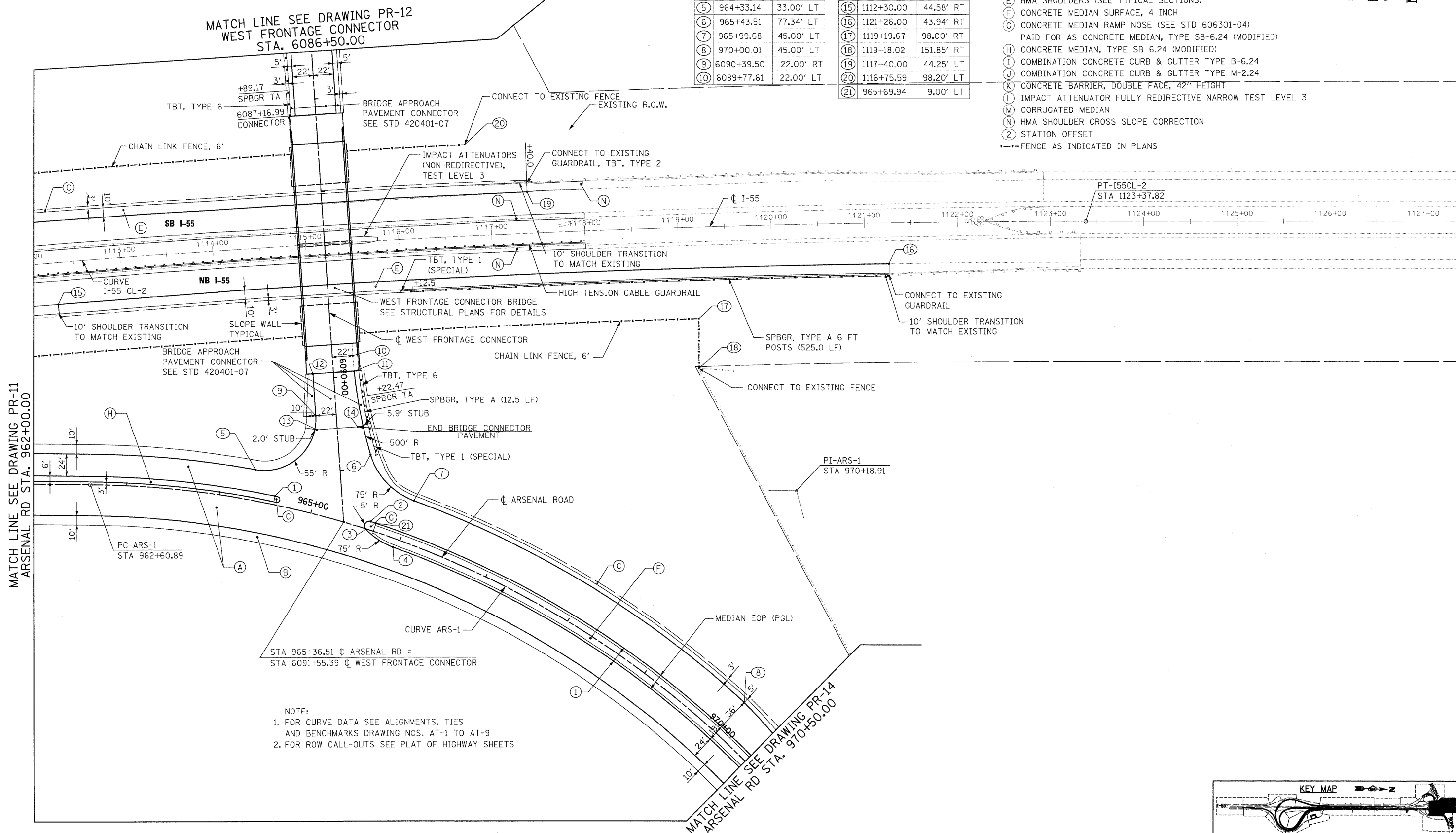

NOTE:

- FOR CURVE DATA SEE ALIGNMENTS, TIES AND BENCHMARKS DRAWING NOS. AT-1 TO AT-9
- FOR ROW CALL-OUTS SEE PLAT OF HIGHWAY SHEETS

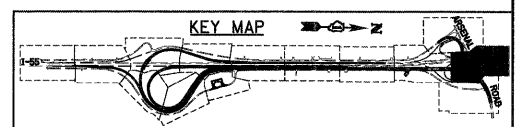

McDonough Associates Inc.
 Engineers / Architects
 130 East Randolph Street, Chicago, Illinois 60601

| | | | |
|--|----------------------|----------------|-----------|
| FILE NAME = D:\62\F12-SHT-PLAN\13.dgn | USER NAME = TKJ\egal | DESIGNED - JTF | REVISED - |
| PLOT SCALE = 1:500 | CHECKED - DLT | DRAWN - JTF | REVISED - |
| PLOT DATE = 2/3/2011 | DATE - 2/4/11 | CHECKED - DLT | REVISED - |

STATE OF ILLINOIS
DEPARTMENT OF TRANSPORTATION

PROPOSED PLAN
 SCALE: 1"=50' SHEET NO. 13 OF 15 SHEETS STA. TO STA.

| | | | | |
|---|------------------------|----------------|---------------------|-----------------|
| F.A.I. RTE. 55 | SECTION 99-2HB-2B-1 | COUNTY WILL | TOTAL SHEETS 756 | SHEET NO. 71 |
| CONTRACT NO. 60F12 | | | | |
| FED. ROAD DIST. NO. 1 ILLINOIS FED. AID PROJECT | | | | |