

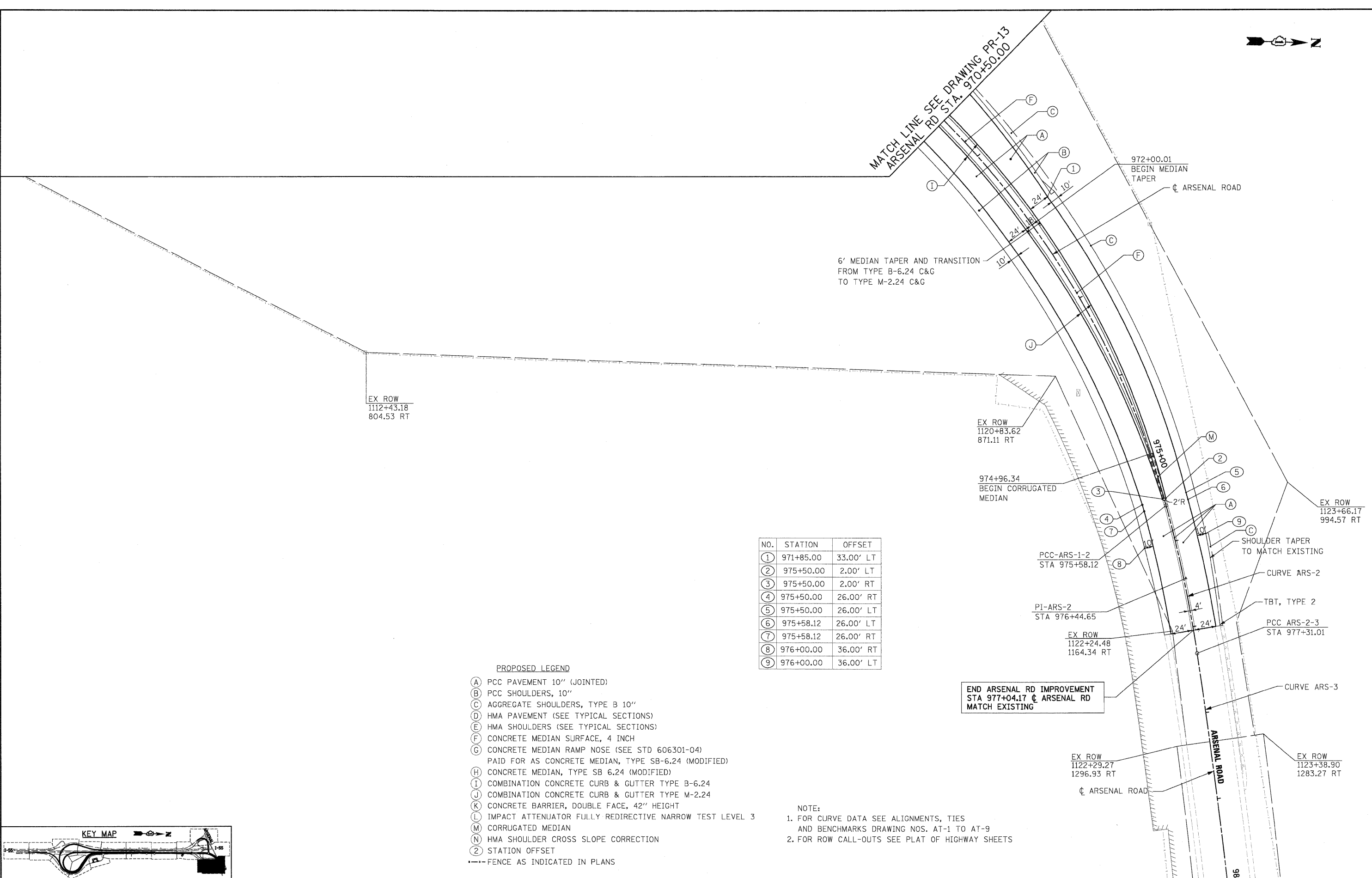

MATCH LINE SEE DRAWING PR-13
ARSENAL RD STA. 970+50.00



NO.	STATION	OFFSET
①	971+85.00	33.00' LT
②	975+50.00	2.00' LT
③	975+50.00	2.00' RT
④	975+50.00	26.00' RT
⑤	975+50.00	26.00' LT
⑥	975+58.12	26.00' LT
⑦	975+58.12	26.00' RT
⑧	976+00.00	36.00' RT
⑨	976+00.00	36.00' LT

PROPOSED LEGEND

- (A) PCC PAVEMENT 10" (JOINTED)
 - (B) PCC SHOULDERS, 10"
 - (C) AGGREGATE SHOULDERS, TYPE B 10"
 - (D) HMA PAVEMENT (SEE TYPICAL SECTIONS)
 - (E) HMA SHOULDERS (SEE TYPICAL SECTIONS)
 - (F) CONCRETE MEDIAN SURFACE, 4 INCH
 - (G) CONCRETE MEDIAN RAMP NOSE (SEE STD 606301-04)
PAID FOR AS CONCRETE MEDIAN, TYPE SB-6.24 (MODIFIED)
 - (H) CONCRETE MEDIAN, TYPE SB 6.24 (MODIFIED)
 - (I) COMBINATION CONCRETE CURB & GUTTER TYPE B-6.24
 - (J) COMBINATION CONCRETE CURB & GUTTER TYPE M-2.24
 - (K) CONCRETE BARRIER, DOUBLE FACE, 42" HEIGHT
 - (L) IMPACT ATTENUATOR FULLY REDIRECTIVE NARROW TEST LEVEL 3
 - (M) CORRUGATED MEDIAN
 - (N) HMA SHOULDER CROSS SLOPE CORRECTION
 - (O) STATION OFFSET
- FENCE AS INDICATED IN PLANS

NOTE:
1. FOR CURVE DATA SEE ALIGNMENTS, TIES AND BENCHMARKS DRAWING NOS. AT-1 TO AT-9
2. FOR ROW CALL-OUTS SEE PLAT OF HIGHWAY SHEETS

END ARSENAL RD IMPROVEMENT
STA 977+04.17 @ ARSENAL RD
MATCH EXISTING

McDonough Associates Inc.
 Engineers / Architects
 130 East Randolph Street, Chicago, Illinois 60601

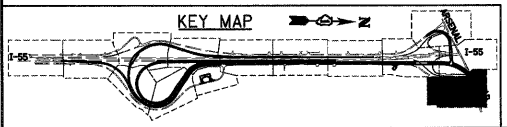

FILE NAME = D160F12-SHT-PLAN14.dgn	USER NAME = TKLuegel	DESIGNED - JTF	REVISED -	STATE OF ILLINOIS DEPARTMENT OF TRANSPORTATION	PROPOSED PLAN	F.A.T. RTE. 55	SECTION 99-2HB-2B-1	COUNTY WILL	TOTAL SHEETS 756	SHEET NO. 72		
PLOT SCALE = 1:500	CHECKED - DLT	REVISED -	SCALE: 1"=50'			SHEET NO. 14 OF 15 SHEETS	STA. TO STA.	CONTRACT NO. 60F12				
PLOT DATE = 2/3/2011	DATE - 2/4/11	REVISED -	FED. ROAD DIST. NO. 1 ILLINOIS FED. AID PROJECT									