

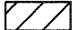





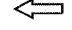

MAINTENANCE OF TRAFFIC LEGEND

-  WORK ZONE (CURRENT STAGE)
-  WORK ZONE (CONTD. FROM PREVIOUS STAGE)
-  DIRECTION OF TRAFFIC
-  PLASTIC DRUMS, SPACING AS SHOWN
-  TEMPORARY PAVEMENT (INSTALLED IN CURRENT STAGE)
-  TEMPORARY PAVEMENT (INSTALLED IN PREVIOUS STAGE)
-  ARROW BOARD
-  TEMPORARY IMPACT ATTENUATOR, TL 3
-  TEMP. CONC. BARRIER W/ PRISMATIC REFLECTORS @ 25 FT CTRS.
-  VERTICAL PANELS, SPACING AS SHOWN

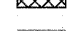
NOTE

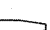
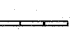
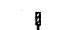
1. REMOVE EXISTING TEMPORARY CONCRETE BARRIER AND PROVIDE CONTRACTOR ACCESS. SEE DETAIL FOR CONTRACTOR ACCESS. CLOSE BARRIER OPENING BY RE-INSTALLING TEMPORARY CONCRETE BARRIER UPON COMPLETION OF PIER CONSTRUCTION.
2. USE OF PHOTO ENFORCEMENT AND ACCOMPANYING SIGNS SHALL BE DETERMINED BY THE ENGINEER.

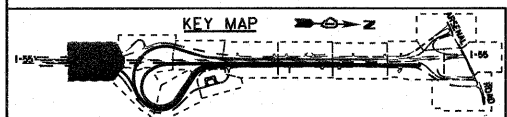
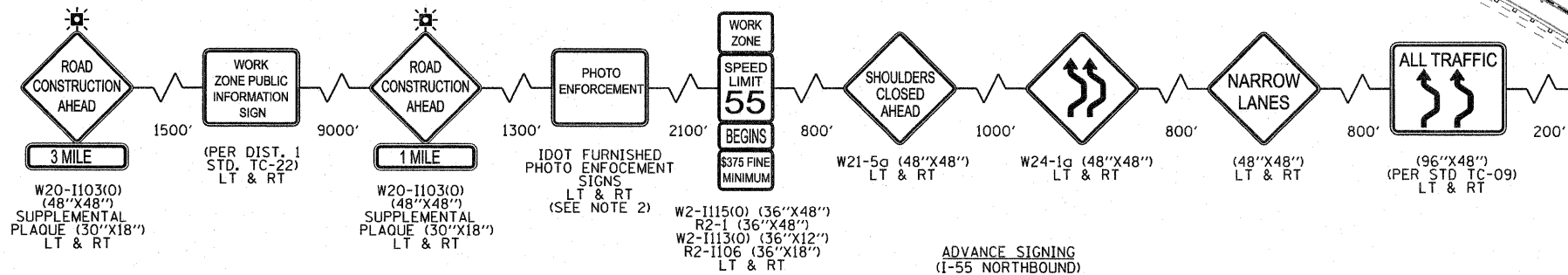
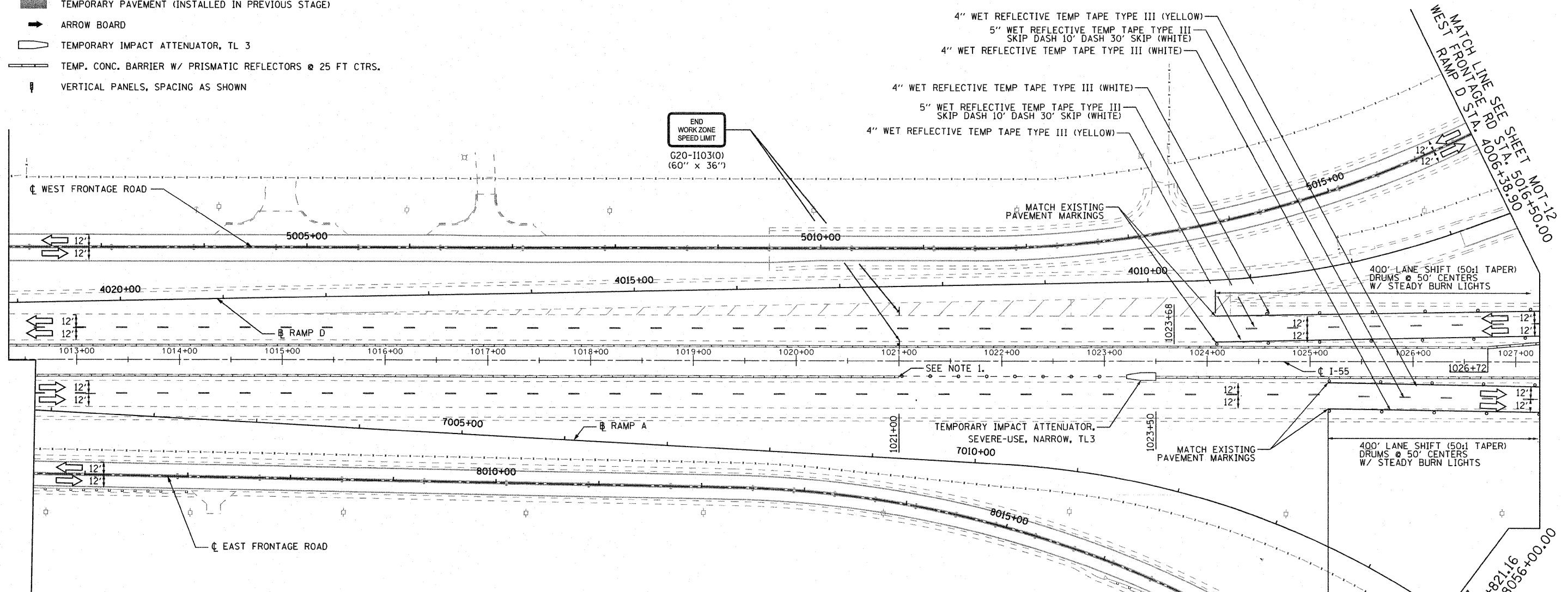

EJM ENGINEERING, INC.
411 South Wells Street Suite 800
Chicago, Illinois 60607



FILE NAME = ...\\D160F12-SHT-STAGING\02.dgn	USER NAME = grai	DESIGNED - GR	REVISED -
		DRAWN - GR	REVISED -
		CHECKED - RY	REVISED -
		DATE - 02/04/2011	REVISED -

**STATE OF ILLINOIS
DEPARTMENT OF TRANSPORTATION**

MAINTENANCE OF TRAFFIC STAGE 1	
SCALE: 1"=50'	SHEET NO. 1 OF 13 SHEETS
STA.	TO STA.

F.A.I. RTE.	SECTION	COUNTY	TOTAL SHEETS	SHEET NO.
55	99-2HB-2B-1	WILL	756	97
CONTRACT NO. 60F12			FED. ROAD DIST. NO. 1 ILLINOIS FED. AID PROJECT	

FINAL