

EJM ENGINEERING, INC.
 411 South Wells Street Suite 800
 Chicago, Illinois 60607

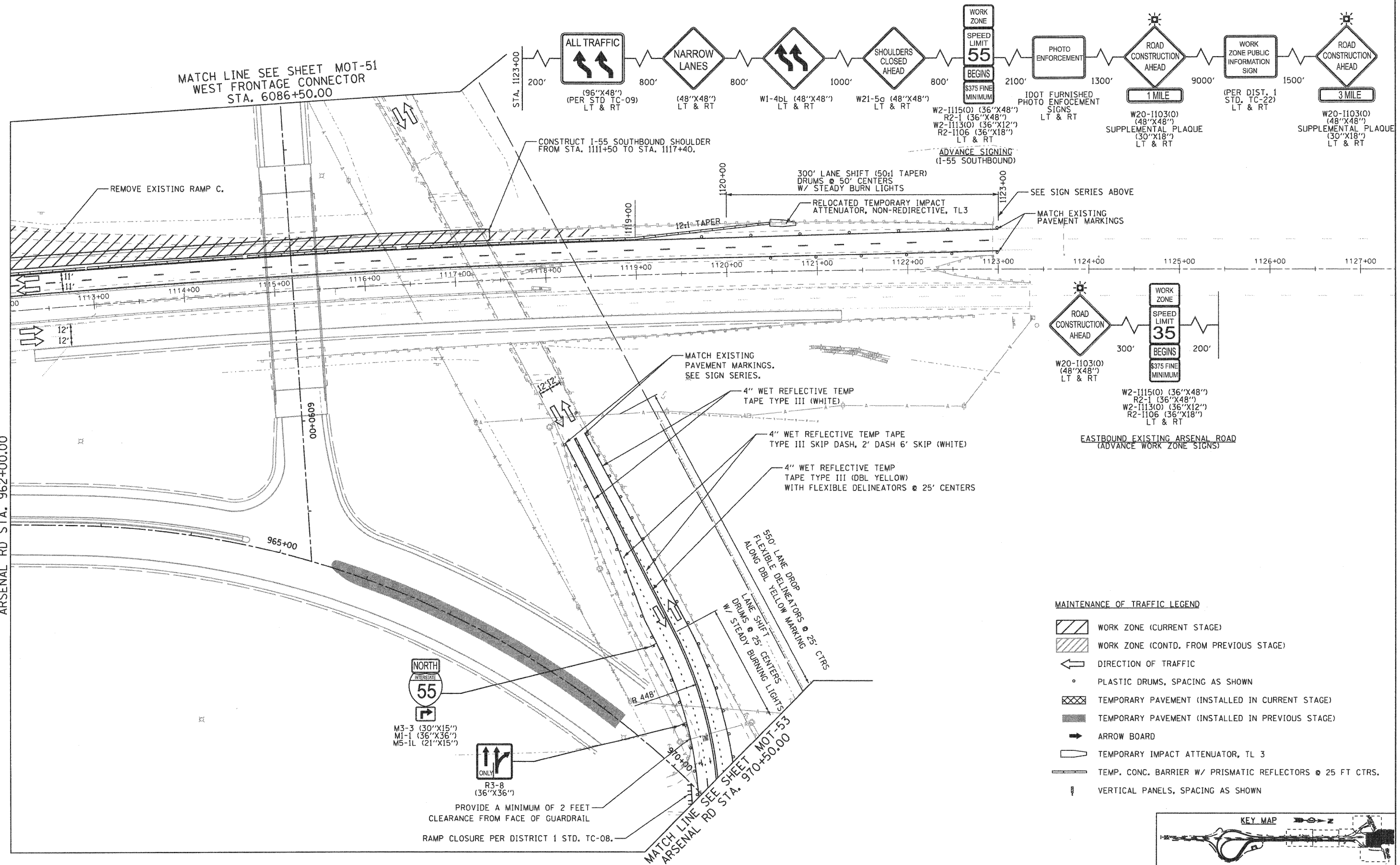

MATCH LINE SEE SHEET MOT-50
 ARSENAL RD STA. 962+00.00

MATCH LINE SEE SHEET MOT-51
 WEST FRONTAGE CONNECTOR
 STA. 6086+50.00



MAINTENANCE OF TRAFFIC LEGEND

- WORK ZONE (CURRENT STAGE)
- WORK ZONE (CONTD. FROM PREVIOUS STAGE)
- DIRECTION OF TRAFFIC
- PLASTIC DRUMS, SPACING AS SHOWN
- TEMPORARY PAVEMENT (INSTALLED IN CURRENT STAGE)
- TEMPORARY PAVEMENT (INSTALLED IN PREVIOUS STAGE)
- ARROW BOARD
- TEMPORARY IMPACT ATTENUATOR, TL 3
- TEMP. CONC. BARRIER W/ PRISMATIC REFLECTORS @ 25 FT CTRS.
- VERTICAL PANELS, SPACING AS SHOWN

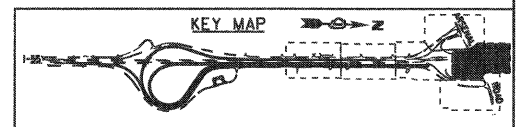

FILE NAME = ...ND168F12-SHT-STAGING413.dgn
 USER NAME = g-r-01
 PLOT SCALE = 1/8"=1'-0"
 PLOT DATE = 2/2/2011

| | |
|-------------------|-----------|
| DESIGNED - GR | REVISED - |
| DRAWN - GR | REVISED - |
| CHECKED - RY | REVISED - |
| DATE - 02/04/2011 | REVISED - |

**STATE OF ILLINOIS
 DEPARTMENT OF TRANSPORTATION**

**MAINTENANCE OF TRAFFIC
 STAGE 4**

SCALE: 1"=50' SHEET NO. 5 OF 6 SHEETS STA. TO STA.

| | | | | |
|---|-------------|--------|--------------------|-----------|
| F.A.I. RTE. | SECTION | COUNTY | TOTAL SHEETS | SHEET NO. |
| 55 | 99-2HB-2B-1 | WILL | 756 | 138 |
| FED. ROAD DIST. NO. 1 ILLINOIS FED. AID PROJECT | | | CONTRACT NO. 60F12 | |

FINAL