

MATCH LINE SEE SHEET MOT-56  
ARSENAL RD STA. 9070+50.00

4" WET REFLECTIVE TEMP TAPE TYPE III (WHITE)  
24" WET REFLECTIVE TEMP TAPE TYPE III (WHITE)  
6" WET REFLECTIVE TEMP TAPE TYPE III SKIP DASH, 2' DASH 6' SKIP (WHITE)

4" WET REFLECTIVE TEMP TAPE TYPE III (YELLOW)

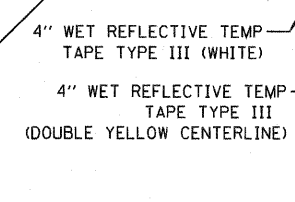
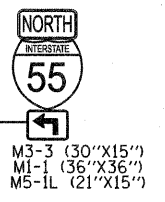
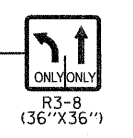
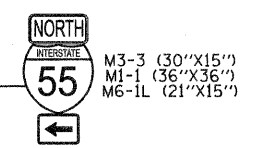
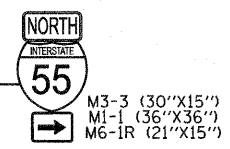

W1-2aL (48"x48")  
W13-1 (24" x 24")

SEE SHEETS TR-07 FOR TEMPORARY TRAFFIC SIGNAL INSTALLATION PLANS.

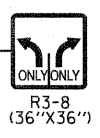

24" WET REFLECTIVE TEMP TAPE TYPE III (WHITE)

4" WET REFLECTIVE TEMP TAPE TYPE III (DOUBLE YELLOW CENTERLINE)

4" WET REFLECTIVE TEMP TAPE TYPE III (WHITE)

6" WET REFLECTIVE TEMP TAPE TYPE III (WHITE)

6" WET REFLECTIVE TEMP TAPE TYPE III SKIP DASH, 2' DASH 6' SKIP (WHITE)

4" WET REFLECTIVE TEMP TAPE TYPE III (WHITE)

RELOCATED TEMPORARY IMPACT ATTENUATOR, NON-REDIRECTIVE, TL3

4" WET REFLECTIVE TEMP TAPE TYPE III (YELLOW)

MATCH EXISTING PAVEMENT MARKINGS. SEE SIGN SERIES.

MAINTENANCE OF TRAFFIC LEGEND

- WORK ZONE (CURRENT STAGE)
- WORK ZONE (CONTD. FROM PREVIOUS STAGE)
- DIRECTION OF TRAFFIC
- PLASTIC DRUMS, SPACING AS SHOWN
- TEMPORARY PAVEMENT (INSTALLED IN CURRENT STAGE)
- TEMPORARY PAVEMENT (INSTALLED IN PREVIOUS STAGE)
- ARROW BOARD
- TEMPORARY IMPACT ATTENUATOR, TL 3
- TEMP. CONC. BARRIER W/ PRISMATIC REFLECTORS @ 25 FT CTRS.
- VERTICAL PANELS, SPACING AS SHOWN

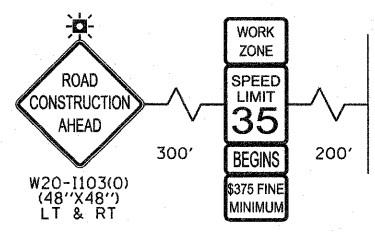

W20-1103(O) (48"x48") LT & RT  
W2-1115(O) (36"x48") R2-1 (36"x48")  
W2-1113(O) (36"x12") R2-1106 (36"x18") LT & RT

WESTBOUND EXISTING ARSENAL ROAD & NORTHBOUND EAST FRONTAGE ROAD (ADVANCE WORK ZONE SIGNS)

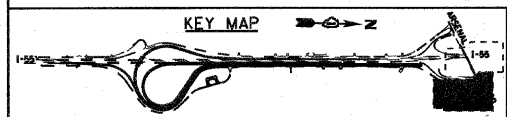

**EJM ENGINEERING, INC.**  
411 South Wells Street Suite 800  
Chicago, Illinois 60607

FILE NAME = ...\\D168F12-SHT-STAGING4C14.dgn	USER NAME = gr-01	DESIGNED - GR	REVISED -	<b>STATE OF ILLINOIS DEPARTMENT OF TRANSPORTATION</b>	<b>MAINTENANCE OF TRAFFIC STAGE 4C</b>		F.A.I. RTE. 55	SECTION 99-2HB-2B-1	COUNTY WILL	TOTAL SHEETS 756	SHEET NO. 143	
PLOT SCALE = 1:50	PLOT DATE = 2/23/2011	DRAWN - GR	REVISED -		SCALE: 1"=50'	SHEET NO. 2 OF 2 SHEETS	STA.	TO STA.	CONTRACT NO. 60F12			
CHECKED - RY	DATE - 02/04/2011	REVISIONS	REVISIONS		FED. ROAD DIST. NO. 1   ILLINOIS FED. AID PROJECT							
DATE - 02/04/2011	REVISIONS	REVISIONS	REVISIONS		<b>FINAL</b>							