

PLAN	DATE
NO. _____	BY _____
NO. _____	DATE _____
NO. _____	DATE _____
NO. _____	DATE _____

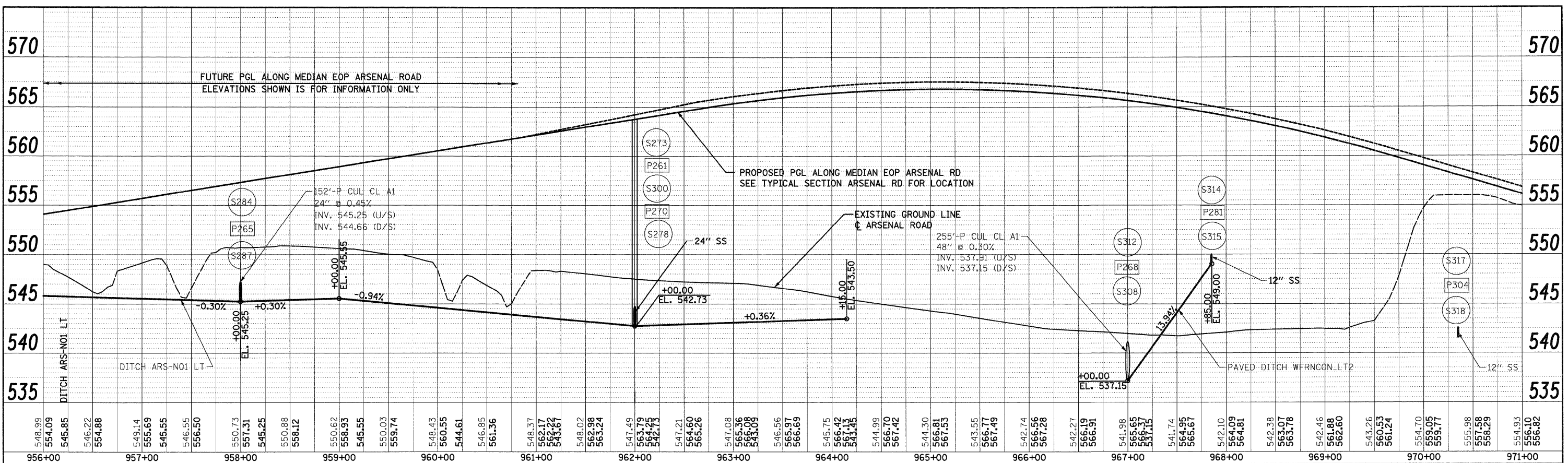

PROFILE	DATE
NO. _____	BY _____
NO. _____	DATE _____
NO. _____	DATE _____
NO. _____	DATE _____

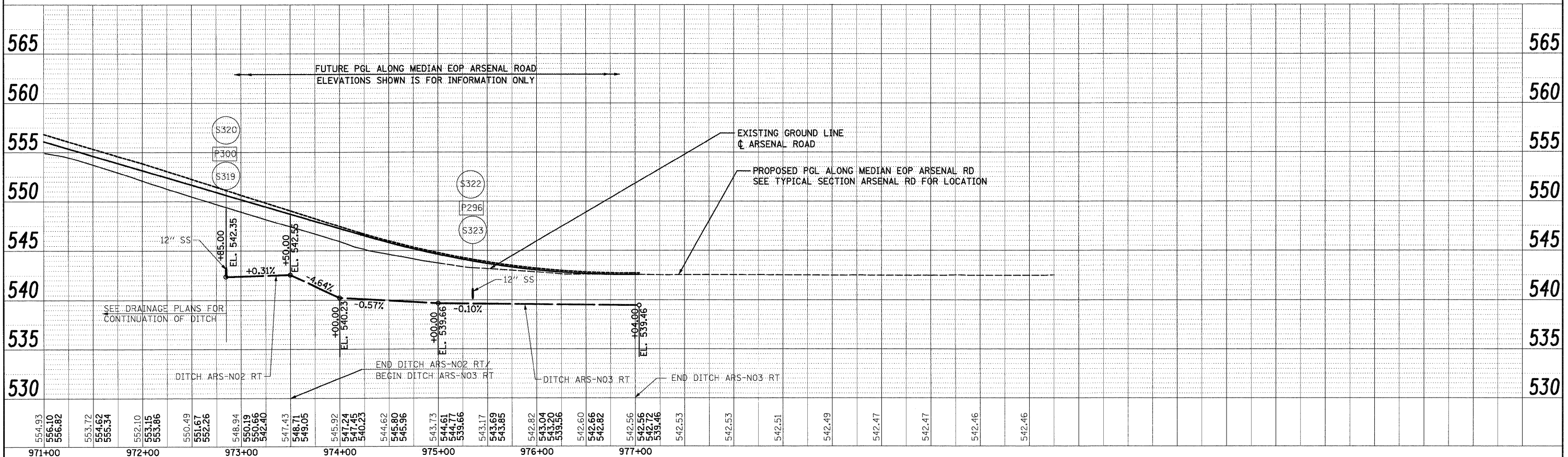

300 W. ADAMS ST.
CHICAGO, IL 60606
TEL: (312) 629-0240
FAX: (312) 629-8449

SINGH
SINGH & ASSOCIATES, INC.
CONSULTING ENGINEERS

FILE NAME = D:\60\F12-SHT-DRAIN\PROFILE04.dgn	USER NAME = TKLuegel	DESIGNED - PKT	REVISED -	STATE OF ILLINOIS DEPARTMENT OF TRANSPORTATION	ARSENAL ROAD DRAINAGE PROFILE	F.A.I. RTE. 55	SECTION 99-2HB-28-1	COUNTY WILL	TOTAL SHEETS 756	SHEET NO. 193
PLOT SCALE = 1:500	CHECKED - CL	REVISED -	REVISED -			CONTRACT NO. 60F12				
PLOT DATE = 2/3/2011	DATE = 2/4/11	REVISED -	REVISED -			FED. ROAD DIST. NO. 1 ILLINOIS FED. AID PROJECT				
SCALE: 1"=50' H: 1"=5' V		SHEET NO. 4 OF 14 SHEETS				STA. TO STA.				