

- NOTES**
- ELEVATIONS ARE FOR INFORMATION ONLY CONTRACTOR SHALL VERIFY ALL ELEVATIONS PRIOR TO CONSTRUCTION.
 - REFER TO STANDARDS 420001, 420101, 420106, 420201 AND 420401 FOR JOINT DETAILS AND SPACING.
 - RAMP C PAVEMENT JOINTS SHALL ALIGN WITH ANCHORAGE SLAB JOINTS ON MSE WALLS #027 AND #028. SEE STRUCTURAL PLANS FOR LOCATIONS.
 - SEE DRAINAGE AND UTILITY PLAN SHEETS FOR MORE INFORMATION ON LOCATIONS OF PROPOSED DRAINAGE STRUCTURES.

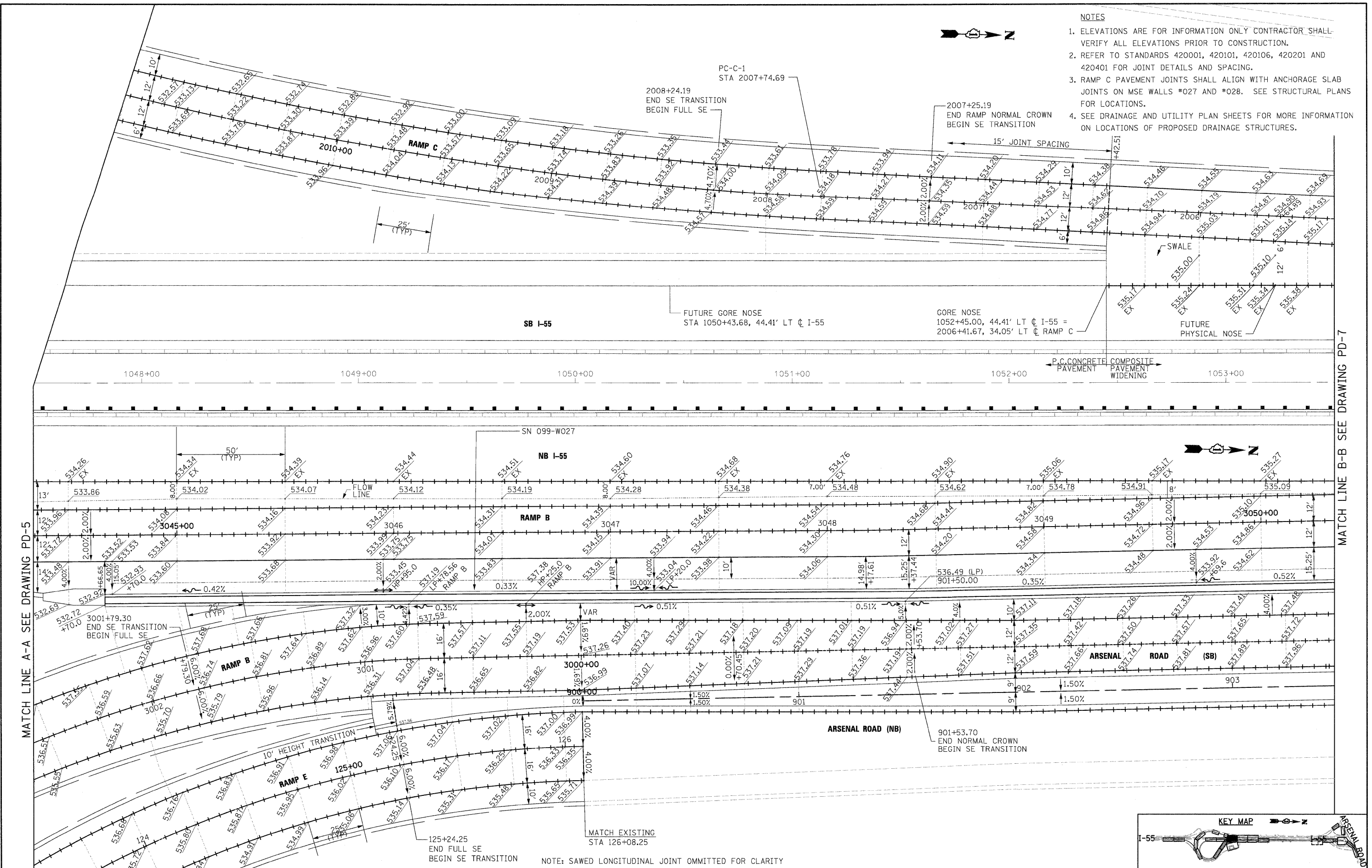

MATCH LINE A-A SEE DRAWING PD-5

MATCH LINE B-B SEE DRAWING PD-7

NOTE: SAWED LONGITUDINAL JOINT OMITTED FOR CLARITY

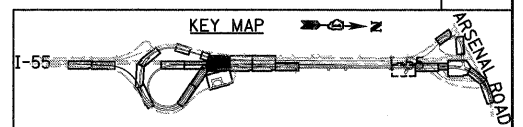

FILE NAME = D162F12-SHT-DETAILS-PAVEMENT06.dgn	USER NAME = TKluegel	DESIGNED - JTF	REVISED -	STATE OF ILLINOIS DEPARTMENT OF TRANSPORTATION	PAVEMENT DETAILS	F.A.I. RTE. 55	SECTION 99-2HB-2B-1	COUNTY WILL	TOTAL SHEETS 756	SHEET NO. 258		
PLOT SCALE = 1:20	CHECKED - DLT	REVISED -	SCALE: 1"=20'			SHEET NO. 6 OF 8 SHEETS	STA. TO STA.	CONTRACT NO. 60F12				
PLOT DATE = 2/3/2011	DATE = 2/4/11	REVISED -	FED. ROAD DIST. NO. 1 ILLINOIS FED. AID PROJECT									