

Bench Mark (BM9): Box cut on S. corner of traffic handhole foundation SE corner of Arsenal Road and east Frontage Road. El. 545.485

Existing Structure: None.

STATE OF ILLINOIS
DEPARTMENT OF TRANSPORTATION

DESIGN SPECIFICATIONS
AASHTO LRFD Bridge Design Specifications,
2007 (4th Edition) with 2008 Interim Revisions.

LOADING HL-93
Allow 50 lbs/sq. ft. for
Future Wearing Surface

DESIGN STRESSES
Field Units
f'c = 3,500 psi
fy = 60,000 psi (reinforcement)
Precast Prestressed Units
f'c = 7,000 psi
f'ci = 6,000 psi
f's = 270,000 psi (1/2" low relaxation strands)
f'si = 201,900 psi (low relaxation strands)

SEISMIC DATA
Seismic Performance Zone (SPZ) = 1
Design Spectral Acceleration at 1.0 sec. (S₀₁) = 0.069g
Design Spectral Acceleration at 0.2 sec. (S₀₅) = 0.127g
Soil Site Class = C

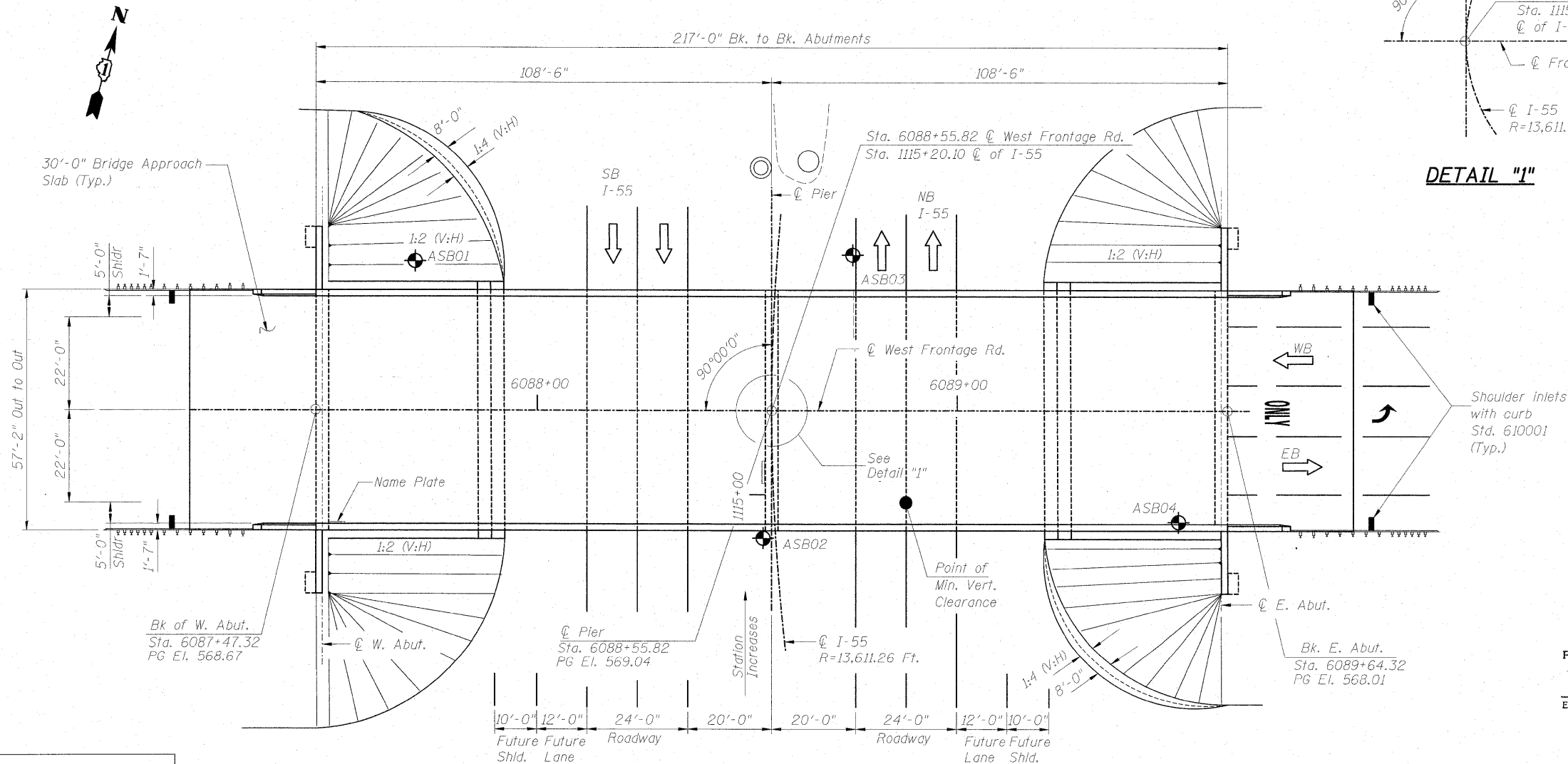
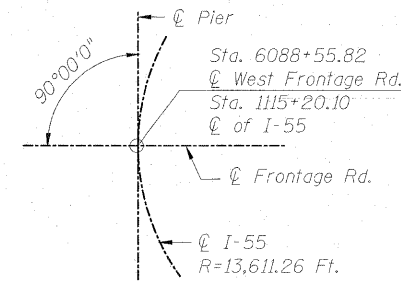
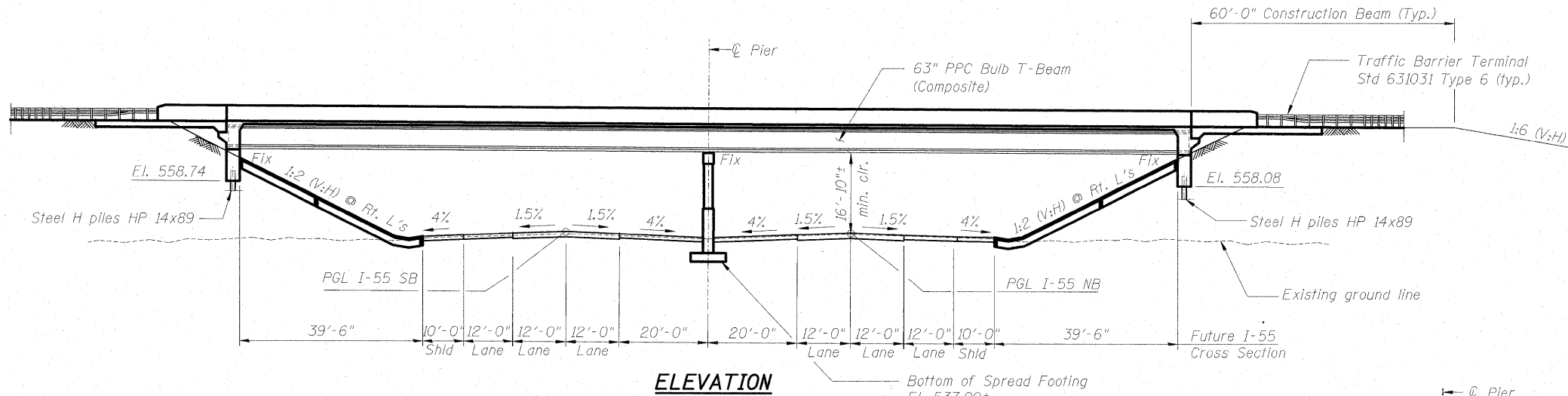

DETAIL "1"

PLAN

Shoulder inlets
with curb
Std. 610001
(Typ.)

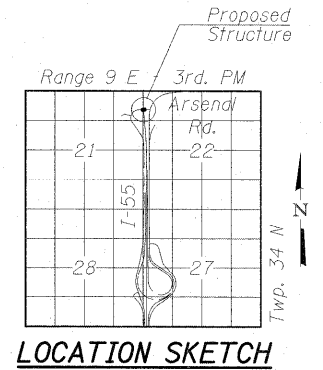
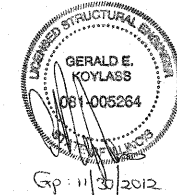

APPROVED
FOR STRUCTURAL ADEQUACY ONLY
Gerald E. Kovlass
ENGINEER OF BRIDGES AND STRUCTURES

**GENERAL PLAN AND ELEVATION
WEST FRONTAGE RD. OVER I-55
SEC. 92-2HB-2B-1
WILL COUNTY
STATION 6088+55.821
STRUCTURE NO. 099-0347**

DESIGNED	MJL
CHECKED	PMH
DRAWN	MJL/RJ
CHECKED	BKB

McDonough Associates Inc.
Engineers / Architects
130 East Randolph Street
Chicago, Illinois 60601
(312) 946-8600

SHEET NO. SF1	F.A.I. RTE.	SECTION	COUNTY	TOTAL SHEETS	SHEET NO.
	55	92-2HB-2B-1	WILL	756	503
SF24 SHEETS	SN 099-0347		CONTRACT NO. 60F12		
FED. ROAD DIST. NO.		ILLINOIS	FED. AID PROJECT		