

STATE OF ILLINOIS
DEPARTMENT OF TRANSPORTATION

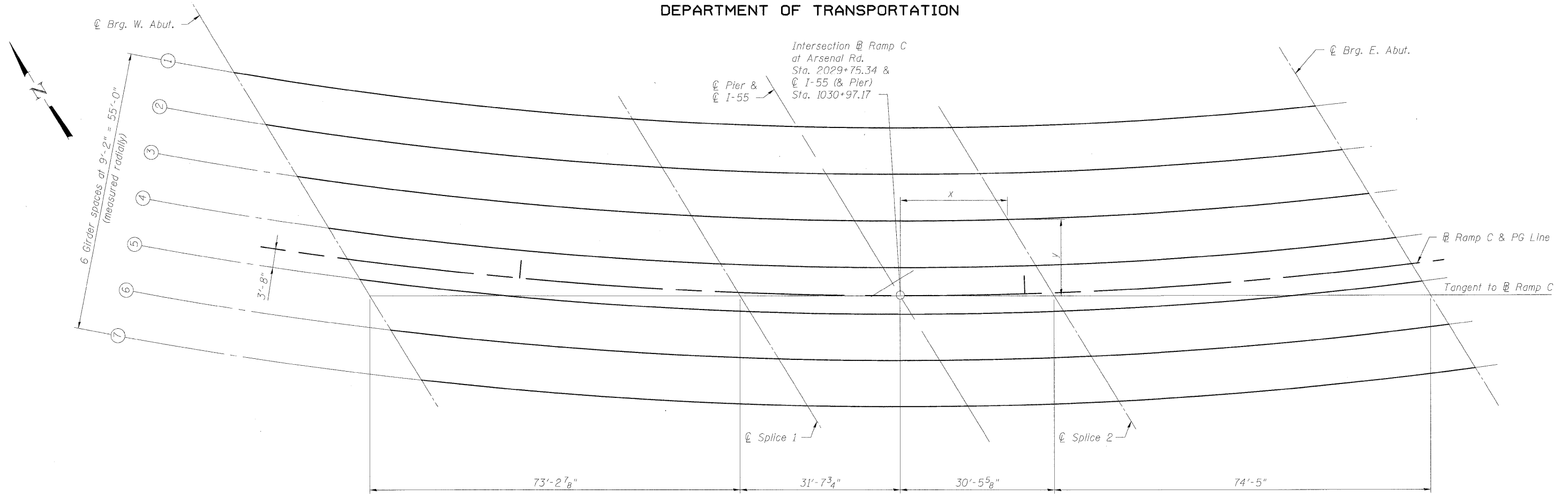

LAYOUT PLAN

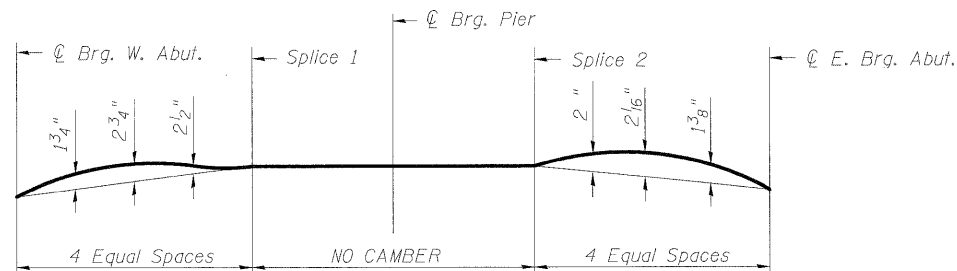

CAMBER DIAGRAM
FOR GIRDERS 1-7

TOP OF WEB ELEVATIONS

GIRDER	@ Brg. W. Abut.	@ Splice 1	@ Pier	@ Splice 2	@ Brg. E. Abut.
1	552.051	552.756	552.873	552.929	552.888
2	552.695	553.344	553.442	553.484	553.418
3	553.331	553.927	554.008	554.037	553.947
4	553.960	554.506	554.572	554.587	554.475
5	554.583	555.082	555.132	555.136	555.002
6	555.200	555.655	555.691	555.683	555.529
7	555.811	556.224	556.247	556.228	556.055

" Top of web elevations
for fabrication only "

LAYOUT DIMENSIONS (In feet-inches)

GIRDER	RADIUS	@ Brg. W. Abut.		Splice 1		Pier		Splice 2		@ Brg. E. Abut.	
		x	y	x	y	x	y	x	y	x	y
1	802'-0"	-131'-8 3/8"	43'-10 5/8"	-52'-10 3/8"	34'-9"	-20'-3 7/8"	33'-3"	+10'-3 1/4"	33'-0 3/4"	+82'-1 3/4"	37'-2 5/8"
2	811'-2"	-125'-4 7/8"	33'-7"	-47'-0 1/2"	25'-2 3/8"	-14'-7 3/4"	23'-11 1/2"	+15'-9 3/4"	23'-11 3/4"	+87'-5 1/4"	28'-6 3/4"
3	820'-4"	-119'-1 7/8"	23'-4 3/8"	-41'-2 7/8"	15'-8 3/8"	-8'-11 7/8"	14'-8 5/8"	+21'-4"	14'-11 3/8"	+92'-8 1/2"	19'-11"
4	829'-6"	-112'-11 5/8"	13'-2 3/4"	-35'-5 1/2"	6'-3"	-3'-4 3/8"	5'-6"	+26'-10 7/8"	5'-11 1/4"	+97'-11 3/4"	11'-3 5/8"
5	838'-8"	-106'-9 3/4"	3'-2"	-29'-8 5/8"	-3'-1 5/8"	+2'-2 7/8"	-3'-8"	+32'-4"	-3'-0 1/2"	+103'-2 3/4"	2'-8 1/2"
6	847'-10"	-100'-8 1/2"	-6'-10"	-24'-0 7/8"	-12'-5 7/8"	+7'-9 7/8"	-12'-9 1/2"	+37'-9 1/2"	-11'-11 7/8"	+108'-5 5/8"	-5'-10 3/8"
7	857'-0"	-94'-7 3/4"	-16'-9 1/8"	-18'-3 7/8"	-21'-9 5/8"	+13'-4 1/2"	-21'-10 3/4"	+43'-2 7/8"	-20'-10 7/8"	+113'-8 3/8"	-14'-5 1/8"

- Notes:
1. For Steel Framing Plan, see Sheet No. S-16.
 2. For Girder Elevations, see Sheet No. S-16.
 3. For Cross-Frame Details, see Sheet No. S-16.
 4. For Splice Details, see Sheet No. S-18.
 5. For Bearing Layout, see Sheet No. S-21.
 6. For Bearing Details, see Sheet No. S-22 & SC-23.

DESIGNED	MB
CHECKED	KJH
DRAWN	AMV
CHECKED	KJH

GIRDER LAYOUT
STRUCTURE NO. 099-0348



McDonough Associates Inc.
Engineers / Architects
130 East Randolph Street
Chicago, Illinois 60601
(312) 946-8600

SHEET NO. SC-17 SHEETS SC-37	F.A.I. RTE.	SECTION	COUNTY	TOTAL SHEETS	SHEET NO.
	55	(99-1&2) R-6	WILL	756	543
FED. ROAD DIST. NO.			ILLINOIS FED. AID PROJECT		
CONTRACT NO. 60F12					