

DATE	
BY	
FINAL SURVEY	
NOTE BOOK	
AREAS CHECKED	
NO.	

DATE	
BY	
ORIGINAL SURVEY	
NOTE BOOK	
AREAS CHECKED	
NO.	

McDonough Associates Inc.
 Engineers / Architects
 100 East Randolph Street, Chicago, Illinois 60601

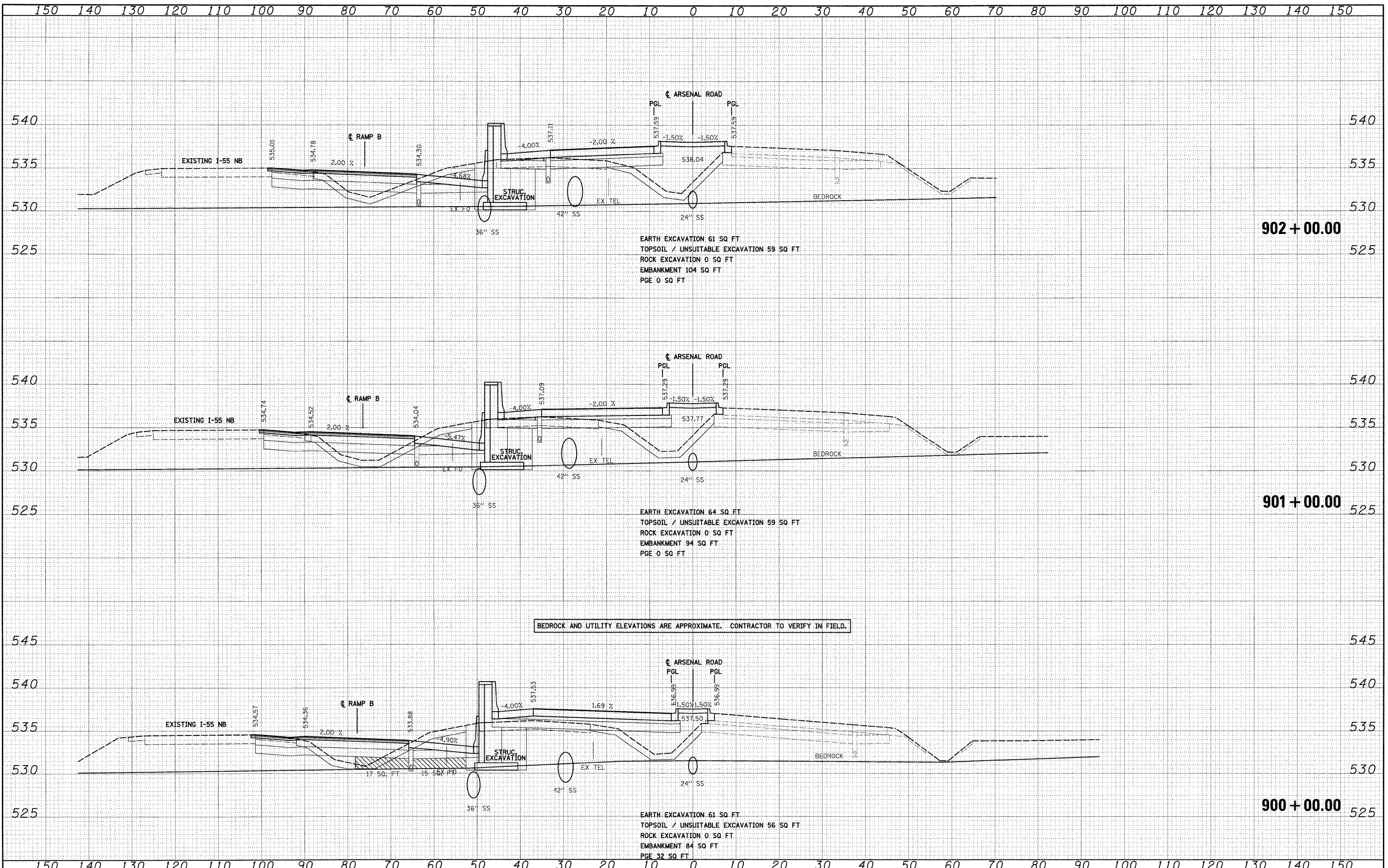

EARTH EXCAVATION 61 SQ FT
 TOPSOIL / UNSUITABLE EXCAVATION 59 SQ FT
 ROCK EXCAVATION 0 SQ FT
 EMBANKMENT 104 SQ FT
 PGE 0 SQ FT

EARTH EXCAVATION 64 SQ FT
 TOPSOIL / UNSUITABLE EXCAVATION 59 SQ FT
 ROCK EXCAVATION 0 SQ FT
 EMBANKMENT 94 SQ FT
 PGE 0 SQ FT

BEDROCK AND UTILITY ELEVATIONS ARE APPROXIMATE. CONTRACTOR TO VERIFY IN FIELD.

EARTH EXCAVATION 61 SQ FT
 TOPSOIL / UNSUITABLE EXCAVATION 56 SQ FT
 ROCK EXCAVATION 0 SQ FT
 EMBANKMENT 84 SQ FT
 PGE 32 SQ FT

FILE NAME = D:\16\F12-SHT-XSSHT01.dgn	USER NAME = TKLuegel	DESIGNED - TRK	REVISED -	STATE OF ILLINOIS DEPARTMENT OF TRANSPORTATION	ARSENAL ROAD CROSS SECTIONS	F.A.I. RTE. 55	SECTION 99-21B-2B-1	COUNTY WILL	TOTAL SHEETS 756	SHEET NO. 602	CONTRACT NO. 60F12		
PLOT SCALE = 1:10	CHECKED - DLT	REVISOR -	REVISOR -			SCALE: 1"=10'H; 1"=5'V	SHEET NO. 1 OF 62 SHEETS	STA. 900+00.00 TO STA. 902+00.00	ILLINOIS FED. AID PROJECT				
PLOT DATE = 2/3/2011	DATE - 2/4/11	REVISOR -	REVISOR -										