

DATE	
BY	
FINAL SURVEY	
SURVEYED	
NOTE BOOK	
AREAS CHECKED	
NO.	

DATE	
BY	
ORIGINAL SURVEY	
SURVEYED	
NOTE BOOK	
AREAS CHECKED	
NO.	

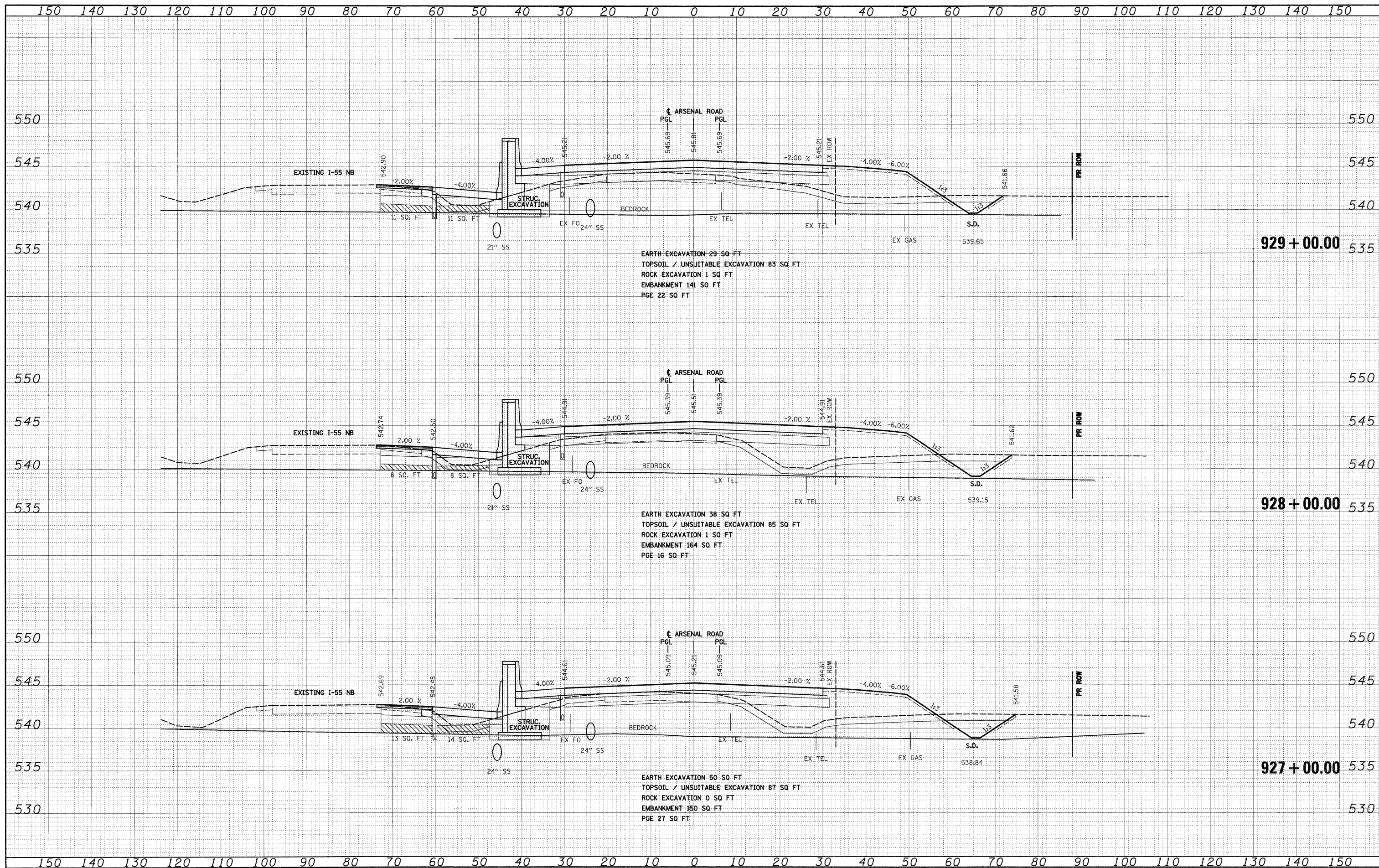

McDonough Associates Inc.  
Engineers / Architects  
100 East Randolph Street, Chicago, Illinois 60601



FILE NAME = D:\162F12-SHT-XSSHT01.dgn  
USER NAME = TKluegel

DESIGNED - TRK	REVISED -
DRAWN - TRK	REVISED -
CHECKED - DLT	REVISED -
DATE - 2/4/11	REVISED -

**STATE OF ILLINOIS  
DEPARTMENT OF TRANSPORTATION**

**ARSENAL ROAD CROSS SECTIONS**  
SCALE: 1"=10'H; 1"=5'V SHEET NO. 14 OF 62 SHEETS STA. 927+00.00 TO STA. 929+00.00

F.A.I. RTE. 55	SECTION 99-2H-B-2B-1	COUNTY WILL	TOTAL SHEETS 756	SHEET NO. 615
CONTRACT NO. 60F12			ILLINOIS FED. AID PROJECT	