

FINAL SURVEY	SURVEYED	BY	DATE
NOTE BOOK	TEMP. DATE		
NO.	AREAS CHECKED		

ORIGINAL SURVEY	SURVEYED	BY	DATE
NOTE BOOK	TEMP. DATE		
NO.	AREAS CHECKED		

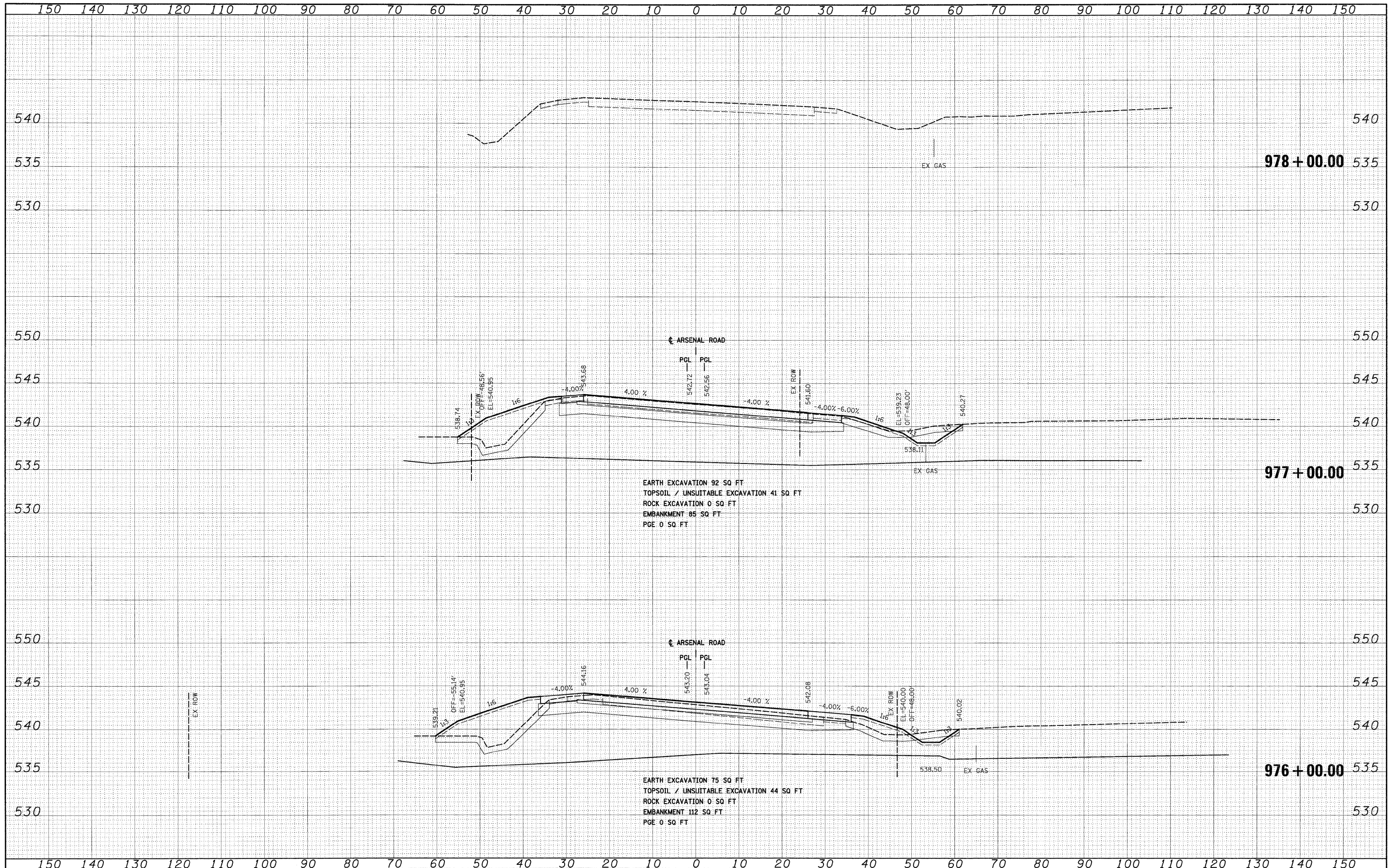

Engineers/Architects
191 East Randolph Street, Chicago, Illinois 60601



FILE NAME = D:\62\F12-SHT-XSSH101.dgn
 USER NAME = TKLuegel
 PLOT SCALE = 1"=10'
 PLOT DATE = 2/3/2011

DESIGNED - TRK	REVISED -
DRAWN - TRK	REVISED -
CHECKED - DLT	REVISED -
DATE - 2/4/11	REVISED -

DESIGNED - TRK	REVISED -
DRAWN - TRK	REVISED -
CHECKED - DLT	REVISED -
DATE - 2/4/11	REVISED -

**STATE OF ILLINOIS
DEPARTMENT OF TRANSPORTATION**

ARSENAL ROAD CROSS SECTIONS

SCALE: 1"=10'H; 1"=5'V SHEET NO. 49 OF 62 SHEETS STA. 976+00.00 TO STA. 978+00.00

F.A.1 RTE.	SECTION	COUNTY	TOTAL SHEETS	SHEET NO.
55	99-2HB-2B-1	WILL	756	650
CONTRACT NO. 60F12				
FED. ROAD DIST. NO. 1 ILLINOIS FED. AID PROJECT				