









LEGEND

-  WORK AREA
-  IMPACT ATTENUATORS, TEMPORARY (FULLY REDIRECTIVE, NARROW), TEST LEVEL 3
-  TYPE III BARRICADE
-  TEMPORARY CONCRETE BARRIER
-  DRUM WITH STEADY BURN MONODIRECTIONAL LIGHT AT 25' CENTERS.
-  DIRECTION INDICATOR BARRICADE WITH STEADY BURN MONODIRECTIONAL LIGHT AT 20' CENTERS.
-  SIGN
-  ARROW BOARD

STAGE II CONSTRUCTION:

1. CONSTRUCT PROPOSED PAVEMENT FROM STA. 96+40.00 TO 97+11.48 & STA. 106+33.44 TO 106+68.00 UNDER HIGHWAY STANDARD 701301-04.
2. SHIFT TRAFFIC TO NEW EB LANES, PROVIDING ONE 11' LANE IN EACH DIRECTION UNDER HIGHWAY STANDARD 701606-07 AND AS SHOWN IN THE PLANS.
3. REMOVE TEMPORARY PAVEMENT, TEMPORARY STEEL PLATE BEAM GUARDRAIL, TYPE A, TEMPORARY TRAFFIC BARRIER TERMINAL, TYPE 1 AND TEMPORARY IMPACT ATTENUATORS PROVIDED DURING PRE-STAGE.
4. CONSTRUCT NORTH HALF OF PROPOSED TRIPLE-BARREL BOX CULVERT AND RETAINING WALL.
5. CONSTRUCT REMAINING PROPOSED ROADWAY, AND NORTH SIDE PROPOSED CURB & GUTTER, SIDEWALKS, GRADING, AND ROADWAY LIGHTING.
6. ALL LEFT TURNS SHALL BE PROHIBITED AT 36TH & 39TH AVE. INTERSECTIONS.
7. PROVIDE HIGHWAY STANDARD 701801-04 AT 36TH & 39TH AVENUE INTERSECTIONS.

STAGE III

1. PLACE FINAL PROPOSED PAVEMENT MARKINGS AND RAISED REFLECTIVE PAVEMENT MARKERS UNDER HIGHWAY STANDARD 701311-03.
2. REMOVE BAGGING FOR TRAFFIC SIGNALS. TURN ON AND RE-OPTIMIZE EXISTING TRAFFIC SIGNAL AT LAKE STREET & 36TH AVENUE.

NOTES:

1. SIGNS WITH FLASHING BEACONS AS SHOWN IN THE PLANS SHALL BE INCLUDED IN THE CONTRACT COST FOR HIGHWAY STANDARD 701606-07.
2. PROPOSED PCC PAVEMENT, PCC SIDEWALKS, PCC DRIVEWAYS AND CONCRETE CURB AND GUTTER MAY BE POURED IN STAGES AND AS DIRECTED BY THE ENGINEER TO ENSURE ACCESS TO DRIVEWAYS.

NO PARKING SIGNS TO BE PLACED; LOCATION TO BE FIELD DETERMINED AND APPROVED BY THE ENGINEER

ENTRANCE DRUMS SHOWN FOR INFORMATION ONLY; FINAL LOCATION TO BE ADJUSTED AS NECESSARY IN THE FIELD (TYP.)

PROPOSED INCIDENTAL HOT-MIX ASPHALT SURFACING TO BE PLACED FROM STA. 100+80 TO 105+00 FOR TEMPORARY ACCESS TO DRIVEWAYS

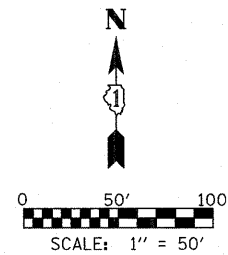
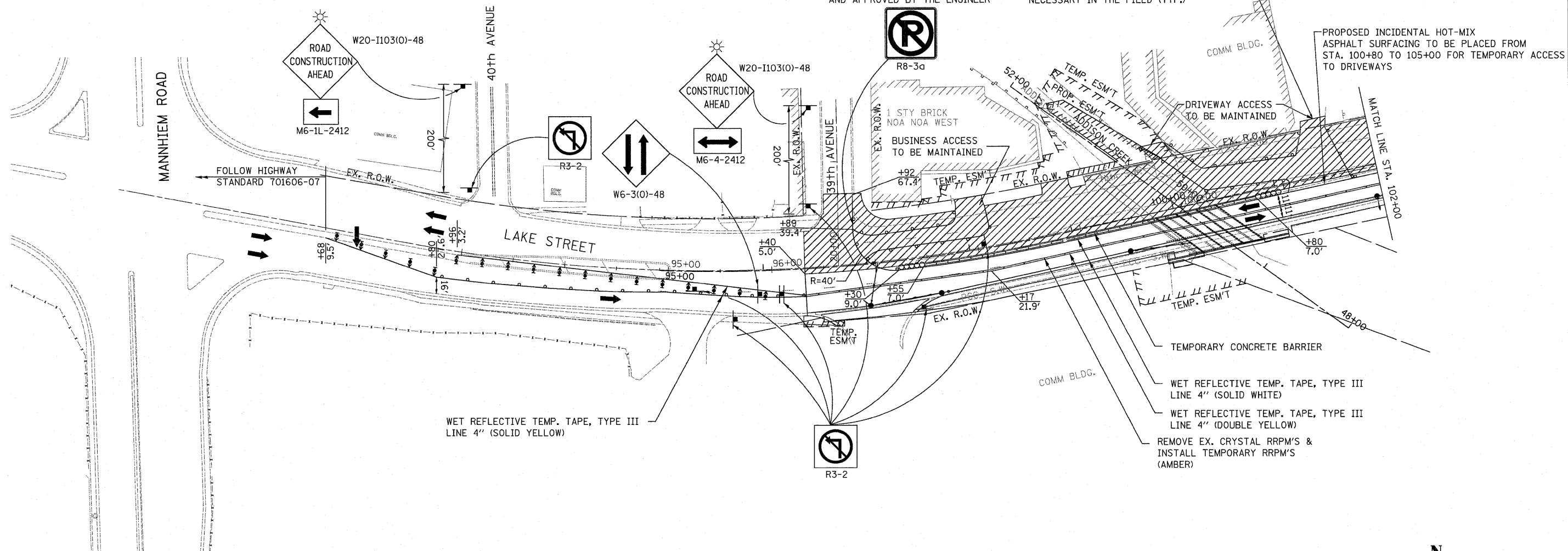

FILE NAME =	DESIGNED - ST	REVISED -
#FILE#	DRAWN - ST	REVISED -
USER NAME = #USER#	CHECKED - FML	REVISED -
PLOT DATE = #DATE#	DATE - 01/2010	REVISED -



**STATE OF ILLINOIS
DEPARTMENT OF TRANSPORTATION**

MAINTENANCE OF TRAFFIC - STAGE II LAKE STREET OVER ADDISON CREEK	
SCALE: 1" = 50'	SHEET NO. 1 OF 2 SHEETS
STA. 91+68 TO STA. 102+00	

F.A.U. RTE.	SECTION	COUNTY	TOTAL SHEETS	SHEET NO.
3537	3264-T	COOK	110	21
FED. ROAD DIST. NO.			[ILLINOIS] FED. AID PROJECT	
			CONTRACT NO. 60H44	