

STORM STRUCTURES

- ① CB TA 4' DIA
TIF OL
STA. 97+19.0, 33.1' LT
RIM = 636.40
- ② CB TA 4' DIA
T24F&G
STA. 97+67.6, 36.1' RT
RIM = 636.58
- ③ CB TA 4' DIA
T24F&G
STA. 97+00, 40.3' RT
RIM = 636.17
- ④ CB TA 4' DIA
TIF OL
STA. 97+80.45, 47.78' LT
RIM = 636.00
INSTALL OVER EX. LINE
V.I.F.
- ⑤ CB TA 4' DIA
TIF OL
STA. 99+57.59, 47.76' LT
RIM = 636.20
INSTALL OVER EX. LINE
V.I.F.
- ⑥ CB TA 4' DIA.
T24F&G
STA. 99+09.8, 31' LT
RIM = 637.38
E. INV=632.90
- ⑦ CB TA 4' DIA.
T24F&G
STA. 99+51.1, 31' RT
RIM = 637.56
E. INV= 633.09
- ⑧ CB TC
TIF OL
STA. 100+27.33, 38.59' LT
RIM = 636.20
INV=632.72
- ⑨ CB TC
TIF OL
STA. 100+71.33, 37.93' LT
RIM = 636.20
INV=633.16
- ⑩ CB TC
TIF OL
STA. 101+15.33, 37.64' LT
RIM = 636.20
INV=633.6
- ⑪ CB TA 4' DIA.
T24F&G
STA. 101+04.6, 31' LT
RIM = 637.59
- ⑫ CB TA 4' DIA.
T24F&G
STA. 101+94.6, 31' RT
RIM = 636.74
- ⑬ CB TA 4' DIA.
T24F&G
STA. 102+60.7, 31' LT
RIM = 636.37
- ⑭ CB TC
TIF OL
STA. 103+13, 36.0' LT
RIM = 634.49
- ⑮ CB TA 4' DIA.
T24F&G
STA. 103+09.7, 31' RT
RIM = 636.10
- ⑯ CB TA 4' DIA.
T24F&G
STA. 103+82.5, 31' LT
RIM = 635.69
N. INV=631.10
- ⑰ CB TA 4' DIA.
T24F&G
STA. 104+34.6, 31' RT
RIM = 635.40
- ⑱ CB TA 4' DIA.
TIF OL
STA. 106+61.9, 43' LT
RIM = 633.71

V.I.F. VERIFY IN FIELD.
M.E. MATCH EXISTING

NOTE

THE DIAMETER AND LOCATION OF THE EXISTING STORM SEWER SYSTEM, AS SHOWN IN THE PARKWAY OF LAKE STREET, ARE ESTIMATED DUE TO POTENTIALLY BURIED MANHOLE STRUCTURES NOT FOUND IN FIELD AND DRAINAGE STRUCTURES FILLED WITH DEBRIS. CONTRACTOR TO FIELD VERIFY LOCATION AND DIAMETERS PRIOR TO ORDERING MATERIAL.

STORM PIPES

- STM 1- 71 LF STORM SEWER, CLASS A, TYPE 1 12" @ 1.00% MIN.
- STM 2- 64 LF STORM SEWER, CLASS A, TYPE 1 12" @ 1.00% MIN.
- STM 3- 6 LF STORM SEWER, CLASS A, TYPE 1 12" @ 1.00% MIN.
- STM 4- 38 LF STORM SEWER, CLASS A, TYPE 2 12" @ 1.00%
- STM 5- 57 LF STORM SEWER, CLASS A, TYPE 2 12" @ 1.00%
- STM 6- 18 LF STORM SEWER, CLASS A, TYPE 2 12" @ 1.00%
- STM 7- 39 LF STORM SEWER, CLASS B, TYPE 1 8" @ 1.00%
- STM 8- 39 LF STORM SEWER, CLASS B, TYPE 1 8" @ 1.00%
- STM 9- 6 LF STORM SEWER, CLASS A, TYPE 1 12" @ 1.00% MIN.
- STM 10- 9 LF STORM SEWER, CLASS A, TYPE 1 12" @ 1.00% MIN.
- STM 11- 2 LF STORM SEWER, CLASS A, TYPE 1 12" @ 1.00% MIN.
- STM 12- 47 LF STORM SEWER, CLASS A, TYPE 1 12" @ 1.00% MIN.
- STM 13- 10 LF STORM SEWER, CLASS A, TYPE 1 12" @ 1.00% MIN.
- STM 14- 10 LF STORM SEWER, CLASS B, TYPE 2 8" @ 1.00%
- STM 15- 5 LF STORM SEWER, CLASS A, TYPE 1 12" @ 1.00% MIN.
- STM 16- 2 LF STORM SEWER, CLASS A, TYPE 1 12" @ 1.00% MIN.
- STM 17- 4 LF STORM SEWER, CLASS B, TYPE 2 8" @ 1.00% MIN.

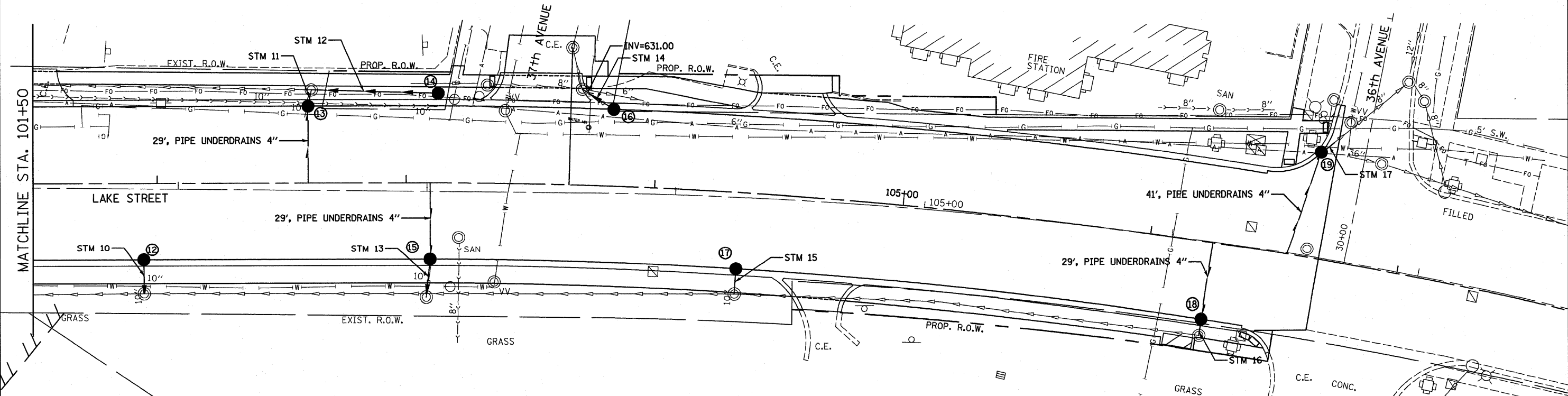

FILE NAME = G:\ENR\06-6798-17 Lake St Triple Box Culvert\3D\Civil\Sheet\018144-ah-train.dgn

Wight	USER NAME = #USER#	DESIGNED - KAC	REVISED -	STATE OF ILLINOIS DEPARTMENT OF TRANSPORTATION	PROPOSED DRAINAGE PLAN LAKE STREET OVER ADDISON CREEK			F.A.U. RTE. 3537	SECTION 3264-T	COUNTY COOK	TOTAL SHEETS 110	SHEET NO. 25
	PLOT SCALE = #SCALE#	CHECKED - KAC	REVISED -		SCALE: 1" = 20'	SHEET NO. 1 OF 1 SHEETS	STA. 96+40 TO STA. 106+68	CONTRACT NO. 60H44				
	PLOT DATE = 1/26/2011	DATE -	REVISED -					ILLINOIS FED. AID PROJECT				