

STATE OF ILLINOIS  
DEPARTMENT OF TRANSPORTATION

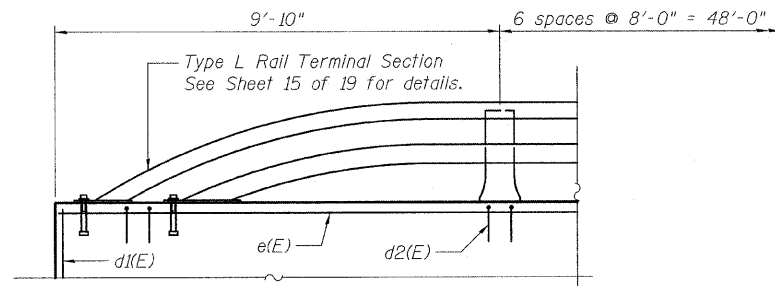

**NORTH PARAPET EAST END**

Looking South

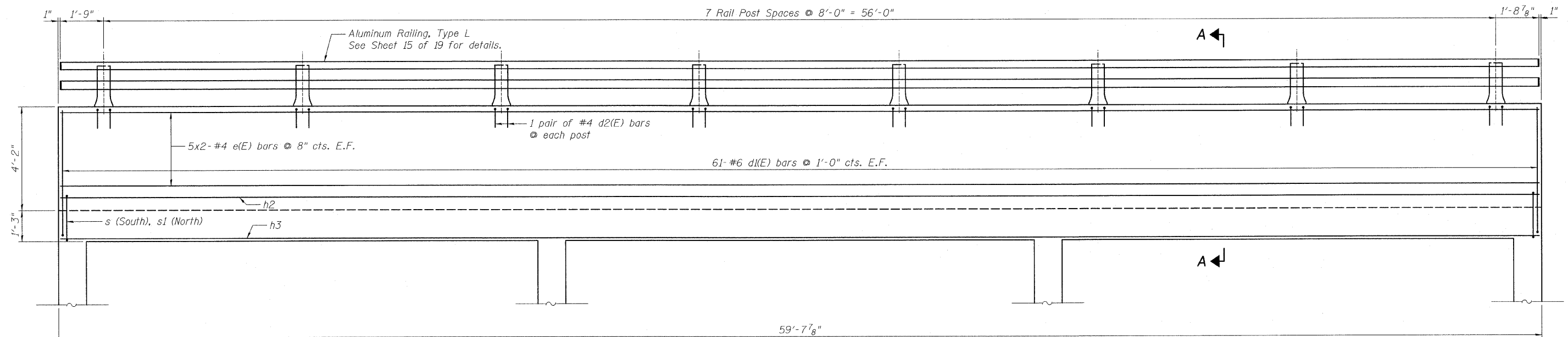

**PARAPET ELEVATION**

South Parapet Looking South (North Parapet Identical Unless Noted Otherwise)

**NOTES:**

1. For Bill of Material see Sheet 6.
2. For lap Length see General Notes on Sheet 2.
3. Barrel reinforcement not shown for clarity.
4. For Section A-A see Sheet 5.
5. Bars indicated thus 45x2-#9 etc. indicates 45 lines of bars with 2 lengths per line.
6. Minimum bar lap length for #4 epoxy coated bars in parapet is 2'-11".

**PARAPET ELEVATION  
STRUCTURE NO. 016-2630**

DESIGNED	MAS
CHECKED	BJM
DRAWN	MAS
CHECKED	BRT



**Wight & Company**  
2500 North Frontage Road, Darien, IL 60561  
630.969.7000 630.969.7979 fax  
Design Firm Registration 184-000451

SHEET NO. 8 19 SHEETS	F.A.U. RTE.	SECTION	COUNTY	TOTAL SHEETS	SHEET NO.
	3537	3264-T	COOK	110	52
CONTRACT NO. 60H44					
ILLINOIS FED. AID PROJECT					

3/17/2011 10:22:51 AM Default G:\ENG\06-6790-17 Lake St. Triple Box Culvert\CAD\Structures\Sh1\0162630-60H4-008-ParapetCulvert.dgn