

QUANTITY  
 4 (100) LINE = 64.1 ft. (19.7 m)  
 21.1 sq. ft. (1.97 sq. m)

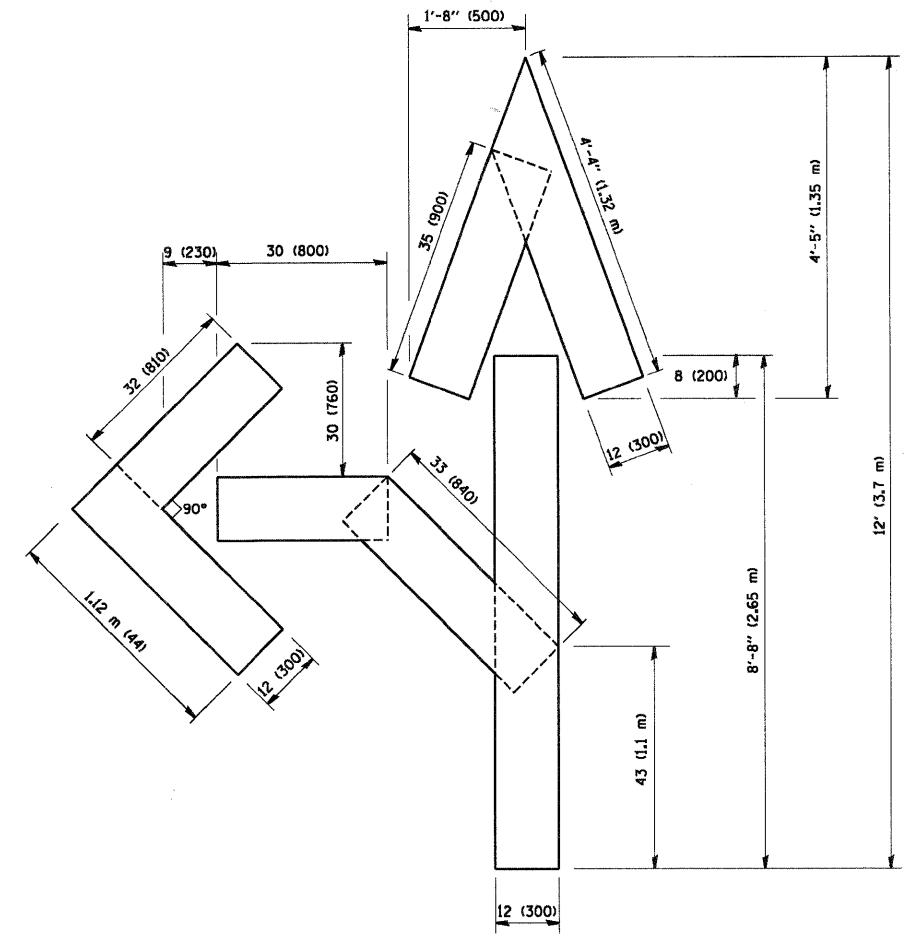

QUANTITY  
 4 (100) LINE = 82.5 ft. (25.3 m)  
 27.5 sq. ft. (2.53 sq. m)

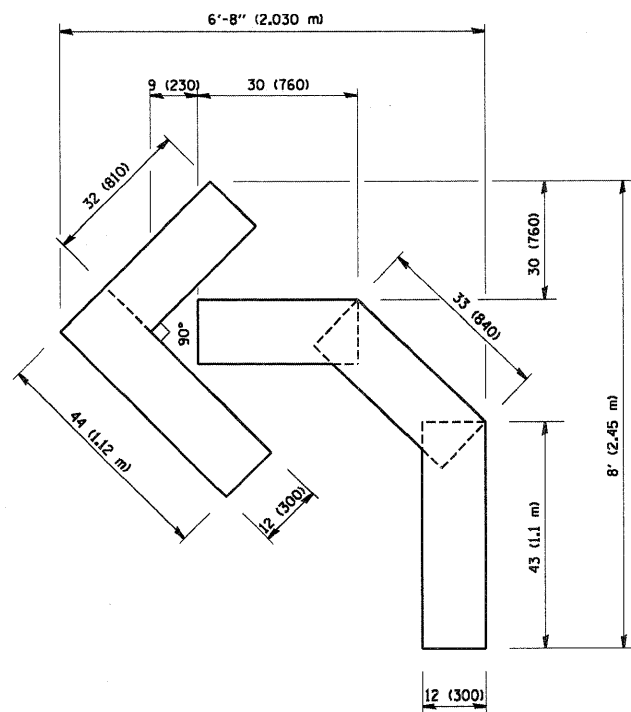

QUANTITY  
 4 (100) LINE = 45.5 ft. (13.9 m)  
 15.2 sq. ft. (1.39 sq. m)

All dimensions are in inches (millimeters) unless otherwise shown.

FILE NAME = F:\CBBEL\_WEST\_Projects\2005\05-0147\_IL173\Civil\N.dgn, Sht\160123-ent-01.sds\TC16.dgn

FILE NAME =	USER NAME = gegljanobt	DESIGNED -	REVISED -T. RAMMACHER 06-05-96
W:\diststd\22x34\tc16.dgn		DRAWN -	REVISED -T. RAMMACHER 11-04-97
PLOT SCALE = 50.0000' / IN.		CHECKED -	REVISED -T. RAMMACHER 03-02-98
PLOT DATE = 1/4/2008	DATE = 09-18-94		REVISED -E. GOMEZ 08-28-00

STATE OF ILLINOIS  
 DEPARTMENT OF TRANSPORTATION

PAVEMENT MARKING LETTERS AND SYMBOLS  
 FOR TRAFFIC STAGING

SCALE: NONE SHEET NO. 1 OF 1 SHEETS STA. TO STA.

F.A.P. RTE.	SECTION	COUNTY	TOTAL SHEETS	SHEET NO.
303	132 B-2	McHENRY	106	92
TC-16			CONTRACT NO. 60129	
FED. ROAD DIST. NO. 1 ILLINOIS FED. AID PROJECT				