

| | | | | |
|-----------------------|----------------|--------------------|--------------|-----------|
| F.A.S. RTE. | SECTION | COUNTY | TOTAL SHEETS | SHEET NO. |
| 0130 | 01-00266-00-BR | KANE | 70 | 1 |
| FED. ROAD DIST. NO. 1 | ILLINOIS | CONTRACT NO. 63196 | | |

STATE OF ILLINOIS
DEPARTMENT OF TRANSPORTATION
DIVISION OF HIGHWAYS

PLANS FOR PROPOSED FEDERAL AID HIGHWAY

F.A.S. ROUTE 0130 (BIG TIMBER ROAD)
BIG TIMBER ROAD OVER TYLER AND PINGREE CREEKS
BRIDGE REHABILITATION AND CREEK RELOCATION
SECTION 01-00266-00-BR
PROJECT BRM-8003(043)
KANE COUNTY
JOB # : C-91-192-01

FOR INDEX OF SHEETS AND
STATE HIGHWAY STANDARDS,
SEE SHEET NO. 2



PROGRAM AND OFFICE MANAGER: CHARLES F. RIDDLE, P.E. 847-705-4406 SCHAUMBURG, IL

TRAFFIC DATA:
ADT = 15,000 (2030); 4,000 (2010)
POSTED SPEED = 50 MPH (DS=60MPH)
DESIGN DESIGNATION = MAJOR COLLECTOR

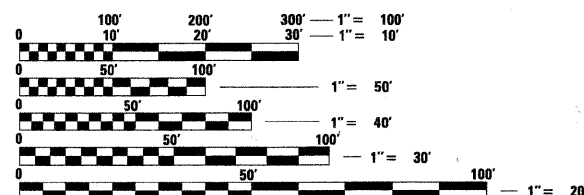

FULL SIZE PLANS HAVE BEEN PREPARED USING STANDARD ENGINEERING SCALES. REDUCED SIZED PLANS WILL NOT CONFORM TO STANDARD SCALES. IN MAKING MEASUREMENTS ON REDUCED PLANS, THE ABOVE SCALES MAY BE USED.

J.U.L.I.E.
JOINT UTILITY LOCATION INFORMATION FOR EXCAVATION
1-800-892-0123
OR 811 T42N, R7E, S26.27

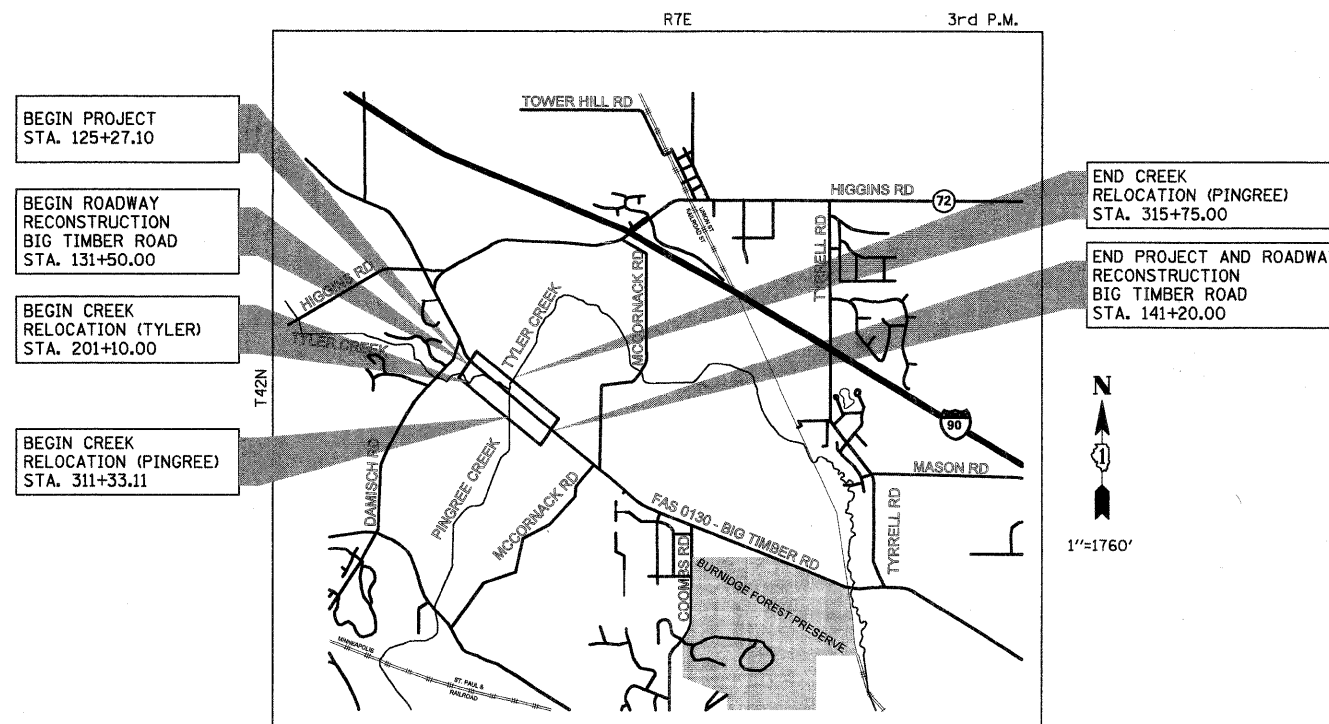

LOCATION MAP

GROSS LENGTH OF PROJECT = 1593 FEET (0.302 MILES)
NET LENGTH OF PROJECT = 1593 FEET (0.302 MILES)

STATE OF ILLINOIS
DEPARTMENT OF TRANSPORTATION
DIVISION OF HIGHWAYS

APPROVED JANUARY 20 20 11
[Signature]
KANE COUNTY DIVISION OF TRANSPORTATION COUNTY ENGINEER TITLE

PASSED FEBRUARY 15 20 11
[Signature]
DISTRICT 4 ENGINEER OF LOCAL ROADS AND STREETS

RELEASING FOR BID
BASED ON LIMITED
REVIEW FEBRUARY 15, 20 11
[Signature]
DEPUTY DIRECTOR OF HIGHWAYS, REGION 1 ENGINEER

CBCE CHRISTOPHER B. BURKE ENGINEERING, LTD.
9575 W. Higgins Road, Suite 600
Rosemont, Illinois 60018
(847) 823-0500

PROFESSIONAL DESIGN FIRM NO.: 184-001175
EXPIRATION DATE: APRIL 30, 2011

PRINTED BY THE AUTHORITY OF THE STATE OF ILLINOIS

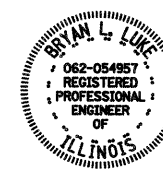

January 19, 2011
[Signature]
BRYAN L. LUKE
ILLINOIS REGISTRATION No. 062-054957
EXPIRATION DATE: 11/30/11

CONTRACT NO. 63196