

**TOP OF WEB ELEVATIONS**  
(For Fabrication use only)

Beam	W. Abut.	E. Abut.
1	896.068	896.220
2	896.218	896.348
3	896.367	896.476
4	896.515	896.603
5	896.662	896.728
6	896.808	896.853
7	896.920	896.944
8	897.032	897.034
9	896.962	896.943
10	896.872	896.831
11	896.753	896.691
12	896.628	896.544
13	896.501	896.396

- NOTES:
1. N.T.R. designates members subject to the supplemental requirements for notch toughness (Zone 2).
  2. All structural steel for 34" plate girder beams shall be AASHTO M270 Grade 50.
  3. Structural steel for diaphragms can be AASHTO M270 Grade 36.
  3. Number of Shear Studs required = 3,354

**FRAMING PLAN**

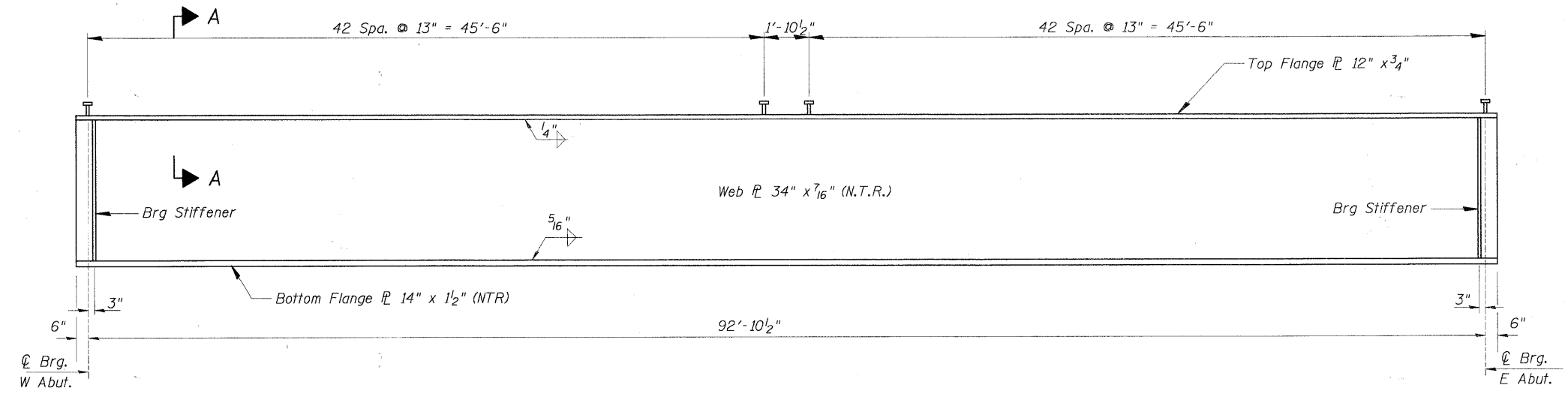

**GIRDER ELEVATION**

**CHRISTOPHER B. BURKE ENGINEERING, LTD.**  
 9575 W. Higgins Road, Suite 600  
 Rosemont, Illinois 60018  
 (847) 823-0500

F.A.S. 0130 - BIG TIMBER ROAD  
 OVER TYLER AND PINGREE CREEK  
 SECTION 01-00266-00-BR  
 KANE COUNTY, ILLINOIS  
 STA. 135+80.00  
 STRUCTURE NO. 045-3323

FILE NAME =	USER NAME = BLUKE	DESIGNED - MM	REVISED -	<b>STATE OF ILLINOIS DEPARTMENT OF TRANSPORTATION</b>	<b>FRAMING PLAN AND DETAILS</b>	F.A.S. RTE.	SECTION	COUNTY	TOTAL SHEETS	SHEET NO.
N:\kanecounty\04198\STRUCT.2\04198-S13.SHT		DRAWN - PDR	REVISED -			0130	01-00266-00-BR	KANE	70	50
PLOT SCALE = 1"		CHECKED - MM	REVISED -			CONTRACT NO. 63196				
PLOT DATE = 2/7/2011		DATE -	REVISED -			FED. ROAD DIST. NO. 1 [ILLINOIS] FED. AID PROJECT BRM-80031043				