

- NOTES:**
- 1) DRIVEWAY LIMITS ARE 2 FEET FROM EDGE OF SIDEWALK, UNLESS OTHERWISE NOTED.
 - 2) THE REMOVAL AND DISPOSAL OF ALL STORM SEWERS, CULVERT PIPES, HEADWALLS, RAILROAD TIES (REGARDLESS OF SIZE OR TYPE) UNDER EXISTING PAVEMENT OR IN PARKWAYS SHALL BE INCLUDED IN THE COST OF REMOVAL AND DISPOSAL OF UNSUITABLE MATERIAL PAY ITEM AND WILL NOT BE PAID FOR SEPARATELY.
 - 3) FINE GRADING OF PARKWAY TO PROVIDE POSITIVE DRAINAGE SHALL BE INCLUDED IN THE COST OF SEEDING CLASS I (SPECIAL).
 - 4) ALL EXCAVATED MATERIALS MUST BE REMOVED FROM THE JOBSITE AT THE END OF EACH WORK DAY.

LEGEND

- [A] STRUCTURE TO BE ADJUSTED
- [R] STRUCTURE TO BE RECONSTRUCTED
- [P] STRUCTURE TO BE RECONSTRUCTED WITH NEW FRAME AND LID
- * DETECTABLE WARNINGS ON SIDEWALK RAMPS
- [X] SIDEWALK REMOVAL
- (TRP) TREE ROOT PRUNING
- TEMPORARY FENCE

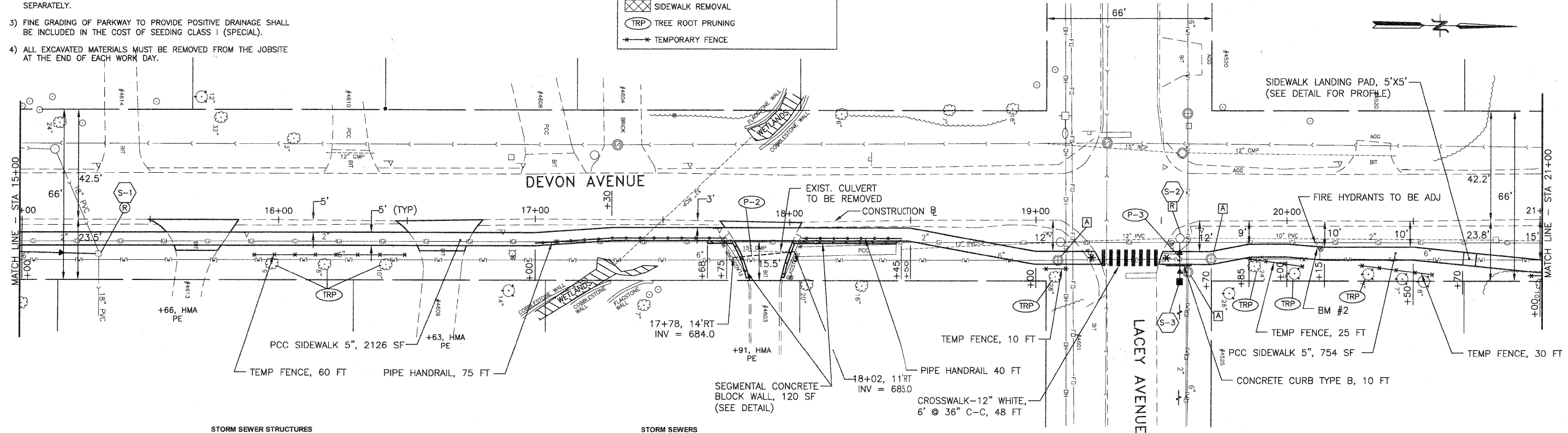

STORM SEWER STRUCTURES

STRUCT. NO.	STATION	OFFSET	STRUCTURE TYPE	RIM	INVERT			
					NORTH	SOUTH	EAST	WEST
S-1	15+30	13' RT	MAN RECON NEW T1F OL	687.20	-	683.95	681.21	681.31
S-2	19+57	7' RT	MAN RECON	694.80	693.06	692.76	693.00	-
S-3	19+57	24' RT	INLETS TA T&G	694.80	-	-	-	693.30

STORM SEWERS

PIPE NO.	LENGTH (FOOT)	DESCRIPTION	MATERIAL	TYPE	DIA. (IN.)	SLOPE %	T&F (CU. YD.)
P-1	130	STORM SEW CL B	PVC SDR26	1	12	3.50	10
P-2	25	STORM SEW CL B	PVC SDR26	1	15	4.00	6
P-3	15	STORM SEW CL B	PVC SDR26	1	12	2.00	2

FILE NAME = USER NAME = PLOT SCALE = PLOT DATE =	DESIGNED -- BDH	REVISED --	STATE OF ILLINOIS DEPARTMENT OF TRANSPORTATION	GEOMETRIC PLAN DEVON AVENUE	SCALE: 1"=20' SHEET NO. 6 OF 26 SHEETS STA. 10+00 TO STA. 21+00	F.A.U. RTE. - SECTION 10-00056-00-SW COUNTY DuPAGE TOTAL SHEETS 26 SHEET NO. 6 CONTRACT NO. 63537 ILLINOIS FED. AID PROJECT
	DRAWN -- SMP	REVISED --				
	CHECKED -- BDH	REVISED --				
	DATE -- 9-29-10	REVISED --				

JAMES J. BENES & ASSOCIATES, INC.
 950 Warrenville Road, Suite 101, Lisle, Illinois 60532
 Tel. (630) 719-7570 • Fax (630) 719-7589