

F.A.U. RTE.	SECTION	COUNTY	TOTAL SHEETS	SHEET NO.
2756	09-00029-00-SW	COOK	14	1
FED. ROAD DIST. NO. 1 ILLINOIS		FED. AID PROJECT		

CONTRACT NO. 63548

STATE OF ILLINOIS
DEPARTMENT OF TRANSPORTATION
DIVISION OF HIGHWAYS
PLANS FOR PROPOSED
FEDERAL AID HIGHWAY
FAU 2756 (80TH AVENUE)
FROM 121ST STREET TO 123RD STREET (McCARTHY ROAD)
SIDEWALK PROJECT
Section No.: 09-00029-00-SW
Project No.: CMM-9003(241)
VILLAGE OF PALOS PARK
COOK COUNTY
JOB NO.: C-91-327-09



INDEX OF SHEETS

SHEET NO.	DESCRIPTION
1	TITLE SHEET
2	GENERAL NOTES, IDOT STANDARDS, AND TYPICAL SECTIONS
3	SUMMARY OF QUANTITIES AND EARTHWORK QUANTITIES
4	ALIGNMENT, TIES AND BENCHMARKS
5-6	EXISTING CONDITIONS AND REMOVAL PLAN
7-8	PROPOSED IMPROVEMENTS AND TYPICAL SECTIONS
9	CONSTRUCTION DETAILS
10-14	CROSS SECTIONS

TRAFFIC DATA
ADT (2010) = 8000
SPEED LIMIT = 35 MPH
FUNCTIONAL CLASS = URBAN COLLECTOR

CHRISTOPHER B. BURKE ENGINEERING LTD.
 9575 West Higgins Road, Suite 600
 Rosemont, Illinois 60018 (847) 823-0500

PROGRAM AND OFFICE ENGINEER: CHAD RIDDLE
 201 W. CENTER COURT
 SCHAUMBURG, ILLINOIS 60196-1096
 (847) 705-4406

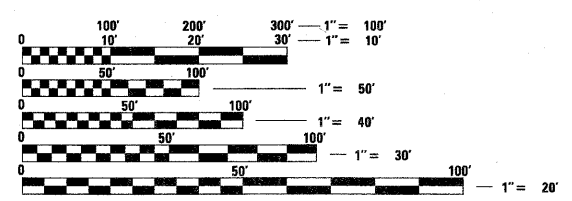

FULL SIZE PLANS HAVE BEEN PREPARED USING STANDARD ENGINEERING SCALES. REDUCED SIZED PLANS WILL NOT CONFORM TO STANDARD SCALES. IN MAKING MEASUREMENTS ON REDUCED PLANS, THE ABOVE SCALES MAY BE USED.

J.U.L.I.E.
 JOINT UTILITY LOCATION INFORMATION FOR EXCAVATION
 1-800-892-0123 OR 811

CONTRACT NO. 63548

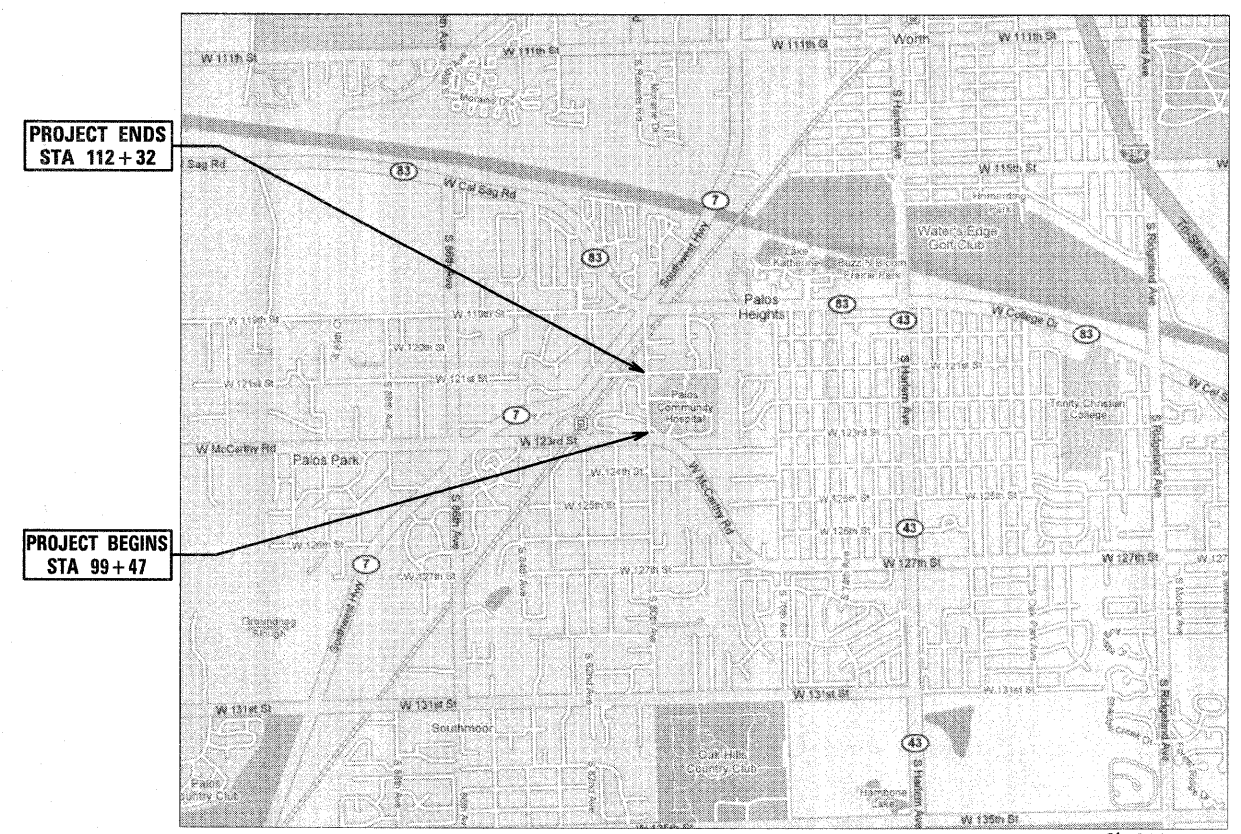

PROJECT ENDS
STA 112+32

PROJECT BEGINS
STA 99+47

T37N R12E SEC 26
LOCATION MAP
 N.T.S.

NET LENGTH OF PROJECT = 1285 LINEAL FEET (0.24 MILES)
GROSS LENGTH OF PROJECT = 1285 LINEAL FEET (0.24 MILES)

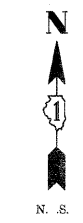

DAVID G. VANDERVELDE
 ILLINOIS REGISTRATION No. 062-035898 ENGINEER
 EXPIRATION DATE: 11/30/2011
 PRINTED BY AUTHORITY OF THE STATE OF ILLINOIS

STATE OF ILLINOIS
DEPARTMENT OF TRANSPORTATION
DIVISION OF HIGHWAYS
 APPROVED January 31, 2011

MAYOR
VILLAGE OF PALOS PARK
 PASSED FEB 15, 2011

DISTRICT 1 ENGINEER OF LOCAL ROADS AND STREETS
 RELEASING FOR
 BID BASED ON
 LIMITED REVIEW FEBRUARY 15, 2011

DEPUTY DIRECTOR OF HIGHWAYS
REGION ONE ENGINEER

PRINTED BY THE AUTHORITY OF THE STATE OF ILLINOIS

SPECIFICATIONS, STANDARDS AND SPECIAL PROVISIONS

STAKING

THE CONTRACTOR SHALL PROTECT AND CAREFULLY PRESERVE ALL SECTION OR SUBSECTION MONUMENTS OR PROPERTY OR REFERENCE MARKERS UNTIL THE VILLAGE, HIS AGENT OR AN AUTHORIZED SURVEYOR HAS WITNESSED OR OTHERWISE REFERENCED THEIR LOCATIONS.

ALL RADII FOR PROPOSED CURB AND GUTTER ARE TO THE EDGE OF PAVEMENT UNLESS OTHERWISE NOTED, AND SHALL BE AS INDICATED ON THE PLANS, ELEVATIONS SHOWN AT POINT OF CURVE, ETC. IS EDGE OF PAVEMENT UNLESS OTHERWISE NOTED.

ALL OFFSET LOCATIONS GIVEN ON THE DETAILED PLANS FOR STRUCTURES, ETC., ARE FROM THE PROPOSED BASE LINE OF CONSTRUCTION. FOR STRUCTURES IN THE CURB LINE, THE OFFSET REFERENCES THE EDGE OF PAVEMENT. ALL OTHER STRUCTURES ARE TO THE CENTER OF STRUCTURE

MISCELLANEOUS

ACCESS: THE CONTRACTOR SHALL PROVIDE ACCESS TO ABUTTING PROPERTY AT ALL TIMES DURING THE CONSTRUCTION OF THIS PROJECT, EXCEPT FOR PERIODS OF SHORT DURATION. THE COST TO PROVIDE ACCESS SHALL BE INCIDENTAL TO THE CONTRACT

DIMENSIONS: IT SHALL BE THE CONTRACTOR'S RESPONSIBILITY TO VERIFY ALL DIMENSION AND CONDITIONS EXISTING IN THE FIELD PRIOR TO ORDERING MATERIALS AND BEGINNING CONSTRUCTION.

ALL SAWCUTTING SHALL BE INCLUDED IN THE UNIT COST OF REMOVAL ITEMS AND SHALL BE PERFORMED PRIOR TO BEGINNING REMOVAL. ANY ITEMS OF WORK REMOVED PRIOR TO SAWCUTTING WILL NOT BE MEASURED FOR PAYMENT.

PAVEMENT GRADES: THE ELEVATIONS INDICATED ON THE PLANS ARE FINISHED GRADES OF PROPOSED PAVEMENT OF SURFACE COURSE, UNLESS OTHERWISE INDICATED.

BARRICADES: THE CONTRACTOR SHALL PROVIDE AND INSTALL TWO (2) WEIGHTED SAND BAGS ON EACH TYPE I OR TYPE II BARRICADE USED. (ONE (1) WEIGHTED SAND BAG ACROSS EACH BOTTOM RAIL.)

RELOCATING EXISTING SIGNS: EXISTING SIGNS WHICH ARE IN CONFLICT WITH PROPOSED IMPROVEMENTS SHALL BE REMOVED AND REINSTALLED UPON COMPLETION OF CONFLICTING IMPROVEMENTS IN ACCORDANCE WITH THE ILLINOIS DEPARTMENT OF TRANSPORTATION "MANUAL OF UNIFORM TRAFFIC CONTROL DEVICES" AND THE "STANDARD SPECIFICATIONS FOR TRAFFIC CONTROL ITEMS". THIS WORK SHALL BE INCLUDED IN THE COST FOR PORTLAND CEMENT CONCRETE SIDEWALK, 5 INCH, SPECIAL.

ANY EXISTING PAVEMENT DAMAGED BY THE CONTRACTOR DURING THE CONSTRUCTION SHALL BE REPLACED/REPAIRED BY THE CONTRACTOR AT HIS/HERS OWN EXPENSE TO THE SATISFACTION OF THE ENGINEER WITH NO ADDITIONAL COMPENSATION TO THE CONTRACTOR.

ALL TRANSITIONS IN CURB HEIGHT SHALL OCCUR OVER 3 FEET ALONG CURB LINE. AT LOCATIONS WHERE CURB TERMINATES, THE LAST 1 FOOT SHALL BE DEPRESSED. DEPRESSED CURB SHALL ALSO BE AT LOCATIONS SHOWN ON THE PLANS AND AS DIRECTED BY THE ENGINEER.

PAVEMENT REMOVAL HAS BEEN ASSUMED TO BE 10 INCHES.

STORM SEWER

WHENEVER, DURING CONSTRUCTION, OPERATIONS ANY LOOSE MATERIAL IS DEPOSITED IN THE FLOW LINE OF DRAINAGE STRUCTURES SUCH THAT THE NATURAL FLOW OF WATER IS OBSTRUCTED, IT SHALL BE REMOVED AT THE CLOSE OF EACH WORKING DAY. AT THE CONCLUSION OF CONSTRUCTION OPERATIONS, ALL UTILITY STRUCTURES SHALL BE FREE FROM DIRT AND DEBRIS. THE WORK SPECIFIED ABOVE WILL NOT BE PAID FOR SEPARATELY BUT SHALL BE INCIDENTAL TO THE CONTRACT.

ANY EXISTING OR PROPOSED STORM SEWER DAMAGED BY THE CONTRACTOR DURING CONSTRUCTION SHALL BE REPLACED BY THE CONTRACTOR AT NO COST TO THE VILLAGE.

DRAINAGE STRUCTURE OFFSETS AS SHOWN ON THE PLANS ARE GIVEN TO THE FOLLOWING POINTS: (A) FOR STRUCTURES FALLING IN THE CURB LINE - TO THE EDGE OF PAVEMENT; B) FOR ALL OTHER STRUCTURES - TO THE CENTER OF STRUCTURE.

TOP-OF-FRAME ELEVATIONS SHOWN ON THE PLANS FOR DRAINAGE STRUCTURES IN THE CURB LINE ARE EDGE-OF-PAVEMENT ELEVATIONS.

FRAME ELEVATIONS GIVEN ON THE PLANS ARE ONLY TO ASSIST THE CONTRACTOR IN DETERMINING THE APPROXIMATE OVERALL HEIGHT OF THE STRUCTURE. FRAMES OF ALL NEW, ADJUSTED OR RECONSTRUCTED STRUCTURES SHALL BE ADJUSTED TO THE FINAL ELEVATION OF THE AREA IN WHICH THEY ARE LOCATED AS PART OF THE STRUCTURE, ADJUSTMENT, OR RECONSTRUCTION COST.

WHEN EXISTING DRAINAGE OR SEWERAGE FACILITIES ARE DISTURBED, THE CONTRACTOR SHALL PROVIDE AND MAINTAIN TEMPORARY OUTLETS AND CONNECTIONS FOR ALL PUBLIC OR PRIVATE DRAINS, SEWERS, OR CATCH BASINS. HE SHALL PROVIDE FACILITIES TO TAKE ALL STORM WATER WHICH WOULD BE RECEIVED BY THESE FACILITIES AND DISCHARGE SAME. HE SHALL ALSO PROVIDE AND MAINTAIN AN EFFICIENT PUMPING PLANT, IF NECESSARY, AND A TEMPORARY OUTLET, AND BE PREPARED AT ALL TIMES TO DISPOSE OF THE WATER RECEIVED FROM THESE TEMPORARY CONNECTIONS UNTIL SUCH TIME THAT PERMANENT CONNECTIONS WITH SEWERS ARE CONSTRUCTED AND IN SERVICE. THIS WORK SHALL BE CONSIDERED INCIDENTAL TO THE CONTRACT.

ALL TRENCH BACKFILL QUANTITIES FOR STORM SEWERS HAVE BEEN COMPUTED AND SHALL BE PAID FOR IN ACCORDANCE WITH SPECIFICATIONS FOR WATER AND SEWER MAIN CONSTRUCTION IN ILLINOIS.

ALL REMOVAL OR EXCAVATION ITEMS BEING DISPOSED OF AT AN UNCONTAMINATED SOIL FILL OPERATION OR CLEAN CONSTRUCTION AND DEMOLITION DEBRIS (CDD) FILL SITE SHALL MEET THE REQUIREMENTS OF PUBLIC ACT 96-1416. ALL COSTS ASSOCIATED WITH MEETING THESE REQUIREMENTS SHALL BE INCLUDED IN THE UNIT PRICE COST FOR THE ASSOCIATED REMOVAL OR EXCAVATION ITEMS IN THE CONTRACT. THESE COSTS SHALL INCLUDE BUT ARE NOT LIMITED TO ALL REQUIRED TESTING, LAB ANALYSIS, CERTIFICATION BY A LICENSED PROFESSIONAL ENGINEER, AND STATE OR LOCAL TIPPING FEES.

GENERAL NOTES

THE OWNER, THE VILLAGE OF PALOS PARK SHALL BE NOTIFIED IN WRITING AT LEAST (3) FULL WORKING DAYS PRIOR TO COMMENCEMENT OF CONSTRUCTION.

BEFORE BEGINNING CONSTRUCTION, THE CONTRACTOR SHALL VERIFY THE LINE AND GRADES SHOWN ON THE CONTRACT DRAWINGS. IF THERE ARE ANY DISCREPANCIES FROM WHAT IS SHOWN ON THE CONTRACT DRAWINGS, THE CONTRACTOR SHALL IMMEDIATELY REPORT SAME TO THE OWNER PRIOR TO PERFORMING WORK. CONTRACTOR SHALL BE RESPONSIBLE FOR COORDINATION OF WORK AS REQUIRED.

ALL ELEVATIONS SHOWN ON THE CONTRACT DRAWINGS ARE NAVD 1988 DATUM UNLESS OTHERWISE SPECIFIED.

THE CONTRACT DOCUMENTS ARE NOT INTENDED TO SHOW EVERY AND ALL DETAILS OF WORK TO BE PERFORMED OR EQUIPMENT TO BE SUPPLIED. THE INTENT OF THE CONTRACT DOCUMENTS IS TO ILLUSTRATE THE CONCEPTUAL DESIGN AND LAYOUT. THE CONTRACTOR SHALL BE KNOWLEDGEABLE AND REGULARLY ENGAGED IN THE TYPE OF WORK DESCRIBED BY THESE CONTRACT DOCUMENTS, AND SHALL BE RESPONSIBLE FOR UNDERSTANDING THEIR INTENT. ANY WORK TO BE PERFORMED OR ITEM OF EQUIPMENT TO BE SUPPLIED WHICH IS NOT SPECIFICALLY CALLED FOR BY THESE CONTRACT DOCUMENTS BUT WHICH IS NECESSARY TO PROVIDE A COMPLETE AND SUCCESSFUL WORKING SYSTEM SHALL BE INCLUDED IN THE CONTRACTOR'S SCOPE OF WORK AT NO ADDITIONAL COST TO THE OWNER.

IT IS THE CONTRACTOR'S RESPONSIBILITY TO DETERMINE ALL MATERIAL QUANTITIES AND APPRAISE HIMSELF/HERSELF OF ALL CONDITIONS. THE CONTRACT PRICE SUBMITTED BY THE CONTRACTOR SHALL BE CONSIDERED AS THE TOTAL COST FOR THE COMPLETE PROJECT. NO CLAIMS FOR EXTRA WORK WILL BE RECOGNIZED DUE TO THE CONTRACTOR'S FAILURE TO UNDERSTAND THE SCOPE OF WORK.

ORIENTATION OF PIPING, CONDUITS, EQUIPMENT, ETC. MAY VARY. CONTRACTOR TO COORDINATE SAME WITH THE OWNER.

ANY AND ALL DEWATERING REQUIRED TO KEEP EXCAVATIONS DRY SHALL BE THE RESPONSIBILITY OF THE CONTRACTOR.

SOIL EROSION PROTECTION SHALL BE IN ACCORDANCE WITH IEPA STANDARDS AND SPECIFICATIONS FOR SOIL EROSION AND SEDIMENT CONTROL. ALL DISTURBED AREAS (NOT IMPERVIOUS IN NATURE) SHALL BE FINE GRADED, TOP SOIL RESTORED (MIN 6 INCHES) AND SEED/MULCH APPLIED UNLESS OTHERWISE SPECIFIED ON THE PLANS.

IDOT STANDARDS

- | | |
|------------------|---|
| (STD. 000001-06) | STANDARD SYMBOLS, ABBREVIATIONS AND PATTERNS |
| (STD. 280001-05) | TEMPORARY EROSION CONTROL SYSTEMS |
| (STD. 420001-07) | PAVEMENT JOINTS |
| (STD. 424001-05) | CURB RAMPS FOR SIDEWALKS |
| (STD. 542301-03) | PRECAST REINFORCED CONCRETE FLARED END SECTION |
| (STD. 602001-02) | CATCH BASIN TYPE A |
| (STD. 604001-03) | FRAME AND LIDS TYPE 1 |
| (STD. 606001-04) | CONCRETE CURB TYPE B AND COMBINATION CONCRETE CURB AND GUTTER |
| (STD. 701501-06) | LANE CLOSURE, 2L, 2W, DAY ONLY, FOR SPEEDS LESS THAN 45MPH |
| (STD. 701801-04) | LANE CLOSURE MULTILANE 1W OR 2W CROSSWALK OR SIDEWALK CLOSURE |
| (STD. 701901-01) | TRAFFIC CONTROL DEVICES |

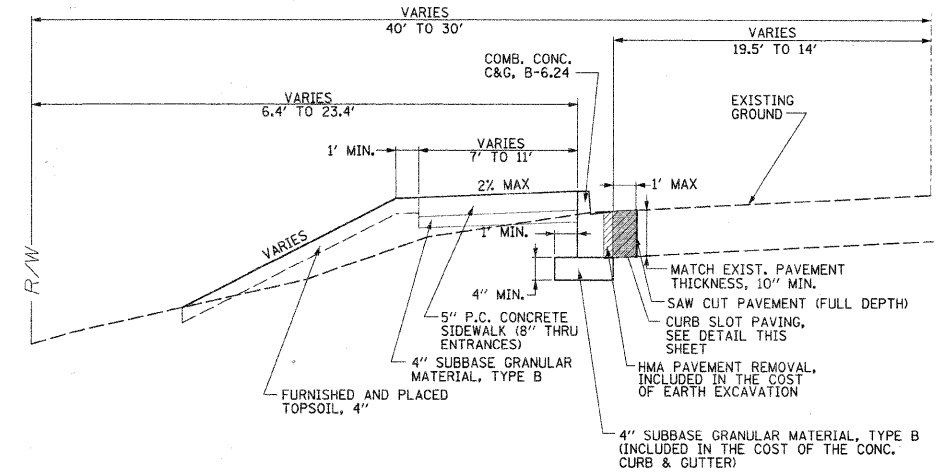

TYPICAL SECTION
STA 99+47 TO STA 112+17

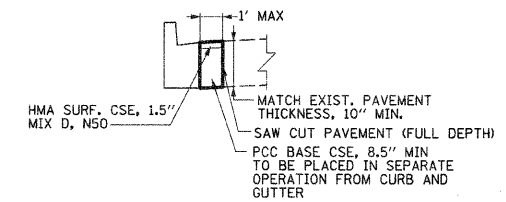

CURB SLOT PAVING
TYPICAL SECTION
STA 99+88 TO STA 112+31

FILE NAME = N:\p\ospark\102055\C1v1\NOT_102055.DGN	USER NAME = CMCCOLLO	DESIGNED - CJM	REVISED -	STATE OF ILLINOIS DEPARTMENT OF TRANSPORTATION	GENERAL NOTES AND IDOT STANDARDS VILLAGE OF PALOS PARK				F.A.U. RTE. 2756	SECTION 09-00029-00-SW	COUNTY COOK	TOTAL SHEETS 14	SHEET NO. 2
PLOT SCALE = 1"	CHECKED - KRC/DV	REVISIONS	REVISIONS		SCALE: N.T.S.	SHEET NO. OF SHEETS	STA. TO STA.	CONTRACT NO. 63548					
PLOT DATE = 2/17/2011	DATE - 10/20/10	REVISIONS	REVISIONS		ILLINOIS FED. AID PROJECT								

PAY ITEM #	ITEM	UNIT	0021 TOTAL QUANTITY
20200100	EARTH EXCAVATION	CU YD	260
20800150	TRENCH BACKFILL	CU YD	185
21101615	TOPSOIL FURNISH AND PLACE, 4"	SQ YD	1000
25000100	SEEDING, CLASS 1	ACRE	0.02
25000400	NITROGEN FERTILIZER NUTRIENT	POUND	2
25000500	PHOSPHORUS FERTILIZER NUTRIENT	POUND	2
25000600	POTASSIUM FERTILIZER NUTRIENT	POUND	2
25100630	EROSION CONTROL BLANKET	SQ YD	1000
25200200	SUPPLEMENTAL WATERING	UNIT	15
28000305	TEMPORARY DITCH CHECKS	FOOT	50
28000400	PERIMETER EROSION BARRIER	FOOT	1200
28000510	INLET FILTERS	EACH	12
31101100	SUBBASE GRANULAR MATERIAL, TYPE B	CU YD	130
35300310	PORTLAND CEMENT CONCRETE BASE COURSE 8 1/2"	SQ YD	150
40603335	HOT-MIX ASPHALT SURFACE COURSE, MIX "D", N50	TON	15
42300400	PORTLAND CEMENT CONCRETE DRIVEWAY PAVEMENT, 8 INCH	SQ YD	185
42400200	PORTLAND CEMENT CONCRETE SIDEWALK 5 INCH	SQ FT	8100
42400410	PORTLAND CEMENT CONCRETE SIDEWALK 8 INCH	SQ FT	390
42400800	DETECTABLE WARNINGS	SQ FT	60
44000100	PAVEMENT REMOVAL	SQ YD	150
44000200	DRIVEWAY PAVEMENT REMOVAL	SQ YD	150
44000500	COMBINATION CURB AND GUTTER REMOVAL	FOOT	25

PAY ITEM #	ITEM	UNIT	0021 TOTAL QUANTITY
54213657	PRECAST REINFORCED CONCRETE FLARED END SECTIONS 12"	EACH	3
54213660	PRECAST REINFORCED CONCRETE FLARED END SECTIONS 15"	EACH	1
550A0050	STORM SEWERS, CLASS A, TYPE 1 12"	FOOT	150
550A0070	STORM SEWERS, CLASS A, TYPE 1 15"	FOOT	222
56400100	FIRE HYDRANTS TO BE MOVED	EACH	2
60201340	CATCH BASINS, TYPE A, 4'-DIAMETER, TYPE 24 FRAME AND GRATE	EACH	1
60208240	CATCH BASINS, TYPE C, TYPE 24 FRAME AND GRATE	EACH	2
60207005	CATCH BASINS, TYPE C, TYPE 1 FRAME, CLOSED LID	EACH	1
60237470	INLETS, TYPE A, TYPE 24 FRAME AND GRATE	EACH	2
60250200	CATCH BASINS TO BE ADJUSTED	EACH	1
60255500	MANHOLES TO BE ADJUSTED	EACH	2
60265700	VALVE VAULTS TO BE ADJUSTED	EACH	3
60605000	COMBINATION CONCRETE CURB AND GUTTER, TYPE B-6.24	FOOT	1300
61140100	STORM SEWERS (SPECIAL), 10"	FOOT	30
61140200	STORM SEWERS (SPECIAL), 12"	FOOT	20
67100100	MOBILIZATION	L SUM	1
70102620	TRAFFIC CONTROL AND PROTECTION, STANDARD 701501	L SUM	1
70102640	TRAFFIC CONTROL AND PROTECTION, STANDARD 701801	L SUM	1
Z0013798	CONSTRUCTION LAYOUT	L SUM	1

* SPECIAL PROVISION

EARTHWORK SCHEDULE

Street	EARTH EXCAVATION	EARTH EXCAVATION ADJUSTED FOR SHRINKAGE (15%)	EMBANKMENT	EARTHWORK BALANCE WASTE (+) OR SHORTAGE (-)	TOPSOIL PLACEMENT
80th Ave	CY 306	CY 260	CY 215	CY 45	CY 110

FILE NAME = N:\palospark\100055\Civil\NS001_100055.DGN	USER NAME = CMCCOLLO	DESIGNED - CJM	REVISED -	STATE OF ILLINOIS DEPARTMENT OF TRANSPORTATION	SUMMARY OF QUANTITIES AND EARTHWORK TABLE VILLAGE OF PALOS PARK	F.A.U. RTE. 2756	SECTION 09-00029-00-SW	COUNTY COOK	TOTAL SHEETS 14	SHEET NO. 3	
PLOT SCALE = 1"	CHECKED - KRC/DV	REVISED -	SCALE: 1:1'			SHEET NO. OF SHEETS	STA. TO STA.	CONTRACT NO. 63548			
PLOT DATE = 2/17/2011	DATE - 10/20/10	REVISED -	ILLINOIS FED. AID PROJECT								

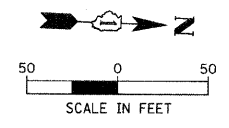

123rd STREET
POT Sta 99+20.11

PROJECT BEGINS
STA 99+47.00

N 1,821,901.57
E 1,125,622.70

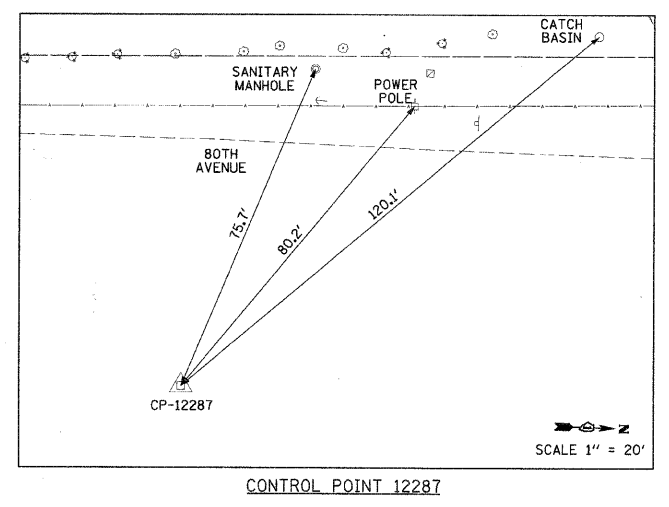

CONTROL POINT 12287

BROOK LANE

OSBM 10-1

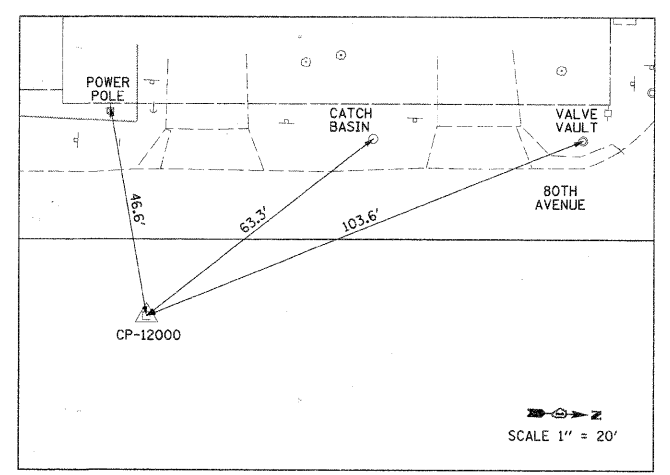

CONTROL POINT 12000

PROJECT ENDS
STA 112+32.40

121st STREET
POT Sta 112+47.09



80th AVENUE

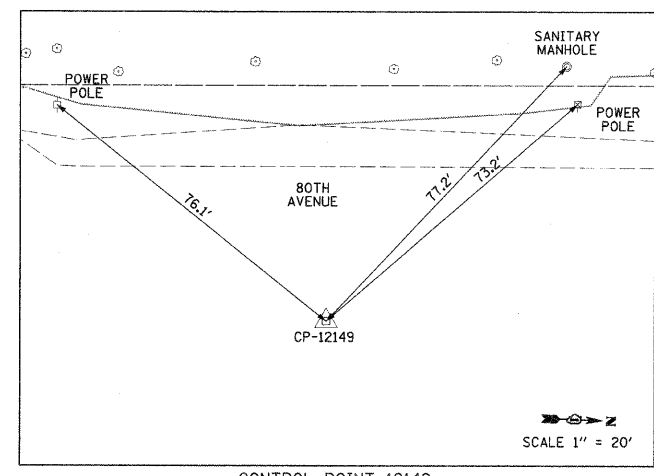

CONTROL POINT 12149

HORIZONTAL CONTROL POINTS					
CP NO.	NORTHING (Y)	EASTING (X)	DESCRIPTION	STATION	OFFSET
CP-12000	1,823,091.42	1,125,598.06	PK NAIL	107+04.78	18.91 RT
CP-12149	1,822,686.43	1,125,614.25	PK NAIL	111+10.09	16.79 RT
CP-12287	1,822,177.17	1,125,645.71	REBAR	101+94.73	32.61 RT

ELEVATION BENCHMARKS DATUM: NAVD 1988		
NO.	DESCRIPTION	ELEV.
OSBM 1	SOUTH FLANGE BOLT OF FIRE HYDRANT IN DRIVE TO METRA STATION (REF JOB #060285)	627.22
OSBM 10-1	R.R. SPIKE IN UTILITY POLE AT N.W. CORNER OF BROOK LANE AND 80TH AVENUE	637.41

* TO CONVERT TO COOK COUNTY HIGHWAY DEPARTMENT DATUM
ADD 2.61' TO ALL ELEVATIONS

FILE NAME =	USER NAME = CMCCOLLO	DESIGNED - CJM	REVISED -
N:\palospark\100055\Civil\BHN1_100055.DGN		DRAWN - CJM	REVISED -
	PLOT SCALE = 50'	CHECKED - KRC/DV	REVISED -
	PLOT DATE = 2/17/2011	DATE - 10/20/10	REVISED -

STATE OF ILLINOIS
DEPARTMENT OF TRANSPORTATION

ALIGNMENT, TIES AND BENCHMARKS VILLAGE OF PALOS PARK			
SCALE: 1:50'	SHEET NO.	OF SHEETS	STA. TO STA.

F.A.U. RTE.	SECTION	COUNTY	TOTAL SHEETS	SHEET NO.
2756	09-00029-00-SW	COOK	14	4
CONTRACT NO. 63548				
ILLINOIS FED. AID PROJECT				

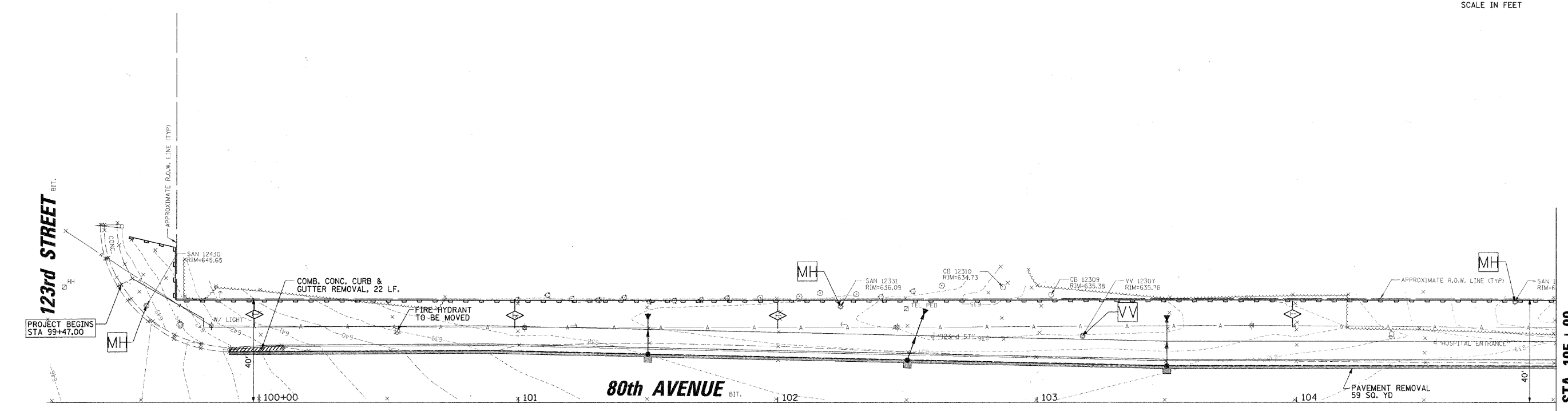
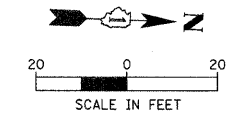

LEGEND:

CATCH BASINS TO BE ADJUSTED	SHOULDER REMOVAL
VALVE VAULTS TO BE ADJUSTED	PAVEMENT REMOVAL
MANHOLES TO BE ADJUSTED	INLET FILTER
COMBINATION CURB AND GUTTER REMOVAL	PERIMETER EROSION BARRIER
DRIVEWAY PAVEMENT REMOVAL	TEMPORARY DITCH CHECK

FILE NAME =	USER NAME = CMCDLLO	DESIGNED - CJM	REVISED -
N:\palospark\100055\C1\1\REMI_100055.DGN		DRAWN - CJM	REVISED -
	PLOT SCALE = 20'	CHECKED - KRC/DV	REVISED -
	PLOT DATE = 2/17/2011	DATE - 10/20/10	REVISED -

**STATE OF ILLINOIS
DEPARTMENT OF TRANSPORTATION**

**EXISTING CONDITIONS, REMOVAL, AND EROSION CONTROL PLAN
VILLAGE OF PALOS PARK**

SCALE: 1:20' SHEET NO. OF SHEETS STA. 99+20.11 TO STA. 105+00.00

F.A.U. RTE.	SECTION	COUNTY	TOTAL SHEETS	SHEET NO.
2756	09-00029-00-SW	COOK	14	5
CONTRACT NO. 63548				
ILLINOIS FED. AID PROJECT				

MATCH LINE STA 105 + 00

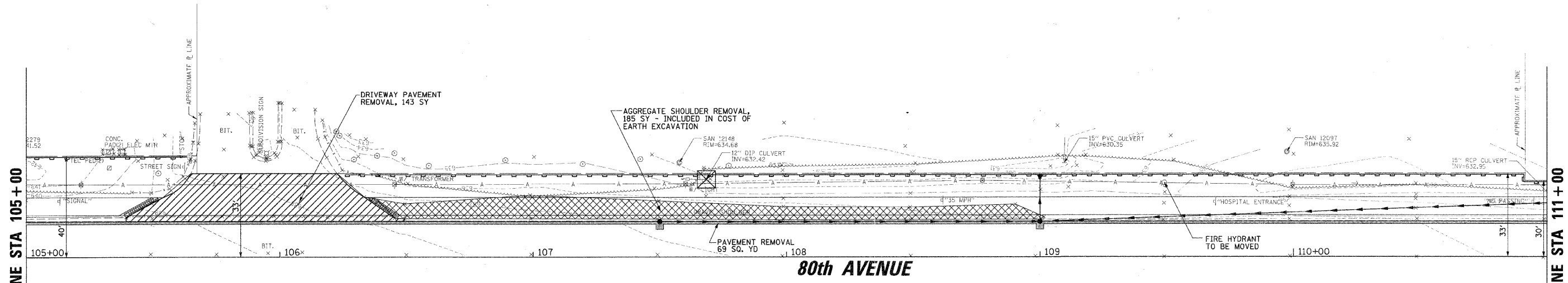
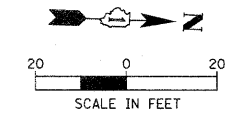

MATCH LINE STA 105+00

MATCH LINE STA 111+00

80th AVENUE

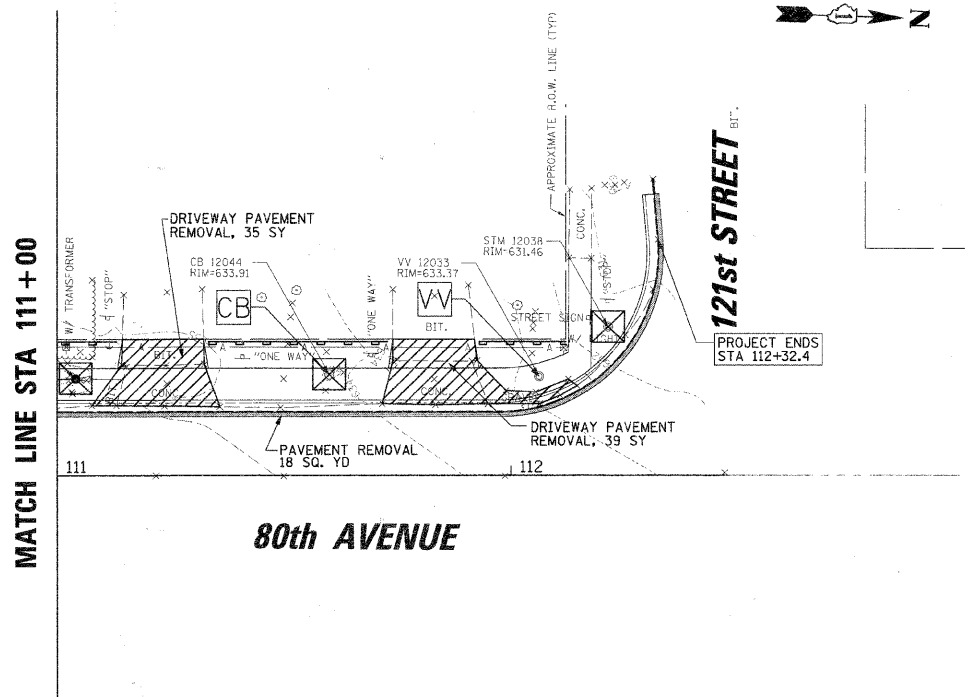

MATCH LINE STA 111+00

121st STREET

80th AVENUE

LEGEND:

- CATCH BASINS TO BE ADJUSTED
- VALVE VAULTS TO BE ADJUSTED
- MANHOLES TO BE ADJUSTED
- COMBINATION CURB AND GUTTER REMOVAL
- DRIVEWAY PAVEMENT REMOVAL
- SHOULDER REMOVAL
- PAVEMENT REMOVAL
- INLET FILTER
- PERIMETER EROSION BARRIER
- TEMPORARY DITCH CHECK

FILE NAME =	USER NAME = CMCCOLLO	DESIGNED - CJM	REVISED -
N:\palospark\20055\Civi\INREM2_100055.DWG		DRAWN - CJM	REVISED -
PLOT SCALE = 20'		CHECKED - KRC/DV	REVISED -
PLOT DATE = 2/17/2011		DATE - 10/20/10	REVISED -



**STATE OF ILLINOIS
DEPARTMENT OF TRANSPORTATION**

**EXISTING CONDITION, REMOVAL, AND EROSION CONTROL PLAN
VILLAGE OF PALOS PARK**

SCALE: 1:20' SHEET NO. OF SHEETS STA. 105+00.00 TO STA. 112+47.09

F.A.U. RTE.	SECTION	COUNTY	TOTAL SHEETS	SHEET NO.
2756	09-00029-00-SW	COOK	14	6
				CONTRACT NO. 63548
ILLINOIS FED. AID PROJECT				

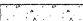
LEGEND:

-  COMBINATION CONCRETE CURB AND GUTTER TYPE B-6.24
-  PCC SIDEWALK, 5" SUBBASE GRANULAR MATERIAL, TYPE B, 4"
-  PCC SIDEWALK, 8" SUBBASE GRANULAR MATERIAL, TYPE B, 4"
-  CURB SLOT PAVING

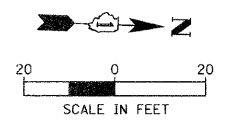

PLAN	SURVEYED	BY	DATE
	PLOTTED		
	CHECKED		
	NO. OF WAYS CHECKED		
	CADD FILE NAME		
	NO.		

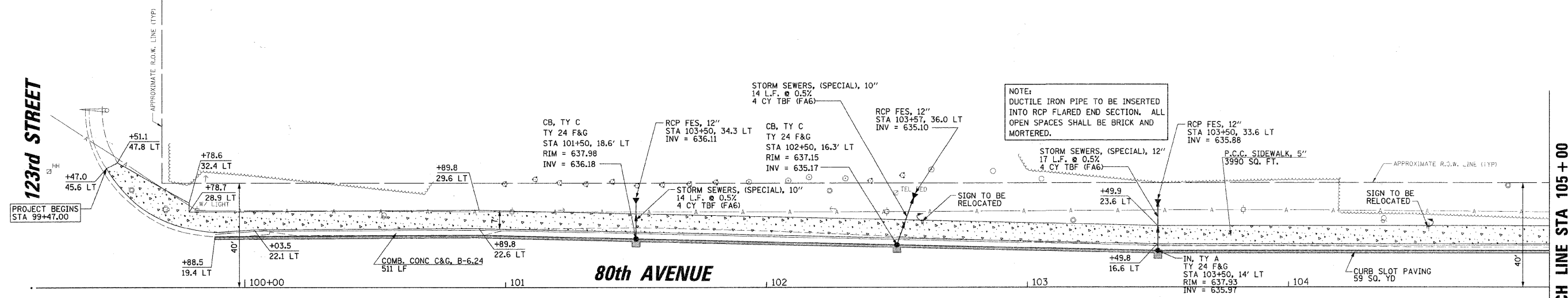

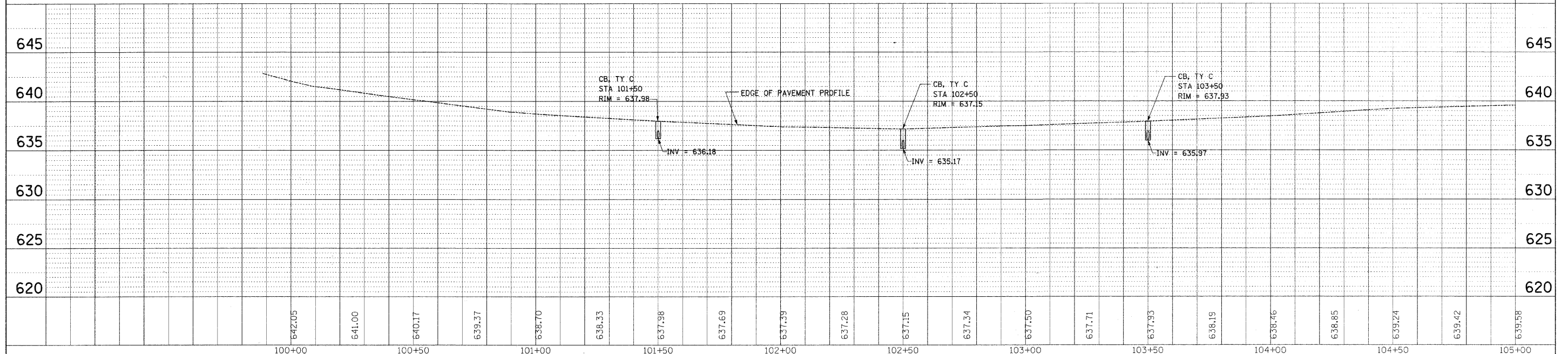

PROFILE	SURVEYED	BY	DATE
	PLOTTED		
	CHECKED		
	NO. OF WAYS CHECKED		
	STRUCTURE NOTATIONS CHRD		
	NO.		

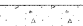
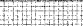

FILE NAME =	USER NAME = CHCCOLLO	DESIGNED - CJM	REVISED -	STATE OF ILLINOIS DEPARTMENT OF TRANSPORTATION	PROPOSED IMPROVEMENTS AND TYPICAL SECTIONS VILLAGE OF PALOS PARK	F.A.U. RTE.	SECTION	COUNTY	TOTAL SHEETS	SHEET NO.
N:\palospark\100095\Civil\RD\1.100095.DGN	PLLOT SCALE = 20'	DRAWN - CJM	REVISED -			2756	09-00029-00-SW	COOK	14	7
	PLLOT DATE = 2/17/2011	CHECKED - KRC/DV	REVISED -			SCALE: 1:20'		SHEET NO. OF SHEETS		CONTRACT NO. 63548
		DATE -	REVISED -			STA. 105+00.00 TO STA. 112+47.09		ILLINOIS FED. AID PROJECT		

LEGEND:

-  COMBINATION CONCRETE CURB AND GUTTER TYPE B-6.24
-  PCC SIDEWALK, 5" SUBBASE GRANULAR MATERIAL, TYPE B, 4"
-  PCC SIDEWALK, 8" SUBBASE GRANULAR MATERIAL, TYPE B, 4"
-  CURB SLOT PAVING

PLAN	SURVEYED	DATE
	PLotted	
	Checked	
	BY	
	NO.	

PROFILE	SURVEYED	DATE
	Plotted	
	Checked	
	BY	
	NO.	

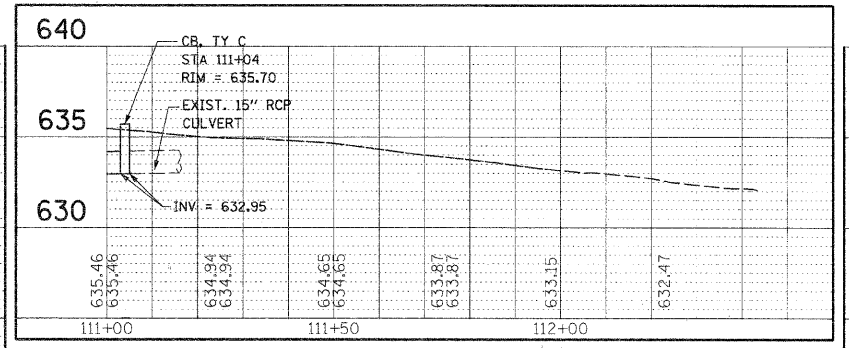
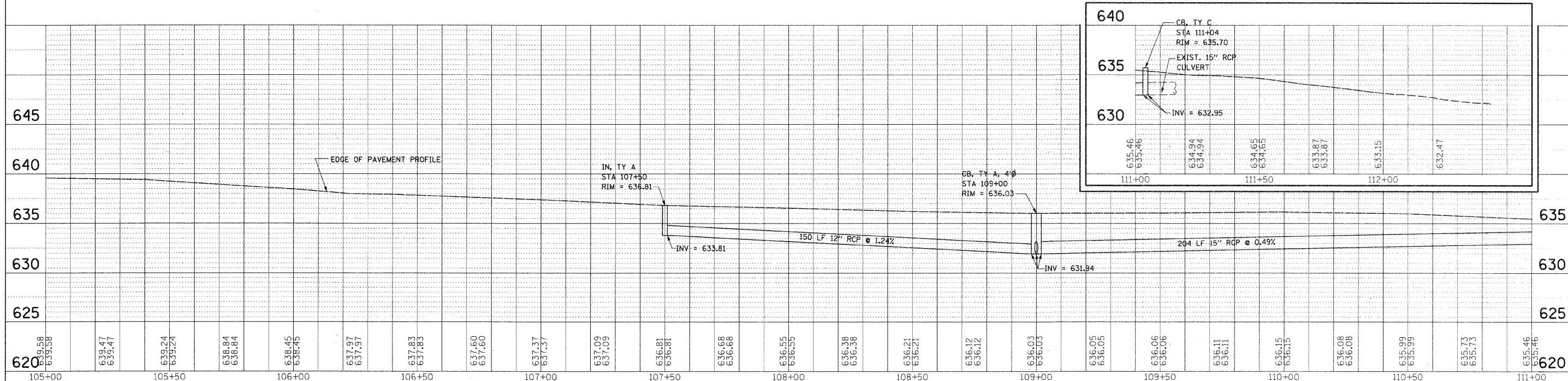
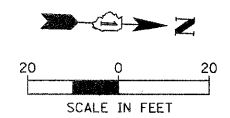
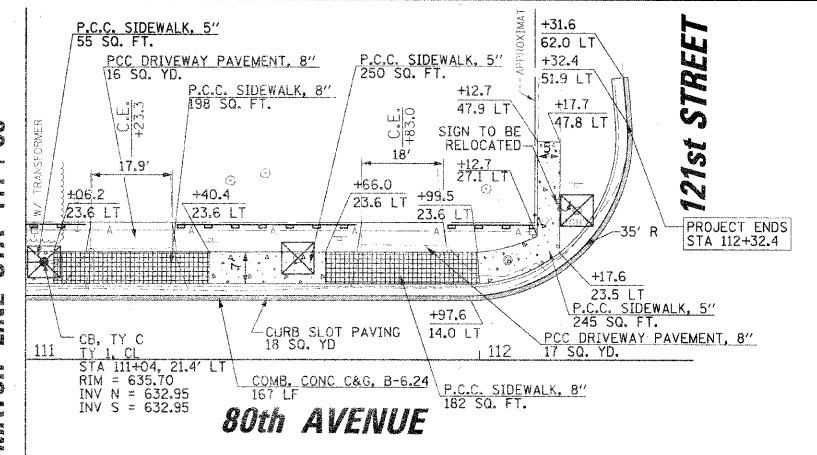
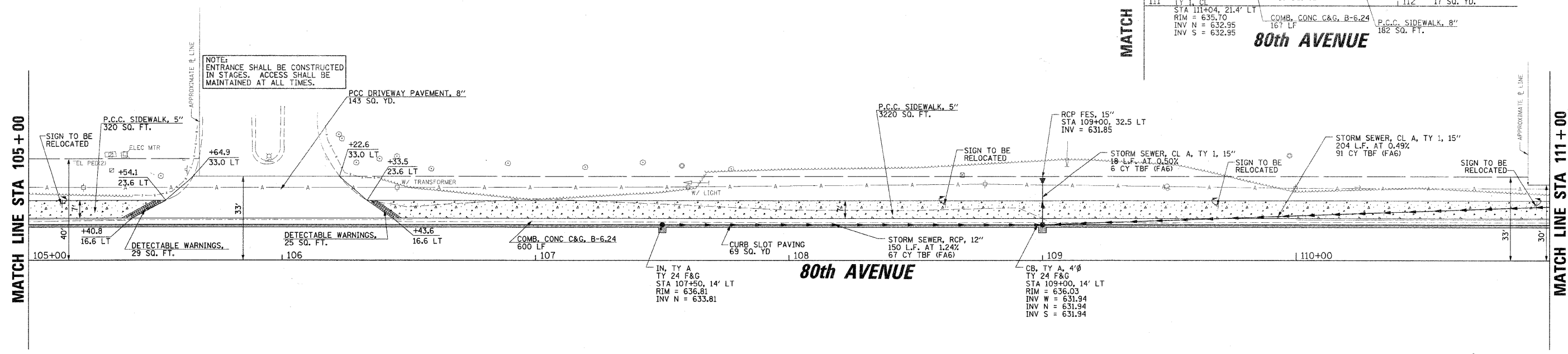

FILE NAME = N:\pelosark\100265\CVI\RD2-100265.DGN	USER NAME = CMCCOLLO	DESIGNED - CJM	REVISED -	STATE OF ILLINOIS DEPARTMENT OF TRANSPORTATION	PROPOSED IMPROVEMENTS AND TYPICAL SECTIONS VILLAGE OF PALOS PARK	F.A.U. RTE. 2756	SECTION 09-00029-00-SW	COUNTY COOK	TOTAL SHEETS 14	SHEET NO. 8		
PLOT SCALE = 20'	DATE = 2/17/2011	CHECKED - KRC/DV	REVISED -			SCALE: 1:20'	SHEET NO. OF SHEETS	STA. 99+20.11 TO STA. 105+00.00	CONTRACT NO. 63548			
		DATE -	REVISED -			ILLINOIS FED. AID PROJECT						

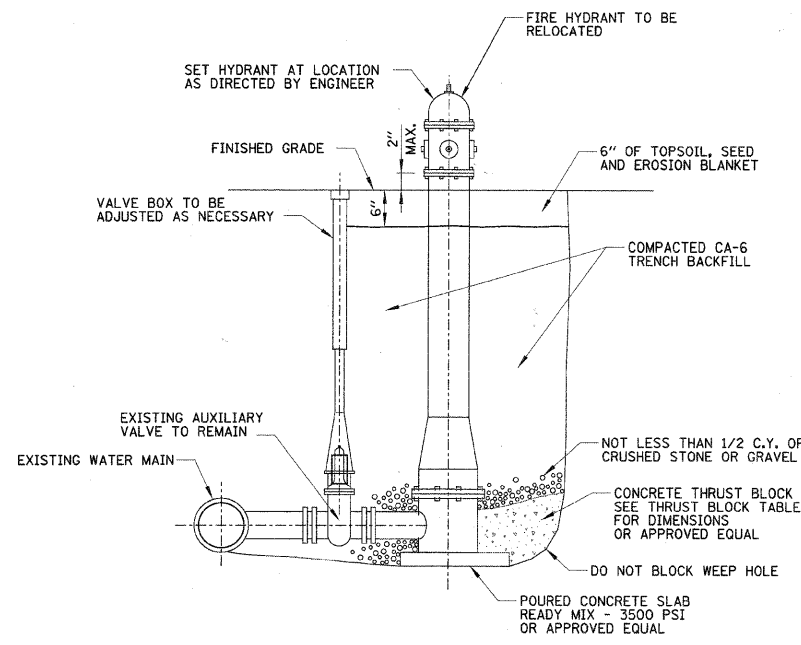

NOTE:
HEIGHT FROM FINISHED GRADE TO WATER MAIN ELEVATION VARIES

FIRE HYDRANT
N.T.S.

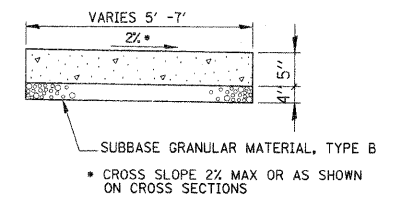

NOTES:

1. ALL REQUIRED EARTH EXCAVATION TO CONSTRUCT P.C.C. SIDEWALK SHALL BE INCIDENTAL TO THE P.C.C. SIDEWALK 5 INCH, SPECIAL.
2. WHEN FORMS ARE REMOVED FROM THE SIDEWALK EITHER THE SIDEWALK SHALL BE BARRICADED OR BACKFILLED WITHIN 24 HOURS.

P.C.C. SIDEWALK, 5 INCH SPECIAL
DETAIL

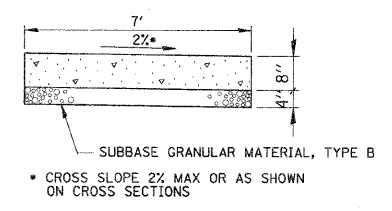

NOTES:

1. ALL REQUIRED EARTH EXCAVATION TO CONSTRUCT P.C.C. SIDEWALK SHALL BE INCIDENTAL TO THE P.C.C. SIDEWALK 8 INCH, SPECIAL.
2. WHEN FORMS ARE REMOVED FROM THE SIDEWALK EITHER THE SIDEWALK SHALL BE BARRICADED OR BACKFILLED WITHIN 24 HOURS.

P.C.C. SIDEWALK, 8 INCH SPECIAL
DETAIL

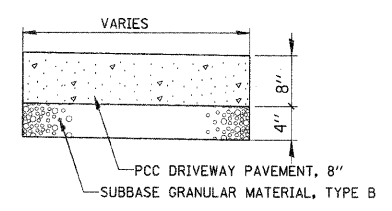

DRIVEWAY PAVEMENT REPLACEMENT
DETAIL

HOT-MIX ASPHALT MIXTURE REQUIREMENTS	
ITEM	VOIDS
HOT-MIX ASPHALT SURFACE COURSE, 1-1/2" MIX "D", N50 (IL-9.5 MM)	4% @ 50 GYR

THE UNIT WEIGHT USED TO CALCULATE ALL HMA SURFACE MIXTURE QUANTITIES IS 112 LBS/SY/IN.

THE "AC TYPE" FOR POLYMERIZED HMA MIXES SHALL BE "SBS/SBR PG 70-22" AND FOR NON-POLYMERIZED HMA THE "AC TYPE" SHALL BE "PG 64-22" UNLESS MODIFIED BY DISTRICT ONE SPECIAL PROVISIONS.

FOR "PERCENT RAP" SEE DISTRICT ONE SPECIAL PROVISIONS.

FILE NAME = N:\palospar-k\100055\Civil\DET1.100055.DGN	USER NAME = CMCCOLLO	DESIGNED - CJM	REVISED -	STATE OF ILLINOIS DEPARTMENT OF TRANSPORTATION	GENERAL DETAILS VILLAGE OF PALOS PARK	F.A.U. RTE. 2756	SECTION 09-00029-00-SW	COUNTY COOK	TOTAL SHEETS 14	SHEET NO. 9	
PLOT SCALE = 1"	CHECKED - KRC/DV	REVISIED -	SCALE: N.T.S.			SHEET NO. OF SHEETS STA. TO STA.	CONTRACT NO. 63548		ILLINOIS FED. AID PROJECT		
PLOT DATE = 2/17/2011	DATE - 10/20/10	REVISED -									

FINAL SURVEY	SURVEYED	BY	DATE
NOTE BOOK	NO. _____		
	TEMPLATE		
	AREAS CHECKED		

ORIGINAL SURVEY	SURVEYED	BY	DATE
NOTE BOOK	NO. _____		
	TEMPLATE		
	AREAS CHECKED		

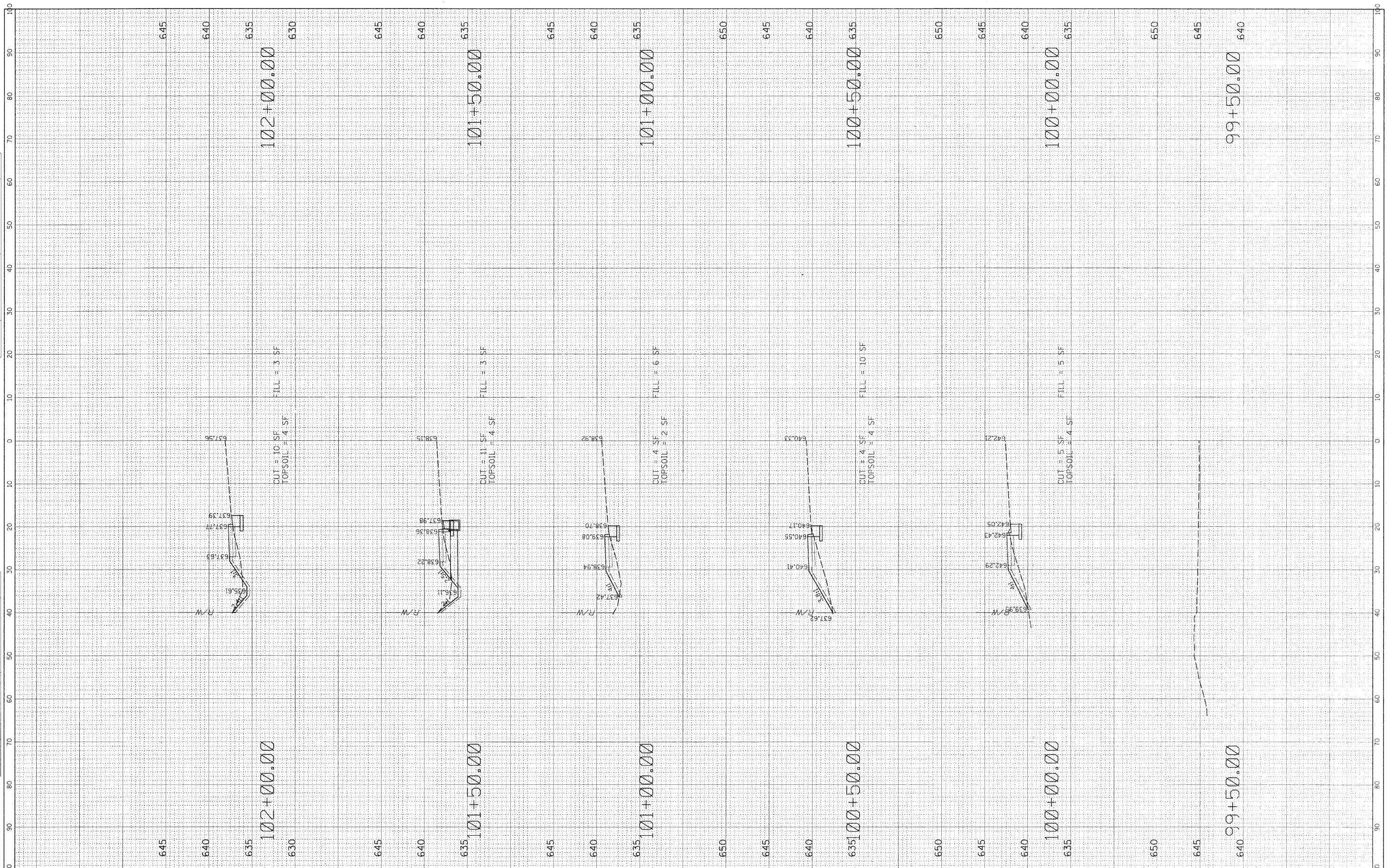

FILE NAME = N:\pelospark\100055\Civil\LAY_80TH.DGN
 USER NAME = CMCCOLLO
 PLOT SCALE = 10'
 PLOT DATE = 2/17/2011

DESIGNED - CJM
 DRAWN - CJM
 CHECKED - KRC/DV
 DATE -

REVISED -
 REVISED -
 REVISED -
 REVISED -

**STATE OF ILLINOIS
 DEPARTMENT OF TRANSPORTATION**

**PROPOSED CROSS SECTIONS
 80TH AVENUE**
 SCALE: 1:10' SHEET NO. OF 14 SHEETS STA. 99+50 TO STA. 102+00

F.A.J. RTE.	SECTION	COUNTY	TOTAL SHEETS	SHEET NO.
2756	09-00029-00-SW	COOK	14	10
CONTRACT NO. 63548			ILLINOIS FED. AID PROJECT	

FINAL SURVEY	SURVEYED	BY	DATE
NOTE BOOK	TEMPLATE		
NO.	AREAS CHECKED		

ORIGINAL SURVEY	SURVEYED	BY	DATE
NOTE BOOK	TEMPLATE		
NO.	AREAS CHECKED		

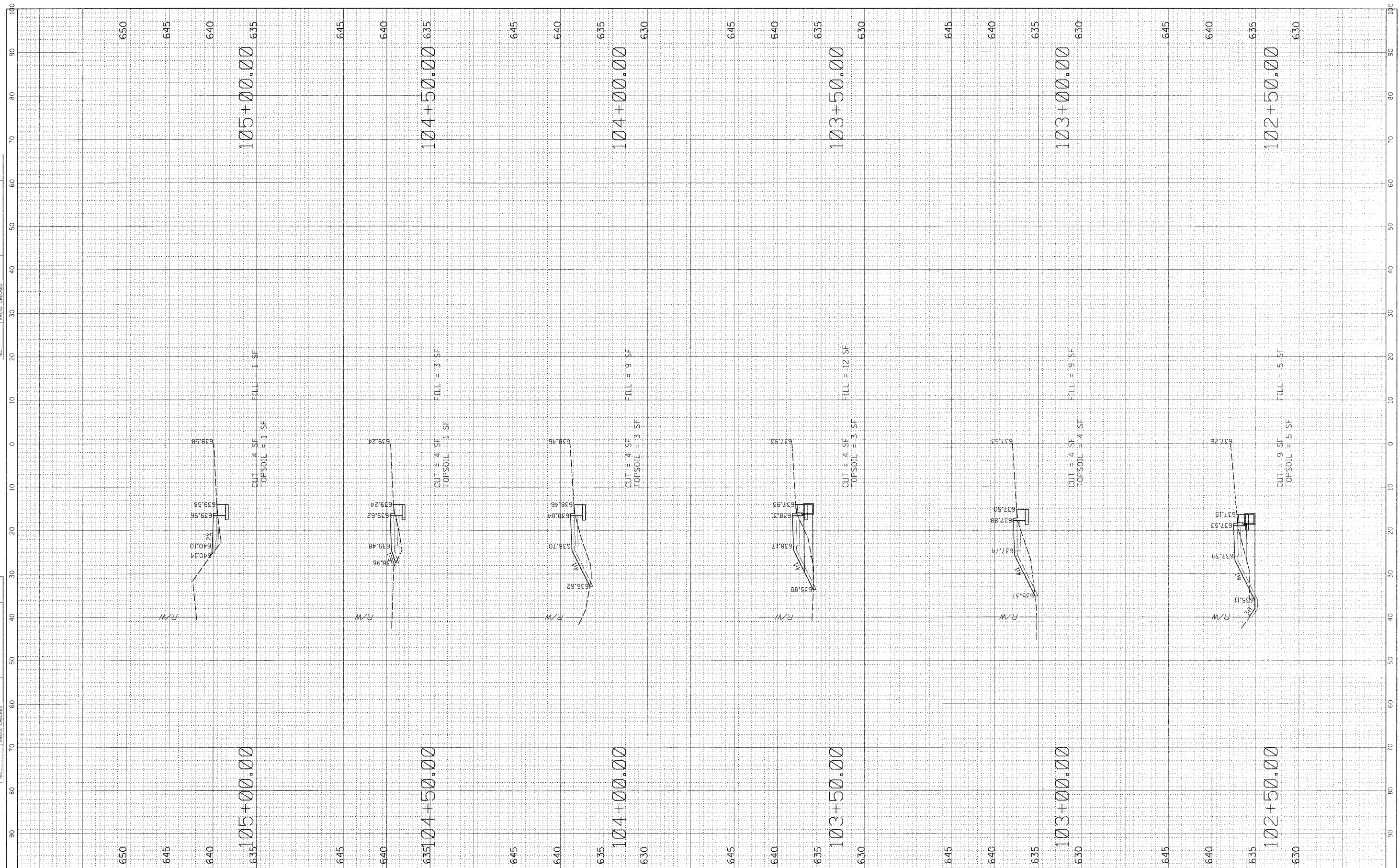

FILE NAME = N:\palspark\102055\Civil\LAY_B0TH.DGN
 PLOT SCALE = 10'
 PLOT DATE = 2/17/2011

USER NAME = CMCCOLLO

DESIGNED - CJM
 DRAWN - CJM
 CHECKED - KRC/DV
 DATE -

REVISED -
 REVISED -
 REVISED -
 REVISED -

**STATE OF ILLINOIS
 DEPARTMENT OF TRANSPORTATION**

**PROPOSED CROSS SECTIONS
 BOTH AVENUE**

SCALE: 1:10' SHEET NO. OF 14 SHEETS STA. 102+50 TO STA. 105+00

F.A.U. RTE.	SECTION	COUNTY	TOTAL SHEETS	SHEET NO.
2756	09-00029-00-SW	COOK	14	11
CONTRACT NO. 63548				
ILLINOIS FED. AID PROJECT				

FINAL SURVEY	BY	DATE
PLANNING		
NOTE BOOK		
AREAS		
CHECKED		
NO.		

ORIGINAL SURVEY	BY	DATE
PLANNING		
NOTE BOOK		
AREAS		
CHECKED		
NO.		

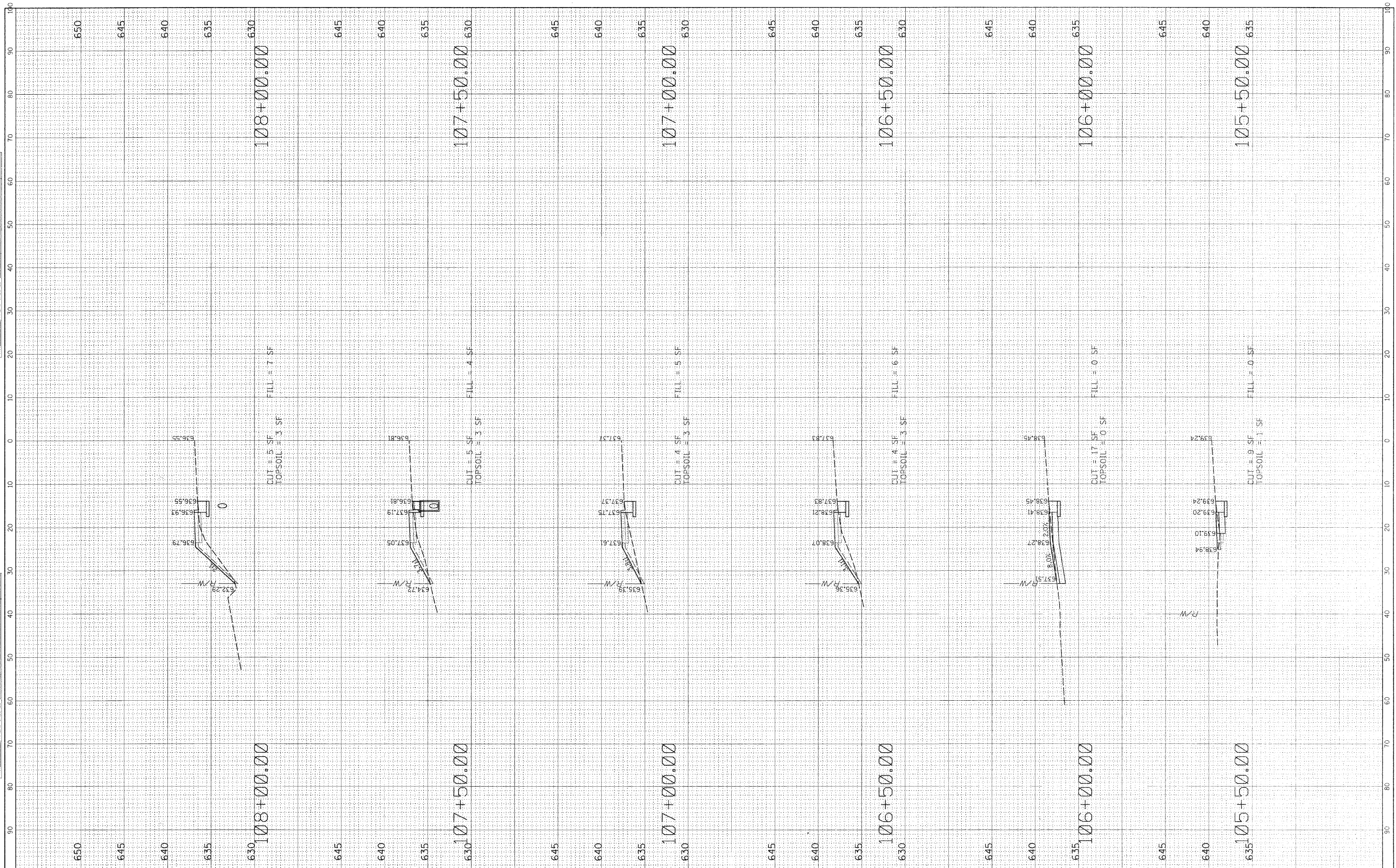

FILE NAME = N:\pelospark\100055\Civil\LAY_80TH.DGN	USER NAME = CMCCOLLO	DESIGNED - CJM	REVISED -	STATE OF ILLINOIS DEPARTMENT OF TRANSPORTATION	PROPOSED CROSS SECTIONS 80TH AVENUE			F.A.U. RTE. 2756	SECTION 09-00029-00-SW	COUNTY COOK	TOTAL SHEETS 14	SHEET NO. 12
PLOT SCALE = 1/8"		DRAWN - CJM	REVISED -		SCALE: 1/8"	SHEET NO.	OF 14 SHEETS	STA.	105+50	TO STA.	108+00	CONTRACT NO. 63548
PLOT DATE = 2/17/2011		CHECKED - KRC/DV	REVISED -		ILLINOIS FED. AID PROJECT							
		DATE -	REVISED -									

FINAL SURVEY	SURVEYED	DATE
NOTE BOOK	TEMPLATE	BY
NO.	AREAS CHECKED	

ORIGINAL SURVEY	SURVEYED	DATE
NOTE BOOK	TEMPLATE	BY
NO.	AREAS CHECKED	

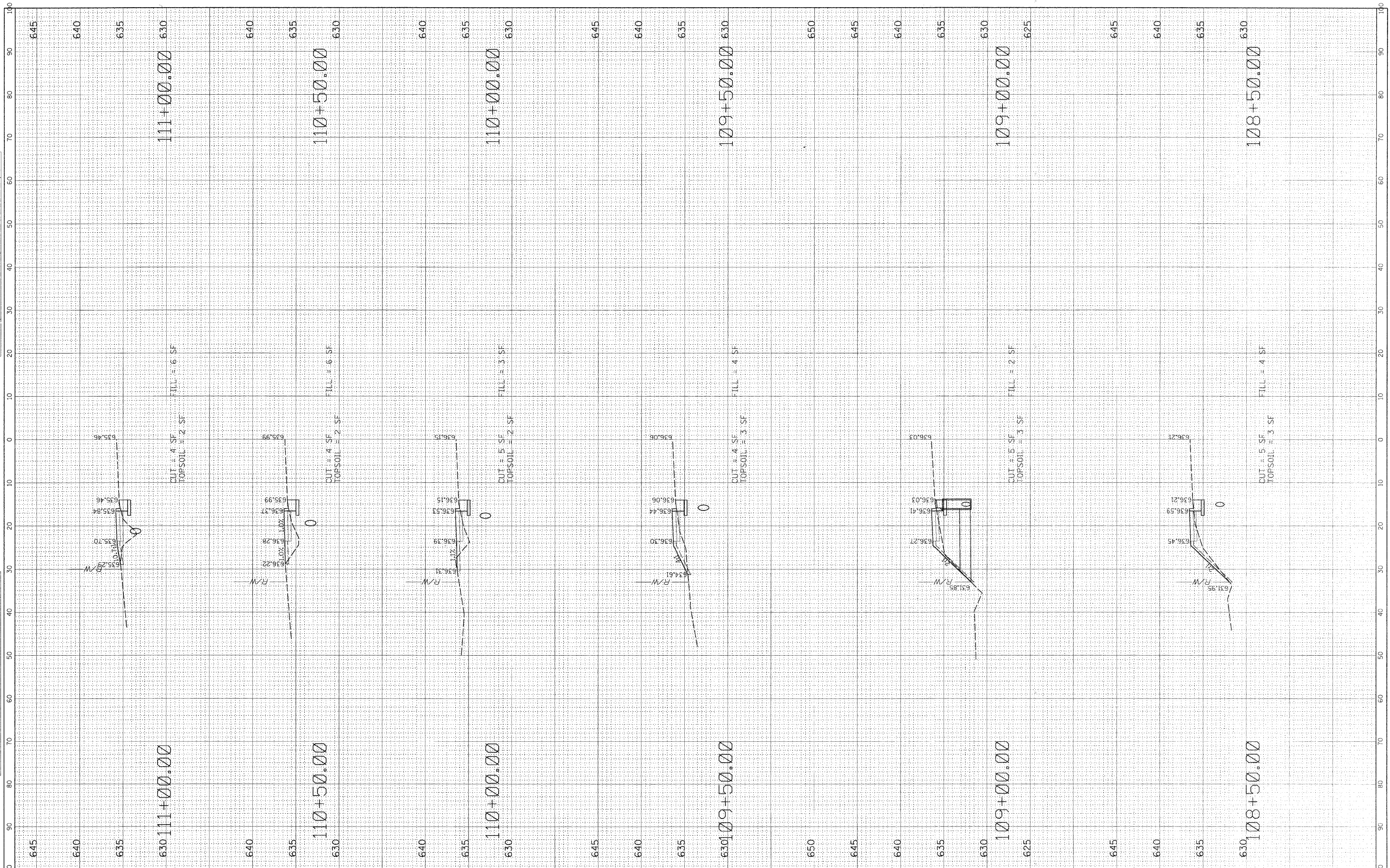

FILE NAME = N:\palspark\100095\Civil\LAY_80TH.DGN

USER NAME = CMCCOLLO
 PLOT SCALE = 10'
 PLOT DATE = 2/17/2011

DESIGNED - CJM
 DRAWN - CJM
 CHECKED - KRC/DV
 DATE -

REVISED -
 REVISED -
 REVISED -
 REVISED -

**STATE OF ILLINOIS
 DEPARTMENT OF TRANSPORTATION**

**PROPOSED CROSS SECTIONS
 80TH AVENUE**

SCALE: 1/40' SHEET NO. OF 14 SHEETS STA. 108+50 TO STA. 111+00

F.A.U. RTE.	SECTION	COUNTY	TOTAL SHEETS	SHEET NO.
2756	09-00029-00-SW	COOK	14	13
CONTRACT NO. 63548			ILLINOIS FED. AID PROJECT	

FINAL SURVEY	BY	DATE
NOTE BOOK		
NO.		
SURVEYED		
TEMPLATE		
AREAS		
CHECKED		

ORIGINAL SURVEY	BY	DATE
NOTE BOOK		
NO.		
SURVEYED		
TEMPLATE		
AREAS		
CHECKED		

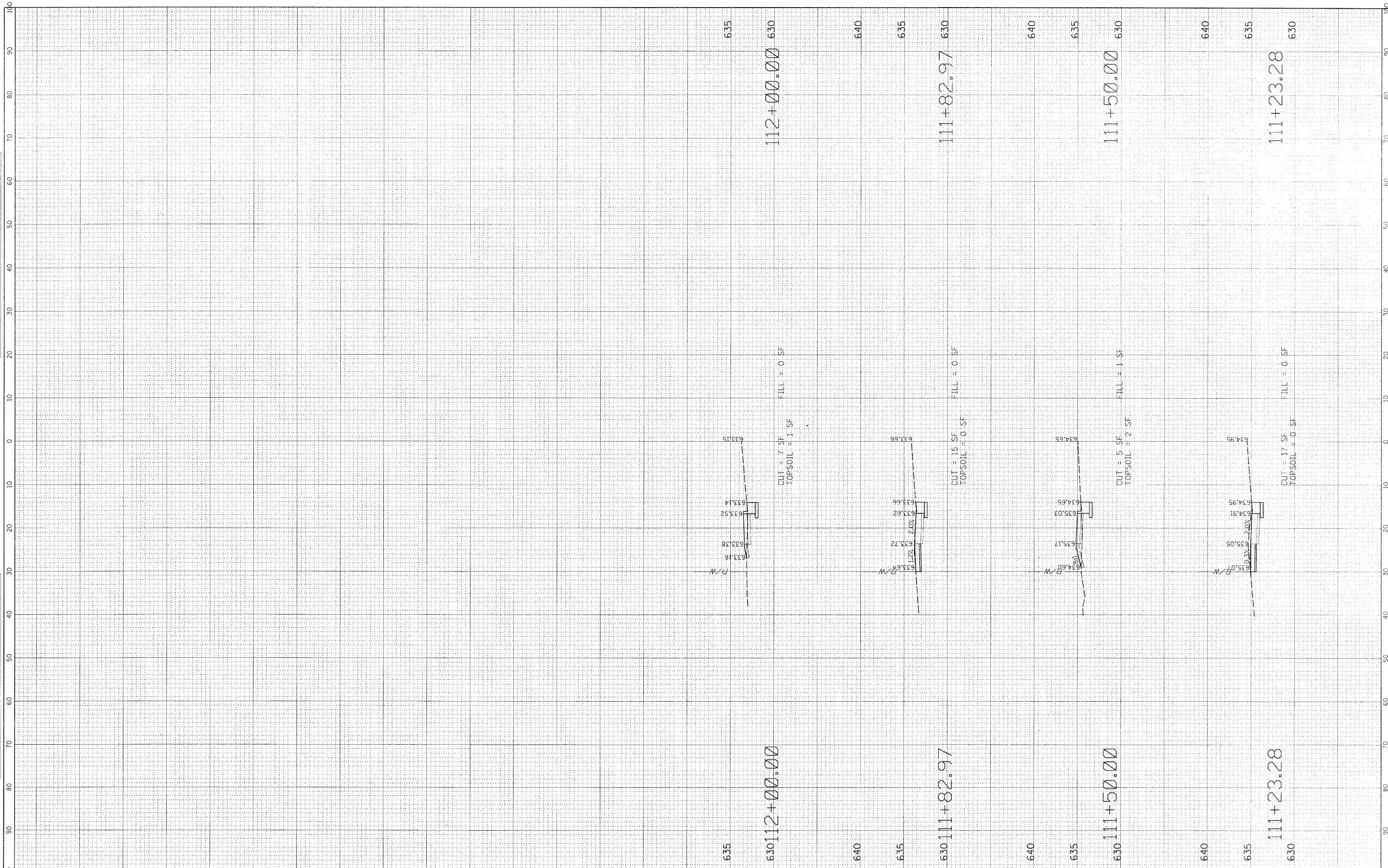

FILE NAME = N:\pelo\pelo-k\100055\Civil\LAY_00TH.DGN

USER NAME = CMCCULLO
 PLOT SCALE = 10'
 PLOT DATE = 2/17/2011

DESIGNED - CJM
 DRAWN - CJM
 CHECKED - KRC/DV
 DATE -

REVISED -
 REVISED -
 REVISED -
 REVISED -

**STATE OF ILLINOIS
 DEPARTMENT OF TRANSPORTATION**

**PROPOSED CROSS SECTIONS
 BOTH AVENUE**

SCALE: 1:10' SHEET NO. OF 14 SHEETS STA. 111+23.28 TO STA. 112+00

F.A.U. RTE.	SECTION	COUNTY	TOTAL SHEETS	SHEET NO.
2756	09-00029-00-SW	COOK	14	14
CONTRACT NO. 63548			ILLINOIS FED. AID PROJECT	