

**NORTH EDGE OF SHOULDER**

Location	Station	Offset (ft)	Theoretical Grade Elevations
W. End West Appr. Pav't.	109+41.71	20.00 Lt.	846.37
A1	109+51.71	20.00 Lt.	846.40
A2	109+61.71	20.00 Lt.	846.43
E. End West Appr. Pav't	109+71.71	20.00 Lt.	846.45

**NORTH EDGE OF PAVEMENT**

Location	Station	Offset (ft)	Theoretical Grade Elevations
W. End West Appr. Pav't.	109+41.71	12.00 Lt.	846.53
A1	109+51.71	12.00 Lt.	846.57
A2	109+61.71	12.00 Lt.	846.59
E. End West Appr. Pav't	109+71.71	12.00 Lt.	846.62

**☉ ROADWAY AND PROFILE GRADE**

Location	Station	Offset (ft)	Theoretical Grade Elevations
W. End West Appr. Pav't.	109+41.71	0.00	846.72
A1	109+51.71	0.00	846.75
A2	109+61.71	0.00	846.78
E. End West Appr. Pav't	109+71.71	0.00	846.80

**SOUTH EDGE OF PAVEMENT**

Location	Station	Offset (ft)	Theoretical Grade Elevations
W. End West Appr. Pav't.	109+41.71	12.00 Rt.	846.53
A1	109+51.71	12.00 Rt.	846.57
A2	109+61.71	12.00 Rt.	846.59
E. End West Appr. Pav't	109+71.71	12.00 Rt.	846.62

**SOUTH EDGE OF SHOULDER**

Location	Station	Offset (ft)	Theoretical Grade Elevations
W. End West Appr. Pav't.	109+41.71	20.00 Rt.	846.37
A1	109+51.71	20.00 Rt.	846.40
A2	109+61.71	20.00 Rt.	846.43
E. End West Appr. Pav't	109+71.71	20.00 Rt.	846.45

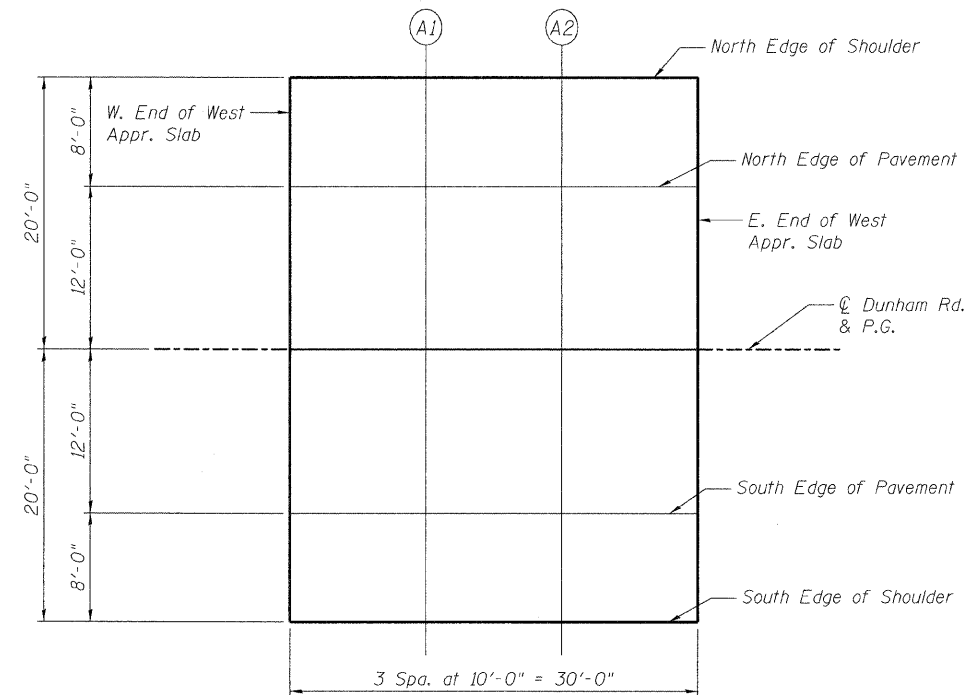

**PLAN**  
West Approach

m:\proj\3381\3381.02\design\Structural\CAD\3381.02 Top of West Approach Slab Elevations.dgn

FILE NAME = 3381.02 03 Top of West Approach Slab Elevations.dgn



USER NAME = espino	DESIGNED - SAT	REVISED -
PLOT SCALE =	CHECKED - AMK	REVISED -
PLOT DATE = 2/4/2011	DRAWN - RD	REVISED -
	CHECKED - BWS	REVISED -

**MCHENRY COUNTY DIVISION OF TRANSPORTATION**

**TOP OF WEST APPROACH SLAB ELEVATIONS**  
**STRUCTURE NO. 056-3180**  
SHEET NO. S-3 OF S-18 SHEETS

F.A. RTE.	SECTION	COUNTY	TOTAL SHEETS	SHEET NO.
	07-00340-00-BR	MCHENRY	46	20
CONTRACT NO. 63552				

ILLINOIS FED. AID PROJECT