

SCALE: N.T.S.

SECTION AT COMPLETION OF PHASE 2

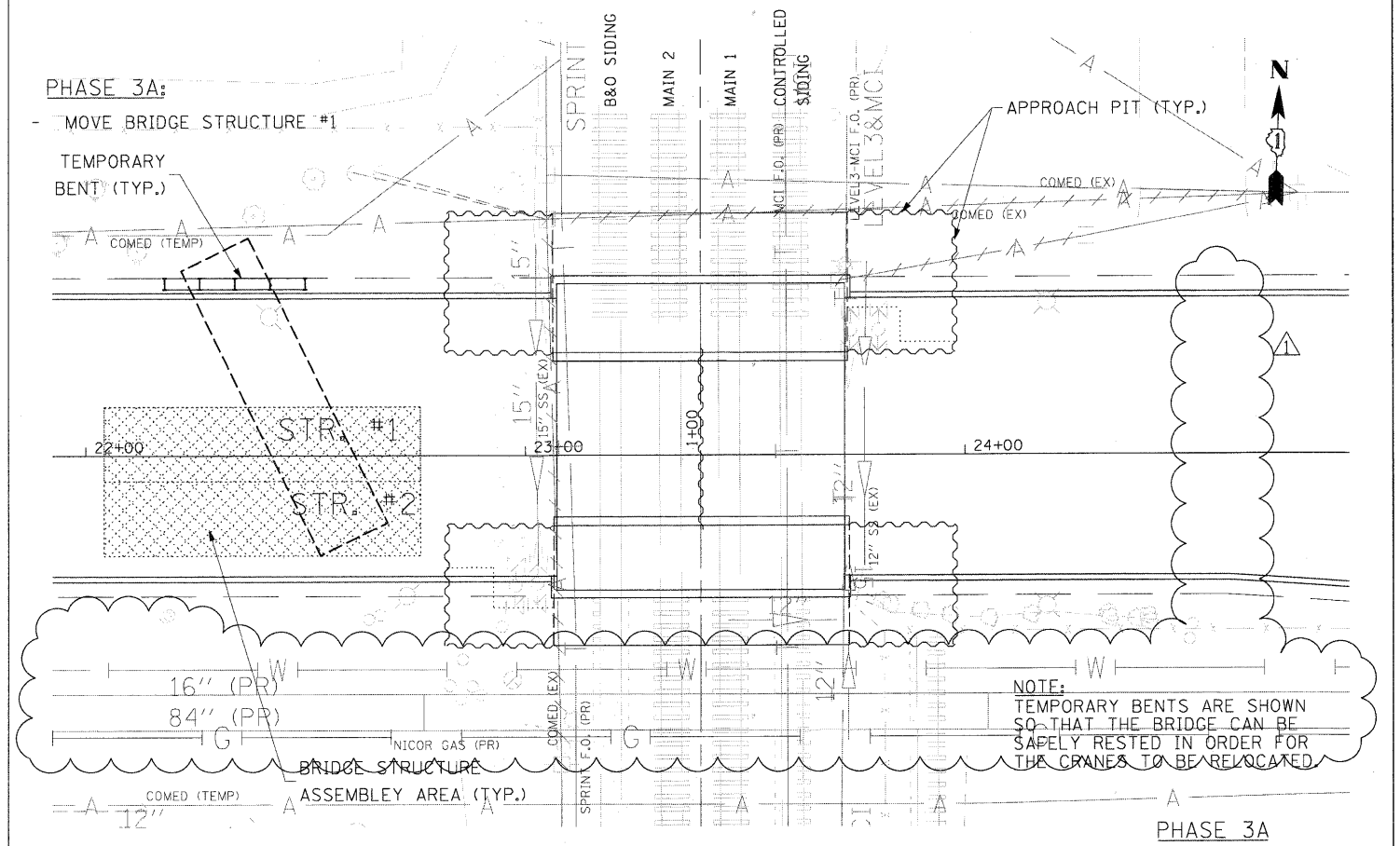

NOTE:
TEMPORARY BENTS ARE SHOWN SO THAT THE BRIDGE CAN BE SAFELY RESTED IN ORDER FOR THE CRANES TO BE RELOCATED.

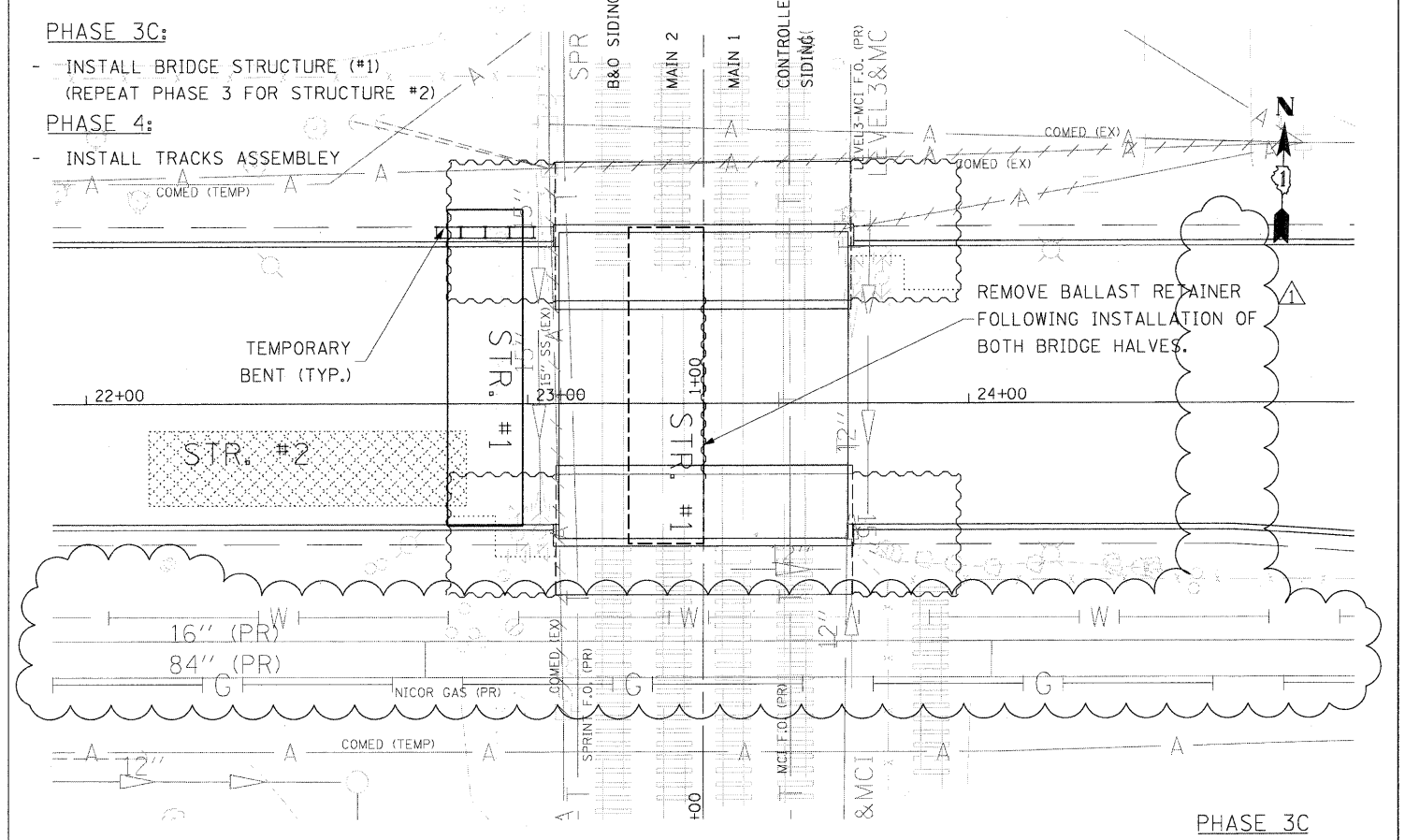
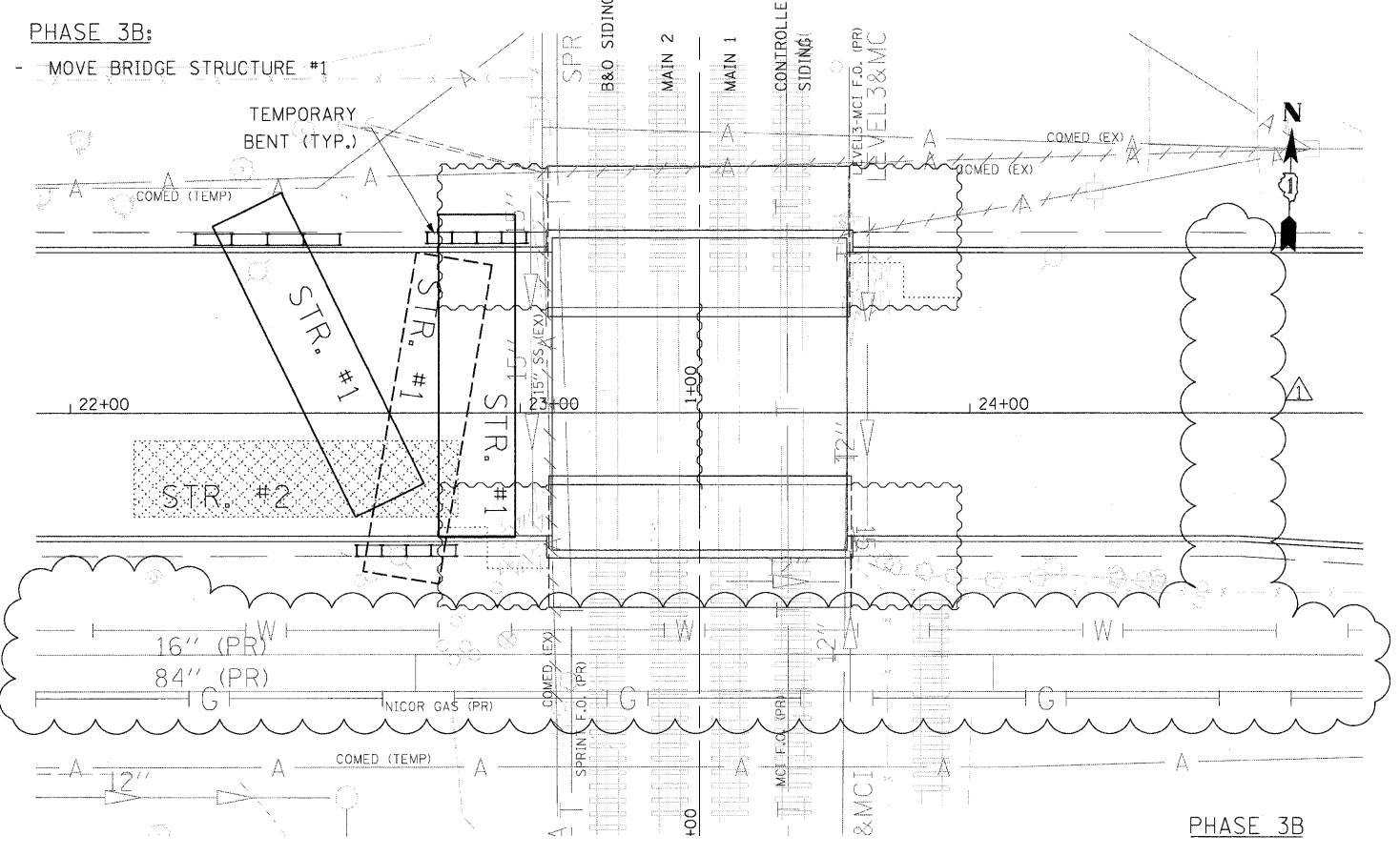

FILE NAME = P:\60155877_0000_CAD\001_Dr-w\ings\Sheets\Civil\60155877-ah-24_out_staging-02.dgn



USER NAME = merryl	DESIGNED - TJW	REVISED - 4/14/11 ADDENDUM
PLOT SCALE = 20,000' / in.	DRAWN - JWM	REVISED -
PLOT DATE = 4/12/2011	CHECKED - TJW	REVISED -
	DATE - March 17, 2011	REVISED -

**STATE OF ILLINOIS
DEPARTMENT OF TRANSPORTATION**

**BRIDGE OUTAGE - 24 HOURS
SUGGESTED STAGING**

SCALE: 1"=20' SHEET NO. 22 OF 65 SHEETS STA 58+60.00 TO STA 60+00.00

F.A.U. RTE.	SECTION	COUNTY	TOTAL SHEETS	SHEET NO.
1537	06-00050-00-GS	COOK	209	112C
FED. ROAD DIST. NO. 1		ILLINOIS FED. AID PROJECT CRE-90031709		