

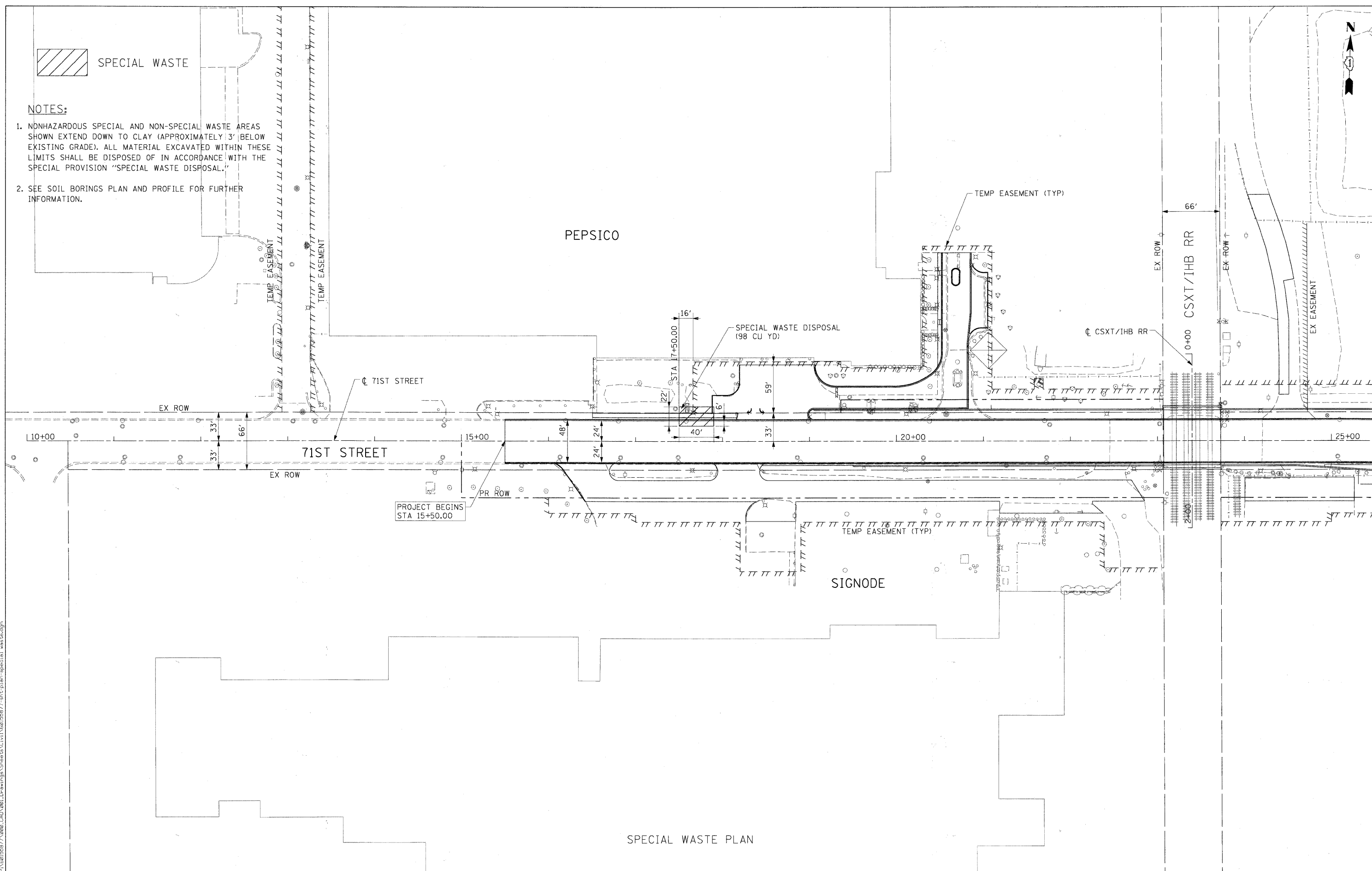

NOTES:

1. NONHAZARDOUS SPECIAL AND NON-SPECIAL WASTE AREAS SHOWN EXTEND DOWN TO CLAY (APPROXIMATELY 3' BELOW EXISTING GRADE). ALL MATERIAL EXCAVATED WITHIN THESE LIMITS SHALL BE DISPOSED OF IN ACCORDANCE WITH THE SPECIAL PROVISION "SPECIAL WASTE DISPOSAL."
2. SEE SOIL BORINGS PLAN AND PROFILE FOR FURTHER INFORMATION.



SPECIAL WASTE PLAN

FILE NAME = P:\60155877\002_CAD\001_Drawing\Sheets\Civil\60155877-01t.plm.apr101.wsd.dgn



USER NAME = manj	DESIGNED - NJH	REVISED -
PLOT SCALE = 50.000' / 1" =	DRAWN - NJH	REVISED -
PLOT DATE = 2/17/2011	CHECKED - TJW	REVISED -
DATE - FEBRUARY 17, 2011	REVISIONS	REVISED -

**STATE OF ILLINOIS
DEPARTMENT OF TRANSPORTATION**

SPECIAL WASTE PLAN

SCALE: 1"=50' SHEET NO. 1 OF 1 SHEETS STA 15+50.00 TO STA 25+00.00

F.A.U. RTE.	SECTION	COUNTY	TOTAL SHEETS	SHEET NO.
1537	06-00050-00-GS	COOK	209	18
CONTRACT NO. 63556			FED. ROAD DIST. NO. 1 ILLINOIS FED. AID PROJECT CRE-9003(709)	