

SECTION 24, TOWNSHIP 38, RANGE 12  
SECTION 25, TOWNSHIP 38, RANGE 12

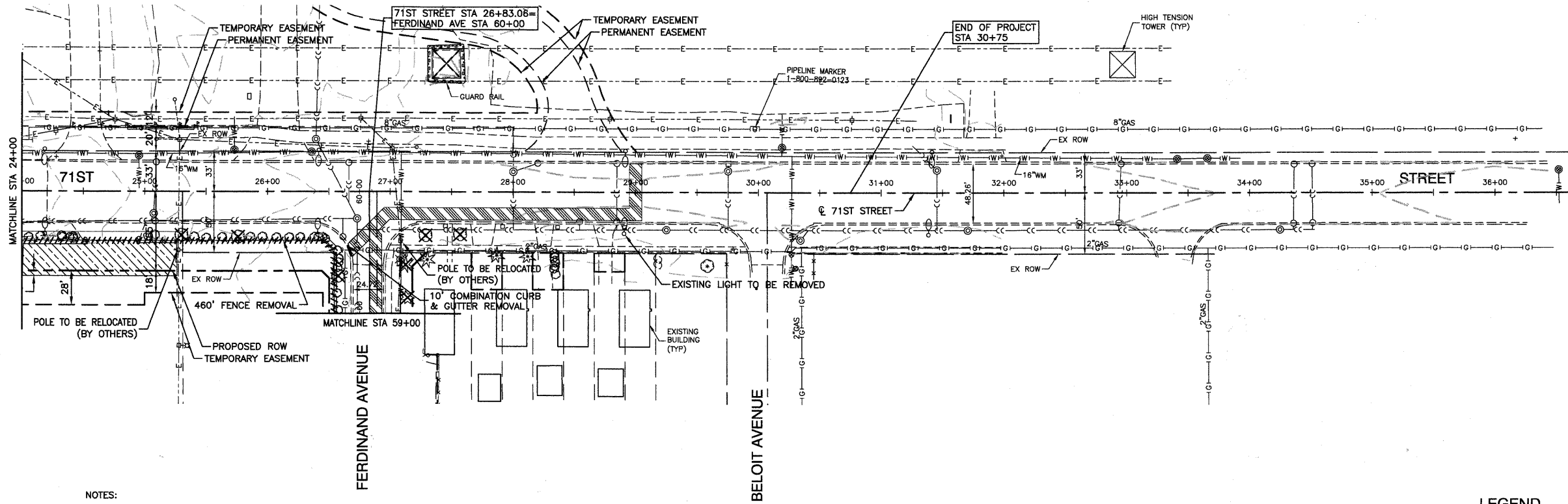

PLAN	SURVEYED	DATE
NOTE BOOK	ALIGNED	
NO.	RT. OF WAY CHECKED	
	GOOD FILE NAME	



NOTES:  
1. CONTRACTOR MUST MAINTAIN ACCESS TO PROPERTIES AT ALL TIMES.

**LEGEND**

	DRIVEWAY PAVEMENT REMOVAL
	CONCRETE SIDEWALK REMOVAL
	PAVEMENT PATCHING
	PAVEMENT REMOVAL
	SUB-BASE GRANULAR MATERIAL TYPE B, 4" AND HOT-MIX ASPHALT PAVEMENT (FULL DEPTH), 12"
	HOT-MIX ASPHALT DRIVEWAY PAVEMENT; 6" HOT-MIX ASPHALT SURFACE COURSE, MIX "C", N50(L-9.5mm); 2" HOT-MIX ASPHALT BINDER COURSE, IL-19.0, N50; 4"

PROFILE	SURVEYED	DATE
NOTE BOOK	GRADES CHECKED	
	B.M. NOTED	

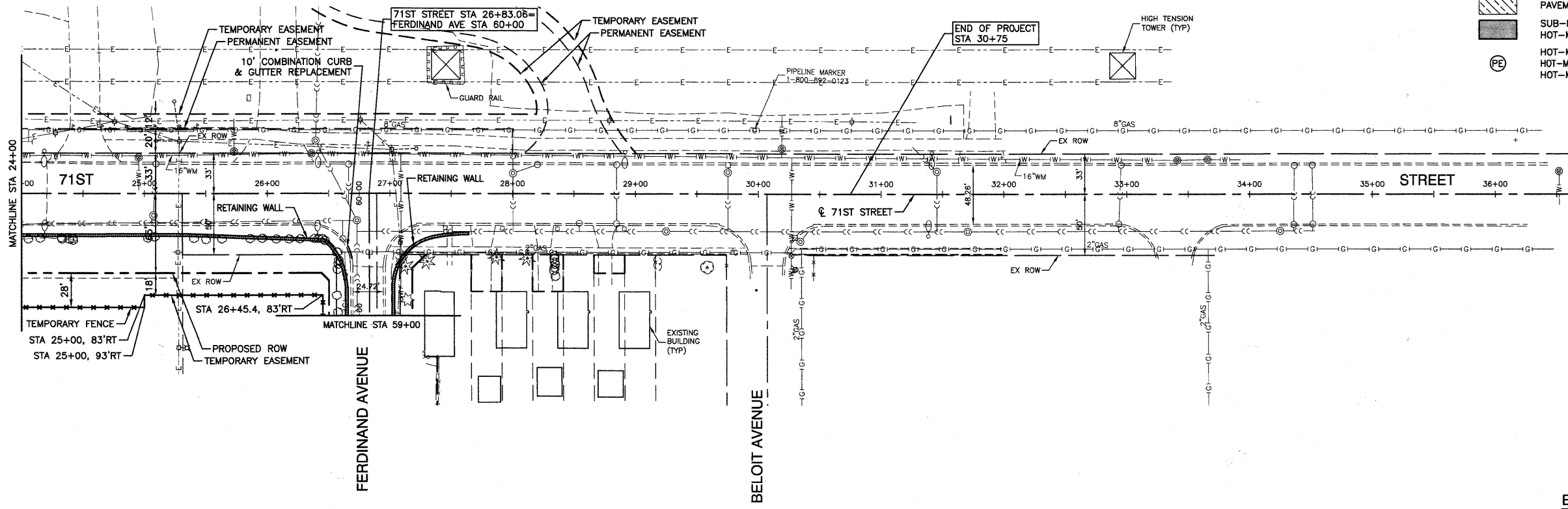

**BENCH MARK: BW249**  
SQUARE CUT ON N CONC BASE OF RR SIGNAL  
MAST ARM BASE ON S ROW OF 71ST STREET  
1/2 MILE WEST OF HARLEM AVENUE  
ELEVATION=620.57

FILE NAME = 09553-PLPR-01 - EX02	USER NAME =	DESIGNED - PKB	REVISED - REL - 01-14-11	<b>STATE OF ILLINOIS DEPARTMENT OF TRANSPORTATION</b>		<b>71ST STREET</b>		F.A.U. RTE.	SECTION	COUNTY	TOTAL SHEETS	SHEET NO.
	PLOT SCALE =	CHECKED - PKB	REVISED -			UTILITY RELOCATION INTERIM ROADWAY PLAN		1537	06-00050-00-GS	COOK	209	20
	PLOT DATE = 12/23/10	DRAWN - PS	REVISED -	SCALE: 1"=50'		SHEET NO. 20	OF 209 SHEETS	STA. 24+00	TO STA. 30+75	CONTRACT NO. 63556		
		CHECKED - AG	REVISED -					FED. ROAD DIST. NO. 1	ILLINOIS	FED. AID PROJECT	CRE-9003(709)	

AT SAVED BY: ROUNDBOR ON 11/14/11  
COTED BY: RICHARD BLONK ON 2/21/11