

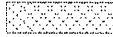

**LEGEND:**  
 CONSTRUCTION WORK ZONE

ML REALTY

PEPSICO

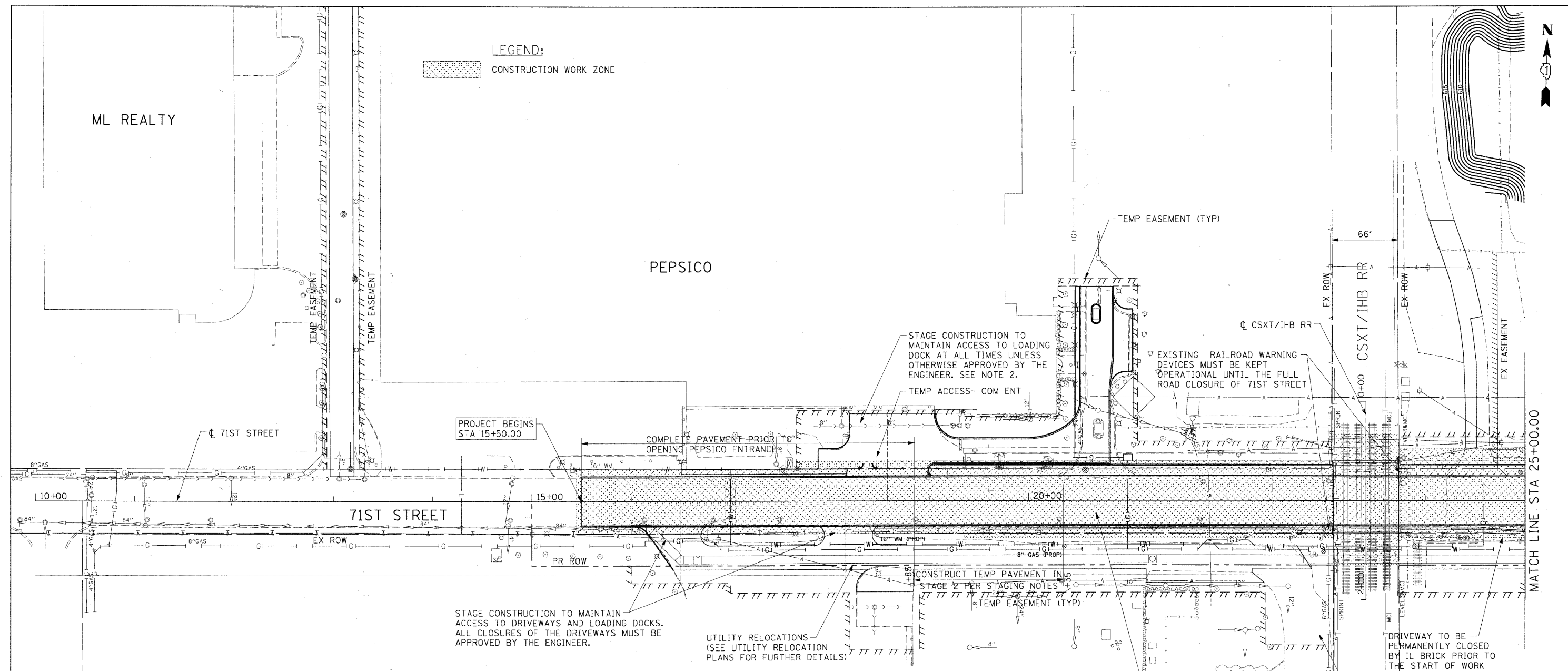

**PROJECT COMMITMENTS FOR THE CSXT**

1. REFERENCE SHEETS 29 AND 108-109 FOR SUGGESTED CONSTRUCTION STAGING DETAILS. SEE THE SPECIAL PROVISIONS FOR ADDITIONAL PROJECT COMMITMENTS AND REQUIREMENTS FOR THE CSXT.

**PROJECT COMMITMENTS FOR 71ST STREET AND THE VILLAGE OF BRIDGEVIEW**

2. SEE THE SPECIAL PROVISIONS AND SHEETS 34 THRU 37 FOR ADDITIONAL PROJECT COMMITMENTS AND REQUIREMENTS FOR 71ST STREET AND THE VILLAGE OF BRIDGEVIEW.

**STAGING NOTES**

3. ALL WORK IN THIS STAGE SHALL BE DONE ACCORDING TO THE DETAILS IN THE PLANS AND USING THE APPROPRIATE HIGHWAY STANDARDS.

SIGNODE

FILE NAME = P:\156015587\0200\_GAO\_001\_Drawing\Sheet\Civil\1560155877-ext-staging-01.dgn



USER NAME = mornj	DESIGNED - TJW	REVISED -
PLOT SCALE = 50.000' / in.	DRAWN - JWM	REVISED -
PLOT DATE = 3/15/2011	CHECKED - TJW	REVISED -
	DATE - March 17, 2011	REVISED -

**STATE OF ILLINOIS  
 DEPARTMENT OF TRANSPORTATION**

**WORK ZONE AND STAGING REQUIREMENTS PLAN -  
 71ST ST**

SCALE: 1"=50' SHEET NO. 1 OF 10 SHEETS STA 15+50.00 TO STA 25+00.00

F.A.U. RTE.	SECTION	COUNTY	TOTAL SHEETS	SHEET NO.
1537	06-00050-00-GS	COOK	209	32
FED. ROAD DIST. NO. 1 ILLINOIS FED. AID PROJECT			CONTRACT NO. 63556	
CRE-9003(709)				