

PLAN	SURVEYED	DATE
NOTE BOOK NO.	PLOTTED	
	CHECKED	
	BY	
	DATE	

PROFILE	SURVEYED	DATE
NOTE BOOK	PLOTTED	
	CHECKED	
	BY	
	DATE	

**BENCH MARK: BW249**  
SQUARE CUT ON N CONC BASE OF RR SIGNAL  
MAST ARM BASE ON S ROW OF 71ST STREET  
1/4 MILE WEST OF HARLEM AVENUE  
ELEVATION=620.57

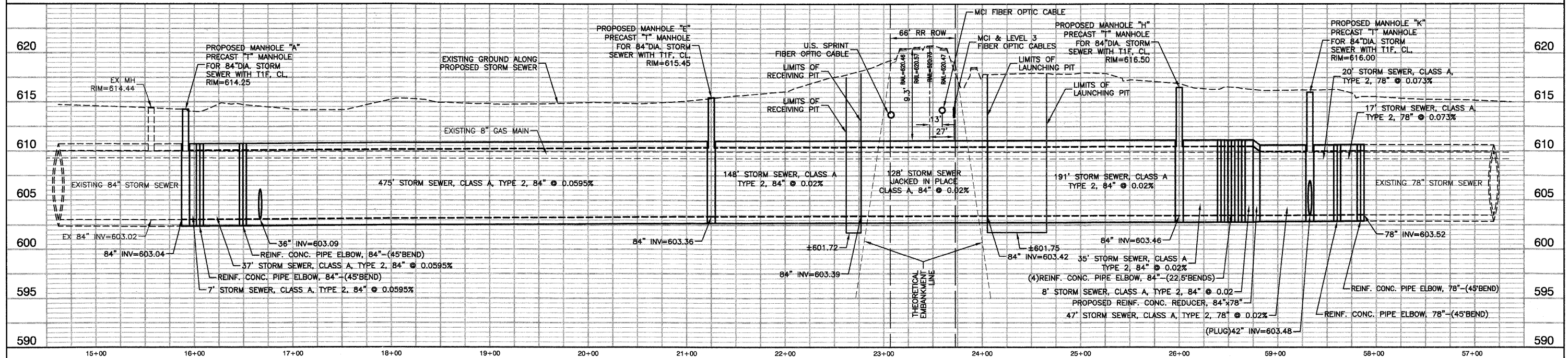

PROPOSED 78" & 84" STORM SEWER

FILE NAME = 09053-PLPR-01 - PR01	USER NAME =	DESIGNED -- PKB	REVISED --	<b>STATE OF ILLINOIS DEPARTMENT OF TRANSPORTATION</b>	71ST STREET		F.A.U. RTE. 1537	SECTION 06-00050-00-GS	COUNTY COOK	TOTAL SHEETS 209	SHEET NO. 50	
	PLOT SCALE =	CHECKED -- PKB	REVISED --		STORM SEWER PROFILE - 84"		SCALE: H 1"=50' V 1"=5'		SHEET NO. 50 OF 209 SHEETS	STA. TO STA.	CONTRACT NO. 63556	
	PLOT DATE = 12/23/10	DRAWN -- PS	REVISED --				FED. ROAD DIST. NO. 1 ILLINOIS		FED. AID PROJECT CRE-9003(709)			
		CHECKED -- AG	REVISED --									

ST. SALES BY: 8/20/2004 ON 12/11/11  
DTED BY: 8/20/2004 ON 12/11/11