

**NOTE:**

FINAL LIMITS OF RESURFACING IN THE MLRP EASEMENT AREA ARE TO BE DETERMINED BY THE ENGINEER DURING CONSTRUCTION.

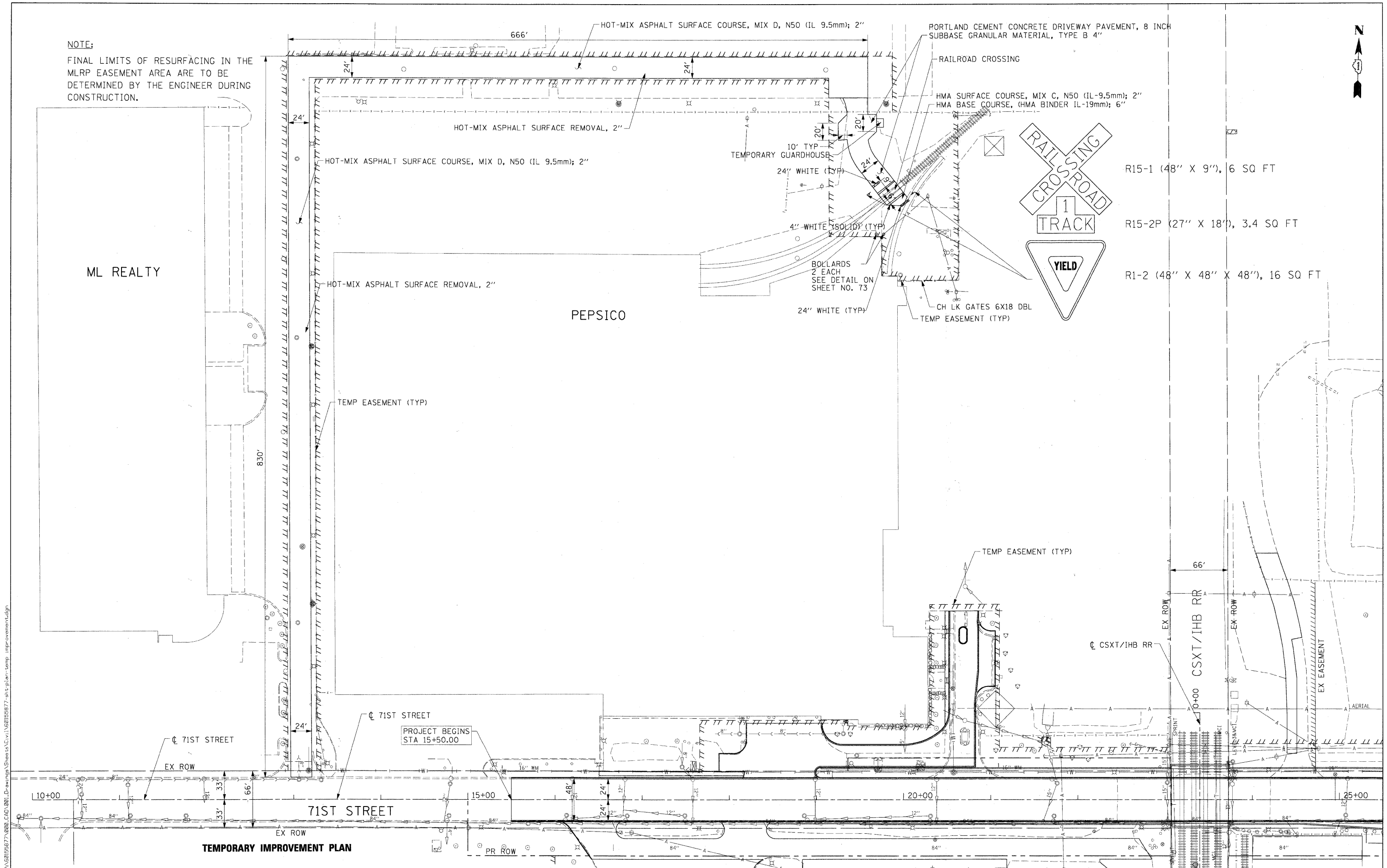

- R15-1 (48" X 9"), 6 SQ FT
- R15-2P (27" X 18"), 3.4 SQ FT
- R1-2 (48" X 48" X 48"), 16 SQ FT

FILE NAME = F:\02150577\020\_CAD\001\_Drawing\Sheets\01\160150577-1ht.plt; temp\_improvement.dgn



USER NAME = marnj	DESIGNED - TJW	REVISED -
PLOT SCALE = 50.000' / 1"	DRAWN - JWM	REVISED -
PLOT DATE = 2/17/2011	CHECKED - TJW	REVISED -
	DATE - FEBRUARY 17, 2011	REVISED -

**STATE OF ILLINOIS  
DEPARTMENT OF TRANSPORTATION**

**TEMPORARY IMPROVEMENT PLAN**

SCALE: 1"=50' SHEET NO. 1 OF X SHEETS STA 15+50.00 TO STA 25+00.00

F.A.U. RTE.	SECTION	COUNTY	TOTAL SHEETS	SHEET NO.
1537	06-00050-00-GS	COOK	209	68
CONTRACT NO. 63556			FED. ROAD DIST. NO. 1 ILLINOIS FED. AID PROJECT CRE-90031709	

TEMPORARY IMPROVEMENT PLAN