

BY	DATE
FINAL SURVEY	SURVEYED
NOTE BOOK	PLOTTED
NO.	TEMPLATE
	AREAS CHECKED

BY	DATE
ORIGINAL SURVEY	SURVEYED
NOTE BOOK	PLOTTED
NO.	TEMPLATE
	AREAS CHECKED

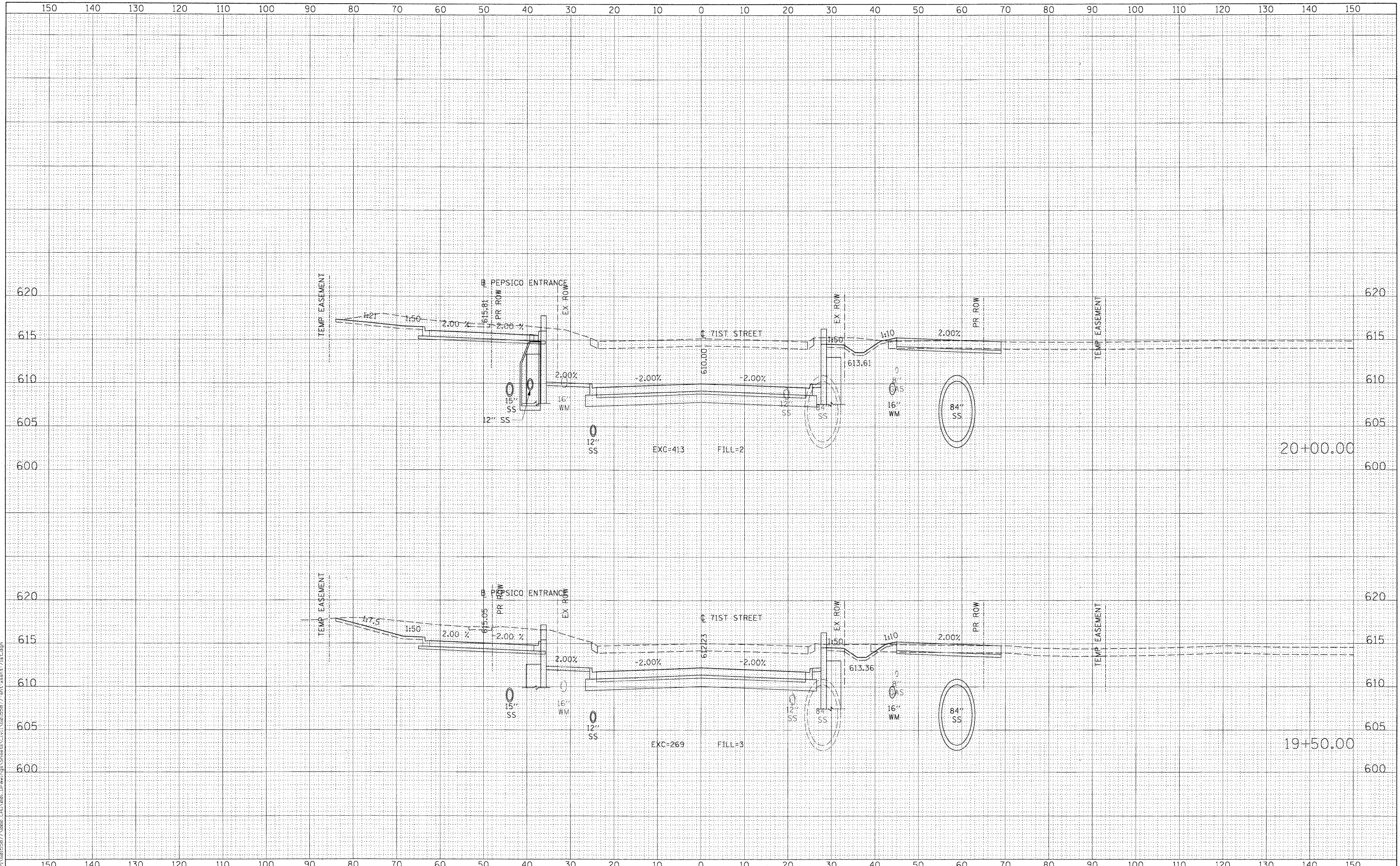

FILE NAME = P:\015577\020 CAD\021 Drawings\Sheet\Civil\02150877.dwg xahh 71stLden



USER NAME = mahnj	DESIGNED - NJH	REVISED -
PLOT SCALE = 10.000' / in.	DRAWN - NJH	REVISED -
PLOT DATE = 2/17/2011	CHECKED - TJW	REVISED -
	DATE - DECEMBER 12, 2010	REVISED -

**STATE OF ILLINOIS
DEPARTMENT OF TRANSPORTATION**

CROSS SECTIONS - 71ST STREET

H: 1"=10', V: 1"=5' SHEET NO. 6 OF 20 SHEETS STA. 19+50.00 TO STA. 20+00.00

F.A.U. RTE.	SECTION	COUNTY	TOTAL SHEETS	SHEET NO.
1537	06-00050-00-GA	COOK	209	187
				CONTRACT NO. 63556
ILLINOIS FED. AID PROJECT				