

FINAL SURVEY	DATE
SURVEYED	BY
PLOTTED	
NOTE BOOK	
TEMPLATE	
AREAS CHECKED	
NO.	

ORIGINAL SURVEY	DATE
SURVEYED	BY
PLOTTED	
NOTE BOOK	
TEMPLATE	
AREAS CHECKED	
NO.	

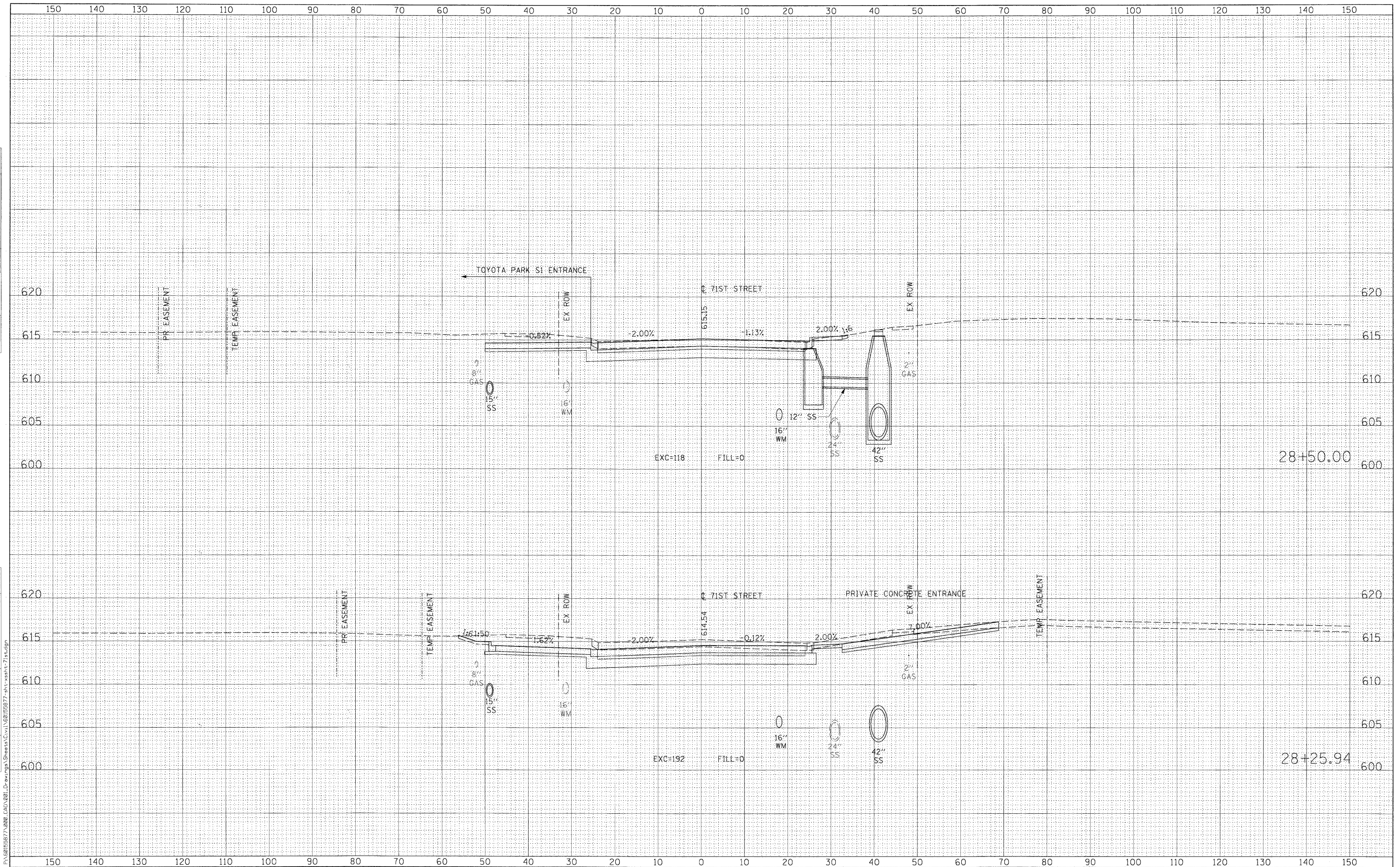

FILE NAME = F:\60155877\0208 CAD\001_Dr\civ\p\Sheesa\Civil\60155877-ahs-ss\st-71st.dgn



USER NAME = mernj	DESIGNED - NJH	REVISED -
PLOT SCALE = 10.000' / 1" =	DRAWN - NJH	REVISED -
PLOT DATE = 2/17/2011	CHECKED - TJW	REVISED -
	DATE - DECEMBER 12, 2010	REVISED -

STATE OF ILLINOIS
DEPARTMENT OF TRANSPORTATION

CROSS SECTIONS - 71ST STREET

H: 1"=10', V: 1"=5' SHEET NO. 16 OF 20 SHEETS STA. 28+25.94 TO STA. 28+50.00

F.A.U. RTE.	SECTION	COUNTY	TOTAL SHEETS	SHEET NO.
1537	06-00050-00-GA	COOK	209	197
CONTRACT NO. 63556			ILLINOIS FED. AID PROJECT	