

STATE OF ILLINOIS
 DEPARTMENT OF TRANSPORTATION
 RIGHT OF WAY PLANS
 FOR PROPOSED
 FEDERAL AID HIGHWAY

ROUTE: T.R. 37 (GRAF ROAD)
 SECTION: 06-00322-00-BR
 PROJECT NO.:
 JOB NO.: R-55-001-97
 COUNTY: McHENRY
 LIMITS: @ LAWRENCE CREEK

F.A. RTE.	SECTION	COUNTY	TOTAL SHEETS	SHEET NO.
0037	06-00322-00-BR	McHENRY	54	16
F.H.W.A. REG.		ILLINOIS	PROJECT BROS-00-DT(683)	

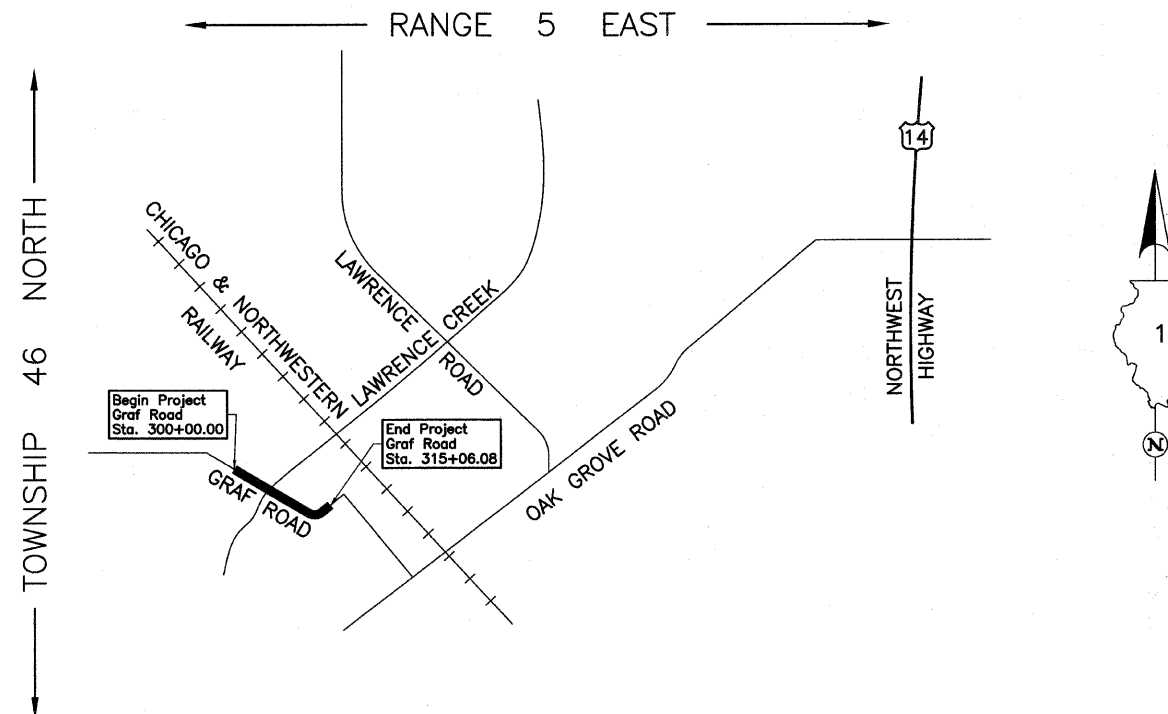
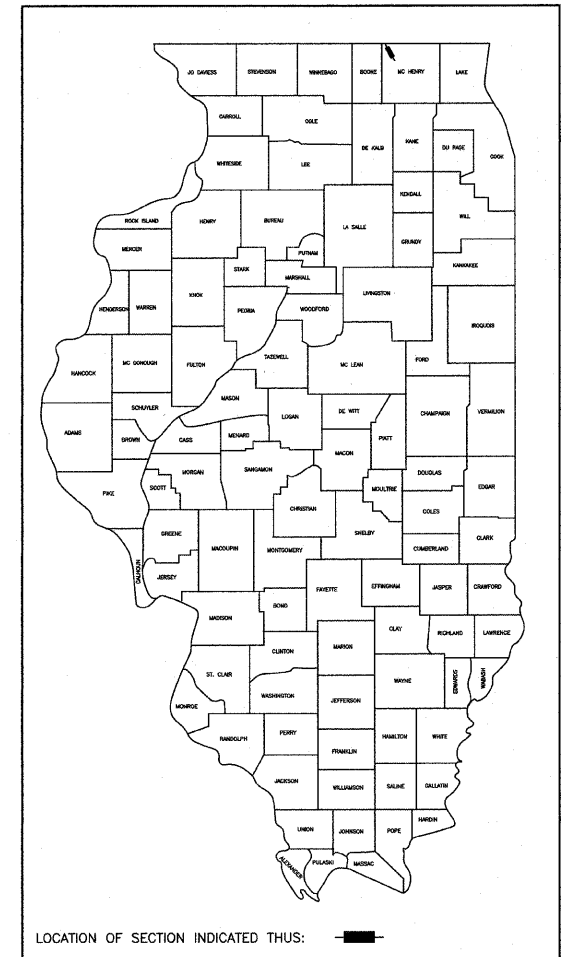

PROJECT LENGTH = 1,506.08 LIN. FT. = 0.285 MILE, GRAF ROAD

APPROVED _____ 20 _____
 LOCAL AGENCY OFFICIAL

APPROVED _____ 20 _____
 ENGINEER OF LAND ACQUISITION

APPROVED _____ 20 _____
 ENGINEER OF LOCAL ROADS & STREETS

APPROVED _____ 20 _____
 DISTRICT ENGINEER

STATE OF ILLINOIS
 DEPARTMENT OF TRANSPORTATION