

TRAFFIC CONTROL PLAN STAGE I

Prior to installing traffic control for each stage, Mr. Scott Kullerstrand shall be notified at 815/284-5468. He or his representative will be on sight to verify signal location and coordinate temporary signals with existing traffic signals.
Refer to Standard 701321 for additional requirements for signs and devices.

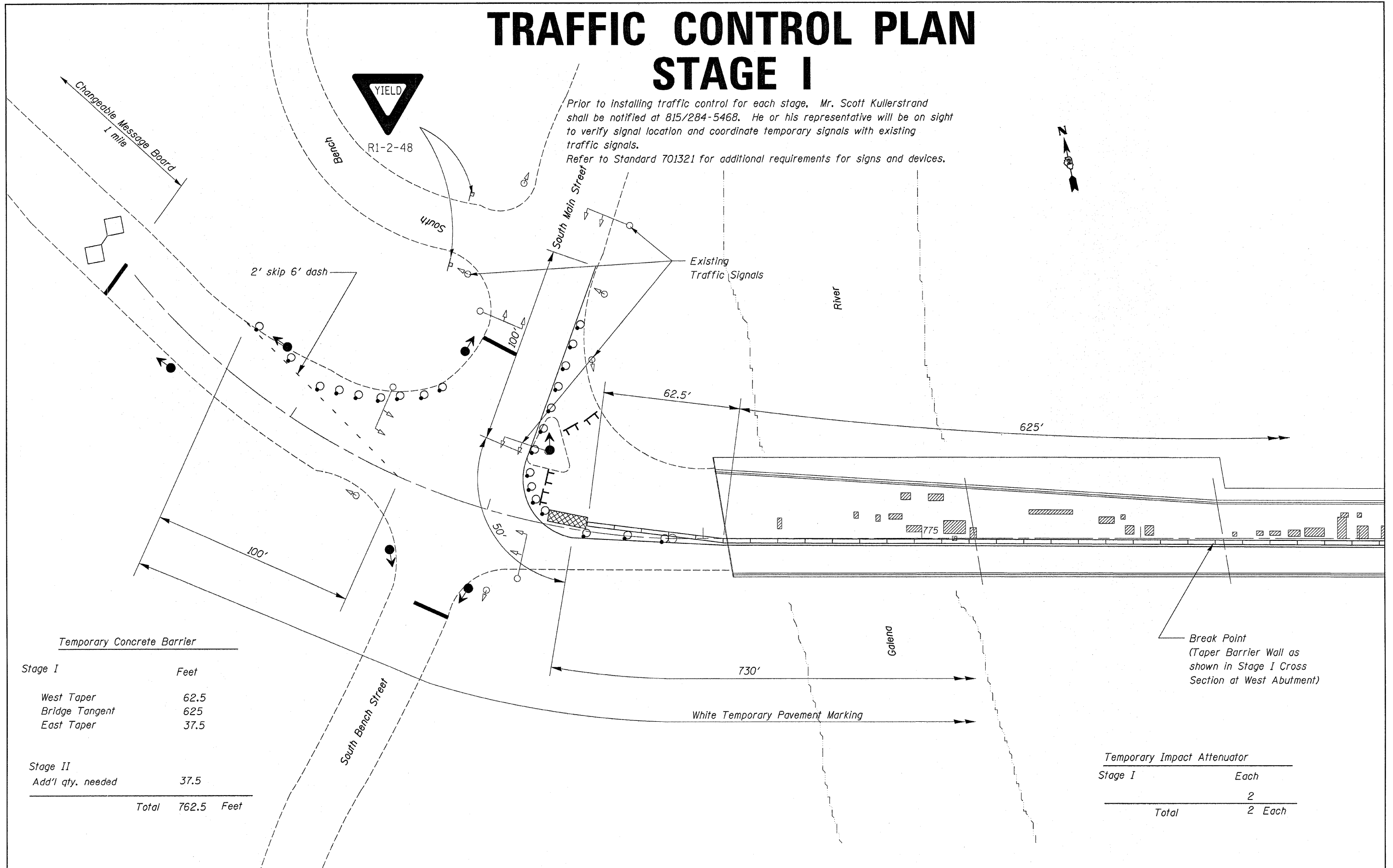

Temporary Concrete Barrier

Stage I	Feet
West Taper	62.5
Bridge Tangent	625
East Taper	37.5
<hr/>	
Stage II	
Add'l qty. needed	37.5
<hr/>	
Total	762.5 Feet

Temporary Impact Attenuator

Stage I	Each
	2
<hr/>	
Total	2 Each

FILE NAME =	USER NAME = jinkdj	DESIGNED -	REVISD -
G:\BRY\CADD plans\Jo Daviess County\043043\PLANeng.dgn		DRAWN -	REVISD -
	PLOT SCALE = 28.0000' / IN.	CHECKED -	REVISD -
	PLOT DATE = Mon Jan 31 07:52:46 2011	DATE -	REVISD -

**STATE OF ILLINOIS
DEPARTMENT OF TRANSPORTATION**

**Traffic Control Plan Stage I
Structure No. 043-0043**

SCALE: _____ SHEET NO. ____ OF ____ SHEETS STA. _____ TO STA. _____

F.A.P. RTE. 301	SECTION (102VBRM-1)	COUNTY Jo Daviess	TOTAL SHEETS 22	SHEET NO. 10
CONTRACT NO. 64G82			ILLINOIS FED. AID PROJECT	