

**EXISTING DRAINAGE LEGEND**

- [R] DRAINAGE STRUCTURE REMOVAL
  - [F] DRAINAGE STRUCTURE TO BE FILLED
  - XXX DRAINAGE PIPE OR PAVED DITCH REMOVAL
- NOTE: REMOVAL OF EXISTING END SECTIONS AND CONCRETE HEADWALLS SHALL NOT BE MEASURE FOR PAYMENT, BUT SHALL BE CONSIDERED INCIDENTAL TO THE COST OF REM. OF STORM SEWERS & CULVERTS.

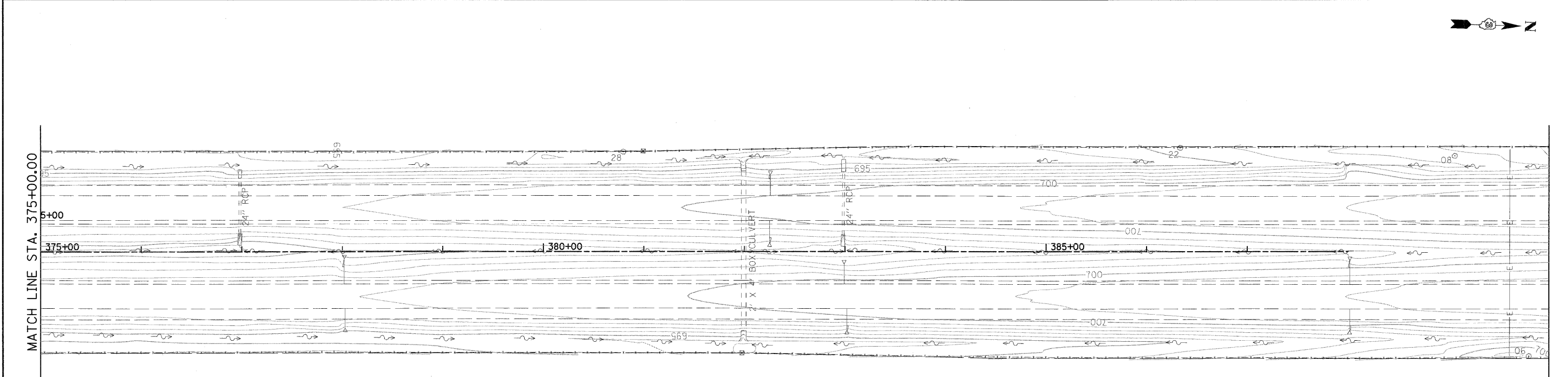

**EXISTING DRAINAGE LEGEND**

- [R] DRAINAGE STRUCTURE REMOVAL
  - [F] DRAINAGE STRUCTURE TO BE FILLED
  - XXX DRAINAGE PIPE OR PAVED DITCH REMOVAL
- NOTE: REMOVAL OF EXISTING END SECTIONS AND CONCRETE HEADWALLS SHALL NOT BE MEASURE FOR PAYMENT, BUT SHALL BE CONSIDERED INCIDENTAL TO THE COST OF REM. OF STORM SEWERS & CULVERTS.

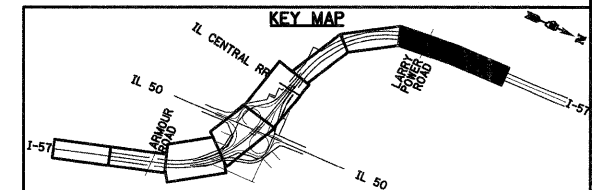

FILE NAME = I:\Dgn\sheet\du06.dgn	USER NAME = EricG	DESIGNED - JWM	REVISED -	<b>STATE OF ILLINOIS DEPARTMENT OF TRANSPORTATION</b>	<b>EXISTING DRAINAGE AND UTILITY PLAN</b>			F.A.I. RTE. 57	SECTION (46-2) I, HBR, VBR	COUNTY KANKAKEE	TOTAL SHEETS 558	SHEET NO. 138
	PLOT SCALE = 1:50	DRAWN - JWM	REVISED -		SCALE:	SHEET NO.	OF SHEETS	STA.	TO STA.	CONTRACT NO. 66409		
	PLOT DATE = 12/22/2010	CHECKED - EJG	REVISED -							FED. ROAD DIST. NO. 3 ILLINOIS FED. AID PROJECT		
		DATE - 12/17/10	REVISED -									