

**STAGE A**

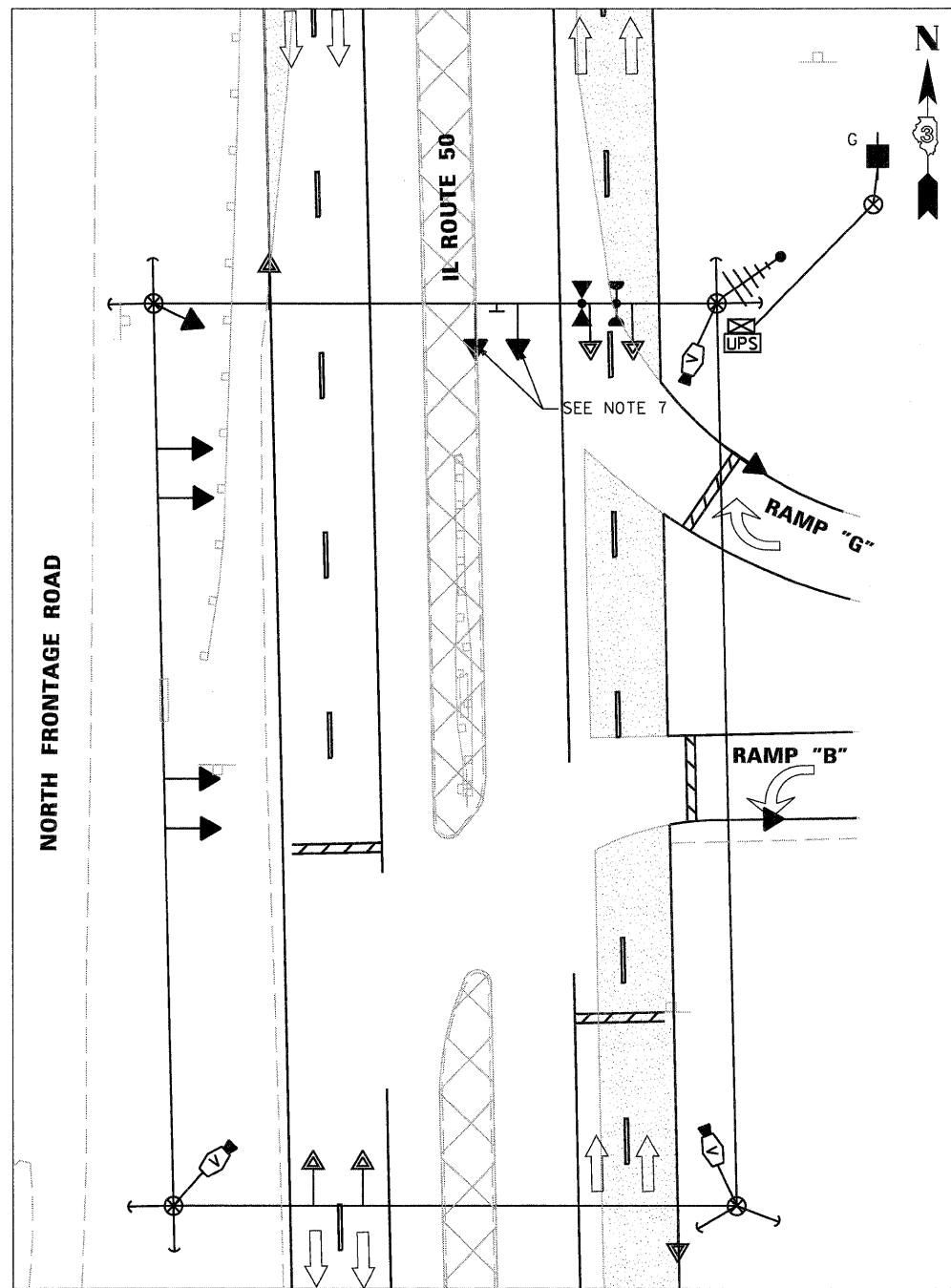

**STAGE B**

**TEMPORARY TRAFFIC SIGNAL LEGEND:**

- TEMPORARY TRAFFIC SIGNAL CONTROLLER [Symbol]
- TEMPORARY TRAFFIC SIGNAL HEAD [Symbol]
- SPAN WIRE MOUNTED ORIGINAL LOCATION [Symbol]
- TEMPORARY TRAFFIC SIGNAL HEAD [Symbol]
- SPAN WIRE MOUNTED SECONDARY LOCATION [Symbol]
- TEMPORARY WOOD POLE (CLASS 5 OR BETTER) 45 FOOT MINIMUM [Symbol]
- TEMPORARY SPAN WIRE, TETHER WIRE, AND CABLE [Symbol]
- TEMPORARY SERVICE INSTALLATION-POLE MOUNTED [Symbol]
- VIDEO DETECTION CAMERA [Symbol]
- G.S. CONDUIT IN TRENCH OR PUSHED [Symbol]
- DOWN GUY OR SIDEWALK GUY [Symbol]
- UNINTERRUPTIBLE POWER SUPPLY [Symbol]
- TEMPORARY WIRELESS INTERCONNECT ANTENNA [Symbol]

THE FOLLOWING EXISTING TRAFFIC SIGNAL EQUIPMENT SHALL BE REMOVED BY THE CONTRACTOR, ALL TRAFFIC SIGNAL EQUIPMENT WHICH IS TO BE REMOVED SHALL BECOME THE PROPERTY OF THE CONTRACTOR AND SHALL BE DISPOSED OF OUTSIDE THE RIGHT OF WAY AT THE CONTRACTOR'S EXPENSE.

- 6 EACH SIGNAL HEAD, 1-FACE
- 3 EACH ALUMINUM MAST ARM ASSEMBLY AND POLE
- 6 EACH TRAFFIC SIGNAL BACKPLATE

**NOTE:**

1. FOR R.O.W. SEE ROADWAY PLAN.

RESTORATION OF WORK AREA: RESTORATION OF THE TRAFFIC SIGNAL WORK AREA SHALL BE INCIDENTAL TO THE RELATED PAY ITEM SUCH AS FOUNDATION, CONDUIT, HANDHOLE, TRENCH AND BACKFILL, ETC.. AND NO EXTRA COMPENSATION SHALL BE ALLOWED. ALL ROADWAY SURFACES SUCH AS SHOULDERS, MEDIAN, SIDEWALKS, PAVEMENT, ETC. SHALL BE REPLACED IN KIND. ALL DAMAGE TO MOWED LAWNS SHALL BE REPLACED WITH AN APPROVED SOD, AND ALL DAMAGE TO UNMOWED FIELDS SHALL BE SEEDED IN ACCORDANCE WITH STANDARD SPECIFICATIONS 252 AND 250 RESPECTIVELY.

**NOTES FOR TEMPORARY TRAFFIC SIGNALS:**

- ALL CONTROL EQUIPMENT INCLUDING EMERGENCY PRE-EMPTION AND COMMUNICATION DEVICES FOR THE TEMPORARY TRAFFIC SIGNALS SHALL BE FURNISHED BY THE CONTRACTOR.
- ONLY CONTROLLERS SUPPLIED BY ONE OF THE DISTRICT APPROVED CLOSED LOOP EQUIPMENT MANUFACTURERS WILL BE APPROVED FOR THE USE AT TEMPORARY SIGNAL LOCATIONS. ALL CONTROLLERS USED FOR TEMPORARY TRAFFIC SIGNALS SHALL BE FULLY ACTUATED NEMA MICROPROCESSOR BASED WITH RS232 DATA ENTRY PORTS COMPATIBLE WITH EXISTING MONITORING SOFTWARE APPROVED BY IDOT DISTRICT 3, INSTALLED IN A NEMA TS1 OR TS2 CABINET. ONLY ONE BRAND OF CONTROLLER WILL BE ACCEPTED FOR ANY ONE CONTRACT.
- ALL TRAFFIC SIGNAL SECTIONS AND PEDESTRIAN SIGNAL SECTIONS SHALL BE 12". HEADS SHALL BE PLACED AS INDICATED ON THE TEMPORARY TRAFFIC SIGNAL PLAN OR AS INDICATED BY THE ENGINEER. THE CONTRACTOR SHALL FURNISH ENOUGH CABLE SLACK TO RELOCATE HEADS TO ANY POSITION ON THE SPAN WIRE OR AT LOCATIONS ILLUSTRATED ON THE PLANS FOR CONSTRUCTION STAGING. THE TEMPORARY TRAFFIC SIGNAL SHALL REMAIN IN OPERATION DURING ALL SIGNAL HEAD RELOCATIONS. EACH TEMPORARY TRAFFIC SIGNAL HEAD SHALL HAVE ITS OWN CABLE FROM THE CONTROLLER CABINET TO THE SIGNAL HEAD.

- ALL EXISTING STREET NAME AND INTERSECTION REGULATORY SIGNS SHALL BE REMOVED FROM EXISTING POLES, RELOCATED AND SECURELY FASTENED TO THE SIGNAL SPAN WIRE OR WOOD POLE AS DIRECTED BY THE ENGINEER.
- ANY TEMPORARY SIGNAL WITHIN AN EXISTING CLOSED LOOP TRAFFIC SIGNAL SYSTEM SHALL BE INTERCONNECTED TO THAT SYSTEM USING SIMILAR BRAND CONTROL EQUIPMENT.
- THE TEMPORARY TRAFFIC SIGNAL SHALL HAVE THE SIGNAL HEAD DISPLAYS, SIGNAL HEAD PLACEMENTS AND CONTROLLER PHASING MATCH THE EXISTING TRAFFIC SIGNAL, AT THE TIME OF THE TURN ON, IF NO TRAFFIC STAGING IS IN PLACE OR WILL NOT BE STAGED ON THE DAY OF THE TURN ON.
- THIS TRAFFIC SIGNAL SECTIONS SHALL BE DEACTIVATED AND BAGGED DURING STAGE "A, B & C" AND AS REQUIRED DURING CONSTRUCTION STAGING. THE TRAFFIC SECTIONS SHALL BE UNBAGGED AT THE END OF STAGE "C" CONSTRUCTION.
- THE SIGN SHALL BE BAGGED DURING STAGE "A, B & C" AND AS REQUIRED DURING CONSTRUCTION STAGING. THE SIGN SHALL BE UNBAGGED AT THE END OF STAGE "C" CONSTRUCTION.
- ALL VIDEO IMAGE SENSOR TO BE MOUNTED ON TEMPORARY WOOD POLE.

**LEFT ON GREEN ARROW ONLY**

**RI0-5**  
2 SIGNS REQUIRED

FILE NAME = g:\zd40403\ts-b.dgn	USER NAME = kkhon	DESIGNED - JA	REVISED -	<b>STATE OF ILLINOIS DEPARTMENT OF TRANSPORTATION</b>	<b>TRAFFIC SIGNAL TEMPORARY INSTALLATION &amp; REMOVAL OF EXISTING EQUIPMENT RAMP-FG &amp; IL 50-STAGE A &amp; B</b>	F.A.I. RTE. = 57	SECTION = (46-2) I, HBR, VBR	COUNTY = KANKAKEE	TOTAL SHEETS = 558	SHEET NO. = 233		
PLOT SCALE = 1:200	DRAWN - RM/IS	CHECKED - HS	REVISED -			SCALE:	SHEET NO. OF SHEETS	STA. TO STA.	FED. ROAD DIST. NO. 3   ILLINOIS FED. AID PROJECT			
PLOT DATE = 12/17/2010	DATE = 12-17-2010	REVISED -	REVISED -			CONTRACT NO. 66409						