

BENCH MARK

B.M. # 216: Set chiseled "□" on NE corner of North Bridge Wall of SB I-57 over IL Rte. 50
El. = 707.838

EXISTING STRUCTURES

SN 046-0014 (S.B.) built in 1965 & SN 046-0015 (N.B.) built in 1963 as F.A.I. Rte. 57 (I-57), Sec. 46-2 HBR. Both existing structures are 4-span continuous steel girder bridges with R.C. decks and open abutments. Existing structures are curved, skewed 19°-21'-07", 189'-3" long, and vary in width between about 51'-54'. Two lanes of traffic in both directions shall be maintained during reconstruction utilizing stage construction. No salvage materials from the existing structures.

STATE OF ILLINOIS
DEPARTMENT OF TRANSPORTATION

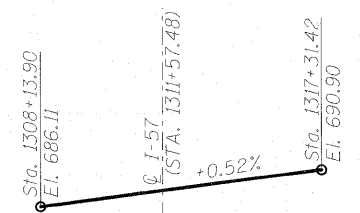
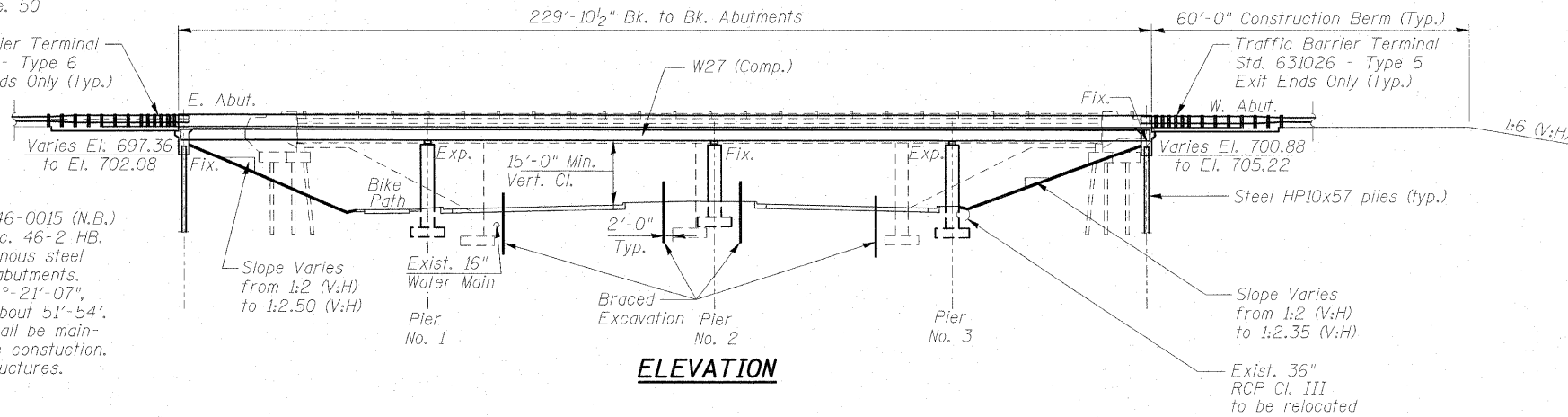

LOADING HS20-44 & ALT.

Allow 50 lbs/sq. ft. for Future Wearing Surface

DESIGN STRESSES

$f'_c = 3,500$ psi
 $f_y = 60,000$ psi (reinforcement)
 $f_y = 50,000$ psi (M270 Gr50)
 $f_y = 36,000$ psi (M270 Gr36)

SEISMIC DATA

Seismic Performance Category (SPC) = A
Bedrock Acceleration Coefficient (A) = 0.04g
Site Coefficient (S) = 1.0

CURVE DATA

P.I. Sta. = 300+42.42
 $\Delta = 59^\circ-17'-30"$ (LT)
 $D = 2^\circ-00'-00"$
 $R = 2,864.79'$
 $T = 1,630.46'$
 $L = 2,964.58'$
 $E = 431.48'$
P.C. Sta. = 284+11.96
P.T. Sta. = 313+76.54
S.E. = 5.44%

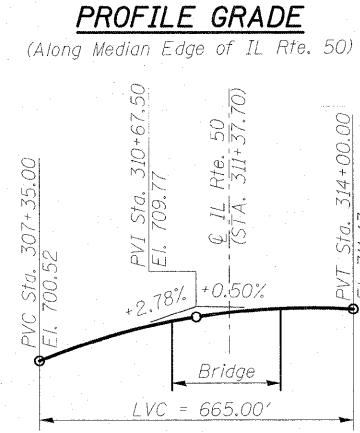

STATION 311+37.70
BUILT 20__ BY
STATE OF ILLINOIS
F.A.I. RT. 57 SEC (46-2) HBR
LOADING HS20
STRUCTURE NO. 046-0144

STATION 311+37.70
BUILT 20__ BY
STATE OF ILLINOIS
F.A.I. RT. 57 SEC (46-2) HBR
LOADING HS20
STRUCTURE NO. 046-0145

NAME PLATE
(Southbound)
See Std. 515001

NAME PLATE
(Northbound)
See Std. 515001

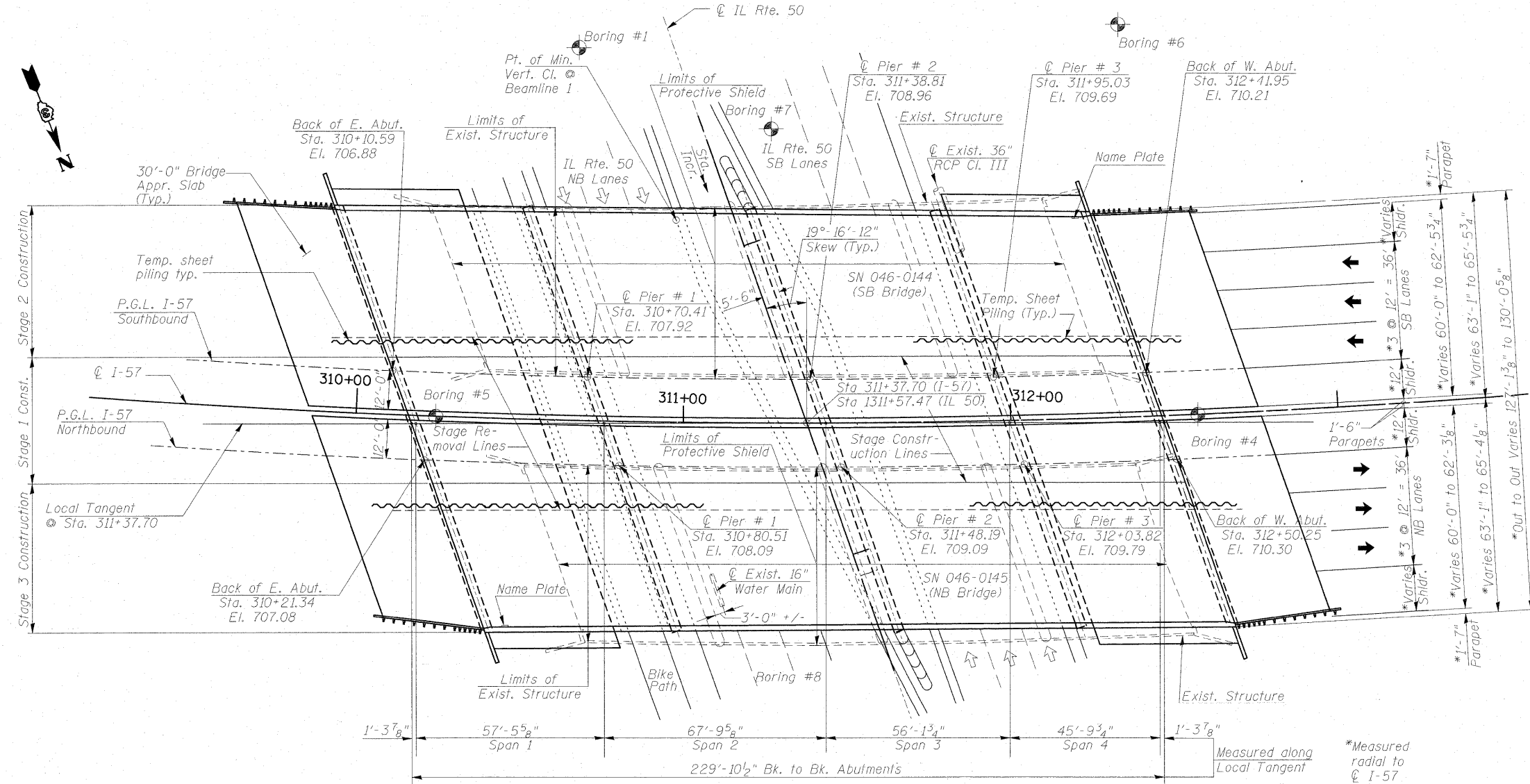
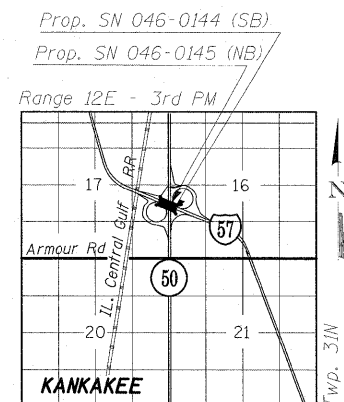

APPROVED
FOR STRUCTURAL ADEQUACY ONLY
Gerald E. Koynass
ENGINEER OF BRIDGES AND STRUCTURES

GENERAL PLAN & ELEVATION
I-57 OVER IL 50
F.A.I. RT. 57 - SEC. (46-2) HBR
KANKAKEE COUNTY
STATION 311+37.70
STRUCTURE NO. 046-0144 (S.B.)
& STRUCTURE NO. 046-0145 (N.B.)

DESIGNED	PMH
CHECKED	BB
DRAWN	AMV
CHECKED	BB

McDonough Associates Inc.
Engineers / Architects
130 East Randolph Street
Chicago, Illinois 60601
(312) 946-8600

SHEET NO. SH-1 SHEETS SH-56	F.A.I. RTE. 57	SECTION (46-2) HBR	COUNTY KANKAKEE	TOTAL SHEETS 558	SHEET NO. 272
	CONTRACT NO. 66409				
FED. ROAD DIST. NO. 3 ILLINOIS FED. AID PROJECT					