

**BENCH MARK**

B.M. # 282: Set chiseled "□" @ Sloped Headwall with Grate, Sta. 282+50, Offset 60' Rt., El. = 669.073

**EXISTING STRUCTURES**

SN 046-0126 built in 2001 as F.A.I. Rte. 57 (I-57), Sec. 46-2 HBR. Existing structure is 2-span continuous steel girder bridge with R.C. deck and vaulted abuts. Existing structure is skewed 16°-16'-36", 216'-4<sup>3</sup>/<sub>4</sub>" long and is 69'-6<sup>5</sup>/<sub>8</sub>" wide. Two lanes of traffic in both directions shall be maintained during construction.

STATE OF ILLINOIS  
DEPARTMENT OF TRANSPORTATION

**INDEX OF DRAWINGS**

- Ret-1 General Plan and Elevation
- Ret-2 Wall Details
- Ret-3 Wall Details
- Ret-4 Soil Boring Log

**DESIGN SPECIFICATIONS**

2004 AASHTO LRFD Bridge Design Specifications with 2005 and 2006 Interims

**DESIGN STRESSES**

f'c = 3,500 psi  
fy = 60,000 psi (reinforcement)  
fy = 50,000 psi (M270 Gr50)

**SEISMIC DATA**

Seismic Performance Category (SPC) = A  
Bedrock Acceleration Coefficient (A) = 0.04g  
Site Coefficient (S) = 1.0

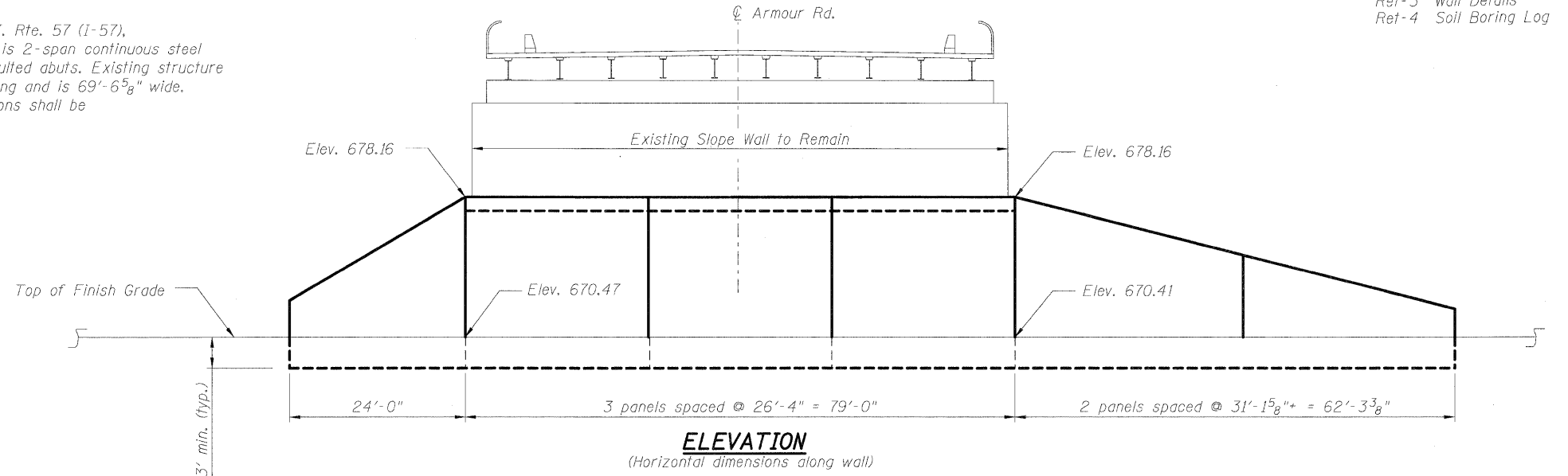

**ELEVATION**  
(Horizontal dimensions along wall)

**BILL OF MATERIAL**

| ITEM                       | UNIT    | TOTAL |
|----------------------------|---------|-------|
| Slope Wall Removal         | Sq. Yd. | 149   |
| Geocomposite Wall Drain    | Sq. Yd. | 112   |
| Soil Nailed Retaining Wall | Sq. Ft. | 1,505 |

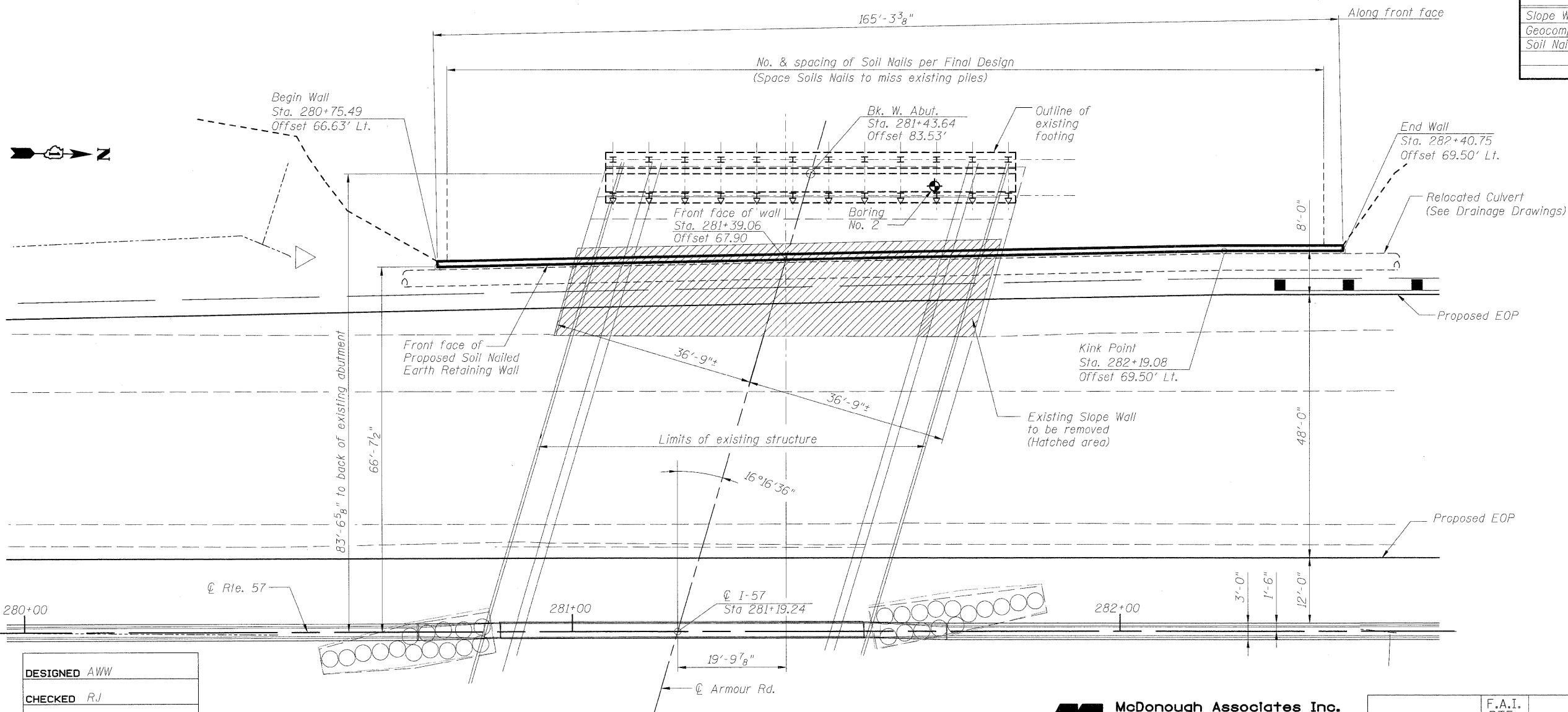

**PLAN**

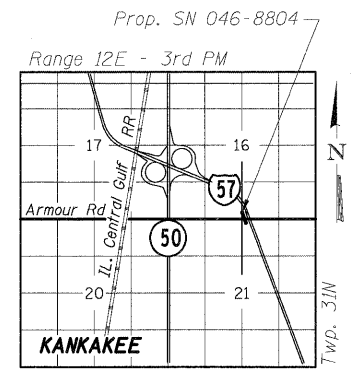

**LOCATION SKETCH**

**GENERAL PLAN AND ELEVATION**  
**ARMOUR RD. OVER I-57**  
**F.A.I. RTE. 57 - SEC. (46-2) HBR**  
**KANKAKEE COUNTY**  
**STATION 280+75.49 TO 282+40.75**  
**STRUCTURE NO. 046-8804**

|          |     |
|----------|-----|
| DESIGNED | AWW |
| CHECKED  | RJ  |
| DRAWN    | RJ  |
| CHECKED  | AWW |

**McDonough Associates Inc.**  
Engineers / Architects  
130 East Randolph Street  
Chicago, Illinois 60601  
(312) 946-8600

| SHEET NO.                                       | F.A.I. RTE. | SECTION    | COUNTY   | TOTAL SHEETS | SHEET NO. |
|---|-------------|------------|----------|--------------|-----------|
| RET-1   | 57          | (46-2) HBR | KANKAKEE | 558          | 376       |
| CONTRACT NO. 66409                              |             |            |          |              |           |
| FED. ROAD DIST. NO. 3 ILLINOIS FED. AID PROJECT |             |            |          |              |           |