

DATE	
BY	
FINAL SURVEY	
SURVEYED	
PLOTTED	
NOTE BOOK	
AREAS	
CHECKED	
NO.	

DATE	
BY	
ORIGINAL SURVEY	
SURVEYED	
PLOTTED	
NOTE BOOK	
AREAS	
CHECKED	
NO.	

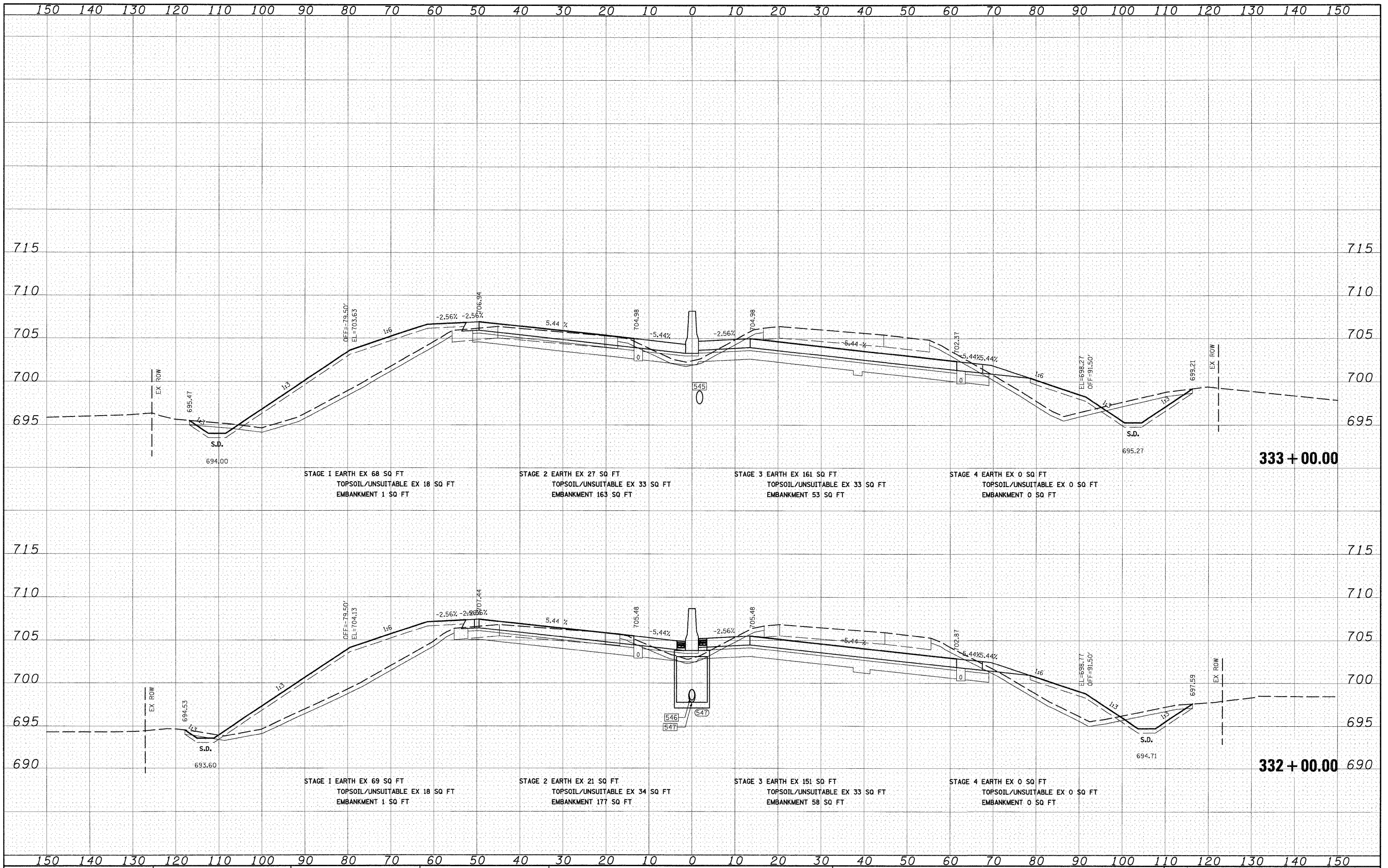

FILE NAME = I:\Dgn\sheets\xs001.dgn

USER NAME = EricG
 DESIGNED - JCL
 DRAWN - JCL
 CHECKED - EJG
 DATE - 12/17/10

REVISED -
 REVISED -
 REVISED -
 REVISED -

**STATE OF ILLINOIS
 DEPARTMENT OF TRANSPORTATION**

I-57 CROSS SECTIONS
 SCALE: 1"=10'H | 1"=5'V SHEET NO. 34 OF 53 SHEETS STA. 332+00.00 TO STA. 333+00.00

F.A.I. RTE.	SECTION	COUNTY	TOTAL SHEETS	SHEET NO.
57	(46-2) I, HBR, VBR	KANKAKEE	558	485
XS-157-34			CONTRACT NO. 66409	
FED. ROAD DIST. NO. 3 ILLINOIS FED. AID PROJECT				