

DATE	
BY	
FINAL SURVEY	SURVEYED
NOTE BOOK	PLOTTED
NO.	AREAS CHECKED

DATE	
BY	
ORIGINAL SURVEY	SURVEYED
NOTE BOOK	PLOTTED
NO.	AREAS CHECKED

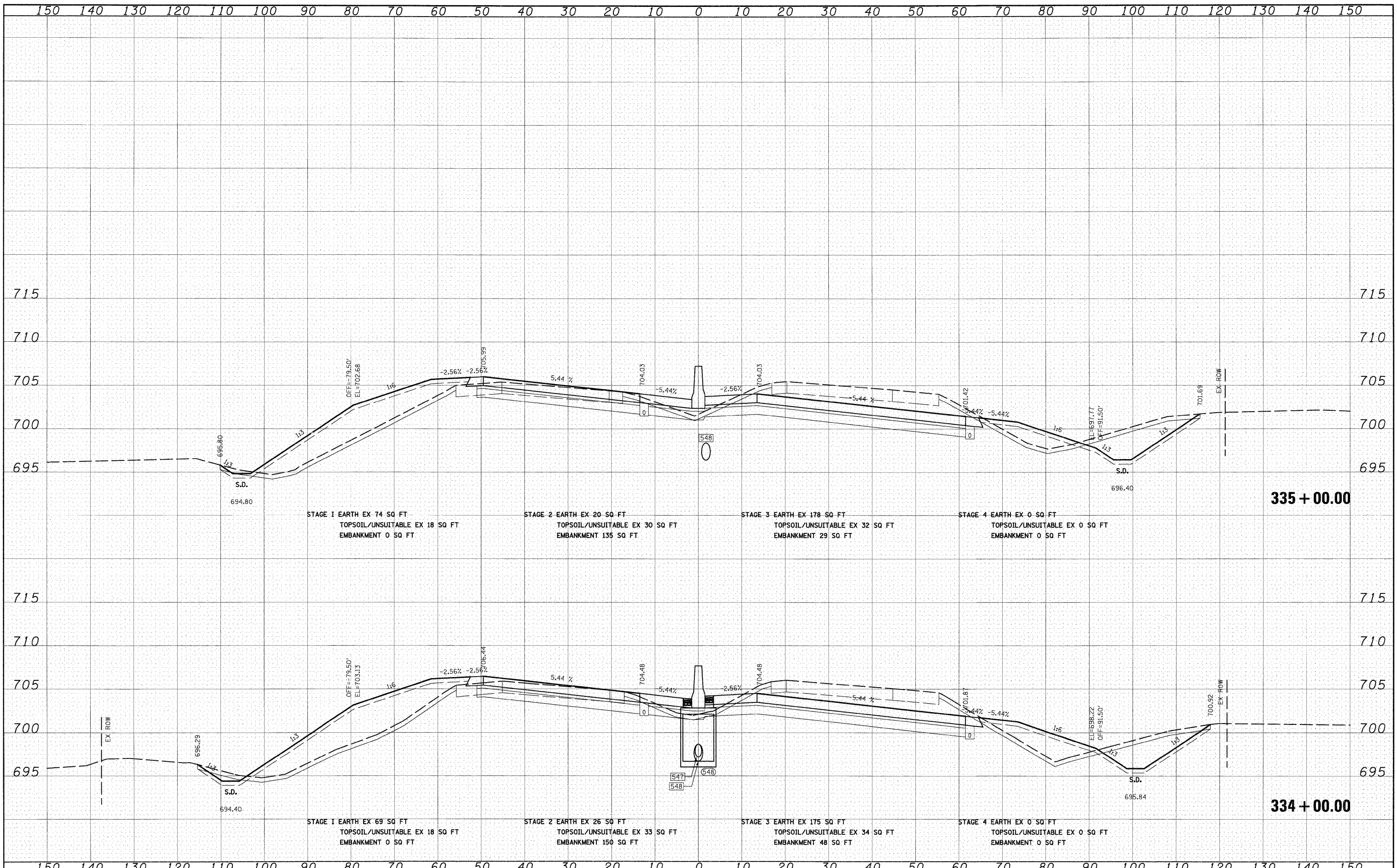

FILE NAME = I:\Ogn\sheets\xs201.dgn  
 USER NAME = Epi10G  
 PLOT SCALE = 1:100  
 PLOT DATE = 12/21/2010

DESIGNED - JCL	REVISED -
DRAWN - JCL	REVISED -
CHECKED - EJG	REVISED -
DATE - 12/17/10	REVISED -

**STATE OF ILLINOIS  
DEPARTMENT OF TRANSPORTATION**

**I-57 CROSS SECTIONS**  
 SCALE: 1"=10'H; 1"=5'V SHEET NO. 35 OF 53 SHEETS  
 STA. 334+00.00 TO STA. 335+00.00

F.A.I. RTE. 57	SECTION (46-2) I, HBR, VBR	COUNTY KANKAKEE	TOTAL SHEETS 558	SHEET NO. 486
<b>XS-157-35</b>		CONTRACT NO. 66409		
FED. ROAD DIST. NO. 3 ILLINOIS FED. AID PROJECT				