

DATE	
BY	
SURVEYED	
PLOTTED	
NOTE BOOK	
AREAS CHECKED	
NO.	

DATE	
BY	
SURVEYED	
PLOTTED	
NOTE BOOK	
AREAS CHECKED	
NO.	

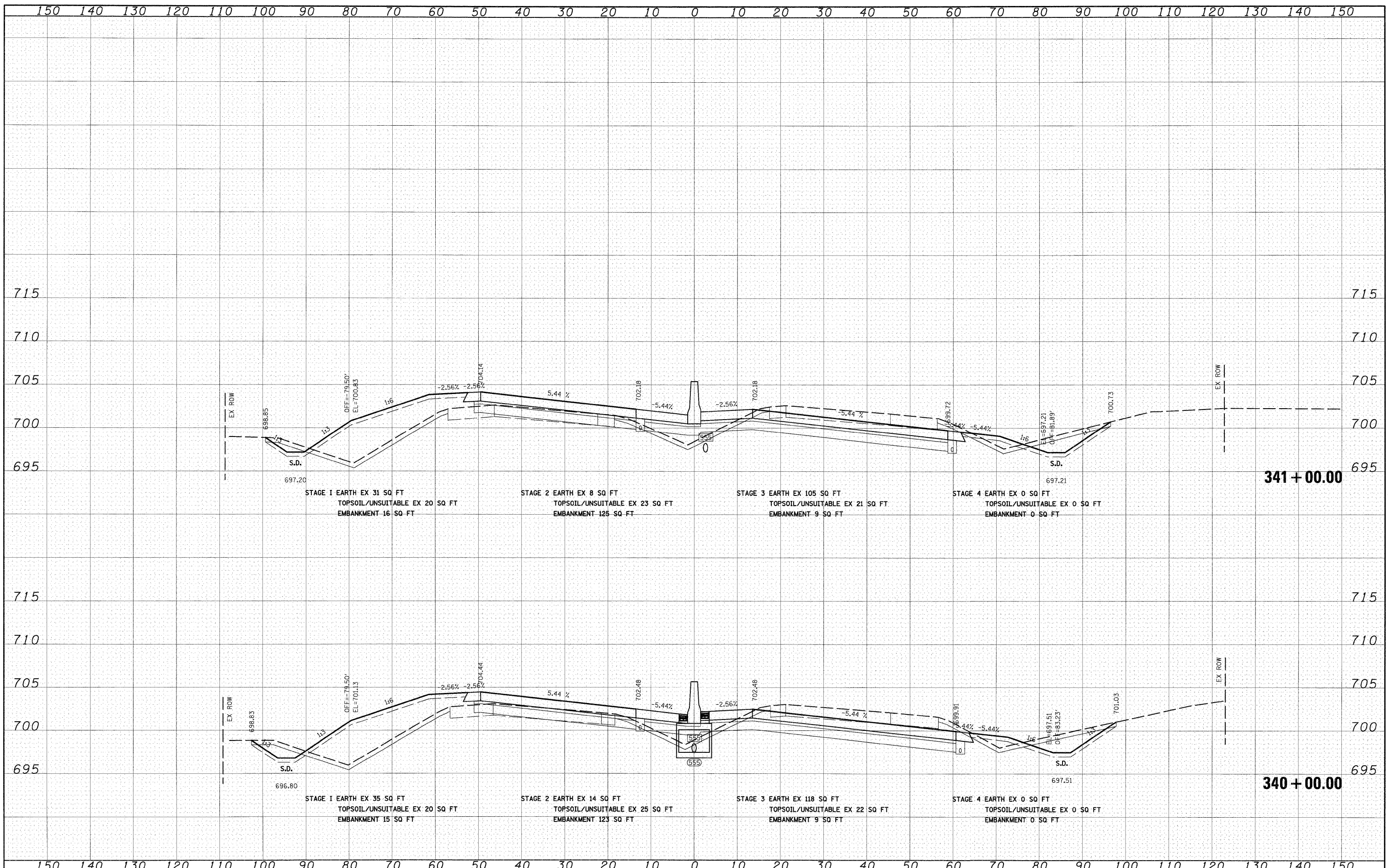

FILE NAME =  
 I:\Dgn\sheets\xs201.dgn

USER NAME = EricG	DESIGNED - JCL	REVISED -
	DRAWN - JCL	REVISED -
PLLOT SCALE = 1:10	CHECKED - E.JG	REVISED -
PLLOT DATE = 12/21/2010	DATE - 12/17/10	REVISED -

**STATE OF ILLINOIS  
 DEPARTMENT OF TRANSPORTATION**

**I-57 CROSS SECTIONS**

SCALE: 1"=10'H; 1"=5'V SHEET NO. 38 OF 53 SHEETS STA. 340+00.00 TO STA. 341+00.00

F.A.I. RTE.	SECTION	COUNTY	TOTAL SHEETS	SHEET NO.
57	(46-2) I, HBR, VBR	KANKAKEE	558	489
<b>XS-157-38</b>		<b>CONTRACT NO. 66409</b>		
FED. ROAD DIST. NO. 3 ILLINOIS FED. AID PROJECT				