

FINAL SURVEY	SURVEYED	BY	DATE
NOTE BOOK	PLOTTED		
NO.	AREAS CHECKED		

ORIGINAL SURVEY	SURVEYED	BY	DATE
NOTE BOOK	PLOTTED		
NO.	AREAS CHECKED		

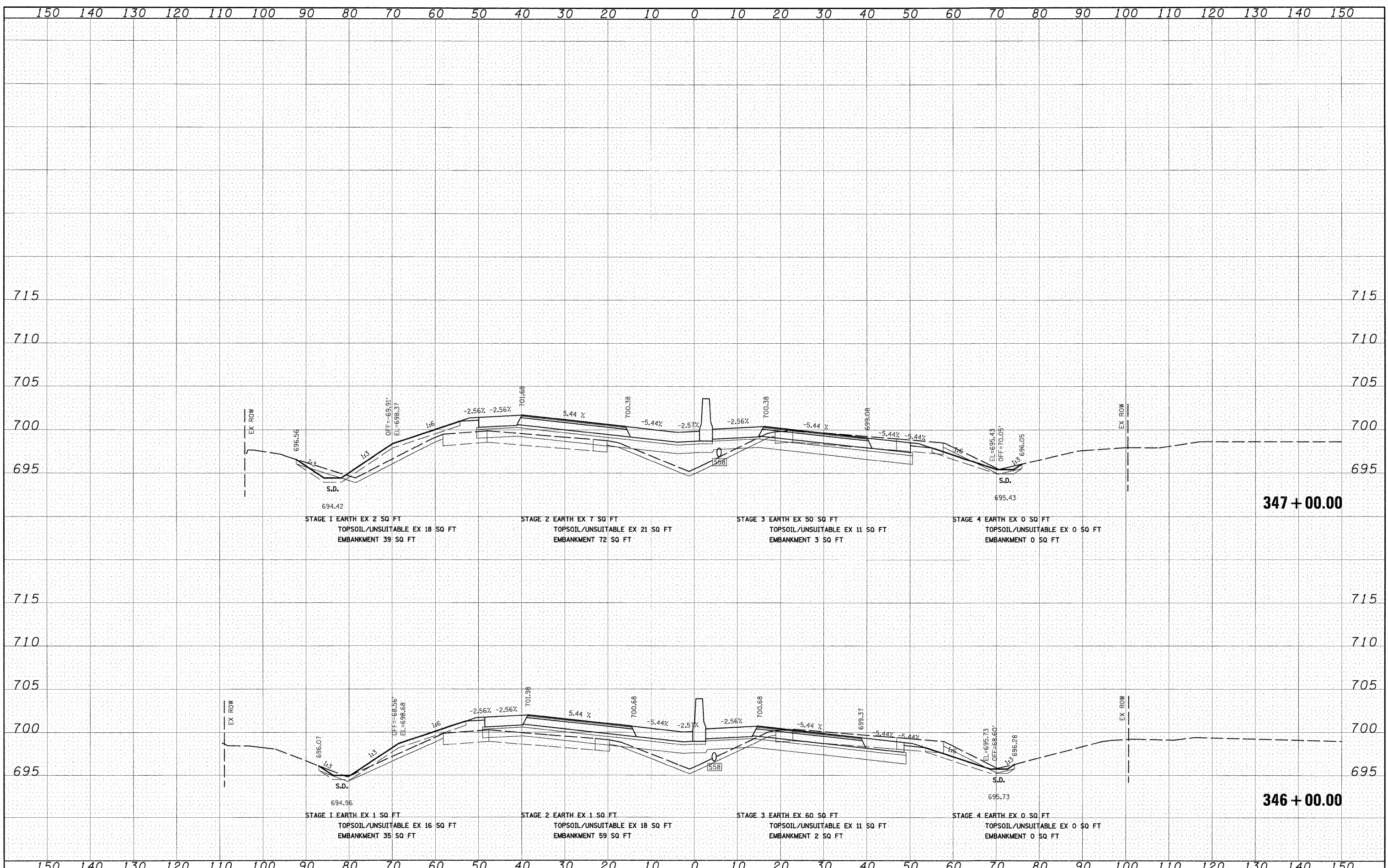

FILE NAME = I:\Dgn\sheets\xs001.dgn
 USER NAME = EricG
 DESIGNED - JCL
 DRAWN - JCL
 CHECKED - EJC
 DATE - 12/17/10

REVISIONS	REVISIONS
REVISIONS	REVISIONS
REVISIONS	REVISIONS
REVISIONS	REVISIONS

**STATE OF ILLINOIS
DEPARTMENT OF TRANSPORTATION**

I-57 CROSS SECTIONS
 SCALE: 1"=10'H; 1"=5'V SHEET NO. 41 OF 53 SHEETS
 STA. 346+00.00 TO STA. 347+00.00

F.A.I. RTE.	SECTION	COUNTY	TOTAL SHEETS	SHEET NO.
57	(46-2) I, HBR, VBR	KANKAKEE	558	492
XS-157-41			CONTRACT NO. 66409	
FED. ROAD DIST. NO. 3 ILLINOIS FED. AID PROJECT				