

JON BELL

TOBY D. RAYMOND AND LINDA L. RAYMOND

GRAPHIC SCALE

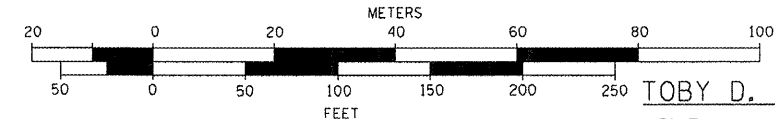

TOBY D. RAYMOND AND LINDA L. RAYMOND

BEGIN IMPROVEMENT SECTION 105BR-1 STA. 751+00.00

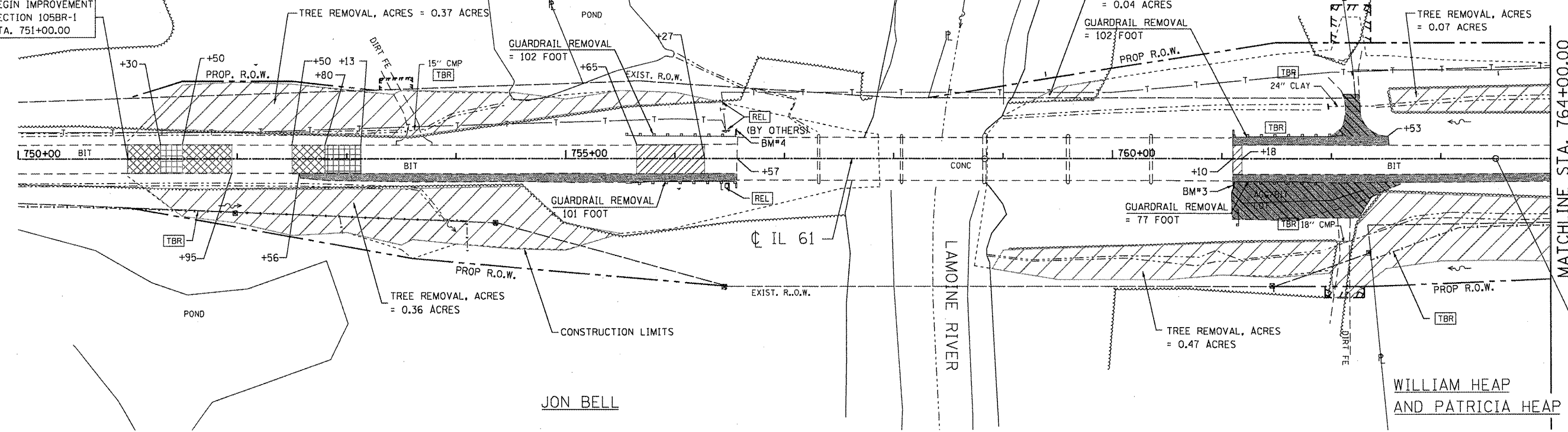

MATCHLINE STA. 764+00.00

TS Sta 763+47.70
EXISTING EQUATION:
Sta 763+50.11 BK =
Sta 763+47.70 AH

WILLIAM HEAP AND PATRICIA HEAP

TOBY D. RAYMOND AND LINDA L. RAYMOND

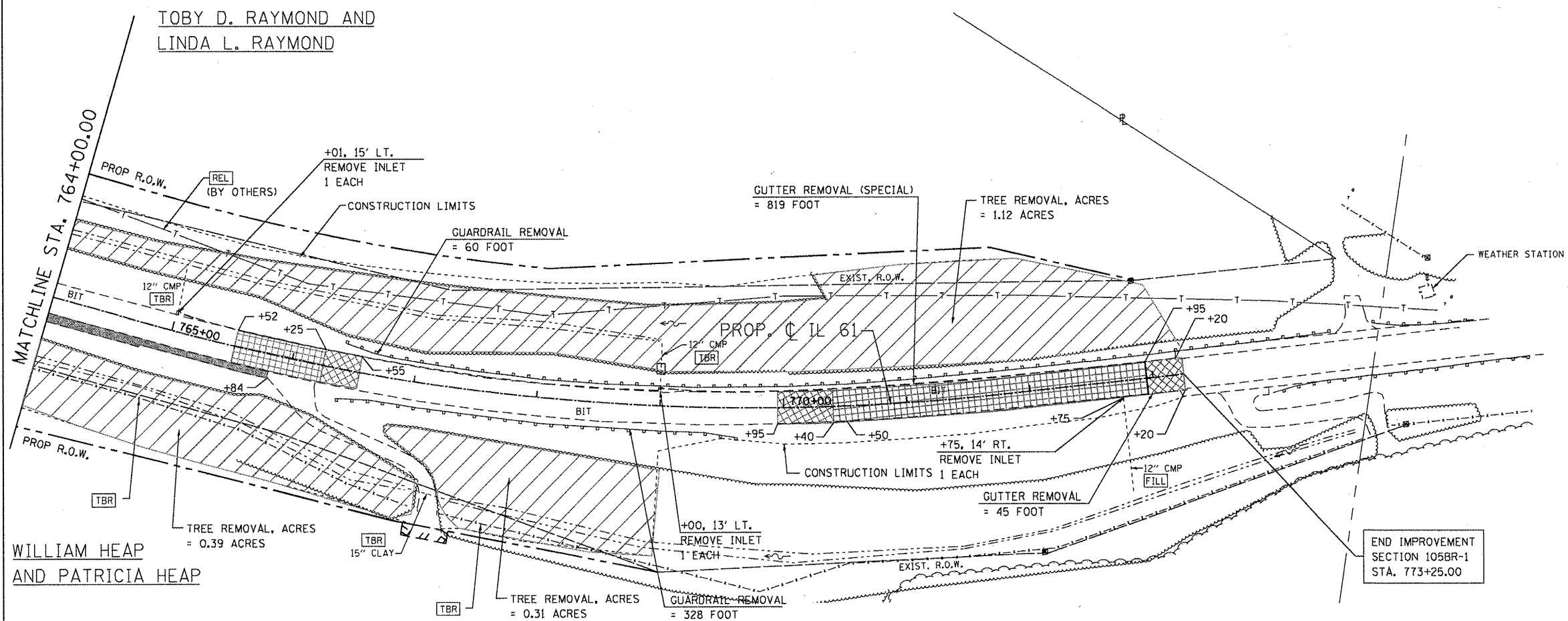

WILLIAM HEAP AND PATRICIA HEAP

END IMPROVEMENT SECTION 105BR-1 STA. 773+25.00

LEGEND

- FILL TO BE FILLED
- TBR TO BE REMOVED
- REL TO BE RELOCATED
- / TREE REMOVAL
- / PAVEMENT REMOVAL
- / HMA SURFACE REMOVAL-BUTT JOINT
- / HMA SURFACE REMOVAL
- / PAVED SHOULDER REMOVAL
- / DRIVEWAY PAVEMENT REMOVAL

USER NAME = gjameson	DESIGNED -	REVISED -
FILE NAME = D468482-shr-removal	CHECKED -	REVISED -
PLOT DATE = 12/21/2010	DRAWN -	REVISED -
PLOT TIME = 10:27:27 AM	CHECKED -	REVISED -

WHKS & CO.
ENGINEERING

7018 KINGSMILL CT.,
SPRINGFIELD, IL
(217) 483-9457
DESIGN FIRM #184001036

STATE OF ILLINOIS
DEPARTMENT OF TRANSPORTATION

REMOVAL PLAN SHEET	
SCALE: 1"=50'	SHEET NO. 1 OF 1 SHEETS
STA. 751+00 TO STA. 773+25	

F.A. RTE. 542	SECTION 105BR-1	COUNTY McDONOUGH	TOTAL SHEETS 117	SHEET NO. 22
CONTRACT NO. 68482				
FED. ROAD DIST. NO. 4 ILLINOIS FED. AID PROJECT				