

STATE OF ILLINOIS
DEPARTMENT OF TRANSPORTATION

* Order a(E) and a₁(E) bars full length.
Cut to fit skew and use remainder
of bars in opposite end.

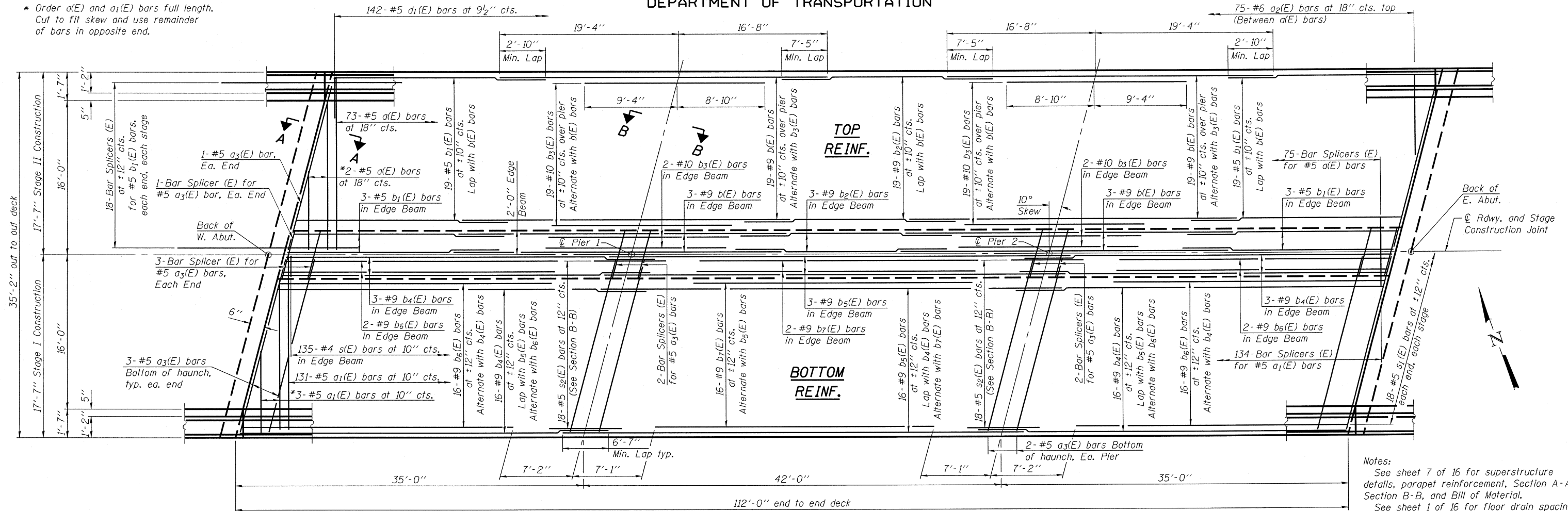

PLAN

Notes:
See sheet 7 of 16 for superstructure details, parapet reinforcement, Section A-A, Section B-B, and Bill of Material.
See sheet 1 of 16 for floor drain spacing. All bars, except bar splicers, are typical for each stage.
See sheet 14 of 16 for Bar Splicer details. Space reinforcement to clear floor drains.

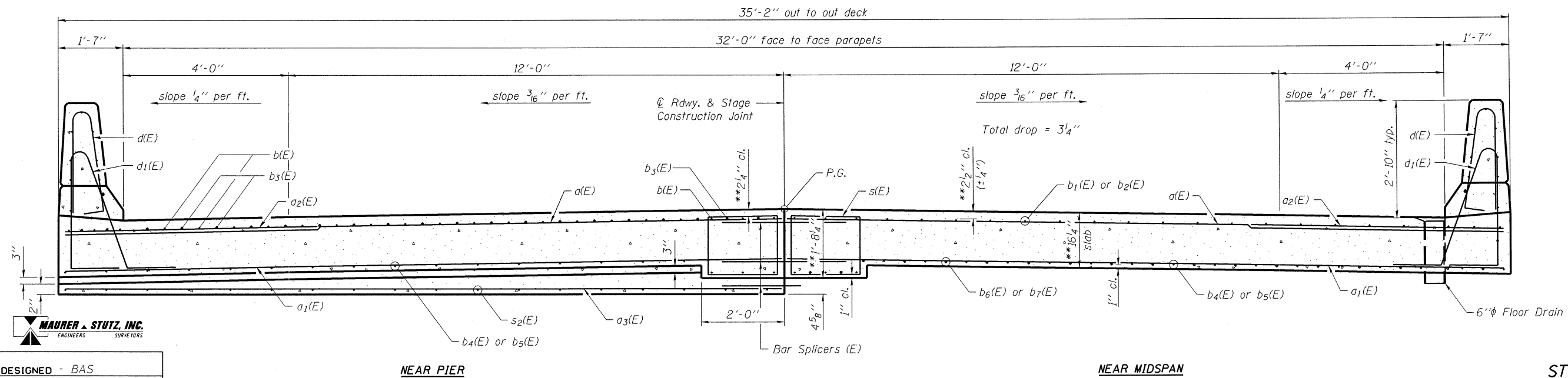

CROSS SECTION
(Looking East)

** Prior to grinding

MAURER & STUTZ, INC.
ENGINEERS SURVEYORS

DESIGNED -	BAS
CHECKED -	KEF
DRAWN -	SGM
CHECKED -	BAS

SUPERSTRUCTURE
STRUCTURE NO. 074-0087

SHEET NO. 6 16 SHEETS	F.A.S. RTE.	SECTION	COUNTY	TOTAL SHEETS	SHEET NO.
	1517	11BR-1	PIATT	48	23
FED. ROAD DIST. NO. -			ILLINOIS FED. AID PROJECT		
CONTRACT NO. 70613					