

SEC. 36, T16N, R7E, 3RD P.M.

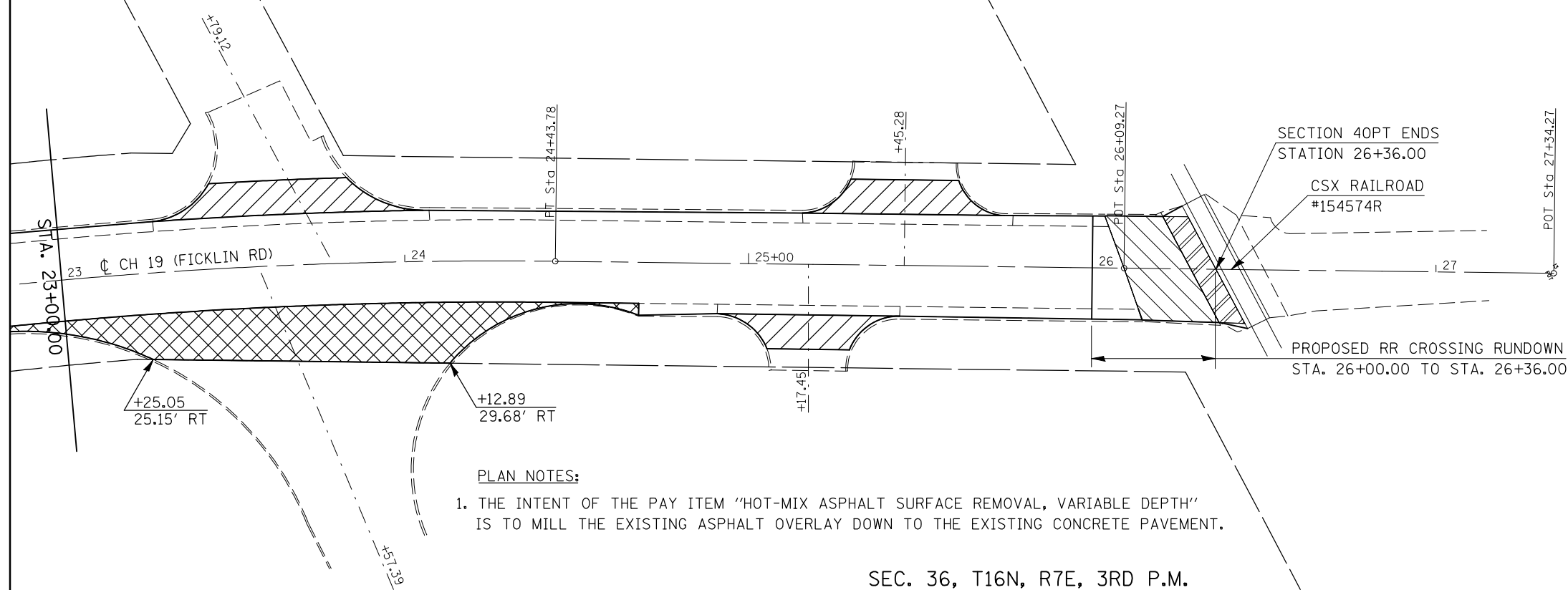
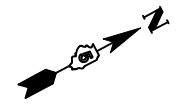

**PLAN NOTES:**  
 1. THE INTENT OF THE PAY ITEM "HOT-MIX ASPHALT SURFACE REMOVAL, VARIABLE DEPTH" IS TO MILL THE EXISTING ASPHALT OVERLAY DOWN TO THE EXISTING CONCRETE PAVEMENT.

- INCIDENTAL SURFACING
- HMA SURFACE REMOVAL, SPECIAL
- HMA SURFACE REMOVAL, VARIABLE DEPTH
- CLASS D PATCHES, TYPE II, 13"

SEC. 36, T16N, R7E, 3RD P.M.

FILE NAME =	USER NAME = hennessdm	DESIGNED -	REVISED -
ct:\pw\work\p1dot\hennessdm\d0242491\0570875-sh1-Db1P1n.dgn		DRAWN -	REVISED -
	PLOT SCALE = 40.0000' / IN.	CHECKED -	REVISED -
	PLOT DATE = 2/1/2011	DATE -	REVISED -

**STATE OF ILLINOIS  
DEPARTMENT OF TRANSPORTATION**

<b>PLAN SHEET</b>			
SCALE:	SHEET NO.	OF SHEETS	STA. TO STA.

F.A. RTE.	SECTION	COUNTY	TOTAL SHEETS	SHEET NO.
CH 19	40PT	DOUGLAS	25	16
CONTRACT NO. 70875			ILLINOIS FED. AID PROJECT	