

STATE OF ILLINOIS
DEPARTMENT OF TRANSPORTATION

DIVISION OF HIGHWAYS
**PROPOSED
HIGHWAY PLANS**
VARIOUS ROUTES
SECTION D5 CRACK & JOINT SEAL 2011-1
ROUTE & SEAL
MCLEAN, DEWITT, PIATT COUNTIES

C-95-057-10

SEE PAGES 3-9 FOR LOCATION MAPS, GROSS & NET LENGTHS OF PROJECT BY LOCATION

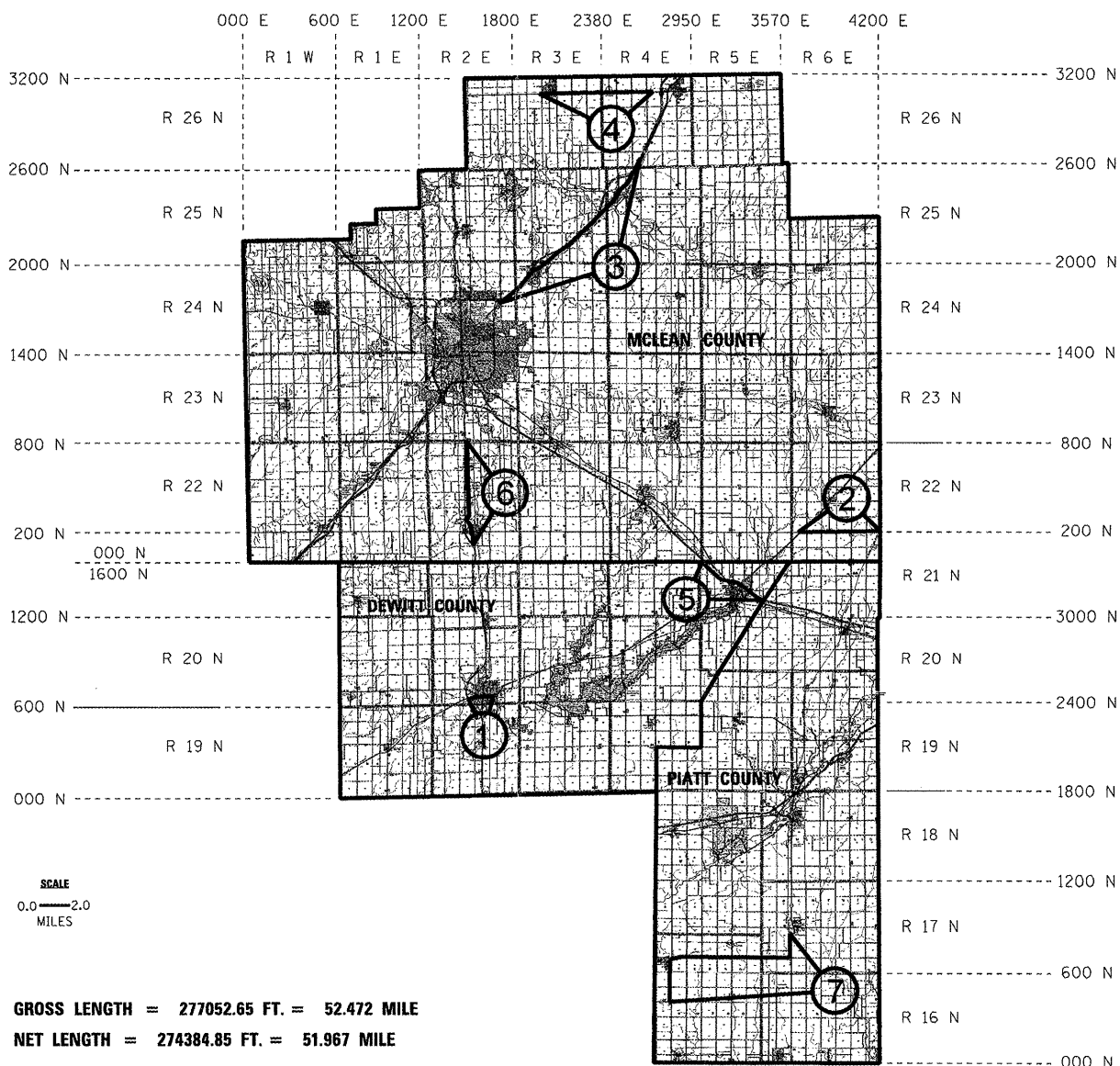

GROSS LENGTH = 277052.65 FT. = 52.472 MILE
NET LENGTH = 274384.85 FT. = 51.967 MILE

F.A. RTE.	SECTION	COUNTY	TOTAL SHEETS	SHEET NO.
VAR.	*	**	33	1
		ILLINOIS	CONTRACT NO. 70880	

* D5 CRACK & JOINT SEAL 2011-1
** MCLEAN, DEWITT, & PIATT

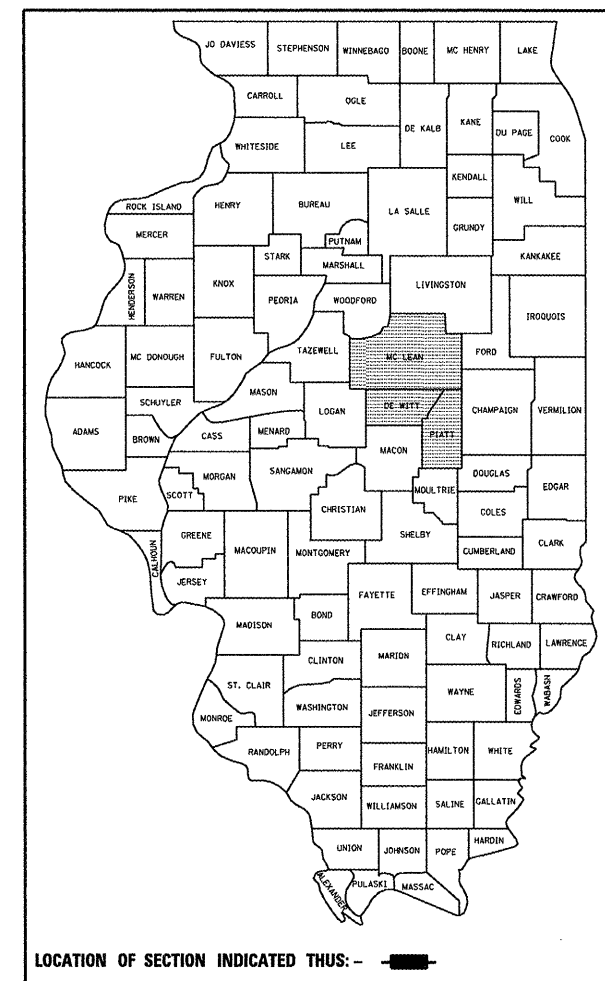

LOCATION OF SECTION INDICATED THUS: - [shaded area] -

FOR INDEX OF SHEETS, SEE SHEET NO. 2

- LOCATION 1: FAP 71 (IL54)
AVERAGE ADT = 10,300 (2010)
FROM I-51 BYPASS TO IL10/IL54 SPLIT
- LOCATION 2: FAP 709 (US136)
AVERAGE ADT = 800 (2010)
FROM IL54 TO CHAMPAIGN COUNTY LINE
- LOCATION 3: OLD ROUTE 66
AVERAGE ADT = 2350 (2010)
FROM NO. OF LEXINGTON TO SO. OF TOWANDA
- LOCATION 4: FAP 317 (US24)
AVERAGE ADT = 6300 (2010)
FROM GRIDLEY TO CHENOA
- LOCATION 5: FAI - 74 DEWITT COUNTY
AVERAGE ADT = 19500 (2010)
FROM MCLEAN COUNTY TO PIATT COUNTY
- LOCATION 6: FAS 1476 (OLD US51)
AVERAGE RURAL ADT = 700 (2010)
AVERAGE URBAN ADT = 2000 (2010)
FROM SO. OF I-74 TO SO. OF HEYWORTH
- LOCATION 7: FAP 741 (IL105)
AVERAGE NB/SB ADT = 1700 (2010)
AVERAGE EB/WB ADT = 900 (2010)
FROM SO. OF BEMENT TO SO. OF CERRO GORDO

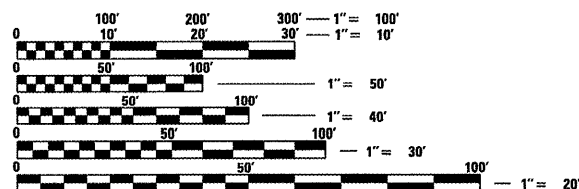

FULL SIZE PLANS HAVE BEEN PREPARED USING STANDARD ENGINEERING SCALES. REDUCED SIZED PLANS WILL NOT CONFORM TO STANDARD SCALES. IN MAKING MEASUREMENTS ON REDUCED PLANS, THE ABOVE SCALES MAY BE USED.

J.U.L.I.E.
JOINT UTILITY LOCATION INFORMATION FOR EXCAVATION
1-800-892-0123
OR 811

PROJECT ENGINEER : NANCY FASIG
PROJECT MANAGER : TODD BLACK
PHONE NUMBER: (217)-465-4181
CONTRACT NO. 70880

STATE OF ILLINOIS
DEPARTMENT OF TRANSPORTATION
DIVISION OF HIGHWAYS

SUBMITTED 2/1 20 11
Justin L. Anderson
DEPUTY DIRECTOR OF HIGHWAYS, REGION ENGINEER

March 25 20 11
Scott E. Stitt, P.E.
Acting ENGINEER OF DESIGN AND ENVIRONMENT

March 25 20 11
Christine M. Reed
DIRECTOR OF HIGHWAYS, CHIEF ENGINEER

PRINTED BY THE AUTHORITY
OF THE STATE OF ILLINOIS