

LOCATION MAP 3 – MCLEAN COUNTY

OLD ROUTE 66 FROM NO. OF LEXINGTON TO SO. OF TOWANDA

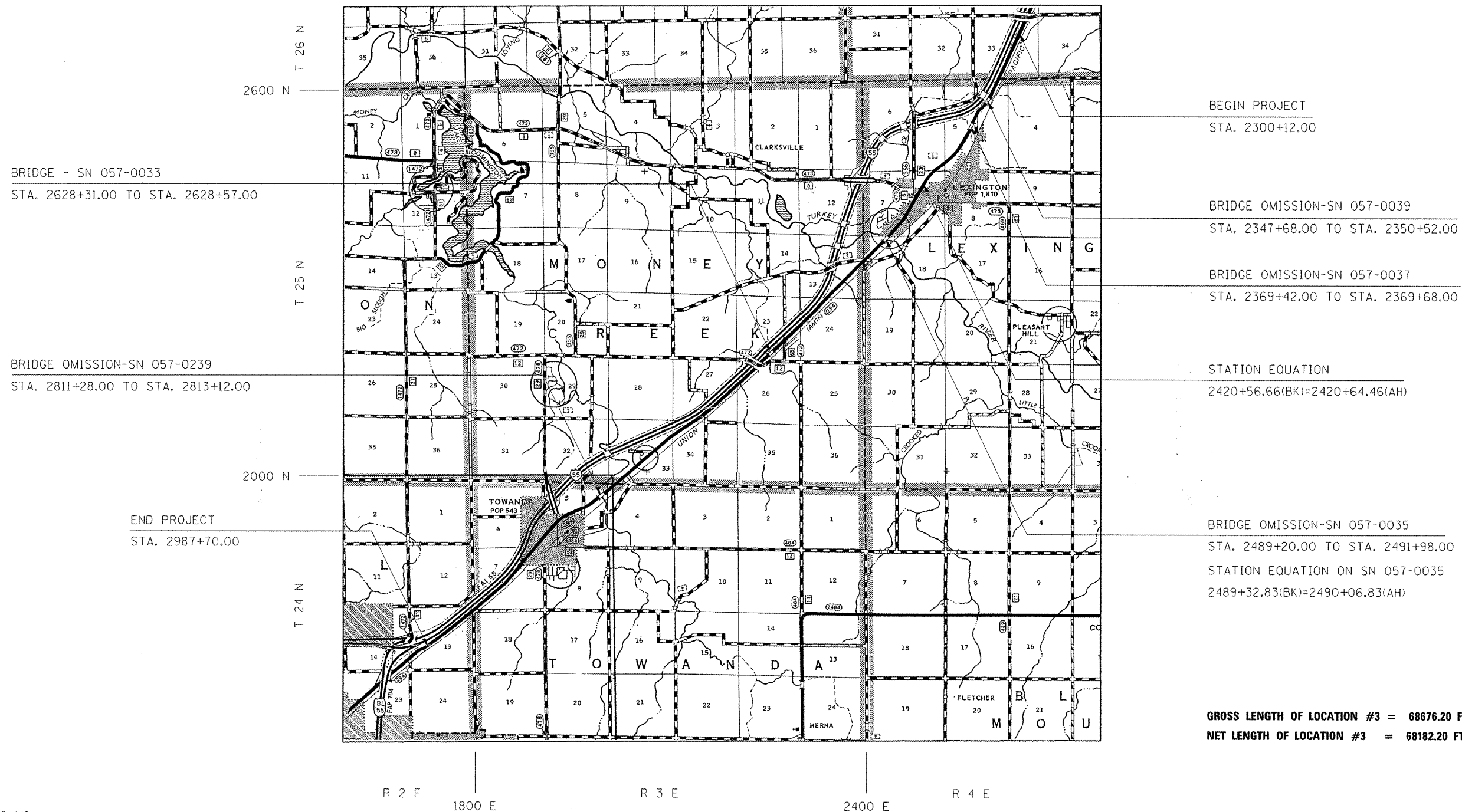

SCALE
1.28125" = 1.0 MI
0.0 0.5 1.0

GROSS LENGTH OF LOCATION #3 = 68676.20 FT. = 13.007 MILE
NET LENGTH OF LOCATION #3 = 68182.20 FT. = 12.913 MILE

* D5 CRACK & JOINT SEAL 2011-1
** MCLEAN, DEWITT, & PIATT

FILE NAME = c:\pwwork\pwwork\mcdot\mcdot\0252724\05	USER NAME = bucklesjj 0880-shr-cover.dgn	DESIGNED -	REVISED -	STATE OF ILLINOIS DEPARTMENT OF TRANSPORTATION	LOCATION MAP #3	F.A. RTE.	SECTION	COUNTY	TOTAL SHEETS	SHEET NO.
		DRAWN -	REVISED -			VAR.	*	**	33	5
		CHECKED -	REVISED -							
		DATE -	REVISED -							
						SCALE:	SHEET NO. 1 OF 1 SHEETS	STA. 2300+12.00 TO STA. 2987+70.00	CONTRACT NO. 70880	
ILLINOIS FED. AID PROJECT										