

TYPICAL PLACEMENT OF PRISMATIC REFLECTORS ON CURBS

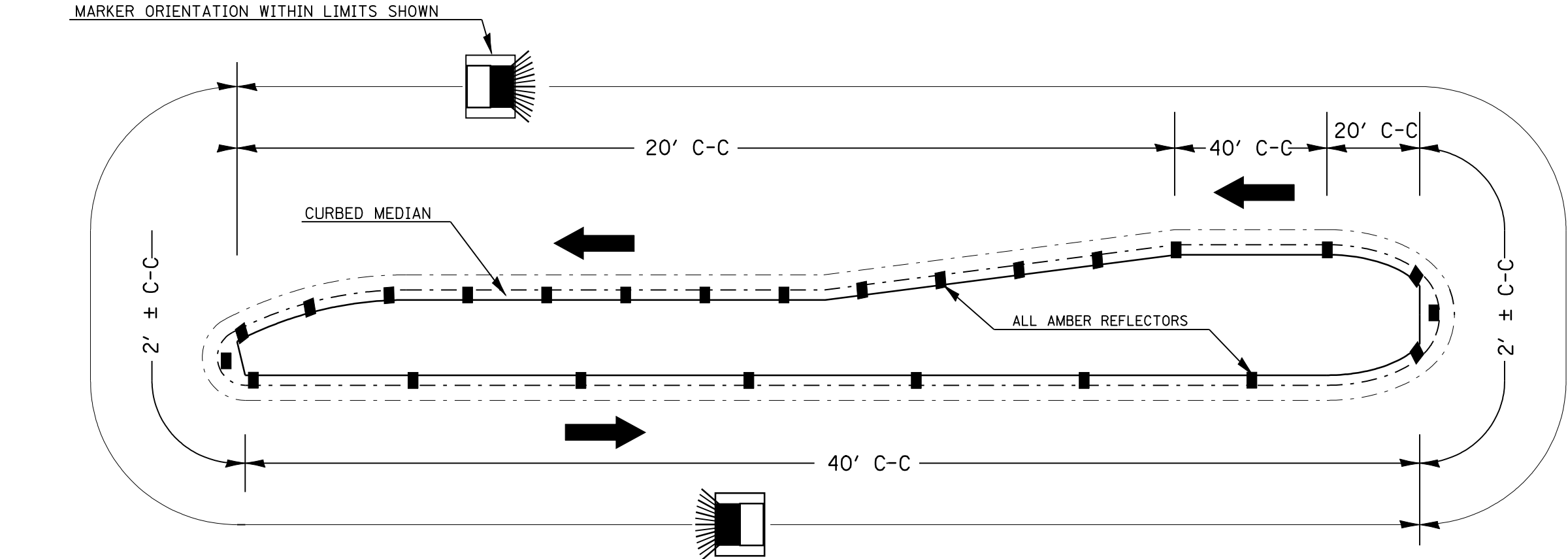

1. PRISMATIC REFLECTORS SHALL BE MONO-DIRECTIONAL AND POSITIONED SO THAT THE REFLECTIVE FACE IS FACING THE APPROACHING TRAFFIC.
2. PRISMATIC REFLECTORS SHALL BE SECURED IN PLACE WITH AN EPOXY ADHESIVE.
3. PRISMATIC REFLECTORS SHALL BE EITHER AMBER OR CRYSTAL IN COLOR.
4. REFER TO SCHEDULES FOR PRISMATIC REFLECTOR QUANTITIES.

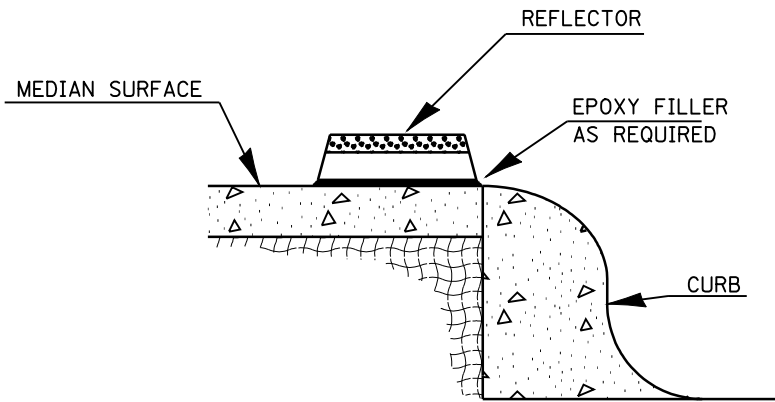
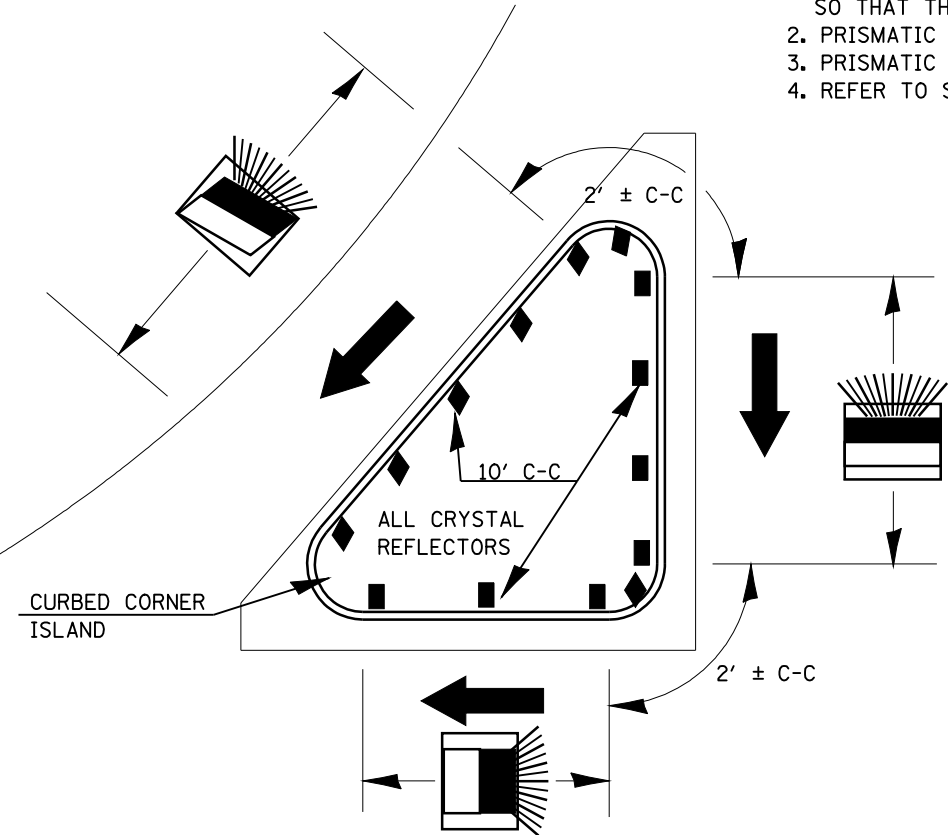

SECTION VIEW

LEGEND

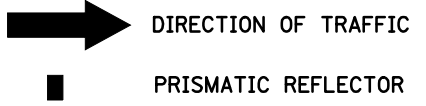

NOT TO SCALE

FILE NAME =	USER NAME = coxte	DESIGNED -	REVISED -	STATE OF ILLINOIS DEPARTMENT OF TRANSPORTATION	PRISMATIC REFLECTOR DETAILS (PLACED ON CURB)				F.A.I. RTE.	SECTION	COUNTY	TOTAL SHEETS	SHEET NO.
c:\pw_work\pwidot\coxte\dms62217\067292	-sht-details.dgn	DRAWN -	REVISED -						55	(59,68)RS-3,BR	*	137	81
PRISM.DGN	PLOT SCALE = 100.0000 ' / IN.	CHECKED -	REVISED -						CONTRACT NO. 72921				
	PLOT DATE = Feb-07-2011 02:03:57PM	DATE -	REVISED -						ILLINOIS FED. AID PROJECT				
					SCALE:	SHEET NO.	OF	SHEETS	STA.	TO STA.	MONTGOMERY, MACOUPIN		